

WELCOME GUIDE

* For safety issue, the product remains low capacity during shipping. Please fully charge the product before initial use!
Please read this Guide carefully before using the product

Product Overview

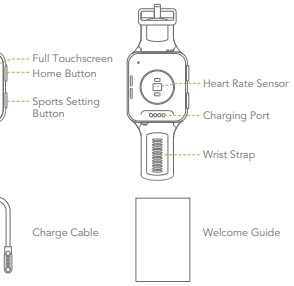

Basic Product Specifications

Display Screen:	1.69" TFT 240*280
Battery Capacity:	300mAh
Battery Type:	Lithium polymer battery
Standby Time:	7 days
Watch Size:	51.8* 36.8* 12.2mm (Strap Not Included)
Weight:	37.0g (Strap Included)
Material:	ABS/PC/LSR
Waterproof:	IP68

* oraimo Lab test result

EN 01

Setting Up Your Smart Watch

For the best experience we recommend using the Joywear 2 App for iOS and Android.

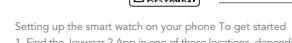

For iOS 9.0 or above
For Android 4.4 or above

The Apple App Store for iPhone.
The Google Play Store for Android phone.

Setting up the smart watch on your phone To get started
1. Find the Joywear 2 App in one of these locations, depending on your device:
2. Install the App. Note that if you don't have an account with the store you'll be required to create one before you can download the App.
3. When the App is installed, open it and be guided through a series of questions that help you create your account, or login to your existing account.
4. Continue following the onscreen instructions to connect, or pair the product to your phone.

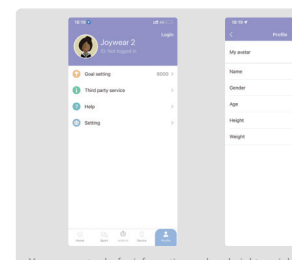

Your account asks for information such as height, weight, and gender to make various calculations such as stride lengths to estimate distance and basal metabolic rate to estimate calorie burn. You can modify your information in Joywear 2-Profile-Me.

EN 02

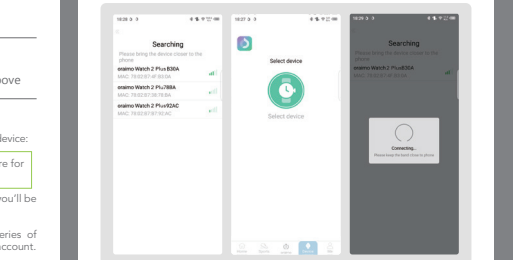

Use Joywear 2 APP to scan QR code on the watch:

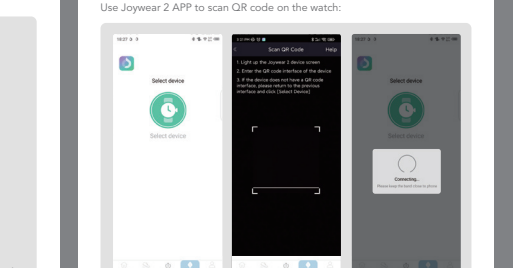

EN 03



The charging dock is not water resistant. Wipe the port, metal contacts, and the device dry before charging.

If you can't pair successfully, try the following methods:

1. Make sure the BT permission is allowed for the app;
2. Make sure the watch is not connected with another phone;
3. Try turning off and on again the BT switch on your phone;
4. If none of these work, try rebooting your phone and the watch, and repeat the above steps again.

Getting To Know Your Smart Watch

Wrist Placement

For all-day wear, your watch should usually rest a finger's width below your wrist bone and lay flat, as you would normally wear a watch.



Charge Your Watch

Connect the metal contacts on the charging dock to those on the back of the device, then put them on a flat surface.



Connect the charging cradle to a power supply, the device's screen will light up and display the battery level.

EN 03

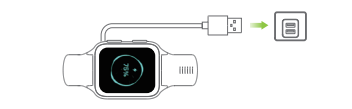

Power On/Off

- When the watch is powered off, charge the watch or long press the home button for 3 seconds to power it on.
- When the watch is turned on, press and hold the side button for 3 seconds. Choose Power Off and tap again to confirm. The watch vibrates and turns off. You can also power off from the "Settings" menu. (Settings – System Settings – Power Off)

Wake Up the Watch

When you're not using this product, the display is off. To wake it up:
• Press the side button.
• Turn your wrist towards you. This function, known as "Raise to Wake", can be turned off in Settings – Raise to wake – Raise to wake. You can also schedule when it's activated during the day.

Using The Clock And Menus

The home screen is a clock. From here you can swipe to see data about your steps, activity time, calories, heart rate, and functions like training modes, weather, message, music, etc.

Controls

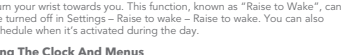

EN 04



Full Touch Screen

1. Hold the home screen to change the watch face
2. Swipe to go different interfaces
3. Tap to enter the function
4. Swipe the screen to the right to return to the previous interface

Control Center

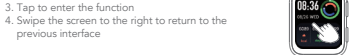

EN 05

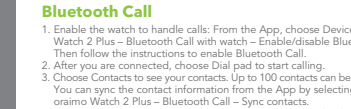

Bluetooth Call

1. Enable the watch to handle calls: From the App, choose Devices – oraimo Watch 2 Plus – Bluetooth Call with watch – Enable/disable Bluetooth Call. Then follow the instructions to enable Bluetooth Call.
2. After you are connected, choose Dial pad to start calling.
3. Choose Contacts to see your contacts. Up to 100 contacts can be displayed. You can sync the contact information from the App by selecting Devices – oraimo Watch 2 Plus – Bluetooth Call – Sync contacts.
4. Choose Recent Contacts to see your recent contacts since the Bluetooth Call function is enabled. Up to 20 recent contacts can be displayed.

Troubleshooting

Can't connect with BT.
1. Make sure your device supports BT 5.1. Make sure your device's software is or above iOS 9.0 or Android 4.4.
2. Restart BT and reconnect after 20 seconds.
3. Restart mobile phone.
4. Make sure mobile phone is not connected with other device.
5. Make sure Joywear 2 is running in system.

Can't search the product.
BT: 2402-2480MHz (TX/RX).
Make sure your location services are enabled (GPS is working), the product has enough power, the product does not connect with other phone and under activated state, then keep the product close to your phone. If still can not search it, please turn off BT function and reconnect after 20 seconds.

Can't monitor heart rate.
Make sure you wear tightly enough to monitor heart rate.

Can't receive notifications after enabling it.
Android phone: Make sure the product is connected with your phone. Allow Joywear 2 App to access notifications. If any security App installed, add Joywear 2 to trust list.
iPhone: Make sure the product is connected with your phone. Reboot your phone and reconnect it with the product.

Is the product waterproof?
This product supports IP68 waterproof which allows the product to be held in water for a maximum of 30 minutes at a depth of 1 metre. You can wear it while washing your hands, having a cold shower or washing your car. Please do not wear it while diving or scuba diving.

Do I need to connect BT all the time? Are there data left when product disconnected with mobile via BT?
Data will be kept in product for seven days. When product is connected with mobile, data will be uploaded to mobile automatically. Kindly synchronize product data to mobile in time.
Note: Call and message notifications only work under BT connection status.

EN 06



User Manual Smart Watch

Model: OSW-32N
Hereby, ORAIMO TECHNOLOGY LIMITED
Declares that this Smart Watch is in compliance with the essential requirements and other relevant provisions of directive 2014/53/EU.

CAUTION

1. Risk of explosion if battery is replaced by an incorrect type, dispose of used batteries according to the instructions.
- disposal of a battery into fire or a hot oven, or mechanically crushing or cutting of a battery, that can result in an explosion;
- leaving a battery in an extremely high temperature surrounding environment that can result in an explosion or the leakage of flammable liquid or gas;
- a battery subjected to extremely low air pressure that may result in an explosion or the leakage of flammable liquid or gas.
2. EUT Temperature: -10°C – +60°C (Standalone).

Operating Frequency

BT: 2402-2480MHz (TX/RX);
Modulation mode: GFSK (BLE)
RF output power: Only for CE
BLE1M: 4.88dBm
BLE2M: 4.99dBm

FCC CAUTION

Any Changes or modifications not expressly approved by the party responsible for compliance could void the user's authority to operate the equipment.
This device complies with part 15 of the FCC Rules. Operation is subject to the following two conditions: (1) This device may not cause harmful interference, and (2) this device must accept any interference received, including interference that may cause undesired operation.

IMPORTANT NOTE

Note: This equipment has been tested and found to comply with the limits for a Class B digital device, pursuant to part 15 of the FCC Rules. These limits are designed to provide reasonable protection against harmful interference in a residential installation. This equipment generates, uses and can radiate radio frequency energy and, if not installed and used in accordance with the instructions, may cause harmful interference to radio communications. However, there is no guarantee that interference will not occur in a particular installation. If this equipment does cause harmful

EN 07

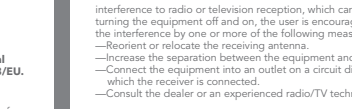

FCC Radiation Exposure Statement

This equipment complies with FCC radiation exposure limits set forth for an uncontrolled environment.

EU Declaration of Conformity

In accordance with EU Directives and Regulations
Company name: ORAIMO TECHNOLOGY LIMITED
Address: FLAT 39 8/F BLOCK D WAH LOK INDUSTRIAL CENTRE 31-35 SHAN MEI STREET FOTAN NT

as the manufacturer hereby declares under our sole responsibility that the Product(s): Smart watch
Model name: OSW-32N
is in conformity with the essential requirements of the RE Directive 2014/53/EU:

Radio: ETSI EN 300 328 V2.2.2 (2019-07)
Article 3.2
EMC: ETSI EN 301 489-1 V2.2.3 (2019-11)
Article 3.1(b) ETSI EN 301 489-17 V3.2.4 (2020-09);
EN IEC 62368-1:2020+A11:2020
Safety: EN IEC 62368-1:2020+A11:2020
Article 3.1(a)
Health: EN 50663:2017, EN 62479:2010
Article 3.1(a)

An EU Type Examination Certificate for this Product was issued in accordance with Annex III (Module B) of the 2014/53/EU Radio Equipment Directive by Bay Area Compliance Laboratories Corp. (2014/53/EU Radio Equipment Directive Notified Body Identification Number 1313)

Signed on behalf of ORAIMO TECHNOLOGY LIMITED
(Signature of authorized person)

roject Manager: Y. Ting Liao
Date: 2022-05-24

EN 08



Customer Service

365 DAYS WARRANTY

Email: care.in@oraimo.com
Nigeria: care.ng@oraimo.com
Kenya: care.ke@oraimo.com
Ghana: care.gh@oraimo.com
Morocco: care.ma@oraimo.com
Egypt: care.eg@oraimo.com
South Africa: care.za@oraimo.com
Others: service@carcare.com

Warranty Certificate

Name :	
Address :	
Tel. No. :	
Date of purchase (dd/mm/yy) :	
Store name :	
Warranty period :	

Warranty Terms & Conditions

* All quality-related defects on items sold directly by oraimo or oraimo's authorized resellers are covered by an extensive warranty, starting from the date of purchase.

* oraimo's limited warranty is restricted to the country of purchase. The limited warranty is void on items taken outside the country they were originally bought in or shipped to directly from an authorized online purchase.

* This warranty covers only original oraimo products. It is not applicable to normal wear and tear, or any defects arising from damage caused by misuse of this product.

* Warranty is for the primary product only non transferable. Any free additional product(s) are not covered in this warranty.

* If the product fails regardless of usage in compliance with the instruction manual and other written precaution, replacement will be provided free of charge.

* To receive replacement, bring the warranty certificate and the product itself to the store from where you have purchased the product.

EN 09

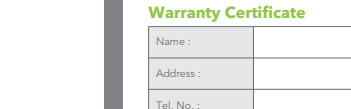

Warranty Certificate

Name :	
Address :	
Tel. No. :	
Date of purchase (dd/mm/yy) :	
Store name :	
Warranty period :	

Warranty Terms & Conditions

* All quality-related defects on items sold directly by oraimo or oraimo's authorized resellers are covered by an extensive warranty, starting from the date of purchase.

* oraimo's limited warranty is restricted to the country of purchase. The limited warranty is void on items taken outside the country they were originally bought in or shipped to directly from an authorized online purchase.

* This warranty covers only original oraimo products. It is not applicable to normal wear and tear, or any defects arising from damage caused by misuse of this product.

* Warranty is for the primary product only non transferable. Any free additional product(s) are not covered in this warranty.

* If the product fails regardless of usage in compliance with the instruction manual and other written precaution, replacement will be provided free of charge.

* To receive replacement, bring the warranty certificate and the product itself to the store from where you have purchased the product.

EN 10

For more information, please visit:

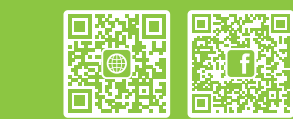

www.oraimo.com @oraimo_accessories