

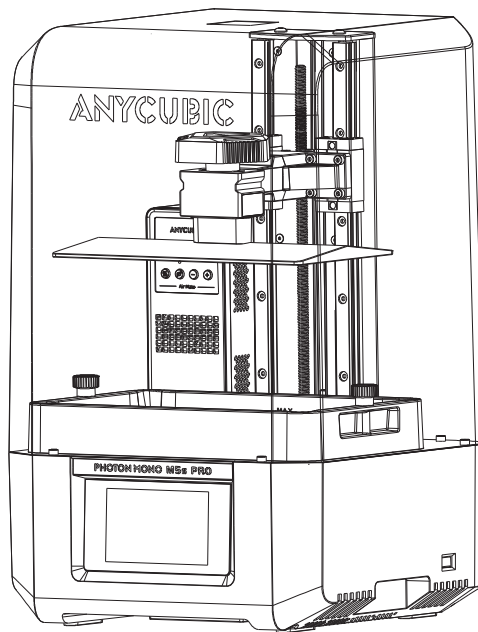

Photon Mono M5s Pro

Installation and Usage Instructions



Content

01 Introduction	1	04 Print Test	11
02 Preparations	3	05 Resin Recycling	14
Assembly	3	06 Attention	14
LCD Test	5		
Accessories Installation	5		
03 File Upload	6		
USB	6		
Cloud	7		

01 Introduction

Overview

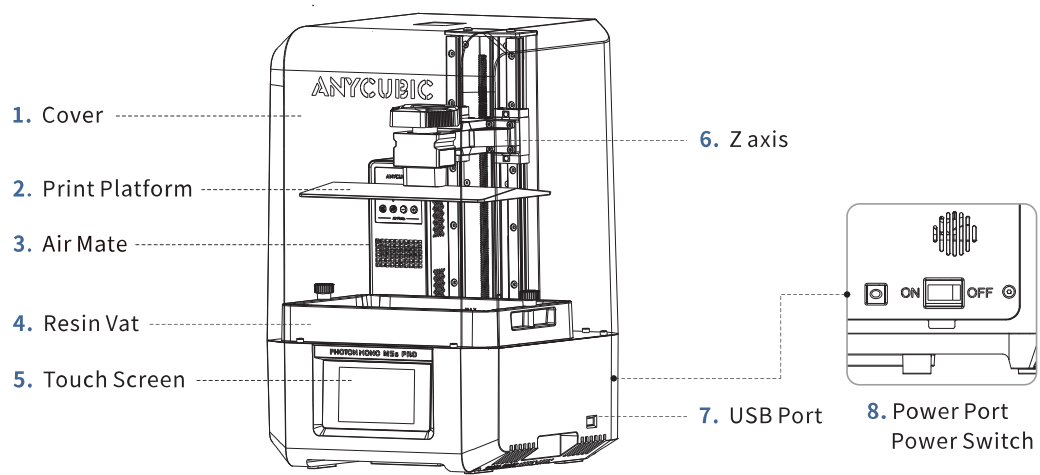

In the Box



Photon Mono
M5s Pro



Print Platform*1



Resin Vat*1



Manual*1



Screen
Protector Kit



Air Mate Kit



Protective
Equipment



Funnels*5



Scrapers*2



Hex Key Set



USB Drive*1



Power Adaptor
Power Cord

Product Parameters

Technical Specifications

LCD screen	10.1-inch 14K
Light source	Matrix LED light
XY Resolution	13320 * 5120
Leveling Method	No-Leveling Required
Touch Screen	4.3-inch Resistive Screen

Physical Dimensions

Product Dimension	290mm(L) * 270mm(W) * 460mm(H)
Build Volume	223.78 mm(L) * 126.38 mm(W) * 200 mm(H)
Weight	9.4 kg

WiFi

Frequency Range	2.4 G (2.400~2.4835 GHz)
Work Mode	AP, STA, AP+STA mode

02 Preparations

For the first use, please follow the instruction to finish the preparation including assembly, LCD test and accessories installation.

Assembly

1. Turn on the machine and wait for auto device check. Then, raise the Z axis by 100mm.

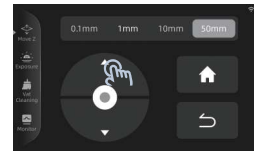
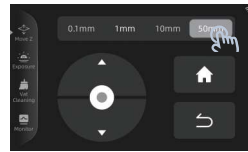
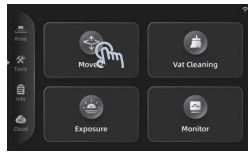

Click 2 times

2. Install the screen protector.

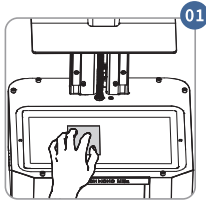

Clean the LCD screen with tool kit

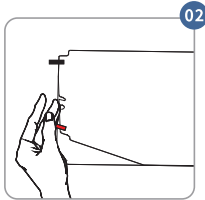

Peel off the film ①

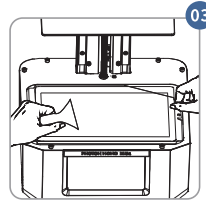

Align the positioning holes and squeeze out air bubbles

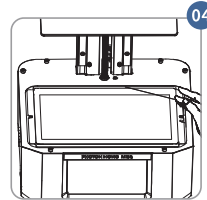

Peel off the film ②

3. Install the print platform.

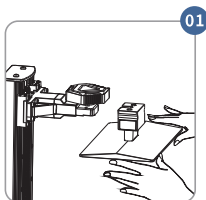

Push the platform onto the platform carrier

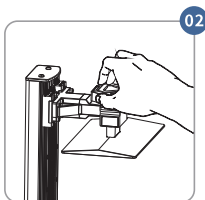

Tighten the knob

LCD Test

Choose an exposure image to test.

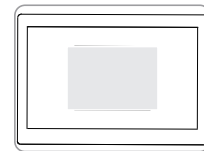
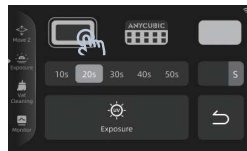
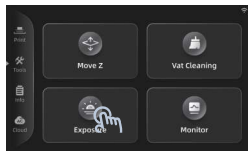

The white part is the exposure area

Accessories Installation

Install the resin vat.

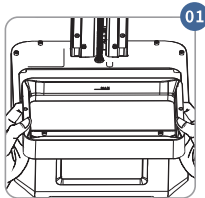

Put resin vat with its feet stuck in locating holes

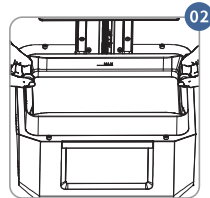

Tighten the two knobs

03 File Upload

USB

1. Use Anycubic Photon Workshop software to process the 3D model file. The installer and instructions is saved in the USB drive.
2. Slice the model. When you set the parameters in the software, there are groups of parameter which can be apply to the printing with different needs.
3. Save the sliced file to USB drive. Then, insert the USB drive to the printer.

Notice for USB drive:

- It is recommended that use the USB drive we provide. If you are using your own USB drive, please ensure that it is formatted to FAT/FAT 32 and has a memory size of less than 32G.
- To ensure proper file reading, please put print files in the root directory of USB drive.

Cloud

Please connect the printer to Anycubic App first for remote uploading and monitoring.

1. Check whether it is global server. If not, click to switch to the global server and wait for the printer restarting.

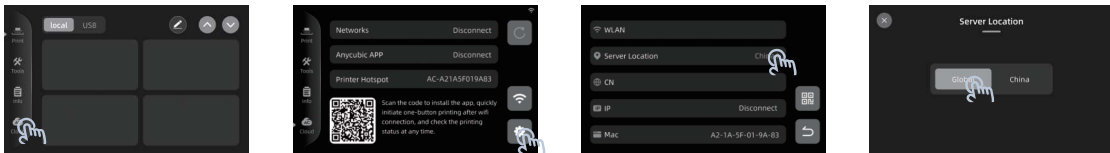

2. Reset WIFI connection.



3. Please search “Anycubic” in App Store or Goolge Play, or scan the QR code on the printer, to download Anycubic App. Then, sign up and sign in.

4. Add a printer in Anycubic App.

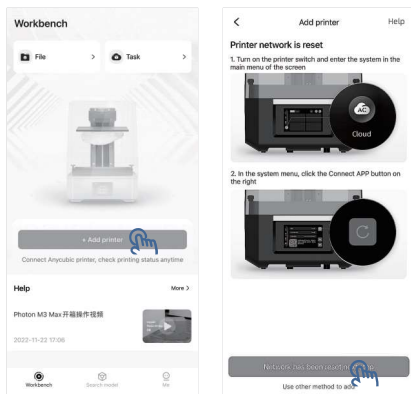

5. Connect to printer's hotspot.

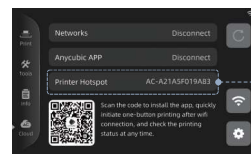
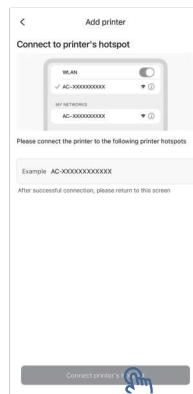

Check the printer's hotspot

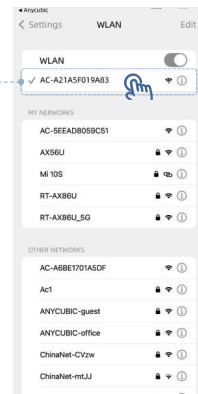

Select the printer's hotspot

6. Return to App, connect the printer to the network.

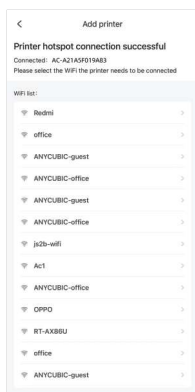

Select WIFI

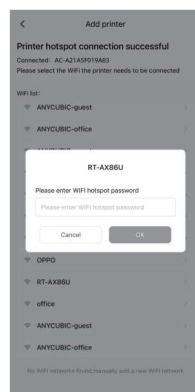

Enter in password

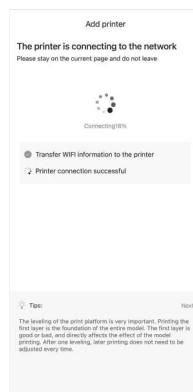

7. Printer is added successfully.

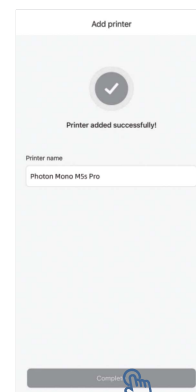

Notice: ① The location and local network must be allowed to use during connection.
② Please ensure the connection to printer's hotspot during the network connection to avoid connection failure.

8. Search model or upload the model files.

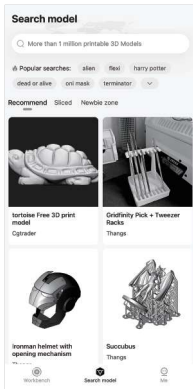

Search model

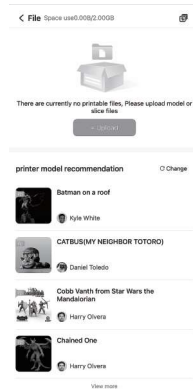
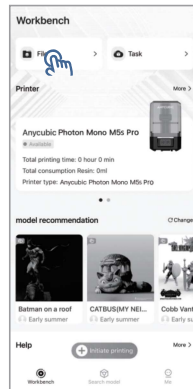

Upload the model files

04 Print Test

*The release film on the resin vat is consumable. Please pay attention to the status of release film on the touch screen and replace the film timely. It is suggested to check the release film carefully before and after every printing. If the film is broken, replace it immediately to avoid further damage to machine.

1. Make sure to wear a mask and gloves (to avoid direct skin contact with the resin), slowly pour the resin into the vat and make sure it is within the vat's maximum scale. Then, put on the cover.

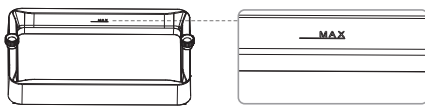

2. Print the file.

• USB drive file

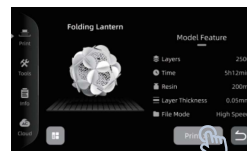
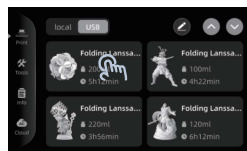
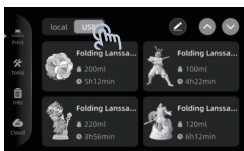

• Remote print

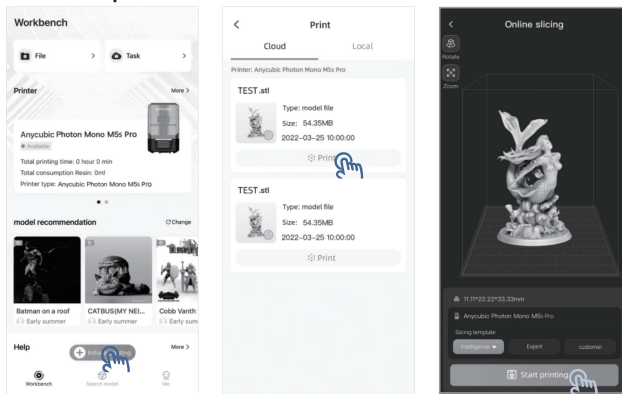

3. When the printing is finished, resin may be cured partly in the vat. Please set to Vat Cleaning and remove the residue.

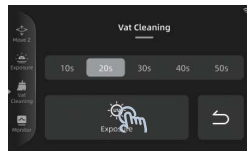

Remove resin sheet by plastic scraper

Notice:

1. If the sliced file is set as high speed mode, please print with high speed resin to avoid print failure.

2. Please level the print platform when:

- ① **print has failed with no formed object on the print platform, or only part of the model adhered to the platform;**
- ② **a new print platform is replaced;**
- ③ **3D printer or print platform has fallen.**

3. The installation and usage instructions of Air Mate are referred to Anycubic Air Mate User Manual .



Scan to watch
the video of leveling

05 Resin Recycling

After printing, there might be some cured resin left in the vat. Please clean the vat timely and filter the remaining resin by a funnel. Otherwise, it may cause damage to the release film or LCD screen. If you do not use the resin for over two days, store it in an airtight container away from light.

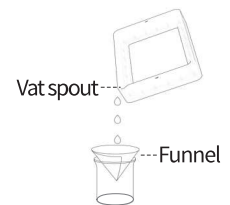

06 Attention

1. Keep Anycubic 3D printer and its accessories out of the reach of children.
2. Do not expose Anycubic 3D printer to water or rain.
3. Do not disassemble Anycubic 3D printer, please contact technical support if you have any questions.
4. In case of emergency, please immediately cut off the power of 3D printer and then contact our technical support.

Thank you for purchasing Anycubic products! For detailed user manual and software installation, please refer to user manual from the USB drive or visit www.anycubic.com and download. If you need any help, please contact technical support at support.anycubic.com/en.

Radio Interference

WARNING: This device complies with Part 15 of the FCC Rules. Operation is subject to the following two conditions: (1) This device may not cause harmful interference, and (2) this device must accept any interference received, including interference that may cause undesired operation.

CAUTION: Changes or modifications not expressly approved by the party responsible for compliance could void the user's authority to operate the equipment.

NOTE: This equipment has been tested and found to comply with the limits for a Class B digital device, pursuant to Part 15 of the FCC Rules. These limits are designed to provide reasonable protection against harmful interference in a residential installation. This equipment generates, uses, and can radiate radio frequency energy. If not installed and used in accordance with the instructions, it may cause harmful interference to radio communications. However, there is no guarantee that interference will not occur in a particular installation. If this equipment does cause harmful interference to radio or television reception, which can be determined by turning the equipment off and on, the user is encouraged to try to correct the interference by one more of the following measures:

- Reorient or relocate the receiving antenna.
- Increase the distance between the equipment and receiver.
- Connect the equipment to an outlet on a circuit different from that to which the receiver is connected.
- Consult the dealer or an experienced radio/TV technician for help.

To maintain compliance with FCC's RF Exposure guidelines, This equipment should be installed and operated with minimum distance between 20cm the radiator your body: Use only the supplied antenna.



Name: APEX CE SPECIALISTS LIMITED
Add: 89 Princess Street, Manchester, M1 4HT, UK
Contact: Wells
Tel: + 441616371080
E-mail: info@apex-ce.com



Name: Apex CE Specialists GmbH
Add: Habichtweg 1 41468 Neuss Germany
Contact: Wells Yan
Tel: +353212066339
E-mail: info@apex-ce.com

FC CE RoHS



M02030354