

H100mm

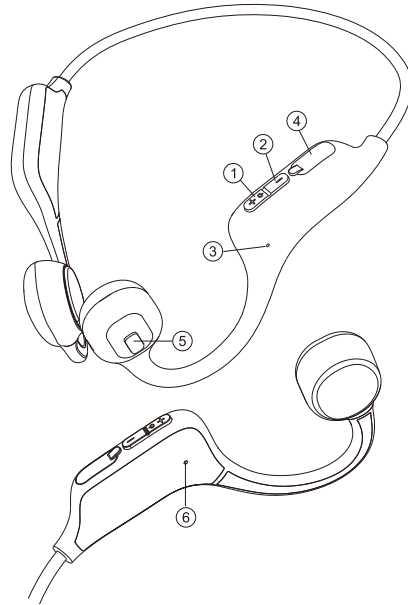

## Manual instruction for Bone Conduction Headphones

### Summary of button functions



1. Power On/Off; Volume up
2. Volume Down
3. Microphone
4. Charging Port
5. Multifunction Button: Pause/Play/Answer Phone; Call/End Phone, Next/Previous Track; Voice Assistant.
6. LED Indicator

### Controls

Power On	When the headphones is in power-off state, press and hold power button for 3 seconds with blue LED flickering, reminding tone; power on.
Power Off	When the headphone is in power-on state, press and hold on button for 5 seconds with red LED flickering once, reminding tone: power off.
Connect Bluetooth	When the Headphone is in power-off state, press and hold it for 3 seconds to enter a pairing state with red and blue LEDs flickering and phone, tablet computer, etc) dis covers "DG08 Pro" press it to connect.
Connected successfully	When the headphone is successfully linked to the device, blue LED will flicker every 3 seconds with reminding tone: Connected.
Pause / Play	When the music is on, single click the multi-function button to pause or play.

Answer / Hang up	Click multi-function button to answer when there is an incoming call. Click the multi-function button to end the on-going call.
Vol +	Press the Vol+ once to turn up the volume.
Vol -	Press the Vol- once to turn down the volume.
Next Track	Double click the multi function button skip to next track.
Previous Track	Triple click the multi-function button skip to previous track.
Assistant	Long press the multi-function button for 2 seconds to enter Voice Assistants model. Long press 2 seconds again to exit the Voice Assistants model.
Reset	After plugging the USB charging line, the headphone will be reset and powered off for charging.
Clear all pairing info	Long press the Power On/Off button and Volume down button for 5 seconds simultaneously.
Charging	In case of using USB charging line for charging, connect the headphone with the USB power. During the Charging, LED turns red. After Charging, the LED turns blue.

L70mm

### How to wear



Hang the Headphone behind your neck with both speakers clinging to your cheekbones. After that, adjust it until you feel comfortable.

#### Note:

1. Due to different drivers, the sound quality of bone conduction headphones cannot be compared to headphones with speakers.
2. Open headphones cannot block external noise, which can cause users to feel that the volume is lower than the actual volume, or there may be sound leakage issues when increasing the volume.

### Specifications

Music play time ..... 6 Hours@70% Volume  
 Battery capacity ..... 200mAh  
 Standby time ..... 100 Hours  
 Charging time ..... 2 Hours  
 Bluetooth Version ..... 5.3  
 Speaker impedance ..... 8Ω  
 Microphones sensitivity ..... 38±3db  
 Connection distance ..... Bluetooth 10 Meters

### Attentions

1. Please wear the bone conduction speakers of the headphone at your cheekbones before your ears and don not put them in your ears.
2. Listening to music for an excessively long time may make you feel uncomfortable. Please try to use a medium volume instead of a high one.
3. No matter how the volume is, please do not make it prevent you from hearing the surrounding sounds.
4. Do not throw, press the headphone or put it in the water.
5. The headphone should keep away from fire, water and high voltage devices.
6. It is not for children's use as it contains small parts.
7. It's equipped with a lithium battery; please dispose of it in accordance with local policies.

**A** If there is any injury or property loss due to violation of the above contents, we will not bear any responsibility.

**Please keep the charging port clean before charging. Wipe dirt and sweat from the charging port when not used.**

### FCC Statement

This equipment has been tested and found to comply with the limits for a Class B digital device, pursuant to part 15 of the FCC Rules. These limits are designed to provide reasonable protection against harmful interference in a residential installation. This equipment generates, uses and can radiate radio frequency energy and, if not installed and used in accordance with the instructions, may cause harmful interference to radio communications. However, there is no guarantee that interference will not occur in a particular installation. If this equipment does cause harmful interference to radio or television reception, which can be determined by turning the equipment off and on, the user is encouraged to try to correct the interference by one or more of the following measures:

- Reorient or relocate the receiving antenna.
- Increase the separation between the equipment and receiver.
- Connect the equipment into an outlet on a circuit different from that to which the receiver is connected.
- Consult the dealer or an experienced radio/TV technician for help.

### FCC Statement

**Caution: Any changes or modifications to this device not explicitly approved by manufacturer could void your authority to operate this equipment.**

This device complies with part 15 of the FCC Rules. Operation is subject to the following two conditions:

1. This device may not cause harmful interference, and
2. This device must accept any interference received, including interference that may cause undesired operation.

#### RF Exposure Information

The device has been evaluated to meet general RF exposure requirement.

The device can be used in portable exposure condition without restriction