

Air Purifier
(ACY2WH)

User Manual



Content

• <i>Safety</i>	3-4
• <i>Safety precaution</i>	5
• <i>Unit and components</i>	6-7
• <i>Getting started</i>	8
• <i>Product structure</i>	10-12
• <i>Buttons</i>	13
• <i>Air quality information</i>	15
• <i>Product Specifications</i>	16
• <i>Maintenance and cleaning</i>	17-19
• <i>Troubleshooting</i>	19
• <i>After Sales Service</i>	20
• <i>After Sales Warranty</i>	20

Air Purifier

(ACY2WH)



Safety

BEFORE USING THIS DEVICE, READ ALL INSTRUCTIONS AND CAUTIONARY MARKINGS IN THIS MANUAL AND ON THE APPLIANCE

- Ensure that the device is fully assembled in line with the instructions before use. Do not dismantle the device.
- Use **ONLY** as described in this manual.
- Suitable for dry locations **ONLY**. Do not use the device outdoors or on wet surfaces and do not expose to water or rain.
- Do not operate any appliance with a damaged cable or plug.
- If the device is not working as it should, has received a sharp blow, has been dropped, damaged, left outdoors, or dropped into water, do not use and contact Air Lab Global Limited.
- Do not use any cleaning agents or lubricants on this device. Unplug before cleaning or carrying out any maintenance.
- Do not stretch the cable or place the cable under strain. Keep cable away from heated surfaces.
- Do not route the cable under furniture or appliances. Do not cover cable with throw rugs, runners or similar coverings. Arrange cable away from traffic area and where it will not be tripped over.
- This device can be used by children aged from 8 years and above and persons with reduced physical, sensory or reasoning capabilities, or lack of experience and knowledge, **ONLY** if they have been given supervision or instruction by a responsible person concerning use of the device in a safe way and understand the hazards involved. Cleaning and maintenance should not be performed by children without supervision.

Safety Precautions

- Do not carry out any maintenance or repair work other than that shown in this manual, or advised by Air Lab Global Limited, its service agent or a similarly qualified person in order to avoid a hazard.
- Do not use the device as a toy. Close attention is necessary when used by or near children. Children should be supervised to ensure that they do not play with the device.
- Do not put any object into the air inlet or the outlet. Do not use with any air inlet or outlet blocked.
- Do not use near furnaces, fireplaces, stoves or other high temperature heat sources.
- Do not use in conjunction with or directly next to an air freshener or similar products. Do not spray or apply perfumes directly on or near the filter. Keep essential oils and chemicals away from the device.
- Always disconnect the plug from the socket before inspecting for problems. If the device will not operate, first check the mains socket has an electricity supply and that the plug is properly inserted into the socket.
- When removing or replacing the filter, make sure to keep your fingers clear.

Unit and components

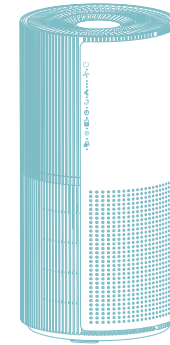

1. Unit Body

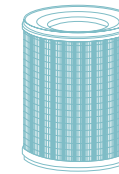

2. Cylinder Air Filter

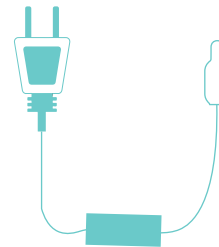

3. Power Adapter

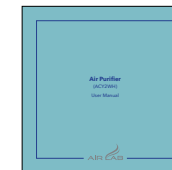

4. User Manual

Getting started

Step 1

Unpack the package and take out the device.

Step 2

Flip the device, rotate the bottom cover in an anticlockwise direction to unlock.

Step 3

Take out the filter with packaging, then remove the filter from the packaging.

Step 4

Put back the filter without packaging.

Step 5

Close the bottom cover and rotate clockwise towards the lock direction.

Step 6

Plug in the power adapter line to the device.

Step 7

Plug the power adapter into the socket.

Step 8

Press the on/off key to run the device.

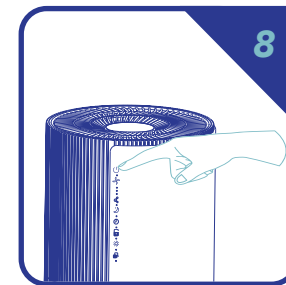
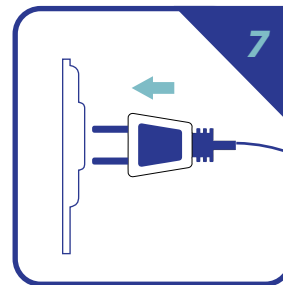
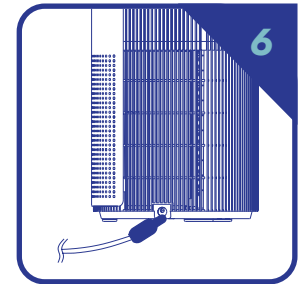
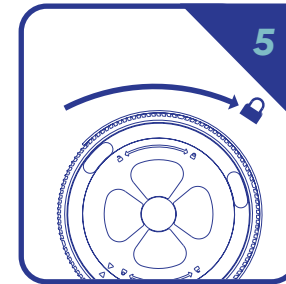
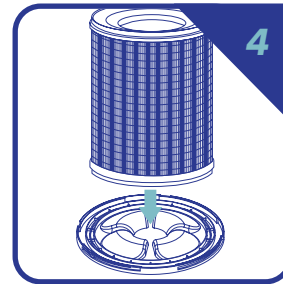
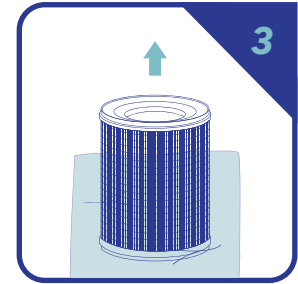
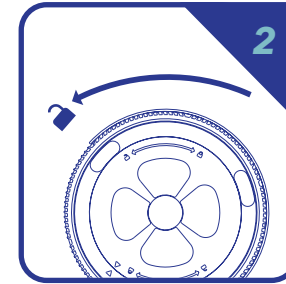
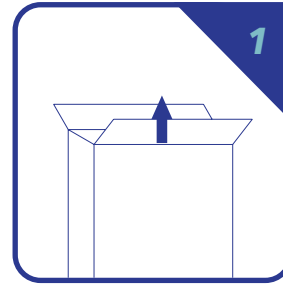

Product Structure

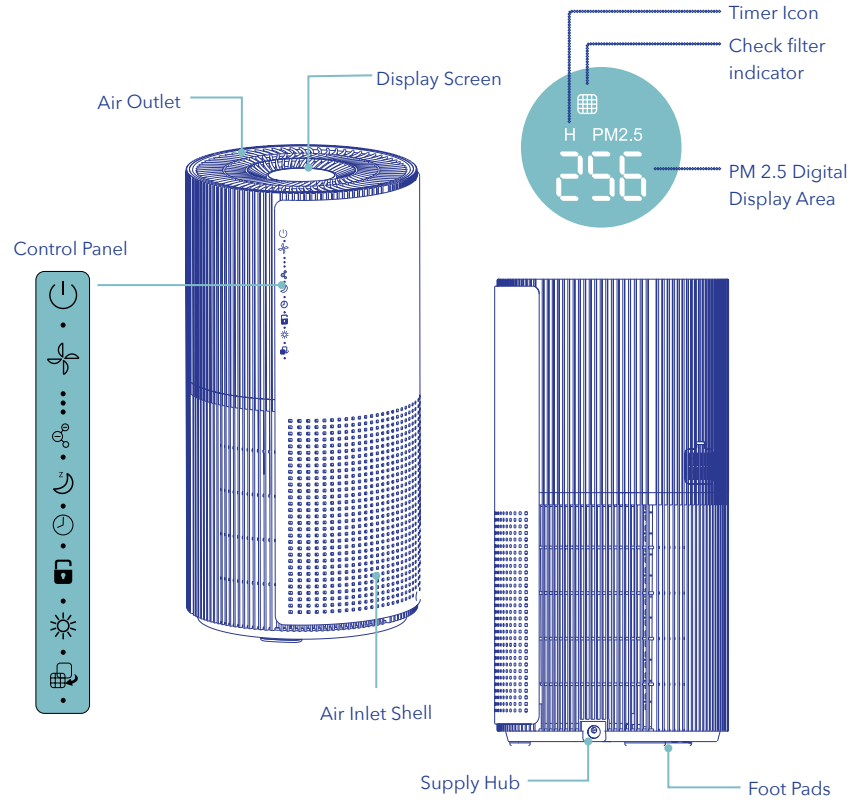

Buttons



Press to turn On or Off

Turn on / off the air purifier by pressing the On/Off button on the control panel.



Airflow speed

Press to switch between the different airflow speeds.



Available airflow speed options are: 1, 2, 3 and 0. Auto mode is set as 0. Adjust the airflow using the buttons on the control panel.



Negative ion purification

Press to Activate or Deactivate.

Activate the negative ion purification function by pressing the button on the control panel.



Sleep mode

Press to Activate or Deactivate.

Activate sleep mode by pressing sleep button which will turn off the screen display and the PM2.5 status indicator with ultra-low speed of the fan. Press any button to deactivate sleep mode.



Timer

Press to Activate or Deactivate.

Activate the timer function by pressing the button on the control panel (1 press = 1 hour). The timer starts from 1 - 12 hours, the power will be turned off when the count down is finished.



Child lock

Press to Activate or Deactivate.

Activate the child lock function by pressing the button on the control panel, the machine will lock itself causing other buttons cannot be used, until 5 seconds of long pressing the button to unlock the child lock.



UVC Disinfection light

Press to Activate or Deactivate.

Activate the UVC Disinfection light function by pressing the button on the control panel.



Check filter indicator

Press and hold the button for 5 seconds to reset the timer.

When the accumulated usage time of the filter reaches 2000 hours, the check filter indicator will be flashing.

Note: The check filter indicator only indicates the end of a 2000 hours period. As suggested, the average lifespan of a filter is 2000 hours. However, the filter's life span could be extended due to low indoor air pollution.

Air quality information

The air quality level for PM 2.5 particles is indicated using a color scale on the display on top of the device.

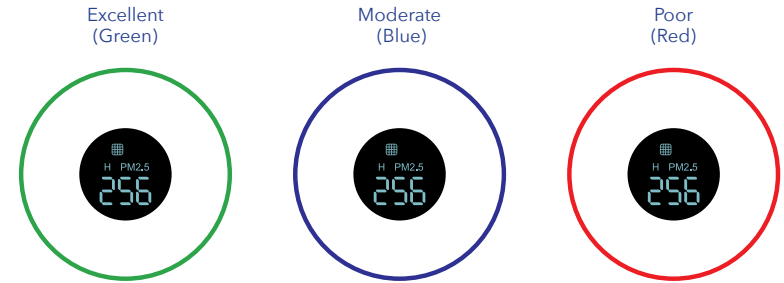

<i>PM 2.5 Index</i>	<i>Air Quality</i>	<i>Fan Speed</i>
10-79	Excellent	1
80-299	Moderate	2
300-500	Poor	3



Product Specifications

Types	Specifications
Product Name	Air Purifier
Voltage	DC 24V
Power	40W
Particulate CADR	355m ³ /h
Max. Area	20-45m ²
Product Dimension	ø270 x 532 mm
Net Weight	4.7kg
Gross Weight	6.37kg
Sensor Type	PM2.5
Max. Noise	≤58dB

Maintenance & Cleaning

- Use ONLY dry and soft cloth to clean the surface of the device including air inlets and outlets.
- Clean the sensor regularly with cotton buds, to maintain sensor accuracy and ensure the continuing high performance of the device.

Cautions:

- Ensure the device is unplugged.
- Do not use detergents or polishes to clean the device.
- Never immerse the device or accessories in water or any other liquid.

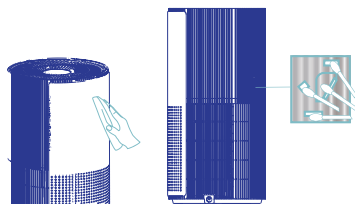

Filter Replacement:

- After 2000 hours usage of the filter, the check filter indicator light will be flashing. Take out the filter and check its color. If part of the filter turns dark grey or black, the filter should be replaced. If the filter is still white or light grey in color which means the filter can be used further, press and hold the check filter indicator button for 5 seconds to reset the filter timer.
- When replacing the filter, please make sure the device is not connected to power, rotate anticlockwise towards unlock direction and open the bottom cover, take out the filter.
- Removing the packaging from the filter, put it into the device.
- Rotate clockwise to lock the bottom cover and place the device on a stable area after that.
- Insert the adapter into the socket. After the device is powered on, press the power button to turn on the device. Press and hold the timer button for 5 seconds to reset check filter timer.

Note: The used air filter contains contaminants collected from the air. Do not touch the filter cotton directly or smell the filter.

Troubleshooting

Trouble	Situation	Treatment
The device does not work.	The power cable is not connected to the power supply.	Connect the power cable to the power supply.
	The adapter is not connected properly.	Please make sure the adapter AC plug properly connected to the outlet. Please ensure that the adapter DC plug is properly connected to the product host.
Air outlet volume is significantly weaker than when purchased.	The air inlet is covered.	Please remove the object covering the air inlet.
	The air inlet has residual dirt.	Please clean the surface of air inlet.
	The filter is covered.	Please remove the object covering the filter.
	The filter has residual dirt.	Please clean the filter. If there is no obvious improvement, please replace the filter.
The air volume at the air outlets is significantly enhanced compared to when purchased	The filter is installed incorrectly.	Please install the filter correctly.
	The filter is damaged.	Please replace it with a new one.

Troubleshooting

Trouble	Situation	Treatment
After the device has been running for a period of time, there is no significant improvement in air quality. The air quality display remains the same.	The filter is installed incorrectly.	Please install the filter correctly.
	The filter is damaged.	Please replace it with a new one.
	The filter has residual dirt.	Please clean the filter. If there is no obvious improvement, please replace the filter.
	Residual dirt stays on the PM2.5 sensor.	Please clean the PM2.5 sensor.
Product operation noise is too loud.	The air inlet is covered.	Please remove the objects covering the air inlet.
	There is object within the air outlet.	Please clean the air outlet.

After sales service

1. Free one-year warranty.
2. After the free warranty, you can contact the company to provide maintenance services.
3. The following conditions are not covered by the warranty:
 - a. Damage due to man-made factors
 - b. Damage due to unauthorized disassembly or repair
 - c. Normal wear and tear after usage
 - d. Filter (unless the filter is damaged before using)
 - e. Damage due to improper installation and usage

Note: In order to protect your rights, please pay attention to the following information.

1. Please register your purchase online with a complete, correct and authentic information within 30 days after purchase to get a one-year free warranty.
2. Keep the purchase receipt or record.
3. Terms and details for the warranty are listed on the online registration page.

After sales warranty

Please visit <https://airlab-tech.com/> within 30 days after purchase to register your product to get a one-year warranty.

1. Warranty terms

- a. From the date of purchase, the warranty period is 1 year, during which maintenance service is free of charge (except for force majeure events, external factors).
- b. The complimentary gift (if any) is not covered by the warranty.
- c. Purchase receipt, shopping records issued by the company, and receipt are all acceptable.

2. Spare parts

Spare parts are provided free of charge during the warranty and charged according to the market prices at the time after the warranty. The filter is not considered as a spare part. Free warranty is not applicable to filter unless it is damaged.

空氣淨化機
(ACY2WH)
使用說明書



Content

• 安全	24–26
• 單元和組件	27
• 使用入門	28–29
• 產品結構	30
• 按鈕	32–34
• 空氣質量資訊	35
• 產品規格	37
• 保養與清潔	38
• 常見問題	39–40
• 售後服務	41
• 保養服務	42



空氣淨化機

(ACY2WH)



安全

使用此設備前，請仔細閱讀說明書上的指引及安全措施。

- 請按照指示組裝機器，切勿拆除機身。
- 請遵從此說明書的指示並使用。
- 此設備只適在乾的地方使用。不能在戶外或潮濕環境使用，避免接觸水及雨水。
- 如電線或插頭損壞，便不能使用。
- 如果設備受到猛烈撞擊及損壞、放置室外或掉入水中，請勿使用設備，並聯絡 Air Lab Global Limited。
- 請勿在本設備上使用任何清潔劑或潤滑劑。在清潔或進行任何維修之前，請拔掉插頭。
- 請勿拉伸電線或將電線處於張力之下。將電線遠離熱高溫地方和明火。
- 請勿將電線放在家具或電器下方。不要用地氈，或類似的覆蓋物遮蓋電線。切勿將電線放在人常流動的地方，以免被絆倒。
- 本設備不適合身體、感官或思維能力低下或者缺乏使用經驗和相關知識的人員(包括八歲或以下的兒童)使用，或進行清潔及維修的工作，除非有負責其安全的人員監督或指導其使用本設備。

安全措施：

- 請遵循本使用說明書的指示進行清潔及維修，或經Air Lab Global Limited、代理公司或經銷商的維修中心或資深人仕，進行維護及維修的工作，以避免發生危險。
- 切勿將本設備當作玩具。在兒童附近使用時，需要有適當人仕監管及密切注意，確保兒童不會以此設備來玩樂。
- 請勿將任何物品放入進風口或出風口。當有阻塞物在出風口和進風口時，切勿使用本設備。
- 請勿在高溫地方或明火附近使用。
- 切勿與空氣清新劑或類似產品一起使用，或在旁使用。請勿直接在設備上或附近噴上或塗上香水。請將精油和化學品遠離設備。
- 在檢查問題之前，必須將插頭拔取。如果設備無法運行，首先檢查是否有電源提供，或插頭是否正確地插入電源插座。
- 在更換或取出濾芯的時候，請注意手指安全，不要被弄傷。

單元和組件

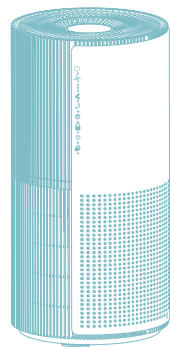

1. 機器主體

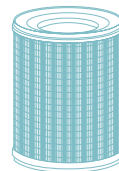

2. 空氣濾芯

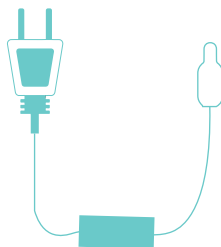

3. 電源適配器

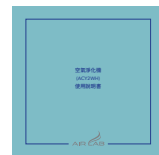

4. 使用說明書

使用入門

步驟1

打開包裝，取出設備。

步驟2

翻倒設備，以逆時針方向旋轉底蓋以解鎖。

步驟3

取出帶包裝的濾芯，然後從包裝中取出濾芯。

步驟4

放入無包裝的濾芯。

步驟5

合上底蓋，然後朝順時針方向旋轉底蓋及鎖定。

步驟6

將電源適配器線插入設備。

步驟7

將電源適配器插入電源插座。

步驟8

按開/關鍵運行設備。

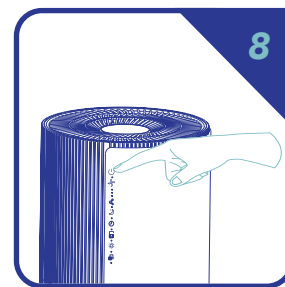
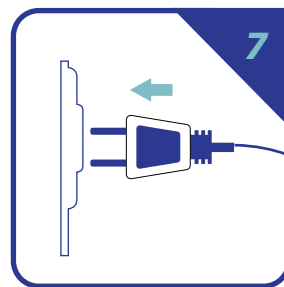
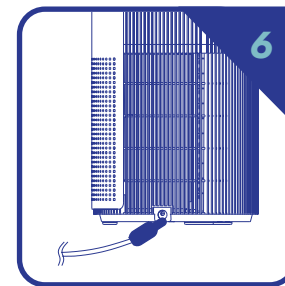
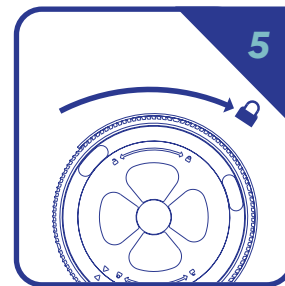
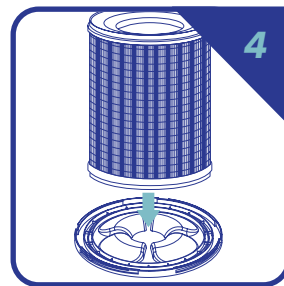
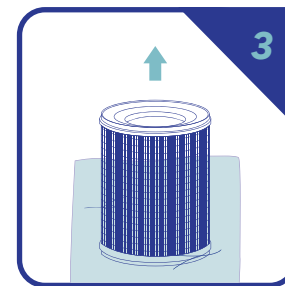
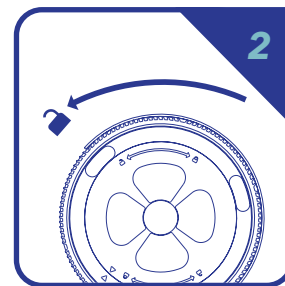
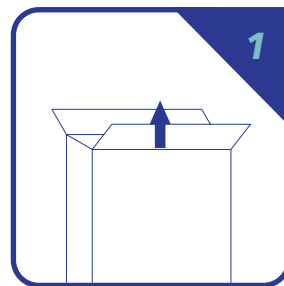

產品結構

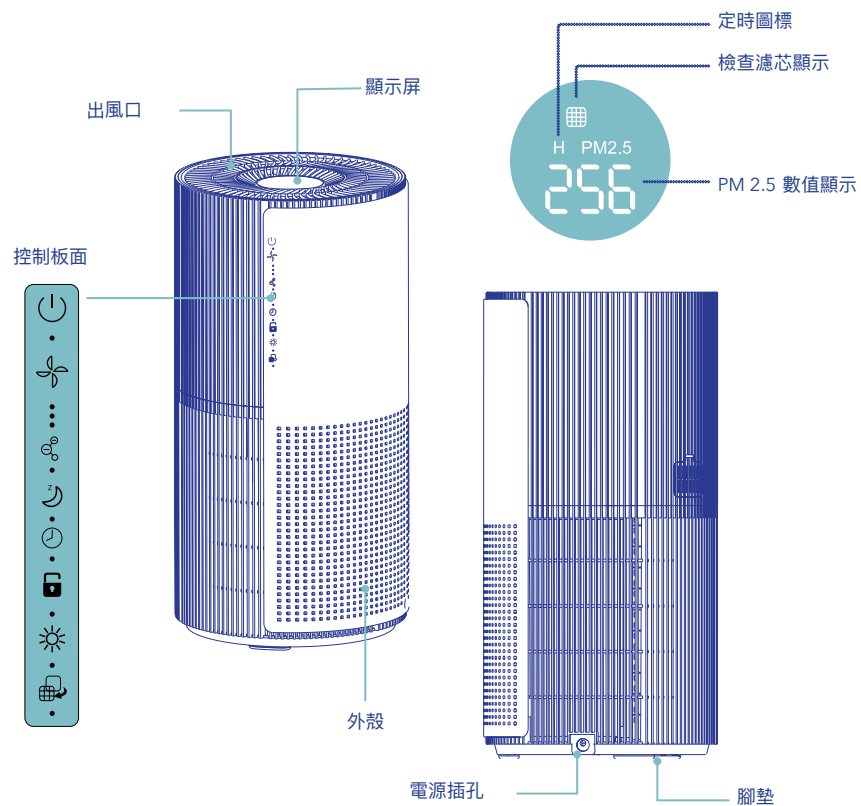

按鈕



開/關

按下以開啟或關閉。

• 按下控制面板上的開/關按鈕開啟或關閉空氣淨化機。



風速調節

按下切換不同風速。

• 可用的風速選項為：1、2、3和0。預設自動感應風速為0。使用控制面板上的按鈕調整風速。



負離子淨化

按下以啟動或停用。

• 使用控制面板上的按鈕啟動負離子淨化功能。



睡眠模式

按下以啟動或停用。

• 使用控制面板上的按鈕啟動睡眠模式功能。睡眠模式將關閉屏幕顯示和PM2.5狀態指示燈，並以超低風速進行。如要解除睡眠模式，可輕觸任何按鈕。



時間制

按下以啟動或停用。

• 按下控制面板上的按鈕（每按一下= 1小時）啟動時間制。計時器從1到12個小時開始計時，倒數完畢後，電源便會自動關閉。



兒童鎖

按下以啟動或停用。

• 使用控制面板上的按鈕啟動兒童鎖功能。通過使用兒童鎖，機器將自行鎖定，並無法使用其他按鈕，直到長按按鈕5秒來解除兒童鎖。



UVC消毒燈

按下以啟動或停用。

• 此設備上提供UVC消毒燈。使用控制面板上的按鈕開啓UVC消毒燈。



檢查濾芯

提示檢查濾芯功能。

當濾芯使用達2000小時，檢查濾芯顯示燈便會閃亮，提示要檢查濾芯。只要長按5秒，便能重新啓動檢查濾芯計時器。

注意：濾芯更換提示只是提醒濾芯已使用2000小時。一般情況下濾芯可使用2000小時，但如果空氣質素較好，濾芯的使用時數可以為2000小時以上。

空氣質量資訊

設備頂部顯示屏上的顏色，是用來指示PM2.5微米顆粒物的空氣質量水平。

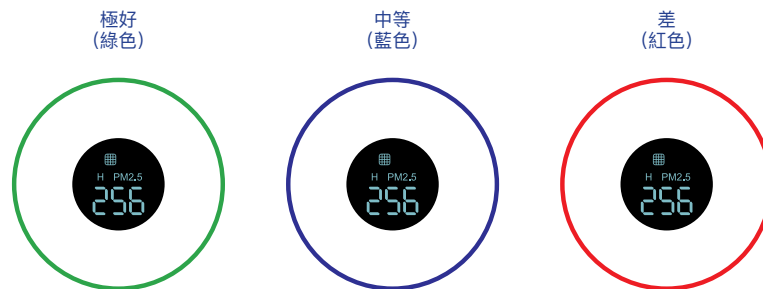

PM2.5指數	空氣質量	風速
10-79	極好	1
80-299	中等	2
300-500	差	3



產品規格

描述	規格
產品名稱	Air Purifier
電壓	DC 24V
耗電量	40W
換氣量	355m ³ /h
最大使用面積	20-45m ²
產品呎吋	ø270 x 532 mm
淨重量	4.7kg
重量	6.37kg
傳感器	PM2.5
最大聲量	≤58dB

保養與清潔

- 請以乾布拭拭機身表面，包括進風口及出風口。
- 定期以棉花棒清潔傳感器表面，以確保傳感器準確性及提供最準確的風速來淨化空氣。

注意事項：

- 清潔前，請務必先拔取適配器插頭並截斷電源。
- 切勿使用具磨性、腐蝕性或易燃性清潔劑（例如漂白劑或酒精）清潔產品的任何部分。
- 切勿將產品和配件浸入水中或任何其他液體中。

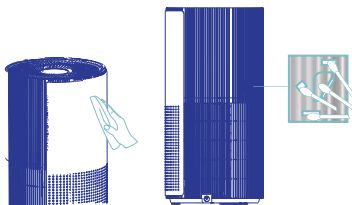

濾網更換：

- 當濾芯使用了2000個小時，檢查濾芯顯示燈便閃亮起來。取出濾芯，並檢查其顏色。當部份濾芯變成深灰色或黑色，濾芯便需要更換。但如果濾芯還是雪白色或淺灰色，濾芯便能繼續使用，請長按檢查濾芯按鈕5秒來重置濾芯計時器。
- 當確認需要更換濾芯，請關閉淨化機，以逆時針方向擰開機身底蓋及打開。取出濾芯，並檢查濾芯顏色，如有變更，便要更換。
- 將濾芯的所有包裝材料移取，然後將取出的濾芯放回機身中。
- 以順時針方向鎖緊機身底蓋，並將淨化機放在穩定的地方上。
- 將適配器插入電源插座。打開電源後，請點擊開關按鈕，以使淨化機正常工作。觸摸計時器按鈕5秒，重置檢查濾芯計時器。

注意：用過的濾芯包含從空氣中收集的污染物。請勿直接觸摸過濾棉或近距離吸聞其味道。

常見問題

常見問題	原因	行動
設備無法開機	電源線未連接到電源。	請確保適配器AC插頭正確連接到電源插座。
	適配器沒有正確連接。	請確保將適配器DC插頭正確連接到產品主機。
出風口沒有排氣。 出風口的風量明顯弱於購買時的風量。	進風口被遮蓋。	請移除覆蓋進風口的物品。
	進風口有殘留污垢。	請清潔進風口。
	濾芯被覆蓋。	請移除覆蓋濾芯的物體。
	濾芯有殘留污垢。	請清潔濾芯。如果沒有明顯的改善，請更換濾芯。
與購買相比，出風口處的風量顯著提高。	濾芯安裝不正確。	請正確安裝濾芯。
	濾芯損壞。	請更換一個新的濾芯。

常見問題	原因	行動
產品運行一段時間後，空氣質量沒有明顯改善。	濾芯沒有正確安裝。	請正確安裝濾芯。
	濾芯損壞。	請更換一個新的濾芯。
	濾芯有殘留污垢。	請清潔濾芯。如果沒有明顯的改善，請更換濾芯。
	PM2.5傳感器進風口和出風口有殘留污物。	請清潔PM2.5傳感器的進風口和出風口。
產品運行噪音過大。	進風口是否被遮蓋。	請移除覆蓋進風口的物品。
	出風口有異物殘留。	請清潔出風口。

售後服務

1. 一年免費保養。
2. 免費保養後，您可以聯繫公司以提供維護服務。
3. 以下條件不在保養範圍內：
 - a. 因為人為疏忽造成
 - b. 未經授權擅自拆卸或修理而造成的損壞
 - c. 正常的使用後磨損
 - d. 濾芯（除非濾芯在使用前已損壞）
 - e. 由於不正確的安裝和使用而造成的損壞

注意：為了保護您的權利，請注意以下信息。

1. 請在購買後30天內在線上註冊您的購買信息，並提供完整正確和真實的信息，以獲得一年的免費保養。
2. 保留購買收據或記錄。
3. 在線上註冊頁面上列出了保養條款和詳細信息。

保養服務

請在購買後30天內登錄<https://airlab-tech.com/>，以註冊您的產品以獲得一年保養。

1. 保養條款

- a. 從購買之日起，保養期為1年，在此期間內免費提供維修服務（不可抗力事件和外部因素除外）。
- b. 贈送禮品（如果有）並不在保養範圍內。
- c. 購買收據，公司簽發的購物記錄和收據都是可以接受的。

2. 配件

配件保養期間可免費提供維修。保養期後，便要按市場價格收費。濾芯不被視為配件，除非損壞，否則免費保養不適用於濾芯。



<https://airlab-tech.com/>

香港新界荃灣柴灣角街66-82號金熊工業中心11樓H室

11H, Golden Bear Industrial Building, 66-82 Chai Wan Kok Street,
Tsuen Wan, NT, Hong Kong

FCC Warning

This device complies with part 15 of the FCC Rules. Operation is subject to the following two conditions: (1) This device may not cause harmful interference, and (2) this device must accept any interference received, including interference that may cause undesired operation.

Any Changes or modifications not expressly approved by the party responsible for compliance could void the user's authority to operate the equipment.

Note: This equipment has been tested and found to comply with the limits for a Class B digital device, pursuant to part 15 of the FCC Rules. These limits are designed to provide reasonable protection against harmful interference in a residential installation. This equipment generates uses and can radiate radio frequency energy and, if not installed and used in accordance with the instructions, may cause harmful interference to radio communications. However, there is no guarantee that interference will not occur in a particular installation. If this equipment does cause harmful interference to radio or television reception, which can be determined by turning the equipment off and on, the user is encouraged to try to correct the interference by one or more of the following measures:

- Reorient or relocate the receiving antenna.
- Increase the separation between the equipment and receiver.
- Connect the equipment into an outlet on a circuit different from that to which the receiver is connected.
- Consult the dealer or an experienced radio/TV technician for help.

This equipment complies with FCC radiation exposure limits set forth for an uncontrolled environment. This equipment should be installed and operated with minimum distance 20cm between the radiator & your body.