

15W 无线充电器 使用说明书



图1

规格参数

产品名称: 无线充电器
输入参数: 5V-2A, 9V-2A, 12V-2A
输出功率: 15W/10W/7.5W/5W
转换效率: $\geq 80\%$ (Max)
充电距离: $\leq 7\text{mm}$
工作温度: 0-45°C
执行标准: Qi
注: 以上参数均来自产品实测, 实际参数会因手机和使用环境等因素而有差异。

常见故障排除

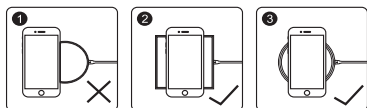
充电慢/发热

1. 检查手机与是否有对准位置 (参考图1)
2. 检查适配是否支持QC3.0快充协议
3. 检查手机是否支持Qi的无线快充协议
4. 检查手机的温度是否高于35°C以上

无法正常充电

1. 检查手机与无线充电器之间是否有金属异物包括金属材质的手机壳和金属指环扣等
2. 检查手机壳的厚度是否超过了3mm

注意事项

1. 请使用支持QC3.0的快充适配器配套使用。
2. 勿将本产品放入火中, 水中或给儿童玩耍。
3. 请不要自行拆机, 否则厂家不承担任何责任。
4. 勿用湿抹布或其它清洁液体清洗本产品。

指示灯说明

1. 通电待机: 红绿灯交替闪烁3秒后熄灭
2. 正常充电: 绿灯持续闪烁
3. 充满状态: 绿灯常亮
4. 异物保护: 红灯以1Hz的频率闪烁



15W Wireless Charger User Manual

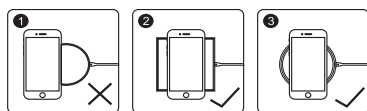

Picture 1

Product Specification

Input: 5V-2A, 9V-2A, 12V-2A
Output: 15W/10W/7.5W/5W
Efficiency: $\geq 80\%$ (Max)
Transmission Distance: $\leq 7\text{mm}$
Operating Temperature: 0-45°C
Standard: Qi

Note: The above parameters are collected from the real result of testing phones, the actual parameters will be different due to factors such as the phone and the usage environment.

RFQ

Charging Slowly / Being Hot

1. Please kindly check whether the phone puts the right charging zone (Picture 1)
2. Please kindly check whether the adapter supports QC3.0;
3. Please kindly check whether the phone supports Qi;
4. Please kindly check whether the temperature of the phone is beyond 35°C

Cannot work normally

1. Please kindly check whether there are some metal substance during the phone and this charger, for example, the metal phone case or the metal ring;
2. Please kindly check whether the phone case is beyond 3mm

Attention:

1. Please use QC3.0 adapters;
2. Please keep the charger away from fire water; Children can not play it as the tool;
3. Please do not disassemble it, or the factory is not responsible for the result;
4. Please clean this charger by dry soft cloth; not wet cloth or chemical

Using Guide:

1. Power On: the light turns off after Red and green alternately flashing for 3S;
2. Charging: Green light flashes
3. Charged Fully: Green Light keeps on
4. FOD Protection: RED light flashes



FCC Warning

This device complies with Part 18 of the FCC Rules.

IC WARNING

This device contains licence-exempt transmitter(s) that comply with Innovation, Science and Economic Development Canada's licence-exempt RSS(s). Operation is subject to the following two conditions:

- (1) This device may not cause interference.
- (2) This device must accept any interference, including interference that may cause undesired operation of the device.

L'émetteur/récepteur exempt de licence contenu dans le présent appareil est conforme aux CNR d'Innovation, Sciences et Développement économique Canada applicables aux appareils radio exempts de licence. L'exploitation est autorisée aux deux conditions suivantes:

1. L'appareil ne doit pas produire de brouillage;
2. L'appareil doit accepter tout brouillage radioélectrique subi, même si le brouillage est susceptible d'en compromettre le fonctionnement.

Refer to Part 18.213(c) and KDB 784748 Annex A section A.5:

- (a) Max. Electric Field Emissions: 0.2817V/m
Max. Magnetic Field Emissions: 0.3050V/m
- (b) The maintenance of the system is the responsibility of the manufacturer.
- (c) To prevent interference, the product should be as far away from devices operating at the same frequency as possible.