

65 mm

100mm

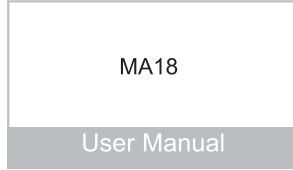

1 Wearing Method

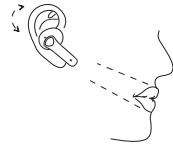

Gently slide into ears
the earbuds tail align with the mouth



Adjust the earbuds to where it
doesn't move while wobbling head

2 Main User Interface

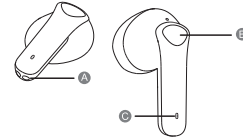

- A. Charging point
- B. Touch button
- C. Microphone
- D. Charging USB port
- E. Status LED

3 Start Here

a. Open charging dock case , take out the earbuds

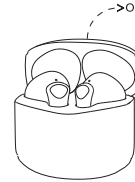

After taking out earbuds , they will
automatically power on and pair
to each other.

b. Pairing with cellphone

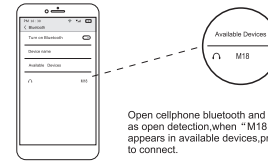

Open cellphone bluetooth and set it
as open detection,when "M18"
appears in available devices,press
to connect.

c. Power off

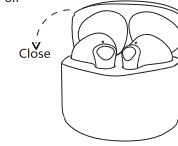

Put back the earbud to the charging dock and close
the cap,the earbuds will power off, and the dock will
charge the earbuds automatically.

4 Charging

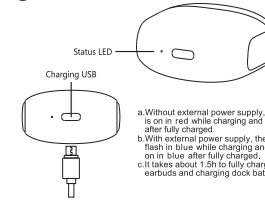

- a. Without external power supply, the LED
is on in red while charging, and will be off
after fully charged.
- b. With external power supply, the LED
flash in blue while charging, and will be
on in blue after fully charged.
- c. It takes about 1.5h to fully charge the
earbuds and charging dock batteries.

5 More Functions



- a. Touch the function button once to answer
calls,press Function Button twice to reject calls.
- b. When playing music, To pause, please press
the function button once. To play the previous
song, please press and hold 2s for left earbud
function button. To play next song, please press
and hold 2s for right earbud function button.
- c. Press left earbud function button
twice to increase volume;
Press right earbud function button
twice to decrease volume;
Press left or right earbud function button
to activate Siri.

6 Important Notice for Single Earbud Using

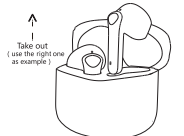

- a. The earbuds can be used individually (each earbud pairs
to separate cellphone)
- b. Open charging dock cap, take out either earbud, and have to
close the cap, wait for 10s, and then turn on cellphone bluetooth
and set it as open detection, when "M18" appears in available
devices, press to connect. The LED will be off.
- c. It will automatically connect to the cellphone, if it connected
previously.

7 Manual re-pairing

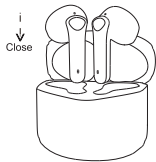

- Step1: make sure to delete all the record of bluetooth connection.
- Step2: put the earbuds into charging case, take them out, it
will be OK after waiting for 1 minute.

Basic Parameter

Product Name: MA18 Operation range: 10m
Charging time: 1.5 hours Call time: 3 hours
Music Time: 4 hours Charging Input: 5 V 200mA
Battery Type: Polymer Li-Ion Battery
Earbud weight: 3.5g + 3.5g

Important Notice

- Please make sure the product is fully charged before
initial use.
- Please use the brand adaptor complying safety
requirements to charge this product.
- If your cellphone can not find "M18", please double
check if your cellphone bluetooth is at "Equipment
visible mode". After initial pairing, the earbuds will be
automatically paired for repeat use. If no use for a long
time, need to follow up pairing procedures to pair with
the cellphone.
- If there is only one earbud has sound while in music
mode, please restart the earbuds or manual re-pairing.

Questions & Answers

Questions	Reasons	Answers
earbuds not "power on"	power run out	charge the charging dock & earbuds
earbuds pairing failure	program error caused by mis-operation	repair manually (pls refer to user manual)
charging case cannot charge the earbuds	dust or impurity covers on the charging point	clean the charging point and ear return to normal
low volume	the volume setting of the earbuds & cellphone not synchronized	turn on cellphone bluetooth & synchronized its volume setting with the connected earbuds
charging dock not charging	charging protection	charge the charging dock by external power
can't find earbuds pairing name or pairing failure with cellphone	earbuds not in pairing mode cellphone bluetooth App error	Re-"power on" the earbuds power off & re-power on cellphone

Security Warning

- Please use the product in the temperature between
0°C-45°C. When the environment temperature is too high
or low, it may cause the product malfunction.
- Please keep the product dry, do not contact water
or humidity environment.
- Please do not drop, throw, pull/drag the product to
prevent damage.
- Please power off before clean the product.
- Please use the product at proper volume while listening
music or answering call, long time at high volume usage
could lead to permanent hearing loss.
- The built in battery is not dismountable, please do not
replace by yourself. If it's really necessary, please ask
help from authorized service center.
- Please dispose the product according to local law, can
not treat it as domestic garbage.
- Without adult supervision, please keep the product out of
reach of children, the swallow of small components
included may cause asphyxia.

Warranty

- This product is covered under warranty for a period of one
year from the date of purchase limited to normal use and
maintenance of the machine parts, materials and functions.
Problems and failures verified upon further identification,
will be provided free repair and replacement parts.
- Excluding the following:
A. Headset is beyond the warranty period;
B. User does not follow the instructions, so that the
headphone wire and earplug broken.
C. Without the authorization to dismount, repair, alteration
structures;
D. Can't provide proof of purchase.
E. Man made damage.
F. Due to natural disasters and other force majeure (such as
earthquakes, fires) product failure of damage causes;

Warranty Card

User's name _____
User's telephone# _____
User's Add _____
Date of purchase _____
Invoice # _____
Dealer's name _____
Dealer's Add _____
Dealer's telephone# _____

PIN:03.009.001.0091

物料编号：03.009.001.0091

名称：MA18-英文说明书

规格：65*100mm 共6P，70g书纸 单色印刷，风琴折

日期：2022年6月22日

FCC Warning

This device complies with part 15 of the FCC Rules. Operation is subject to the following two conditions:

(1) This device may not cause harmful interference, and (2) this device must accept any interference received, including interference that may cause undesired operation.

Any Changes or modifications not expressly approved by the party responsible for compliance could void the user's authority to operate the equipment.

Note: This equipment has been tested and found to comply with the limits for a Class B digital device, pursuant to part 15 of the FCC Rules. These limits are designed to provide reasonable protection against harmful interference in a residential installation. This equipment generates uses and can radiate radio frequency energy and, if not installed and used in accordance with the instructions, may cause harmful interference to radio communications. However, there is no guarantee that interference will not occur in a particular installation. If this equipment does cause harmful interference to radio or television reception, which can be determined by turning the equipment off and on, the user is encouraged to try to correct the interference by one or more of the following measures:

- ▶ -Reorient or relocate the receiving antenna.
- ▶ -Increase the separation between the equipment and receiver.
- ▶ -Connect the equipment into an outlet on a circuit different from that to which the receiver is connected.
- ▶ -Consult the dealer or an experienced radio/TV technician for help.

The device has been evaluated to meet general RF exposure requirement. The device can be used in portable exposure condition without restriction.