

# User Manual

## 1.About Bluetooth headphone.

Thank you for purchasing the Bluetooth headphone,for the sake of making full of the functions of the products, please read the user manual carefully in advance.

## 2.Appearance and function.

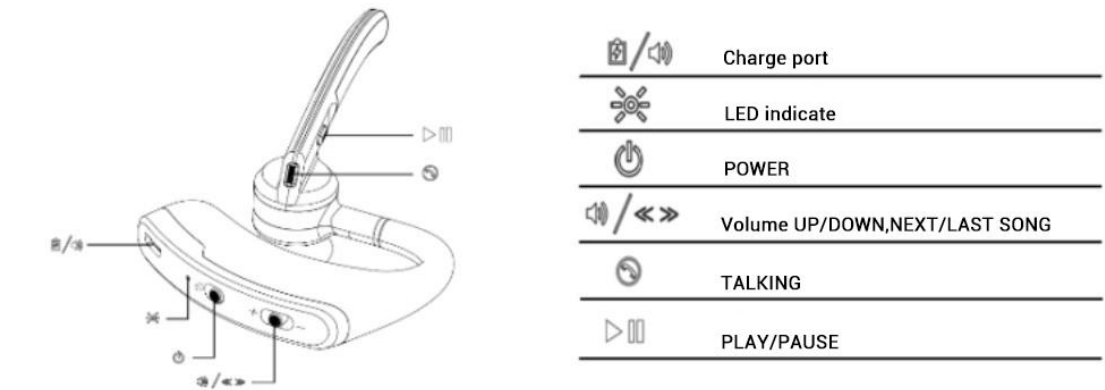

## 3.Installation.

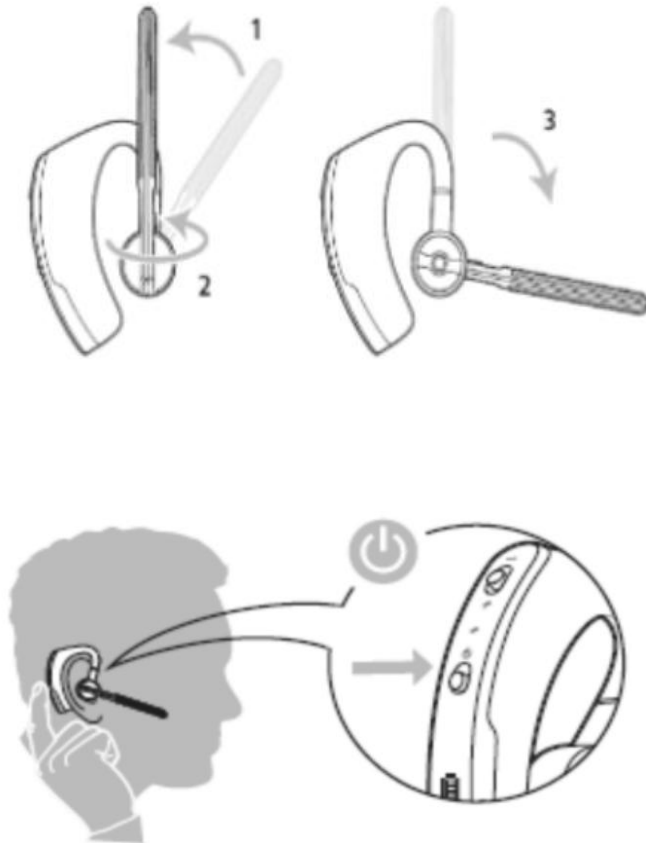

Take the headphone from the package and adjust the angle to meet ear comfort.

## 4. Using the headphone.

### (1). Pairing.

For the first time to use the headphone, it needs to be paired manually as follows:

- a. Power on the headphone, the LED indicator will flash between red and blue alternately, the headphone will report "Power on"
- b. Activate your mobile phone's Bluetooth function and search for available Bluetooth devices.
- c. Select "V8" from the list, once it is connected it will show in your phone. The headphone will report "connected"

### (2). Connected the second phone.

- a. After the first cellphone pairing is successful, please turn off the headphone then turn it on, also disconnect the first phone.
- b. Please pair for the second cellphone as in the above steps, after the second cellphone pairing is successful and with voice report "Phone connected", please reconnect the first phone, now the two phones are connected at the same time.

### (3). Answer/End the Call.

- a. Once a call comes, the headphone will ring when the call is coming, short press the "TALKING" button to receive the call.
- b. Voice answer/end the call.

This headphone has integrated the newest smart technology to allow voice answer of the call, once a call comes, just say "YES" will answer the call, say "NO" will reject the call.

### c. Recall the last number.

Short press "TALKING" button twice for the last number redialing.

### d. Voice dialing.

Ensure your mobile phone can support the voice dialing function and you have set it before you use this function. In standby mode, short press the "TALKING" button to activate. At this time, the voice dialing function in mobile phone will be automatically activated, please speak out the name of your expected contact toward the microphone. (Please refer to mobile phone's user manual).

**Caution:** only apply to the mobile phone with function configuration of voice dialing.

### (4). Play/Pause.

In the normal state, press the "PLAY" button to play the music, press again to stop the music. Press the volume button for a long time to adjust the volume, press the volume button for the last/next song.

## 5. Charging.

The product with built-in rechargeable battery can be charged randomly by the micro USB. To use your Bluetooth headphone for the first time, please charge the headphone fully.

(1) While charging, the Red LED Indicator will light up, after charging is finished, the Red LED Indicator will be off.

(2) While on low power, the headphone will report "didi" for alarm every 5 minutes until power off, please charge the headphone in time.

## 6. Care and maintenance.

(1) Do not expose the speakerphone to liquid, moisture or humidity.

(2) Do not use abrasive cleaning solvents to clean the speakerphone.

(3) Do not place the speakerphone in high temperature, as it may result in an explosion.

(4) Do not expose the speakerphone to contact with sharp objects as this will cause scratching and damage.

(5) Do not attempt to disassemble the speakerphone, as it does not contain serviceable components.

(6) If you do not use the speakerphone for the long time, be sure to store it in a dry place, free extreme temperature, humidity and dust.

## 7. Specification.

Bluetooth Specifications..... Version 4.0, 10 meters

Operating Frequency Band..... 2.4GHz to 2.48GHz unlicensed ISM band

Rechargeable Battery... 3.7VDC, 90mAh, (Li-ion battery)

AD/DC Charger..... DC 5 to 6V, 400mA

Normal Charge Time..... up to 1hrs. (approx)

Talking time..... up to 6hrs.

Standby Time..... up to 300hrs.

Weight..... 18g (without package)

Note: The above configuration may change or upgrade according to the product development plan without any prior notice.

## FCC WARNING

This device complies with part 15 of the FCC Rules. Operation is subject to the following two conditions: (1) This device may not cause harmful interference, and (2) this device must accept any interference received, including interference that may cause undesired operation.

Note: This equipment has been tested and found to comply with the limits for a Class B digital device, pursuant to part 15 of the FCC Rules. These limits are designed to provide reasonable protection against harmful interference in a residential installation. This equipment generates, uses and can radiate radio frequency energy and, if not installed and used in accordance with the instructions, may cause harmful interference to radio communications. However, there is no guarantee that interference will not occur in a particular installation. If this equipment does cause harmful interference to radio or television reception, which can be determined by turning the equipment off and on, the user is encouraged to try to correct the interference by one or more of the following measures:

- Reorient or relocate the receiving antenna.
- Increase the separation between the equipment and receiver.
- Connect the equipment into an outlet on a circuit different from that to which the receiver is connected.
- Consult the dealer or an experienced radio/TV technician for help.

Note: The Grantee is not responsible for any changes or modifications not expressly approved by the party responsible for compliance. such modifications could void the user's authority to operate the equipment.

The device has been evaluated to meet general RF exposure requirement.

This equipment complies with FCC's RF radiation exposure limits set forth for an uncontrolled environment. This device and its antenna(s) must not be co-located or conjunction with any other antenna or transmitter.