

User Manual

Bluetooth Pairing

Turn the button to "ON", the bluetooth mode is ready once blue light flashes, Open the mobile phone, enter the option- "setting ", Search and connect with "WONEW-BR35", Once the connection is successful, the blue light off.

Battery Replacement

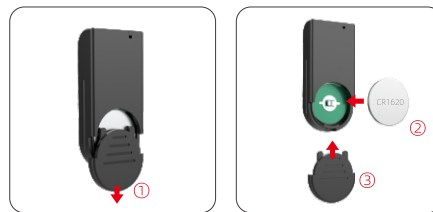

①Slide down to take the battery cover out

②Replace with a new battery

③Slide up the battery cover

FCC Warning:

This device complies with part 15 of the FCC Rules. Operation is subject to the following two conditions: (1) this device may not cause harmful interference, and (2) this device must accept any interference received, including interference that may cause undesired operation.

Any changes or modifications not expressly approved by the party responsible for compliance could void the user's authority to operate the equipment.

NOTE: This equipment has been tested and found to comply with the limits for a Class B

digital device, pursuant to Part 15 of the FCC Rules. These limits are designed to provide reasonable protection against harmful interference in a residential installation. This equipment generates, uses and can radiate radio frequency energy and

, if not installed and used in accordance with the instructions, may cause harmful

interference to radio communications. However, there is no guarantee that interference

will not occur in a particular installation.

If this equipment does cause harmful interference to radio or television reception,

which can be determined by turning the equipment off and on, the user is encouraged to

try to correct the interference by one or more of the following measures:

- Reorient or relocate the receiving antenna.
- Increase the separation between the equipment and receiver.
- Connect the equipment into an outlet on a circuit different from that to which the receiver is connected.

-- Consult the dealer or an experienced radio/TV technician for help. The device has

been evaluated to meet general RF exposure statement.

The device can be used in portable exposure condition without restriction.

Warning: Changes or modifications to this unit not expressly approved by the

part responsible for compliance could void the user's authority to operate the equipment