

CREALITY

Create reality, achieve dreams



K1

K1

3D Printer User Manual

V1.0

Dear Users

Thank you for choosing our products. For the best experience, please read this User Manual carefully and strictly follow the instructions to operate the printer. Our teams will always be ready to provide you with the best services. Please contact us via the phone number or e-mail address provided at the end of this User Manual when you encounter any problem with the printer. For a better experience in using our products, you can also learn how to use the printer in the following ways: Accompanied instructions: you can find the relevant instructions and videos in the USB flash disk.

You can also visit our official website (<https://www.creality.com>) to find information regarding software, hardware, contact information, device instructions, device warranty information, and more.

NOTES

- 1 Do not use the printer in any way other than described herein in order to avoid personal injury or property damage;
- 2 Do not place the printer near any heat source or flammable or explosive objects. We suggest placing it in a well-ventilated, cool and dustless environment;
- 3 Do not expose the printer to a violent vibration or any other unstable environment, as this may cause poor print quality;
- 4 Please use recommended filaments to avoid clogging of the extrusion head and causing damage to the machine;
- 5 Do not use the power cable of other products during installation. Always use a grounded three-prong power outlet, which accompanies the printer;
- 6 Do not touch the nozzle and the heated bed during operation to avoid burns or personal injury;
- 7 Do not wear gloves or wraps while operating the machine to prevent entrapment of movable parts that could cause crushing and cutting injuries to bodily parts;
- 8 Use the provided tools to clean the filament from the extruder in time taking advantage of the residual temperature after printing. Do not touch the extruder directly when cleaning, otherwise it may cause burns;
- 9 Clean the printer frequently. Clean the printer body with a dry cloth regularly after powering off the printer, wipe away dust, bonded print filament and foreign objects on the guide rails;
- 10 Children under 10 years old should not use the printer without supervision, otherwise it may cause personal injury;
- 11 Users should comply with the laws and regulations of the corresponding countries and regions where the equipment is located (used), abide by professional ethics, pay attention to safety obligations, and strictly prohibit the use of our products or equipment for any illegal purposes; Creality will not be responsible for any violators' legal liability under any circumstance;
- 12 Tip: Do not plug in or unplug wires on a charged basis.

1. About the Device	01-03
1.1 About the Printer	01-01
1.2 Device Specifications	02-02
1.3 Packing List	03-03
2. Unboxing	04-09
2.1 Unpacking Steps	04-05
2.2 Install the Product	06-08
2.3 Power-on guide	09-09
3. About the User Interface	10-12
3.1 Main、Prepare	10-10
3.2 Files	11-11
3.3 Tune、Support	12-12
4. First Printing	13-17
4.1 LAN Printing	13-15
4.2 USB flash disk Printing	16-17
5. Functional Specification	18-19
5.1 Filament Retreat	18-18
5.2 Printing platform descriptions	19-19
6. Tips and Routine Maintenance	20-23
6.1 Maintenance Items	20-20
6.2 Error Code Instructions	21-21
6.3 Precautions for printing	22-23

1. About the Device

1.1 About the Printer

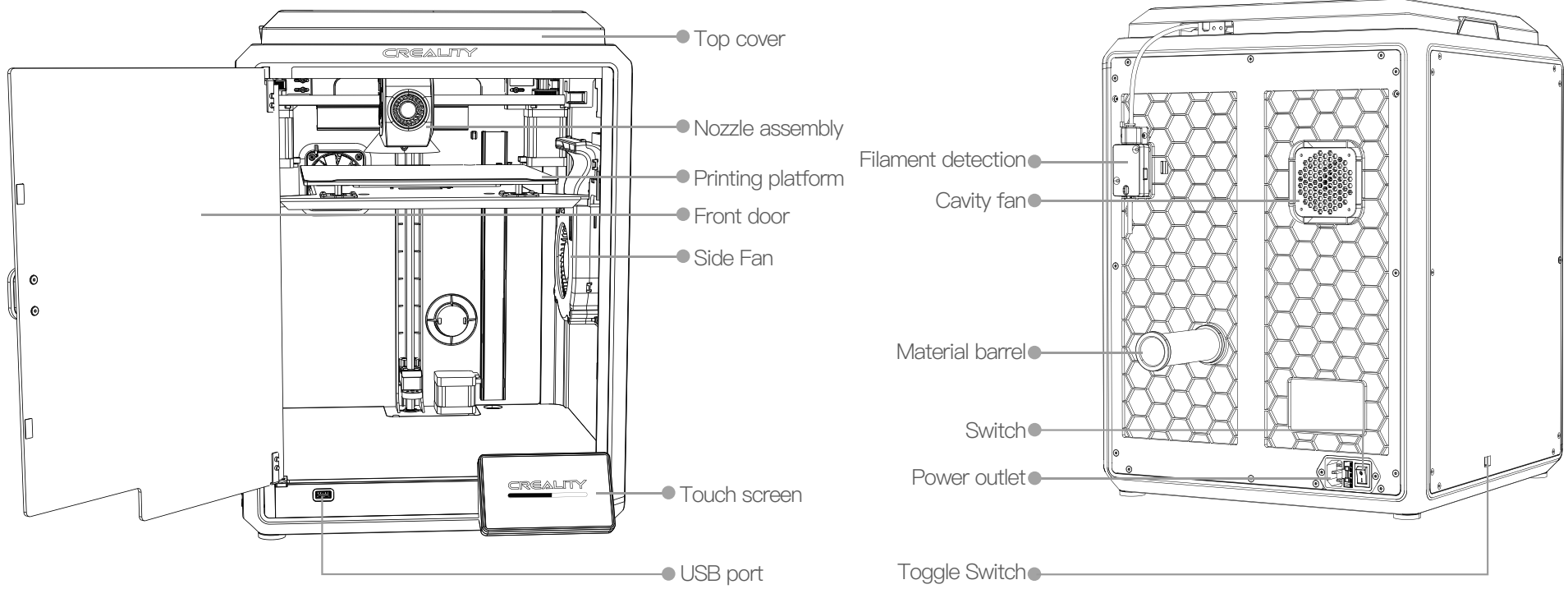

1. About the Device



1.2 Device Specifications

General Specifications	
Product Model	K1
Dimensions	355*355*480mm
Machine Weight	12.5kg
Max. Build Dimensions	220*220*250mm
Print Technology	FDM
Rated Voltage	100–120V~/200–240V~, 50/60Hz
Rated Power	350W
Ambient temperature	10°C–30°C / 50°F–86°F
Extruder	Sprite Direct Drive
Supported Filament	PLA/TPU/PETG/ABS/PET/Carbon
Max. Heated Bed Temperature	100°C
Max. Nozzle Temperature	300°C
User Interface	4.3 inch touch screen
Print Interface	USB Flash Disk/LAN Printing/Creativity Cloud Printing
Power Loss Recovery	Yes
Filament Detection	Yes
Auto leveling	Yes

1. About the Device

1.3 Packing List

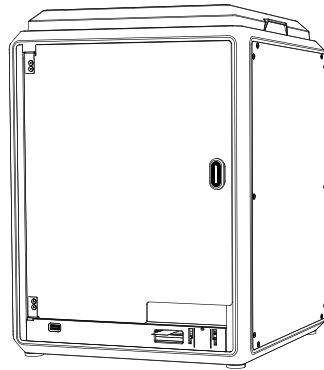

1 Printer

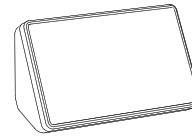

2 Touch screen

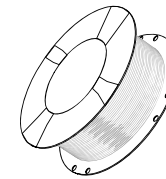

3 Filament



Tool Box List

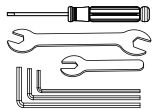

4 Wrench and Screwdriver x1



5 Blade x1

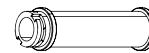

6 Material barrel x1

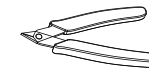

7 Cutting plier x1



8 1.2mm nozzle cleaner x1



9 USB flash disk x1



10 Lubricating Grease x1

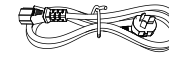

11 Power Cable x1



12 M6 socket spanner x1



13 Glue Stick x1



14 Quick Guide x1



15 After-sales Services Card x1

* Tips: the above accessories are for reference only. Please refer to the physical accessories!

2. Unboxing

2.1 Unpacking Steps

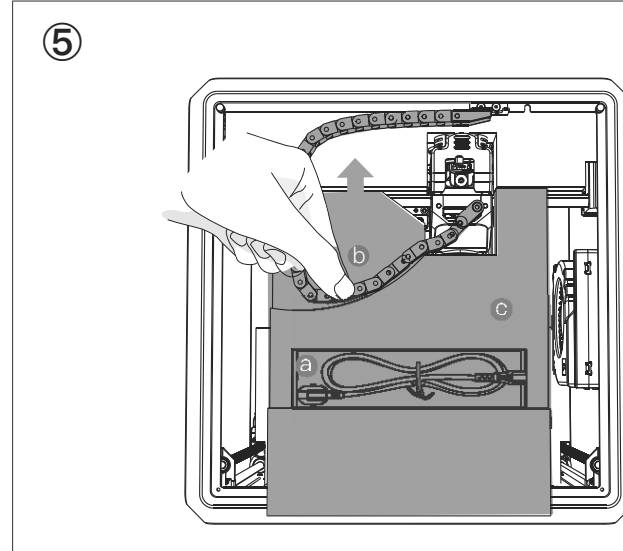
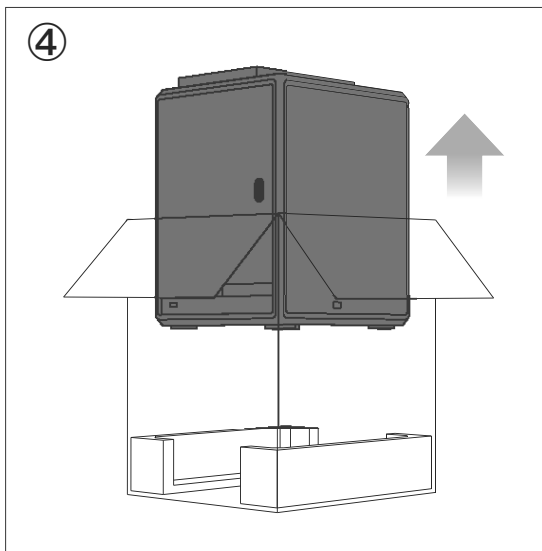
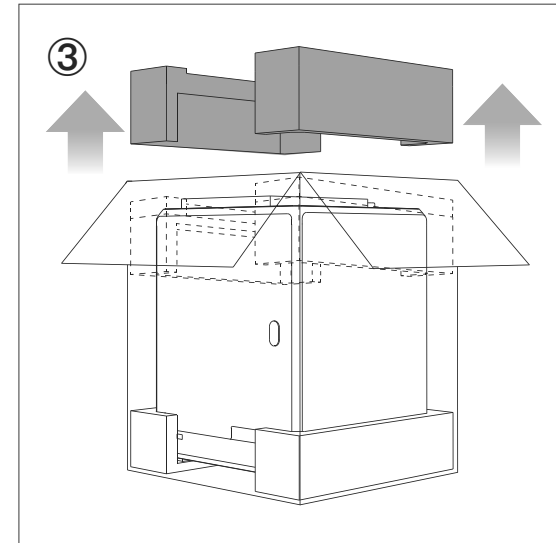
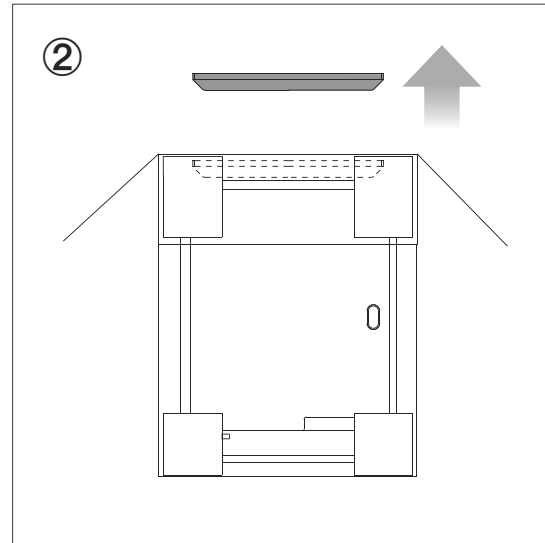
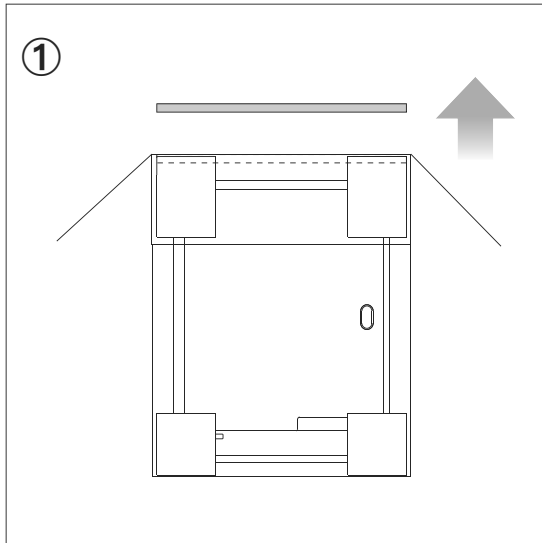

- a Take out the power cord;
- b Move the chain to one side in the direction indicated by the arrow;
- c Finally, take the grey foam as shown.

2. Unboxing

2.1 Unpacking Steps

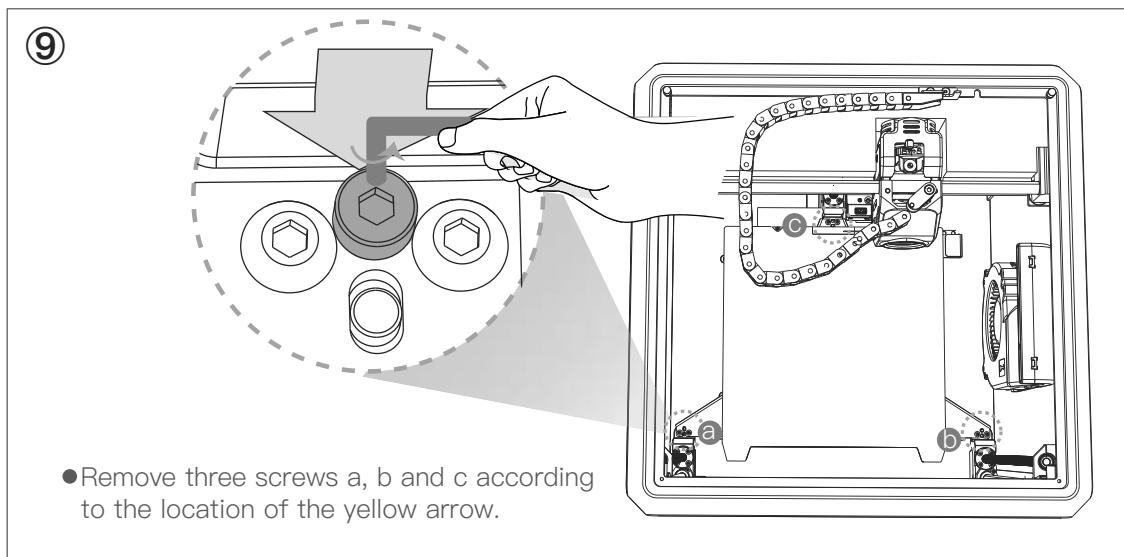
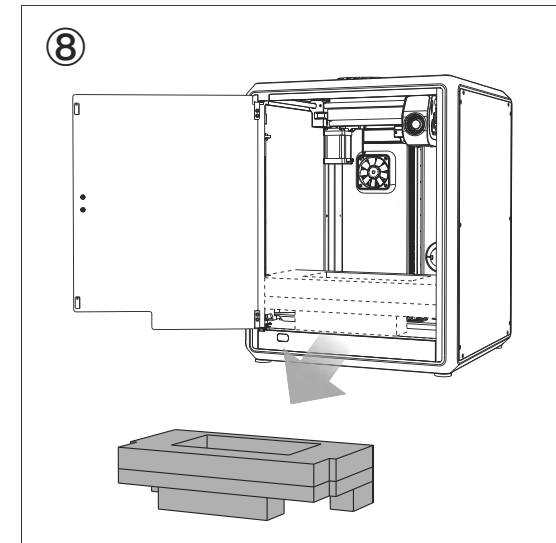
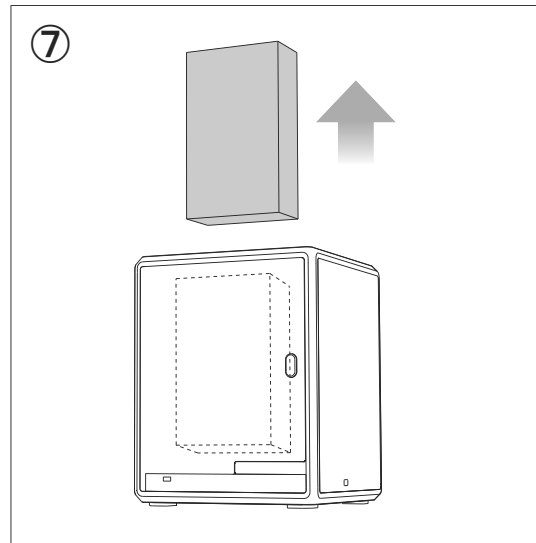
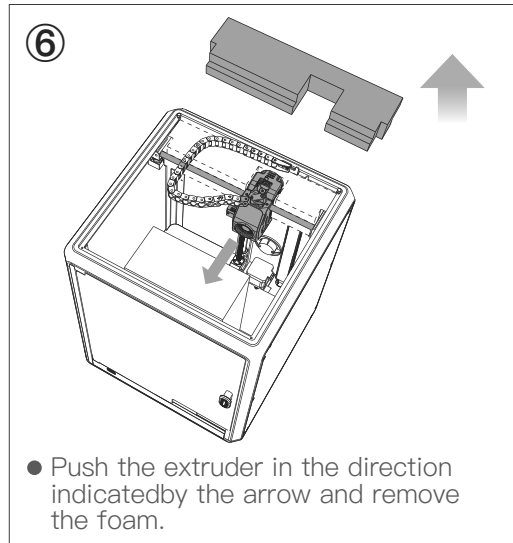

2. Unboxing

2.2 Install the Product

① Take the touch screen out of the tool box and connect the touch screen to the flat cable extended from the base according to Figure A. Then snap the touch screen into the slot in the baseplate, as shown in Figure B.

② Connection and power on.

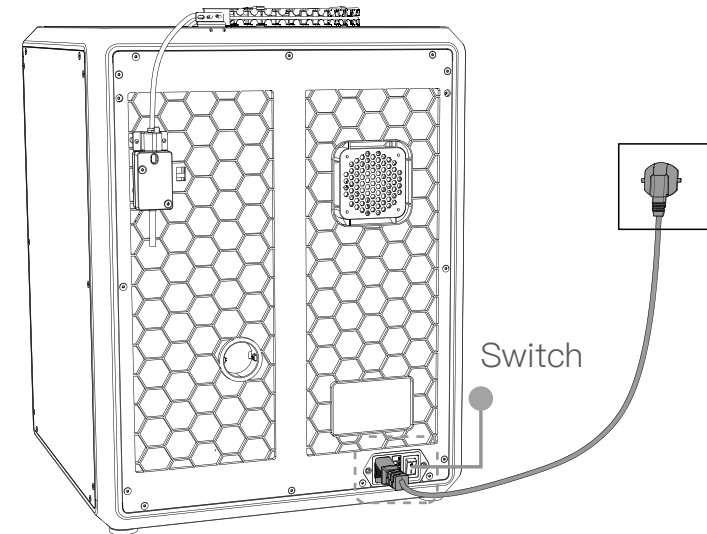
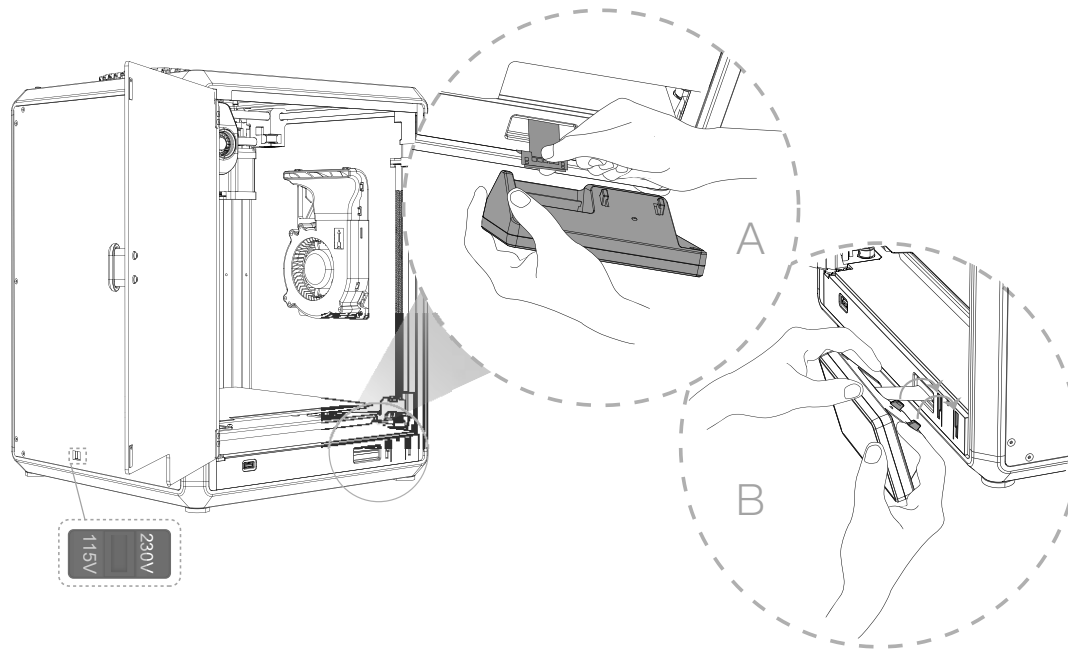

Caution:

- Please ensure the correct position for the power supply switch and mains before supply connection, in order to avoid damage to the device.
- If the mains between 100V and 120V, please select the 115V for the power supply switch with a straight screwdriver.
- If the mains between 200V and 240V, please select the 230V for the power supply switch (default is 230V) with a straight screwdriver.



Caution:

- Do not power up the machine while you are connecting or disconnecting the touch screen.
- The flexible flat cable of the base is pulled lightly and broken carefully.

2. Unboxing

2.2 Install the Product

③ Select a language and click "Next", then click "OK" on the screen and lift the heatbed.

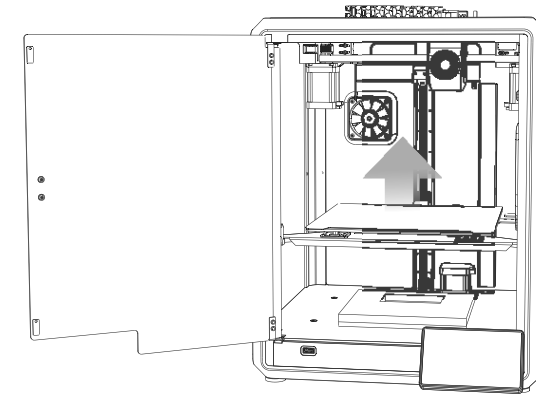

④ Take out the foam as shown and click "OK" to proceed to the next step. Keep the blue cube in the figure clean of debris and then click "OK".

