

## GIMBAL STABILIZER L08 SELFIE STICK TRIPOD



User Manual

### Remove the remote control

Pull out the lever and then slide up to remove the selfie stick.

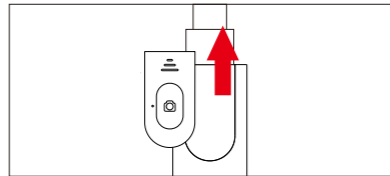

### How to replace the battery

The remote control cover can be opened from the grooves on both sides.

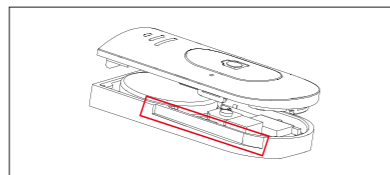

### How to use

1. Long press the camera button for 3 seconds to turn on, the indicator light Flash for 4 seconds to enter the pairing state, pairing The status blue indicator light flashes, use Search "Selfie" on your phone to match, After the pairing is successful, the blue indicator light goes out.
2. The Selfie is connected to the phone When, short press the camera button, the blue light flashes.
3. After booting, in the state of no pairing connection It will automatically shut down after 5 minutes of no operation.
4. After booting, in the Selfie and mobile phone No operation for 10 minutes when connected Work goes to sleep, after another 10 minutes without Operation automatically shuts down.
5. In the boot and sleep state, long press to shoot Press the key for 3 seconds to shut down, the indicator light flashes off Off.

### How to open a tripod

Open outwards at the handle position and it can be turned into tripod mode.

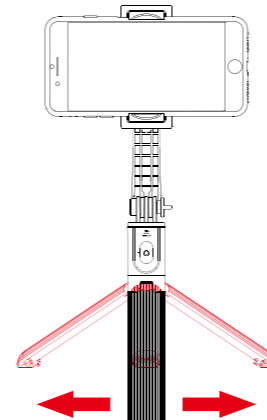

### Usage mode of pan-tilt holder

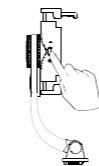

After clamping the phone and keeping the phone in natural stance, press and hold Pan-tilt power key for 5 seconds to start up, Press and hold for 3 seconds to shut down.



After starting up, the green light flashes to enter stable mode, shake the handle left and right, the phone will always maintain a constant direction.



Click the power button of the pan head bracket to switch between horizontal and vertical beats; manually dial left (right) for more than 45° for 2 seconds, and the pan head automatically rotates 90° to the left (right).

### Selfie stick mode

When the pan-tilt is not available or turned off, swipe the unlock key to turn it into tripod mode.

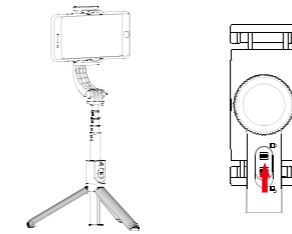

When battery of the pan-tilt is low, there will be a red light flashing to remind you that you need to use the micro USB interface to charge; the charging process indicates that the red light is on for a long time; after charging, the red light goes out.

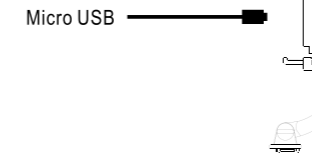

### REMIND

- Long press the power button for 1 second, and the green light will be on for 5 times within 2 seconds to enter the calibration. After entering the calibration shape, the stabilizer should be put flat at this time, as shown in the figure and the stabilizer will automatically rotate for 2 rounds to stop, at this time, the red and green cross flashing. Press the button upward, place the stable clapper horizontally at the traffic light flash, press the power button once, the red light flashes slowly, and the green light flashes long after about 3 seconds, then manually shut down, and then start up, then you can work normally.
- The selfie stick is compatible with Android 4.2.2, Android devices and IOS 5.0 or above of iPhone (if you change the "volume key" function of the system under the camera option of mobile phone, you must change it to the default, or "take photos" to make the selfie stick work normally)
- When clamping the phone, it must be pressed against the phone clip.

1. Stable Mode: Best use in 3 telescopic rods (within 50cm)
2. Selfie Stick Tripod Mode: 5 telescopic rods are recommended (within 70cm)

Thank you for your support!  
FCC CE RoHS

### FCC Warning Statement

Changes or modifications not expressly approved by the party responsible for compliance could void the user's authority to operate the equipment. This equipment has been tested and found to comply with the limits for a Class B digital device, pursuant to Part 15 of the FCC Rules. These limits are designed to provide reasonable protection against harmful interference in a residential installation. This equipment generates uses and can radiate radio frequency energy and, if not installed and used in accordance with the instructions, may cause harmful interference to radio communications. However, there is no guarantee that interference will not occur in a particular installation. If this equipment does cause harmful interference to radio or television reception, which can be determined by turning the equipment off and on, the user is encouraged to try to correct the interference by one or more of the following measures:  
-Reorient or relocate the receiving antenna.  
-Increase the separation between the equipment and receiver.  
-Connect the equipment into an outlet on a circuit different from that to which the receiver is connected.  
-Consult the dealer or an experienced radio/TV technician for help.