

## Front

# Welcome



Lightcloud

### LED A19 with Tunable RGB

LCBA19-9-E26-9RGB-SS

WE'RE HERE TO HELP:  
**1(844) LIGHTCLOUD**  
1(844) 554-4825

## Hello

Lightcloud Blue is a wireless lighting control system that allows you to control RAB Lighting's various compatible devices with your mobile device. Lightcloud Blue lamps are wirelessly controlled locally via the Lightcloud Blue app. Get even more features like secure remote control capability from anywhere that has an internet connection. Lightcloud Gateway and Bridge devices are required to access premium features.

## Product Features & Specifications

Direct Connect LED, No Gateway or Hub required  
Wirelessly control from your mobile device  
On, off and dimming  
Color tuning  
Wireless remote control  
Create custom scenes  
Live-in look vacation mode  
Sensor compatible  
Schedules and automations  
SmartShift automated circadian schedule

Catalog Number: LCBA19-9-E26-9RGB-SS
Model Number: LCBA19-9-E26-9RGB-SS
<b>Electrical:</b> 8.5W, 800lm 1.20Vdc 40Hz
<b>Construction:</b> Lamp Base E26

## Safety Information

- Not suitable for use with dimmers and sensors unless specifically designed for RAB Lightcloud Blue Lamps.
- Risk of electric shock.
- Do not use where directly exposed to water.
- Not intended for use with emergency exit fixtures or emergency lights.
- Only install in operating environments between -4°F and 104°F (-20°C to 40°C).
- Only use the control provided with or specified by these instructions to control this lamp. This lamp will not operate properly when connected to a standard (incandescent) dimmer or dimming control.

WE'RE HERE TO HELP:  
**1(844) LIGHTCLOUD**  
1(844) 554-4825

## Installing your Lightcloud Blue Lamp

### Pre-Installation

- 1 Turn off power  
• Place the wall switch in the off position.  
• Turn off the main power at the breaker panel or remove the fuse from the fuse box.
- 2 Find a suitable location  
Use these guidelines when installing devices:
  - If there is a clear line of sight between a Lightcloud Blue Smart RGB A19 and another Lightcloud Blue device they can be placed up to 200 feet apart.
  - If a Lightcloud Blue Smart RGB A19 and another Lightcloud Blue device are separated by ordinary drywall construction, try to keep them within 70 ft. of each other.
  - Brick, concrete and steel construction may require additional Lightcloud Blue devices to go around the obstruction.

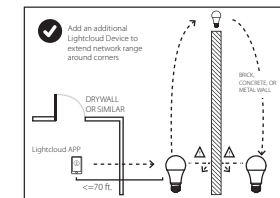

## Installing your Lightcloud Blue Lamp (cont'd)

- 3 Connect device to power.  
After installed, turn the power on and the lamp will enter pairing mode automatically if it has not already been paired. Once the lamp has been paired, it will indicate by flashing on and off 5 times and then dim to 30% brightness.

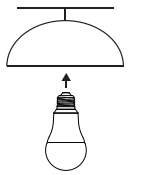

## Back







Lightcloud

Lightcloud Blue is a wireless lighting control system. It's powerful and flexible, yet easy to use and install. Learn more at [www.lightcloud.com](http://www.lightcloud.com)

**1(844) LIGHTCLOUD**  
1(844) 554-4825

**RAB**<sup>®</sup>  
©2022 RAB LIGHTING Inc.  
Made in China.  
[Pat. rablighting.com/ip](http://Pat. rablighting.com/ip)

## Controlling your Lightcloud Blue Device

- 1 Confirm your device is connected and powered on.
- 2 Download the Lightcloud app from the Apple App Store or Google Play store.  
 
- 3 Launch the App and create an account. 
- 4 Tap the "add device" icon in the app to start connecting devices. 
- 5 Follow the remaining steps in the app. Create areas, groups, and scenes to organize and control your devices.
- 6 You're all set!

## Setting Device to Pairing Mode

If your Lightcloud Blue Smart RGB A19 is already paired, you can reset it by using the below methods.

### Method 1: Manual 1-10 devices

Power the lamp off and on 5 times consecutively. Do not allow more than 2 second to elapse between switching. The lamp will flash 3 times, then reset to 100% brightness at default CCT.



### Method 2: Reset Tool 10 or more devices

The reset process must be done by professional electricians qualified by RAB. Reach out to your RAB sales manager to request a Reset Tool. The tool simply needs to be placed directly on the lamp for 2 seconds. The lamp will flash 3 times, then reset to 100% brightness at default CCT.



## Functionality

### Configuration

All configuration of Lightcloud Blue products may be performed using the Lightcloud Blue app.

WE'RE HERE TO HELP:  
**1 (844) LIGHTCLOUD**  
1 (844) 544-4825  
[support@lightcloud.com](mailto:support@lightcloud.com)

### FCC Information:

This device complies with Part 15 of the FCC Rules. Operation is subject to the following two conditions: 1. This device may not cause harmful interference, and 2. This device must accept any interference received, including interference that may cause undesired operation.

To comply with the FCC's RF exposure limits for general population / uncontrolled exposure, this transmitter must be installed to provide a separation distance of at least 20 cm from all persons and must not be co-located or operating in conjunction with any other antenna or transmitter. The manufacturer is not responsible for any radio or TV interference caused by unauthorized modifications to this equipment. Such modifications could void the user's authority to operate the equipment.

CAUTION: Changes or modifications to this equipment not expressly approved by RAB Lighting may void the user's authority to operate this equipment.

Note: This equipment has been tested and found to comply with the limits for a Class B digital device, pursuant to part 15 of the FCC Rules. These limits are designed to provide reasonable protection against harmful interference in a residential installation. This equipment generates, uses and can radiate radio frequency energy and, if not installed and used in accordance with the instructions, may cause harmful interference to radio communications. However, there is no guarantee that interference will not occur in a particular installation. If this equipment does cause harmful interference to radio or television reception, which can be determined by turning the equipment off and on, the user is encouraged to try to correct the interference by one or more of the following measures:  
—Reorient or relocate the receiving antenna.  
—Increase the separation between the equipment and receiver.  
—Connect the equipment into an outlet on a circuit different from that to which the receiver is connected.  
—Consult the dealer or an experienced radio/TV technician for help

## Manual Folding

