

UOKIER

BABY MONITOR

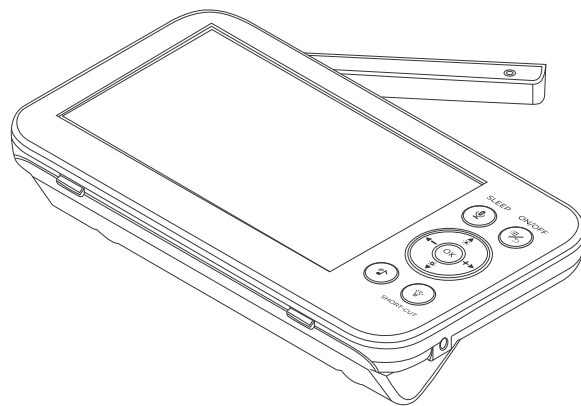

User Manual
Email: support@uokier.com

Thank you for purchasing UOKIER baby monitor

Please read this user guide carefully before operating the baby monitor, and properly keep the guide for future use.

If you need any assistance, please contact us by official customer service

Email: support@uokier.com

Facebook: [@UOKIER](#)

Official Website: www.uokier.com

CONTENTS

Precautions for Use	01
Helpful Tips	
Warranty	
Package Contents	
Product Details	04
Screen Details	
Camera Details	
Operation	05
Installation	
Pairing Settings	06
Initial Pairing Settings	
Screen Display	
Feeding Time Setting	11
Sound Sensitivity	11
Play Lullabies	11
Temp & Time Setting	11
Dormant & Lumi Setting	11
Language Setting	11
System Setting	11
Intercom	11
Brightness Setting	01

Volume Adjustment Display	-----	11
Lullabies	-----	11
Troubleshooting	-----	11
Product Description	-----	11

PRECAUTIONS FOR USE

Before installing and using our baby monitor, follow these safety instructions and read these helpful tips.

Important safety Instructions

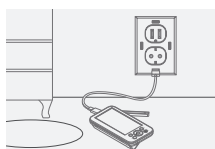

Please fully charge before the first time using to extend the battery life.



To protect the safety and privacy of babies, this baby monitor uses 2.4GHz wireless technology which doesn't need to connect to Wi-Fi



Keep the camera away from the monitor during the use, as signal interference can cause noises.

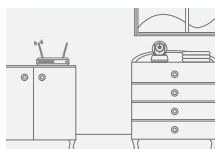

Keep the distance between the baby monitor and the Wi-Fi signal source, as it may affect the signal.



Do not put the baby monitor near water or heat sources.

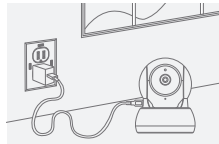

Do not use different power source, it may result in safety issues.



Strangulation Hazard: Please keep cord of power adapter out of the reach of children to prevent Children Strangulation Hazard.



There is a protective film on the display, please tear it off before use.



There is an external antenna on the top of the display, which can be erected as needed to enhance the signal.

Warranty

Your baby monitor comes with warranty within 1 year. However, the warranty does not cover the following:

- Purchases from unauthorized resellers
- Improperly operated devices
- Purchases made over 1 year ago (unless you get an extended warranty)
- Free products
- Lost or stolen products

Package Contents

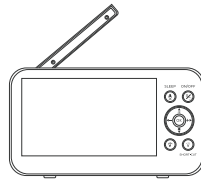

Monitor

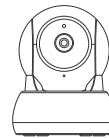

Camera

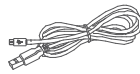

2 * Power cables



Parts package

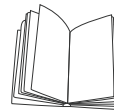

Instruction manual

PRODUCT DETAILS

Screen Details

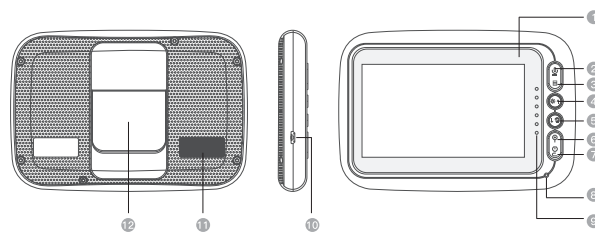

- | | | | |
|----------------------|--------------|----------------------|------------|
| 1 Sound alarm lights | 4 Brightness | 7 ON/OFF Back button | 10 Input |
| 2 Intercom | 5 Voice | 8 Microphone | 11 Speaker |
| 3 Menu/OK | 6 Zoom | 9 Cue light | 12 Holder |

Camera Details

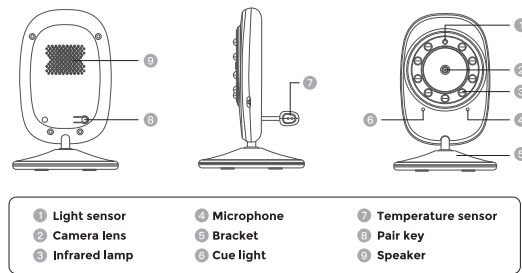

OPERATION

Installation

1 . Host Start Up

Press and hold this button (ON/OFF) to turn on the baby monitor and the screen will light up.

Note: Please check whether the battery is fully charged. Charge the baby monitor if the battery is not full.

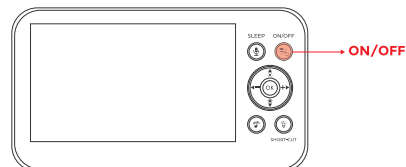

2 . Camera Start Up

When the camera is connected to 5V DC power, it starts up automatically.

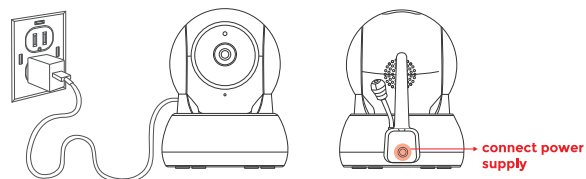

After both the host and the camera are powered on and started up, the pairing settings are needed to be modified if the host screen can not display the monitoring image taken by the camera correctly. See section below.

PAIRING SETTINGS

Initial pairing settings

1. Press menu key to enter the menu when the host is on;

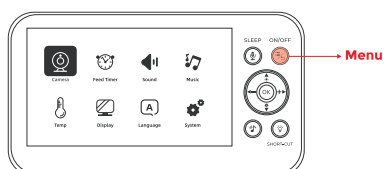

2. Then press select key select camera setting bar;

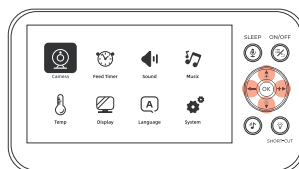

3. Press OK key to enter pairing setting;

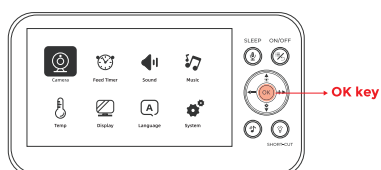

4. Select camera "1" or "2" or "3" or "4" to be used;

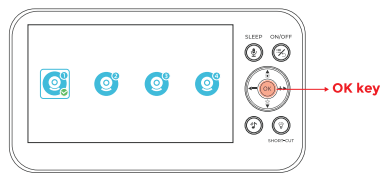

5. Press ok to confirm, in the meantime, long press the camera's pair key (at the bottom of the camera);

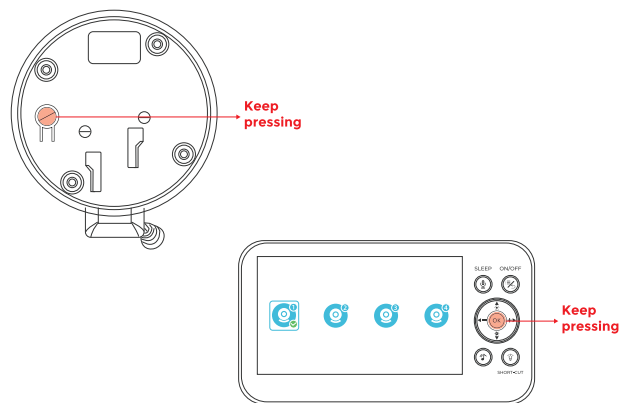

6. When the pairing is successful, the corresponding icon of "1" or "2" of the camera will display the signal ladder to indicate the matching is successful.

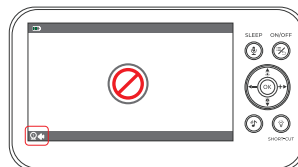

SCREEN DISPLAY

Video Cycle: This function is only valid for pairing multiple cameras at the same time. No need to operate when only have one camera.

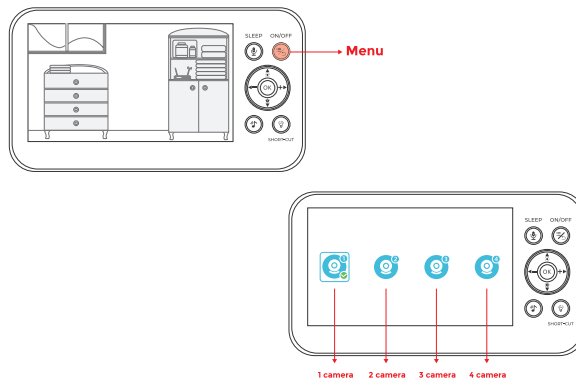

1. Press the menu key to enter the setting toolbar, select the pairing icon, and then enter the next menu.
2. Select the video 1 icon to match the first camera, and the video 2 icon to match the second camera, and the video 3 or 4 icon to match the third or fourth camera.

FEEDING TIME SETTING

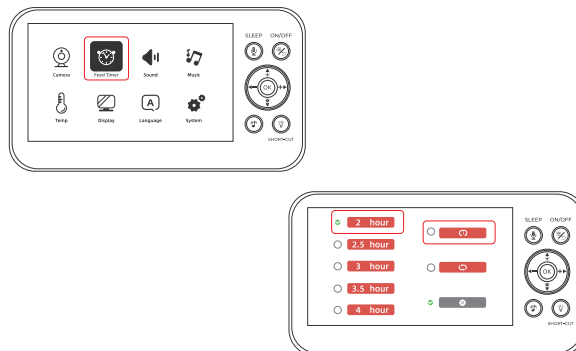

1. Press the menu toolbar, then press the selection key to the left or right;
2. Select the feeding time setting field and press the OK key to confirm;
3. Press the selection key up or down to select the appropriate time;
4. Or choose right, then up or down to cancel the feeding time setting, or continue or once
5. When the predefined time is reached, the superior unit will issue an alarm to remind you. Press the OK key to turn off the alarm.

SOUND SENSITIVITY

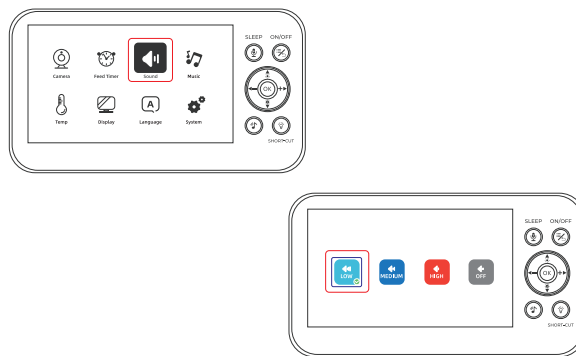

1. Press the menu toolbar, then press the selection key to the left or right;
2. Select the sound setting field, and then press the OK key to confirm;
3. Press the left or right selection key to switch the sensitivity level, select one of the following options;
4. Finally press the OK key to confirm.

Low : The sound function is enabled with low sensitivity, sounds are transmitted only when the baby is crying loudly.

Medium : The sound function is enabled with medium sensitivity, the baby unit transmits sounds when the baby is crying normally.

High : The sound function is enabled with high sensitivity, even soft sound from the baby room are transmitted.

OFF : The sound function is disabled, all sounds from the baby room are transmitted, even if the baby is crying, it will not alarm.

1. After enabling this function, the ear icon will appear in the lower left corner of the screen.
2. When the sound of the baby room is louder than the set volume, the parent unit will alarm. You can turn the alarm off by pressing any button or directly select OFF to disable sound function.
3. Please select the appropriate sound sensitivity according to your actual need.

PLAY LULLABIES

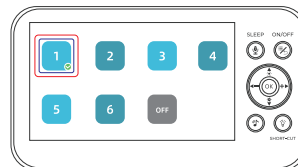
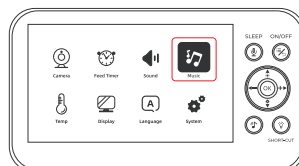

1. Press the menu toolbar, then press the selection key to the left or right;
2. Select the music setting field, and then press the OK key to confirm;
3. Press the selection key up and down or left and right to select your favorite lullaby 1-6;
4. Or select OFF to stop lullaby playback, press the OK key to confirm.

TEMPERATURE & TIME SETTING

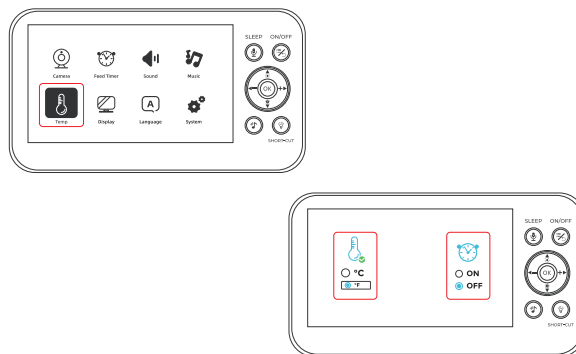

1. Press the menu toolbar, then press the selection key to the left or right;
2. Select the temp setting field and press the OK key to confirm;
3. Press the up or down selection key to select the appropriate temp unit;
4. Or press the right button to select the temperature alarm switch;
5. Finally press the OK key to confirm.

VOX FUNCTION

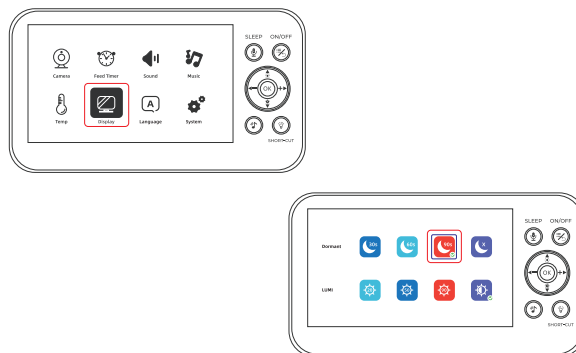

1. Press the menu toolbar, then press the selection key to the left or right;
2. Select the display setting field, and then press the OK key to confirm;
3. Press the left or right selection key to switch the number of seconds after the screen automatically turns off, or select "Off" to stop the power saving mode;
4. Or press the brightness setting button. Then press the left and right selection key to adjust the screen brightness.
5. Finally press the OK key to confirm.

LANGUAGE SETTING

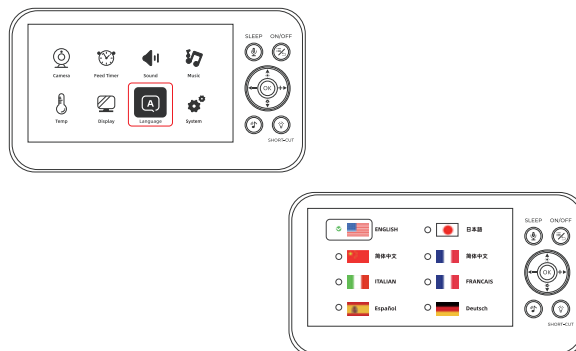

1. Press the menu toolbar, then press the selection key to the left or right;
2. Select the language setting field, and then press the OK key to confirm;
3. Press the selection key up and down or left and right to select your required national language;
4. Finally press the OK key to confirm.

SYSTEM SETTING

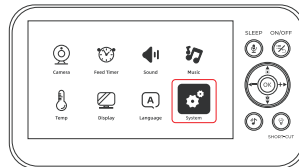

1. Press the menu toolbar, then press the selection key to the left or right;
2. Select the system setting field and press the OK key to confirm;
3. Press the up or down selection key to select the appropriate time;
4. Press the left or right selection key to select the next or previous step;
5. Finally press the OK key to confirm.;
6. Wi-Fi Set - Please modify the network according to your needs.
7. Reset - Please restore factory settings according to your needs.
8. SysInfo - Please check the system version.

INTERCOM

1. Long press the talk button to talk directly with your baby.
2. When this function is enabled, the call image appears on the bottom left corner of the screen.

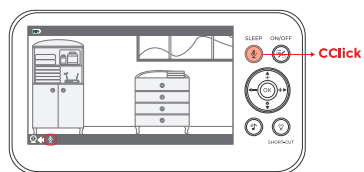

Brightness Setting

1. Press the brightness setting button.
2. Then press the up or down selection key to adjust the screen brightness.

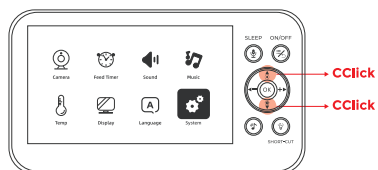

VOLUME ADJUSTMENT DISPLAY

1. Press the volume setting button.
2. Then press the left or right selection key to adjust the volume.

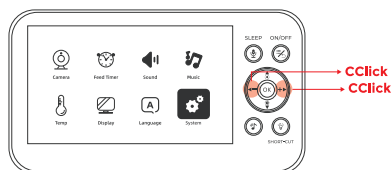

Lullabies

Press the lullaby button to switch 1-6 songs or turn off the music.

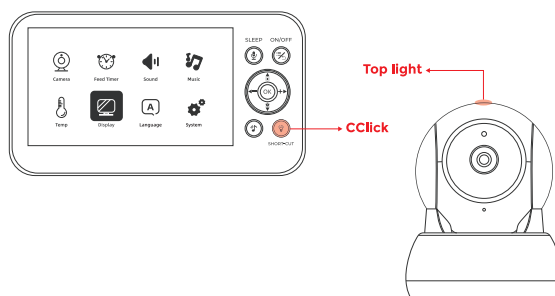

NIGHT LIGHT & SHORT-CUT

Night light

Please press the night light key to turn on or off the night light above the camera.

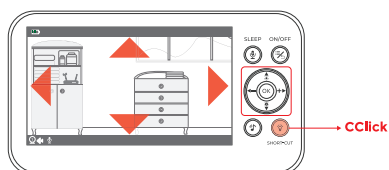

Short-cut

1. Press the short-cut button.
1. Then press the selection key to adjust the horizontal or vertical rotation of the camera up, down, left or right.

TROUBLESHOOTING

To quickly solve your problems and to prevent improper using and settings, please follow the operations below. If your problems or enquiries cannot be eliminated after reading, please do not hesitate to contact us.

Troubleshooting table		
No	Description	Solution and operation
1	Screen of host cannot show monitor image	A) Make sure that there are not many big things such walls between the display and the camera for poor signal will cause on image. B) Determine the display has been connected to the 5V DC power supply, screen of the host lights. C) Determine the camera is connected to the 5V DC power supply. D) The display and the camera have paired successfully. (Can refer to page 6 for re-pairing: pairing settings)
2	Screen of host does not work	A) If the host is in a power saving state, press any key to light screen. B) Check whether the 5V DC power supply is powered on. Make sure that the USB plug of the power adapter is correctly inserted into the 5V DC socket of the host and the two metal plugs at the other end of the power adapter are correctly inserted into the electrified power socket. Please observe the power indicator lamp.
3	The monitor's black screen over and over during use	Our baby monitor has a Sound function. Once the baby monitor detects your baby's voice, the warning lights and the sound alarm will be on and the screen will be activated. (See page 16: VOX function settings)

SPECIFICATIONS

Wireless Camera

Operating Frequency Range: 2400MHz-2483.5MHz
Transmitting Power: 94.7dBuV/m@3m
Monitor sensitivity: -88dBm
Type of Modulation: GFSK
Data Rate: 3Mbps
Transmission range: Outdoor 100 m(Eye of Sight)
Operating Temperature Range: 0 C--+40 C
Operating Humidity Range: 85%RH
Environment Rating: Indoor use only

Image Sensor Type: 1/3" Color CMOS Image Sensor
Effective Pixel: 2 megapixels
Lens: EFL=3.6mm.F=2.8
Viewing Angle(Diagonal): 70 degree
IR LED Type/Night Vision: 9 pcs IR LED 15 m
Power Requirement: DC 5V
Other Special Feature: Built in Microphone/ Speaker

Wireless Monitor

Display Type/Size: Color TFT 5 inch
Resolution(Pixel): 800*480(RGB)
Viewing Angle: H:80 degree, V:100 degree
Power Requirement: Adapter DC 5V
Battery: 3.7V Li-polymer



This device complies with part 15 of the FCC Rules. Operation is subject to the following two conditions: (1) This device may not cause harmful interference, and (2) this device must accept any interference received, including interference that may cause undesired operation.

Any Changes or modifications not expressly approved by the party responsible for compliance could void the user's authority to operate the equipment.

Note: This equipment has been tested and found to comply with the limits for a Class B digital device, pursuant to part 15 of the FCC Rules. These limits are designed to provide reasonable protection against harmful interference in a residential installation. This equipment generates uses and can radiate radio frequency energy and, if not installed and used in accordance with the instructions, may cause harmful interference to radio communications. However, there is no guarantee that interference will not occur in a particular installation. If this equipment does cause harmful interference to radio or television reception, which can be determined by turning the equipment off and on, the user is encouraged to try to correct the interference by one or more of the following measures:

- Reorient or relocate the receiving antenna.
- Increase the separation between the equipment and receiver.
- Connect the equipment into an outlet on a circuit different from that to which the receiver is connected.
- Consult the dealer or an experienced radio/TV technician for help.