



Borecam Pro 2.0

Wireless Digital Borescope

Wifi operation for Android
and iOS phones or tablets



Thank you for choosing Lyman Borecam 2.0 Borescope. Please read the user manual before operating the device and keep it for future reference.

⚠ This device is NOT for medical use or human examination.

Safety

⚠ WARNING! Please read all safety warnings and all instructions before using this product. Failure to follow the warnings and instructions may result in electric shock, fire and serious injury.

- Keep the tool dry, clean, free from oil, water, gas or other materials causing corrosion.
- Keep work area clean and well lit.
- This appliance is not intended for use by persons with limited physical, sensory or mental capabilities.
- This appliance is not intended for medical use or personal inspection.
- Keep bystanders and children away while operating the tool.
- Do not overreach, keep proper footing and balance at all times.

Battery

- Only use 5V indoor home use USB charger to charge the device.
- Please charge the device at least once every 3 months if it is left unused for a long time to prevent damage to the battery.

Maintenance

- Always keep the camera lens clean.
- Should any other components not mentioned need to be replaced, please contact our customer service department at 1-800-225-9626.

Product Description

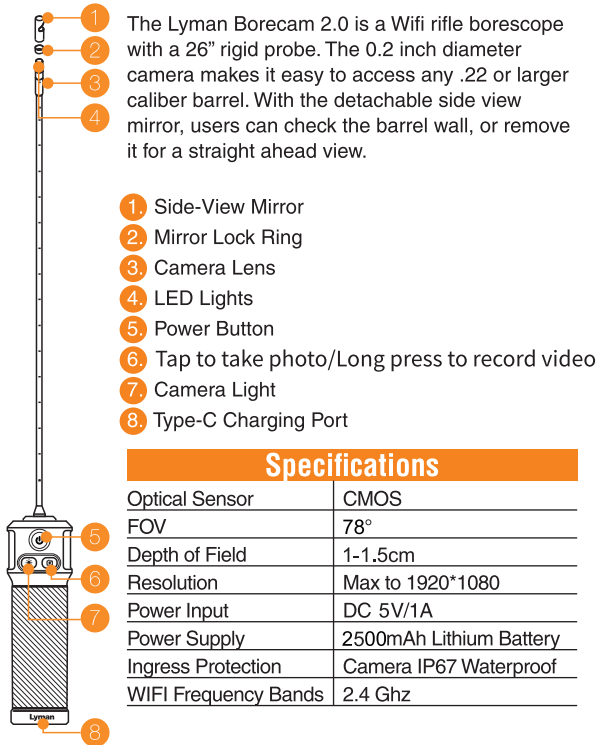

The Lyman Borecam 2.0 is a Wifi rifle borescope with a 26" rigid probe. The 0.2 inch diameter camera makes it easy to access any .22 or larger caliber barrel. With the detachable side view mirror, users can check the barrel wall, or remove it for a straight ahead view.

- 1. Side-View Mirror
- 2. Mirror Lock Ring
- 3. Camera Lens
- 4. LED Lights
- 5. Power Button
- 6. Tap to take photo/Long press to record video
- 7. Camera Light
- 8. Type-C Charging Port

Specifications

Optical Sensor	CMOS
FOV	78°
Depth of Field	1-1.5cm
Resolution	Max to 1920*1080
Power Input	DC 5V/1A
Power Supply	2500mAh Lithium Battery
Ingress Protection	Camera IP67 Waterproof
WIFI Frequency Bands	2.4 Ghz

Operating Instructions

DOWNLOADING THE APP

Use the Borecam with the "Borecam 2.0" app. You can download it from Apple Store/Google Play or scan the QR code below.



Connecting Your Device to the Borecam 2.0

1. Press the power button to turn on the Borecam. The button will blink slowly to indicate that WIFI is not connect to your device.

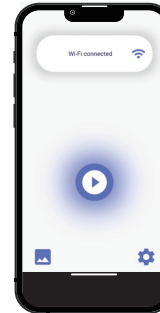
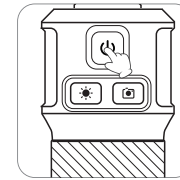

2. Go into the WIFI settings on your device, choose and connect with "Borecam2.0". The power button will stop blinking and turn solid when connected. **Note:** when in use, if the power button begins flashing quickly, the unit needs to be recharged.

3. Open the “Borecam 2.0” app, click the **GO** button to add “Borecam 2.0-xxxxxx” and start using it.

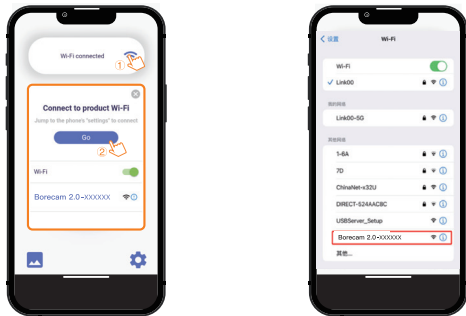

4. Click the **▶** to start using.

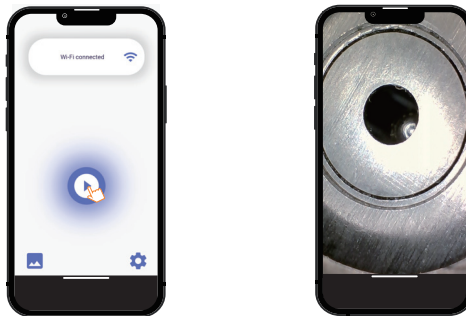

-4-

App Instructions

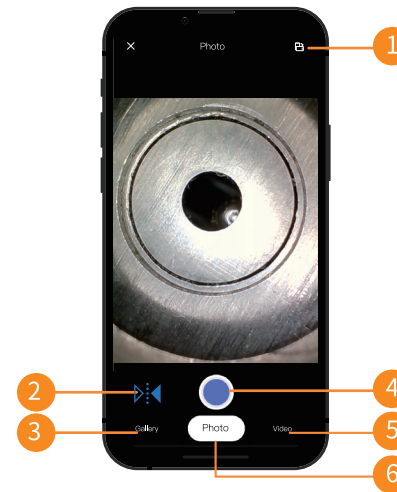

1. **Rotate:** Click to rotate the image
2. **Screen Mirroring:** Click to enter into Screen Mirroring Mode
3. **Gallery:** Click to check the photos/videos
4. **Shoot Button:** Click to take a photo/video record
5. **Video:** Click to enter into Video Mode
6. **Photo:** Click to enter into Photo Mode

-5-

Instructions

How to Focus

Screw mirror in or out depending on your caliber diameter to get the best focal distance and use the "lock ring" to hold it in position.

For Example

- a. For rifle barrel with .223 caliber



- b. For rifle barrel with larger caliber.

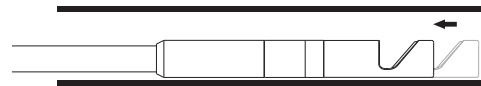

For best results, always use the mirror that is closest to your bore diameter.

Lyman[®]
Brands That Perform



Lyman Products

475 Smith Street
Middletown, CT 06457
1-800-225-9626

www.lymanproducts.com

FCC Caution:

Any Changes or modifications not expressly approved by the party responsible for compliance could void the user's authority to operate the equipment.

This device complies with part 15 of the FCC Rules. Operation is subject to the following two conditions: (1) This device may not cause harmful interference, and (2) this device must accept any interference received, including interference that may cause undesired operation.

Note: This equipment has been tested and found to comply with the limits for a Class B digital device, pursuant to part 15 of the FCC Rules. These limits are designed to provide reasonable protection against harmful interference in a residential installation. This equipment generates, uses and can radiate radio frequency energy and, if not installed and used in accordance with the instructions, may cause harmful interference to radio communications. However, there is no guarantee that interference will not occur in a particular installation. If this equipment does cause harmful interference to radio or television reception, which can be determined by turning the equipment off and on, the user is encouraged to try to correct the interference by one or more of the following measures:

- Reorient or relocate the receiving antenna.
- Increase the separation between the equipment and receiver.
- Connect the equipment into an outlet on a circuit different from that to which the receiver is connected.
- Consult the dealer or an experienced radio/TV technician for help.

This device complies with FCC radiation exposure requirement set forth for an uncontrolled environment.