

User Manual



Wireless Pad

www.rushcharge.com

Getting Started

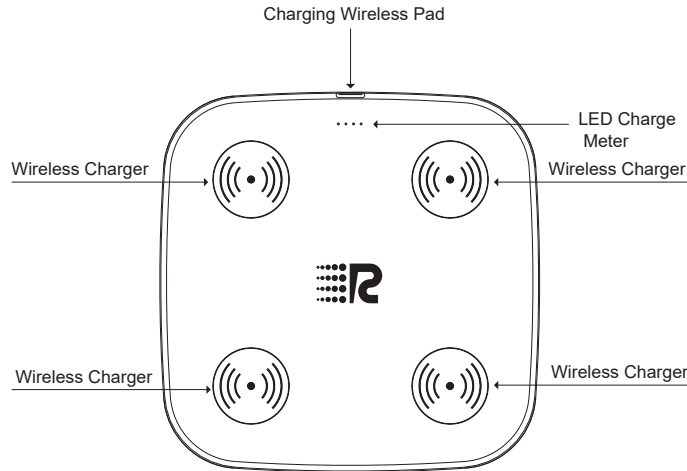

Charging Your Wireless Pad

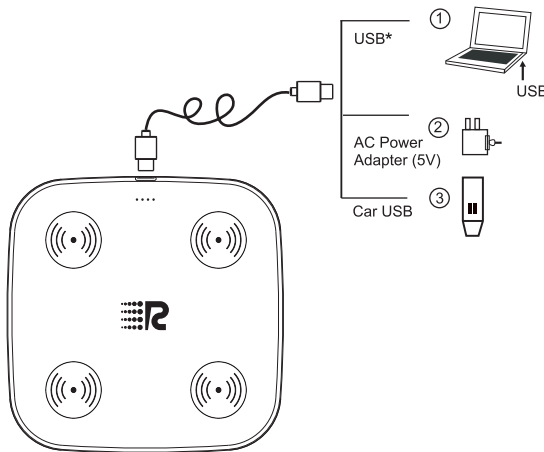

- 1.Use Type-C to Type-C charging Cable to charge your Wireless Pad
- 2.After plug in the Type-C cable the LED will flashing 3S and then off.
- 3.LED indicate will show red by accident.

Charging Your Smartphone with Wireless Pad

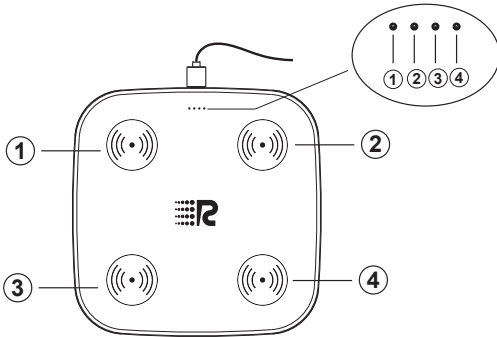

- 1.Powers any device equipped with wireless charging.
- 2. " ① " wireless charge is show by the " ① " LED indicate.
- " ② " wireless charge is show by the " ② " LED indicate.
- " ③ " wireless charge is show by the " ③ " LED indicate.
- " ④ " wireless charge is show by the " ④ " LED indicate.
- 3.When charger is in use,LED will show green , After full charge, LED will show red.
- 4. When the device is not in the correct charging area,the LED flash red.

Specification

Input	40W(max)
Output	4*7.5W/5W/10W
Frequency Response	110-205KHZ
Charging Distance	2-5mm
Dimension	202*202*12mm

**FCC Radiation Exposure Statement**  
This equipment complies with FCC RF radiation exposure limits set forth for an uncontrolled environment. This transmitter must not be co-located or operating in conjunction with any other antenna or transmitter

This device complies with Part 15 of the FCC Rules, operation is subject to the following two conditions.  
1. This device may not cause harmful interference, and  
2. This device must accept any interference received, including interference that may cause undesired operation.

• Warning: Changes or modifications to this unit not expressly approved by the party responsible for compliance could void the user's authority to operate the equipment.

• NOTE: This equipment has been tested and found to comply with the limits for a Class B digital device, pursuant to Part 15 of the FCC Rules. These limits are designed to provide reasonable protection against harmful interference in a residential installation. This equipment generates, uses and can radiate radio frequency energy and, if not installed and used in accordance with the instructions, may cause harmful interference to radio communications. However, there is no guarantee that interference will not occur in a particular installation. If this equipment does cause harmful interference to radio or television reception, which can be determined by turning the equipment off and on, the user is encouraged to try to correct the interference by one or more of the following measures:  
• Reorient or relocate the receiving antenna.  
• Increase the separation between the equipment and receiver.  
• Connect the equipment into an outlet on a circuit different from that to which the receiver is connected.  
• Consult the dealer or an experienced radio/TV technician for help.



All trademarks are the property of their respective owners.