

True Wireless Earbuds

User Manual



FCC ID:2AX9FDW-TWS350B



In the Box

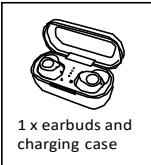

1 x earbuds and charging case

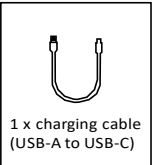

1 x charging cable (USB-A to USB-C)

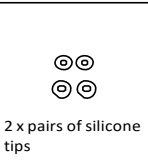

2 x pairs of silicone tips

Safety Information

- Read and follow the instructions carefully.
- Frequent exposure to high volume levels could cause permanent hearing damage.
- Don't attempt to replace earbuds or charging case batteries yourself— damaging the batteries could cause overheating and injury.
- Use of noise-canceling earbuds while operating a vehicle is not recommended and is illegal in some areas. Follow any laws regarding earbud and headphone use while operating a vehicle.
- Only use a standard charger to charge the earphones to avoid damagingthe battery.
- Frequent charging may reduce the battery performance.
- Do not expose the earbuds to direct heat.
- Keep the charging ports and earbuds clean.
- Do not dismantle the product yourself for any reason.
- Do not clean the product with oil or any corrosive cleaning agents.
- Do not use this product in any potentially hazardous places.

Page 1

Introduction to Parts

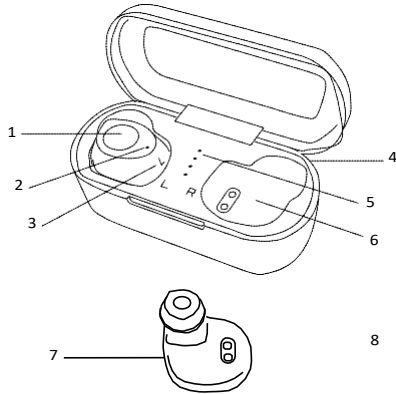

1. Control button
2. Earbud indication light
3. L/R mark
4. USB-C charging port
5. Battery indicator
6. Earbud charging dock
7. Microphone
8. Earbud charging connectors

Page 2

Pairing

1. Fully charge the earbuds before the first use.
2. Remove the earbuds from the charging case, the earbud indication light will flash red and blue.
3. Search for "DW-TWS350B" from the Bluetooth menu of your mobile device.
4. Once paired, the earbuds will connect to your paired device automatically when removing from the charging case.

Control Buttons

Left control button



Long press

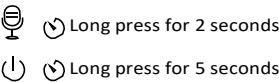

Right control button

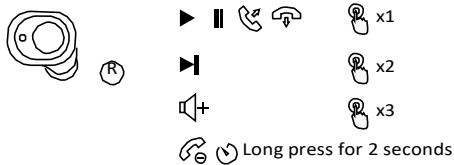

Page 3

Charging

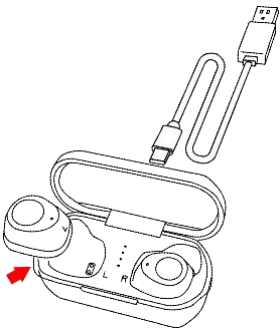

1. The earbuds indication light will flash red when battery is low.
2. To charge the earbuds, insert them into the charging case. Make sure to place the correct earbud in the corresponding dock.
3. Close the charging case cover to charge the earbuds. It takes around 1.5 hrs to fully charge the earbuds.
4. To charge the charging case, use the cable provided to connect it to a power source.
5. The battery indicator will show the progress during charge, all indicators will turn solid blue once fully charged.

⚠ WARNING: This device complies with Part 15 of the FCC Rules. Operation is subject to the following two conditions: (1) this device may not cause harmful interference, and (2) this device must accept any interference received, including interference that may cause undesired operation.

Page 4

Specifications

Model:	DW-TWS350B
Color:	Black
Bluetooth version:	5.1 JL
Driver size:	0.3 in (8 mm)
Music playtime:	Approx. 6-18 hrs with charging case
Earbuds charging time:	Approx. 1.5 hrs
Charging input:	5V 1A
Connection distance:	32.8 ft (10 m)
Impedance:	16Ω
Earbud dimension:	0.88 x 0.86 x 0.96 in
Charging case dimension:	2.83 x 1.30 x 1.30 in
Net weight:	1.57 oz

- * Specifications are subject to change without notice. Battery life and charge cycles vary by setting and the actual environment.
- * All pictures shown are for illustration purposes only. Actual products may vary due to product enhancement.

Get More Support

Scan the QR code below or email us at: contact@wasserstein-home.com



CONTACT US

Page 5

<p>NOTE: This equipment has been tested and found to comply with the limits for a Class B digital device, pursuant to part 15 of the FCC Rules. These limits are designed to provide reasonable protection against harmful interference in a residential installation. This equipment generates uses and can radiate radio frequency energy and, if not installed and used in accordance with the instructions, may cause harmful interference to radio communications. However, there is no guarantee that interference will not occur in a particular installation. If this equipment does cause harmful interference to radio or television reception, which can be determined by turning the equipment off and on, the user is encouraged to try to correct the interference by one or more of the following measures:</p> <p>Page 6</p>	<p>-Reorient or relocate the receiving antenna. - Increase the separation between the equipment and receiver. -Connect the equipment into an outlet on a circuit different from that to which thereceiver is connected. -Consult the dealer or an experienced radio/TV technician for help Changes or modifications not expressly approved by the party responsible for compliance could void the user's authority to operate the equipment.</p> <p>Page 7</p>	
--	--	--