

# Swap Pad

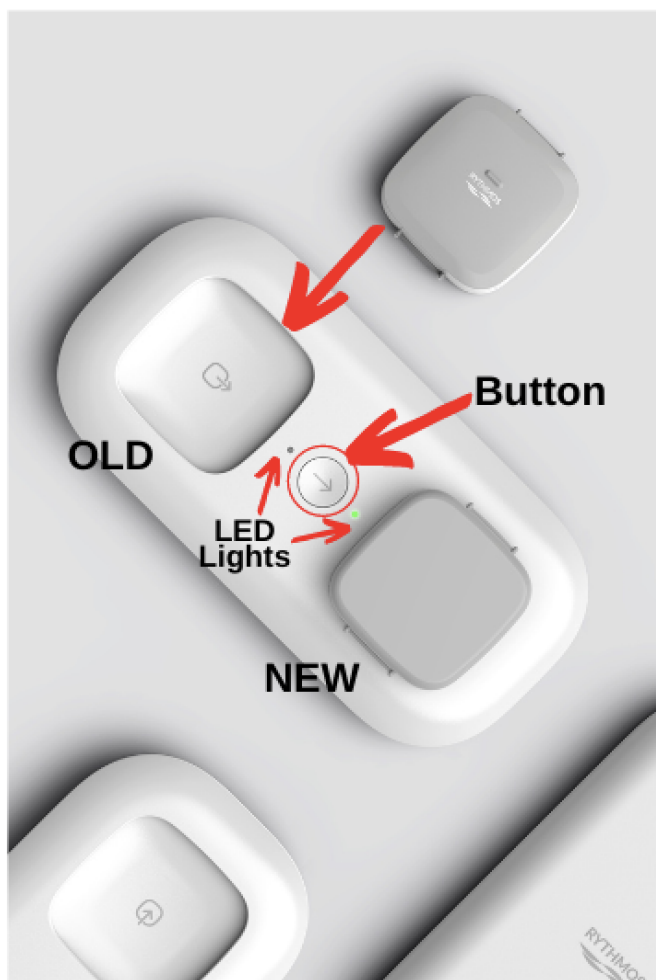

## How to Use the Swap Pad...

- 1** Read the instructions on the back of the Swap Pad.
- 2** Place the old and new wearable on the appropriate pad, button side down.
  - The LED's will turn blue when both wearables are correctly placed.
- 3** Press the center button.
  - The LED's will begin flashing in an alternating pattern to indicate a swap is in progress.
- 4** The LED's will blink green to indicate a successful swap, or red to indicate a failure.
  - If they blink red, check Rythmos. It may be a false negative.
  - Swap may take 1-2 minutes to complete.

This equipment complies with FCC radiation exposure limits set forth for an uncontrolled environment. A separation distance of 25 cm must be maintained between this device and nearby persons. This transmitter must not be co-located or operation in conjunction with any other antenna or transmitter. Maximum antenna gain of -1dBi. This device complies with part 15 of the FCC rules. Operation is subject to the following two conditions: (1) This device may not cause harmful interference, and (2) this devices must accept any interference received, including interference that may cause undesired operation. Caution: Changes or modifications not expressly approved by the party responsible for compliance could void the user's authority to operate this equipment.