

TCL

Air Purifier

USER MANUAL

Model: KJ200F-A4

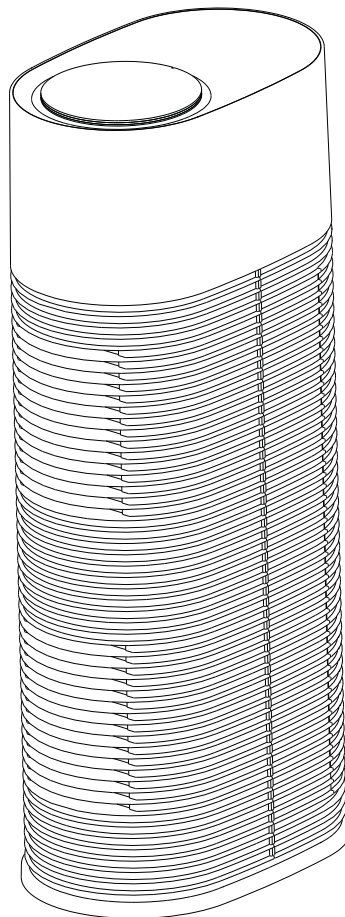

READ AND SAVE THESE INSTRUCTIONS

Safety precautions

Please be sure to follow

To avoid the harm or damage to property that may be caused to you and others, please be sure to follow the following safety precautions.



Warning

This sign indicates that "serious injury or death may be caused."



Notice

This sign indicates that personal injury or damage to other articles may be caused.

● The categories of contents that must be followed are distinguished and explained by signs as follows:



This sign indicates prohibited items.



This sign indicates mandatory items.



Warning



● **WARNING :** "To Reduce The Risk Of Fire Or Electric Shock, Do Not Use This Fan With Any Solid-State Speed Control Device.

● Caution: The user is cautioned that changes or modifications not expressly approved by the party responsible for compliance could void the user's authority to operate the equipment.

● This device complies with Part 15 of the FCC rules. Operation is subject to the following two conditions: (1) this device may not cause harmful interference, and (2) this device must accept any interference received, including interference that may cause undesired operation.

● **Do not touch the power plug with wet hand.**

(or it may cause electric shock)



● **Do not damage power cord or power plug**

● Do not cut, scratch, refit, excessively warp, pull, reverse and twist the power cord, or it may cause electric shock or fire accident.

● (If damaged, the power cord must be replaced by contacting the seller.)

● **Do not use the power, socket for connecting equipment exceeding equipment rated value and only use 120V 60Hz AC power.**

(Or it may cause short circuit or internal damage of power line and give rise to fire or electric shock accident.)

● **Do not allow children to operate the air purifier without adult supervision.**

(or it may cause electric shock or injury.)



● **It is forbidden to use chlorine or acid detergent.**

(The poisonous gas given out by detergent will do harm to health.)

● **It is forbidden to put the foreign objects into the air inlet, air outlet and other gaps.**

(Any contact with the interior of product may cause electric shock or injury.)

● **Please plug into the power socket entirely.**

If it is not plugged firmly, it may cause electric shock and even fire accident due to overheat.

Do not use the damaged plug or loosen power socket.

● **Please regularly clean the power plug.**

If there is dust on the power plug, the humidity may damage the insulated part of plug.

● Unplug the power plug and wipe with dry cloth.

● If the electric appliance is not used for a long time, unplug the power plug.

● **Before maintenance to electrical appliance, make sure of disconnecting power.**

(or the product may start suddenly and thus cause electric shock and injury.)

● **In case of any of following circumstances, please immediately turn off the power of machine.**

- If one switch does not work.
- If breaker works or fuse is burnt.
- If a burnt smell or unusual sound or vibration is felt.
- If there is any other abnormal phenomenon or fault.

● **If the power adapter of machine is damaged, please contact the seller**

● **This machine is not suitable for the disabled person, person with perceptual disturbance, person with intellectual disabilities or children to operate by their own.**

(It is exceptional if the machine is operated with the supervision and guidance of safety director.)

● **Children are not allowed to operate the air purifier arbitrarily.**

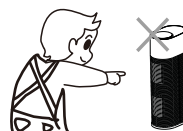

● **Do not expose machine body to wet conditions.**

Or it may cause fire and electric shock accident due to short circuit.



● **Do not disassemble or refit the air purifier arbitrarily.**

(Arbitrary disassembly or refitting may cause fault or fire accident.) In case of fault, (Please Contact the seller)



Notice



• Do not place the machine in following places:

- Unstable bearing surface (or the air purifier may be tipped over and fractured and cause personal injury and damage to substances.)
- Places with high temperature, high humidity or that may get the machine wet, such as bathroom (Air purifier may cause electric leakage and thus give rise to electric shock or fire accident)
- Kitchen and other places emitting cooking fumes.
- Place using oil or combustible gas and may cause leakage. (Fire or smoke may occur due to the ignition of oil or gas or suction of oil and combustible gas by machine)
- Please keep the product away from plants & animals.
- **Do not let volatile substance or combustible materials, such as cigarette or incense, etc. to enter the machine.** (Or it may cause fire accident)
- **Do not use ethyl alcohol or diluent or other solvent to clean the air purifier; meanwhile, avoid the surface of machine from contacting aerosol bomb.** (Air purifier may be fractured and damaged, even short circuit and thus give rise to electric shock or fire accident)
- **Do not use the air purifier in the room with incense insecticide.** (or the chemical residue may accumulate in the machine and release in the air through air outlet and thus do harm to the health.)
- After using insecticide in the room, open the window so that the room will be ventilated thoroughly and then the air purifier can be used.
- **Please do not sit on and lean on the product.** (Or it may cause equipment damage and personal injury.)
- **Prepare to move the air purifier**
Stop the operation of product, unplug the power plug.



- **NOTE:** This equipment has been tested and found to comply with the limits for a Class B digital device, pursuant to Part 15 of the FCC Rules. These limits are designed to provide reasonable protection against harmful interference in a residential installation. This equipment generates, uses and can radiate radio frequency energy and, if not installed and used in accordance with the instructions, may cause harmful interference to radio communications. However, there is no guarantee that interference will not occur in a particular installation.
- If this equipment does cause harmful interference to radio or television reception, which can be determined by turning the equipment off and on, the user is encouraged to try to correct the interference by one or more of the following measures:
 - Reorient or relocate the receiving antenna.
 - Increase the separation between the equipment and receiver.
 - Connect the equipment into an outlet on a circuit different from that to which the receiver is connected.
 - Consult the dealer or an experienced radio/TV technician for help.
- **FCC Radiation Exposure Statement**
- This equipment complies with FCC radiation exposure limits set forth for an uncontrolled environment. This equipment should be installed and operated with a minimum distance of 20cm between the radiator and your body.
- This transmitter must not be co-located or operating in conjunction with any other antenna or transmitter.



- **When plugging the power plug, please hold the square head part of plug by hand.** (Or it may cause damage of power adapter due to stress and thus give rise to electric shock, short circuit and fire.)
- **When using together with non-electric heater, please keep the air ventilating.**
- This product cannot eliminate CO (when the non-electric heater is operating, it will generate CO and other gases. If the air cannot be ventilated, it will result in poisoning)
- This appliance is not a substitute for proper ventilation, like regular vacuum cleaning, or use of an extractor hood or fan while cooking.
- The appliance does not remove Carbon Monoxide (CO) or Radon (Rn). It cannot be used as a safety device in case of accidents with combustion process and hazardous chemicals.

Operating requirements

- **Please do not use in following places.**
- The place with direct sunshine and directly facing air outlet and heating place, or it may cause deformation, deterioration, decoloration and fault of machine body.
- The place that curtain and other silk fabrics may shield the air outlet, or it may influence the accuracy of signal acquisition of sensor.
- Surrounding place of electrical equipment with high-intensity magnetic field and strong interaction.
- Do not use the extension socket with other electric appliance with strong electro-magnetic induction, or it may easily cause damage.
- Please do not place objects on the machine.
- Do not place magnet, metal objects and water glass on the machine (Metal and magnet may cause the malfunction of inductive switch and the water in the water glass may sprinkle and thus cause the damage to machine and electric shock.)
- **When used for a long time at the same place**
The surrounding wall and floor of product may be dirtied. please adjust the placing position when maintaining the product.
- When filtering pollen or indoor raise dust, please place the air purifier on the ground, pollen and dust easily gather at the bottom air of indoor due to the weight, it is, therefore, suggested that the product shall be placed on flat ground in the room.
- **To enhance the working efficiency of air purifier, circulate the air in the room effectively and purify.**
Please place the air purifier in the place when there is no screen 30cm at the front, rear, left and right and within the scope of 100cm on the top so that the air will be better circulated and air purifier will work more efficient.

Product introduction

This air Purifier can remove dust and fume powerfully. The places with much smoke, dust, pollen and other particle pollutants, such as indoor space, smoking zone, parlour etc. It will reduce the probability of being affected by passive smoking and protect you and your family's health.

This air Purifier has been equipped with Multifunctional filter, which can efficiently remove the particulate matter in the air and effectively eliminate PM 2.5-level particulate matter, formaldehyde and odour (smoke) to make the air you breathe clean and fresh.

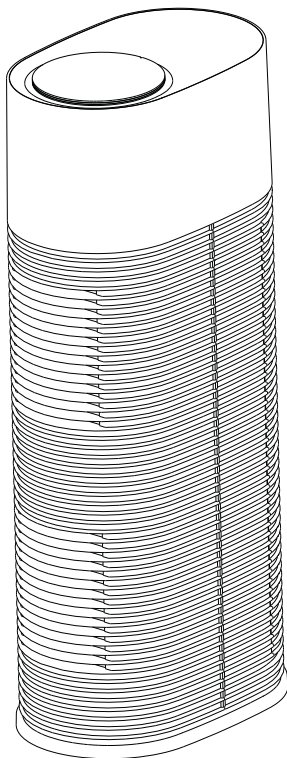

• Multifunctional filter

It can adsorb the smoke, pollen, dust and filter the bacteria in air. With anti-bacterial function, it can deeply clean the air and effectively remove PM 2.5. It can effectively remove the formaldehyde, TVOC, bad smell (smoke) in the air.

Component

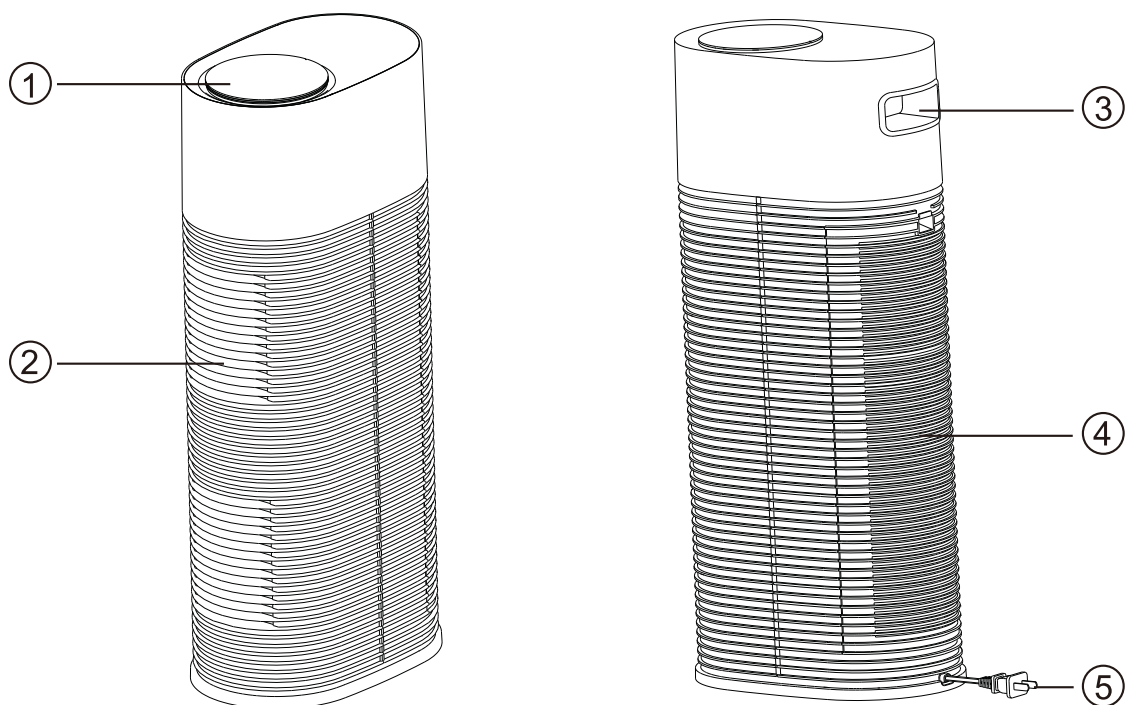

1. Operation panel

2. Air outlet

3. Handle

4. Air inlet

5. Power line

Preparation for use

Please be sure to follow

Preparation for starting up

Dismantle the multifunctional filter

- 1、 Press the clasp and open the back cover ;

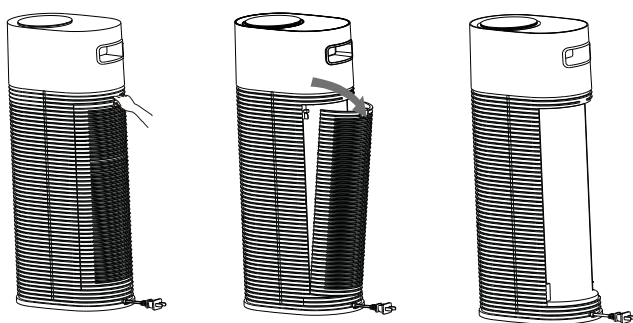

- 2、 Remove the strainer from the product ;

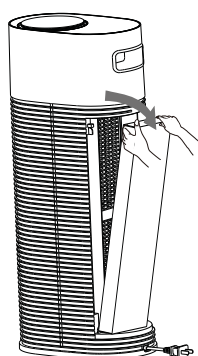

- 3、 Take out the multifunctional filter from the plastic bag.

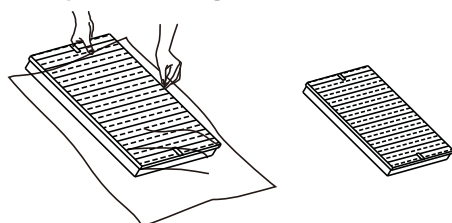

Since the multifunctional filter is a consumable . It is not involved in the warranty period of the whole machine . Please confirm that the multifunctional filter is in good condition before removing the protective bag.



Install the multifunctional filter

- 1、 Install the multifunctional filter ;
(The side with drawstring will face outward)

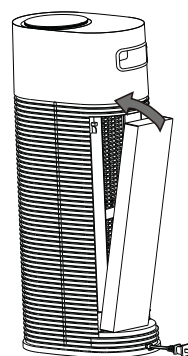

- 2、 Install the rear cover and press the buckle until you hear the "ba" sound to prove that the lock is locked.

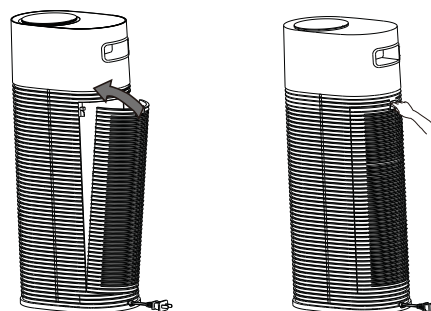

Please do not use the air purifier when all multifunctional filter have not be installed.



Preparation for use

Power on

Place the air purifier on a horizontal support and plug it into a power socket;

- Only use the product on 120V 60Hz socket.
- Before plugging in , please make sure that the hand and plug are dry. If the hand or plug is wet , please wipe the plug or hand and then plug into the power socket.
- After power on , the light on operation panel will flicker for one time , press the button for every time, there will be "Beep" prompt sound.

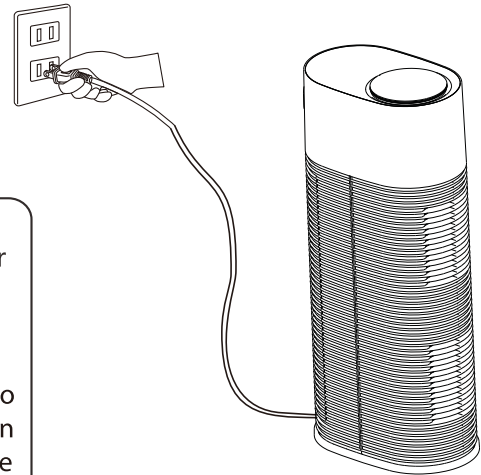

- Please close the door and window during use.
- If the air quality is not improved after the air purifier is operational for a long time , please open the door and window to keep air ventilation. (under extreme environment)
- Please place the air purifier in the place when there is no screen 30cm at the front, rear, left and right and within the scope of 100cm on the top so that the air will be better circulated and air purifier will work more efficient. Do not place anything on top of appliances and do not sit on the appliances.

Control panel

Operation panel

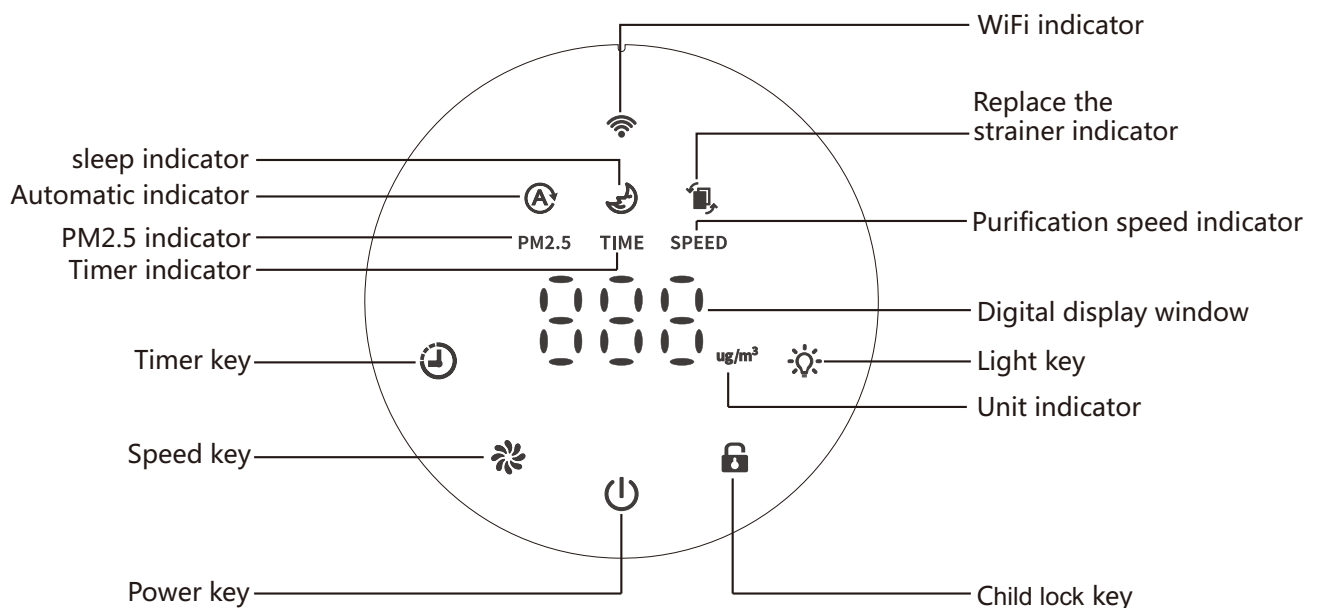

How to use

Starting up



Light on



Plug the power plug into socket and press the power key to start up.

- Under ready mode , press power key start machine , air purifier starts work and operates at auto speed , automatic light on and the air quality lights are red, green and blue;
 - During the first operation, the cleaning speed will be run according to the feedback of the internal dust detector. The digital tube displays the current PM2.5 value. The smaller the value, the better the air quality;
 - When on any working mode except "ready mode", press the key and air purifier will stop the present state to enter ready mode ;
- ※ Standby mode refers to the state when the power is switched on and not turned on.

Light



Light on



- In working mode , the user can press the light key to start or close the light function .

Wind speed setting



Light on



- In the power-on state, press the "Wind Speed" button, and the wind speed will be switched according to the cycle of automatic mode, 1, 2, 3 and sleep mode, at this point, the digital tube according to the set wind speed gear display the current wind speed;
- In the sleep mode, the indoor monitor feedback air quality, the air volume always meets the quiet effect during sleep, at this time, the key light is half on, other lights are all off .
- In the automatic or sleep mode, the purification speed does not need to be adjusted. If you want to change the air volume, please press the wind speed button to exit the automatic or sleep mode.

Timing



Light on



- During operating state , press the "Time" key to start timing shut down function . The time could be set as 1-2-3-4-12(h)-cancel the timing , the corresponding indicator light will be on.
- After setting the timing shut down , if pressing the "power" key, the timing setting will be cancelled and immediately enter off state.

Lock



Light on



- In working mode , the user can press the lock key for 3S, to start or close the lock function .

Multifunctional filter resetting





Light on



- The internal timer will calculate the accumulative operating time . When the filter light flashes, the buzzer rings five times (every time the machine starts) , it reminds the change of strainer (the time of timer is calculated based on simulation test in the laboratory, which may not be coincident with actual use . When the purification effect is getting poorer , please replace the strainer in advance.)
- After replacing the strainer , long press the "wind speed" key for 3S and the buzzer will sound and then the indicator light will be out.
- After the "Filter Replacement" indicator light flickers ,please replace the strainer timely .

Packing list

Packing position	Packaging of main engine			Remarks
Shape	Main engine 	Manual 		
Quantity	1	1		

Specification parameters

Model Name	KJ200F-A4
Rated voltage/Frequency	120V~ 60Hz
Rated power	50W
Applicable Area	≤24m ²

Maintenance

Maintenance precautions

- The power plug must be unplugged and power connection must be disconnected before maintenance.

Multifunctional filter

- Multifunctional filter cannot be washed by water.
- Multifunctional filter is consumable device , which is not involved in the warranty period.

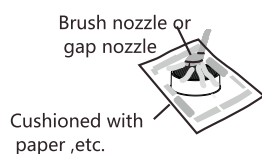

Wipe the machine body and operation panel with dry soft cloth.

Please do not use cloth in hard texture to wipe, or it will cause the surface damage.

Please use dry cloth to handle the power line so as to prevent the residual water on the plug surface from causing electric shock.

Please use neutral detergent and do not use cleaning powder, alkaline detergent thinner, bleaching agent, alcohol and gasoline to clean the machine body.

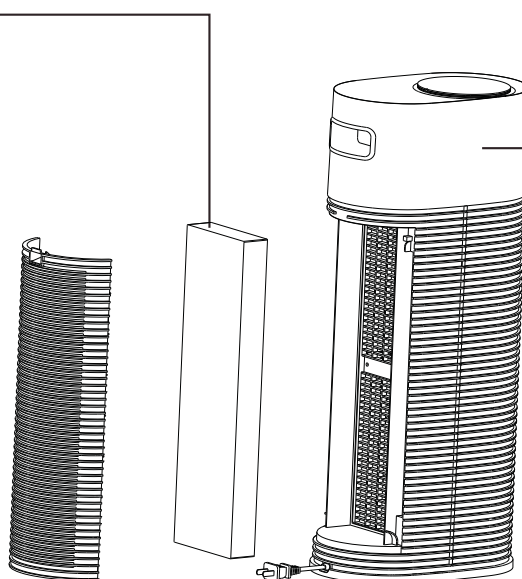

! Notes

- Please do not operate while dismantling the multifunctional filter. (It will lose the effect of dust removal and the inhaled dust may cause the sensor fault.)

Reference time of replacing multifunctional filter

Multifunctional filter	When the replace strainer indicator light flickers (about once every 3 to 6 months.)
Condition:The product should be operated 8 hrs/day and operating environment is ordinary.	
If the operating environment is heavily polluted , please shorten the change time according to practical situation.	

The replacement frequency of the multifunctional filter may vary , depending on actual usage and operating environment . please replace the multifunctional filter when the purification is not effective.

- After replacing the multifunctional filter press the wind speed key for 3s and the replace filter indicator light will be out , resetting is finished.
- Please handle the used multifunctional filter as non-combustible rubbish.

Troubleshooting

The problems that you may encounter when using the machine are listed below . If you are unable to solve the problem according to following information, please contact the customer care.

Problem	Possible solution
The filter indicator light flickers, and has not disappeared.	You have neglected the prompt of replacing strainer . When the filter indicator light started flickering , you failed to replace the strainer timely . You must replace the strainer and long press the wind speed key for 3s . After the resetting, the indicator light will be out .
There is no air at air outlet	The product is not connected to the power , please plug into the power socket to turn on the product .
Product has been operating for a long time , but the air quality is not improved significantly	Certain strainer may not be placed in the product , please make sure of installing strainer correctly in proper order. Start from the most inside strainer : multifunctional filter -- rear hood. The indoor humidity is too high , which has formed condensation. Please do not place the product in places with high humidity , such as bathroom , toilet . There is barrier surrounding the product , which has affected the purification effect. (Please refer to the contents in Notice) The room area where the product placed is too large. The recommended room area of this product is about 24m ²
There is dirt in the air which is hard to remove	Please check whether the HEPA multifunctional filter is dirty. If it is still not improved after maintenance, please replace the multifunctional filter.
The smell in the air is hard to remove	Whether the product is used in the place with strong smell ? If the product is used under cigarette and roast and other strong smells, it will generate odor in several weeks or months , please replace the multifunctional filter and keep ventilating frequently.

Correct Disposal of This Product



Waste electrical products should not be disposed of with household waste. Please recycle where facilities exist. Check with your Local Authority or retailer for recycling advice.

APP Networking operation guide

Step 1. Plug the power into the socket and the machine will go into standby mode, the wifi will automatically search for the connection, and the wifi indicator will flash; long press "wind speed" button 3S, and the buzzer will sound once to enter the state of distribution network.

- When entering the distribution network, WiFi indicator flashes rapidly;
When connected, WiFi indicator flashes slowly;
When the network configuration is completed, the WiFi indicator is always on.

※ If the network allocation is not successful within 3 minutes, the wifi indicator will go out.



Step 2. You can download the smart APP by scanning the qr code below through WeChat or other software, or search the APP Store and major android markets for "smart life" to download and install.



Step 3. Go to the home page and click Create a New account.

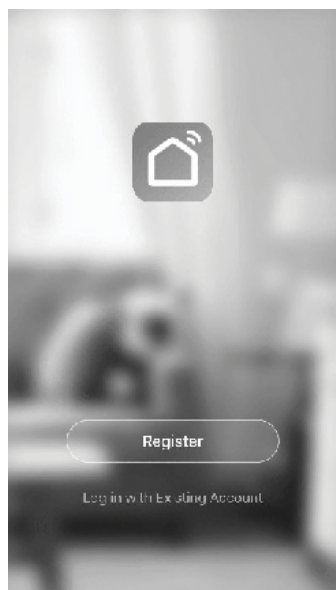

Step 4. Enter your phone number or email address to log in.

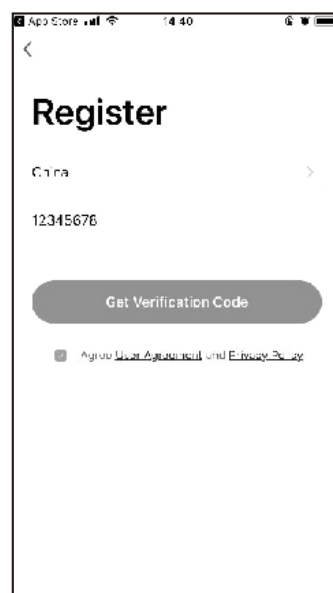

Step 5. Click "+" to add device.

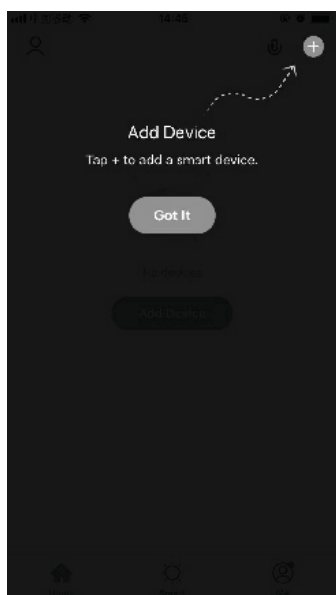

Step 6. Manual add device.

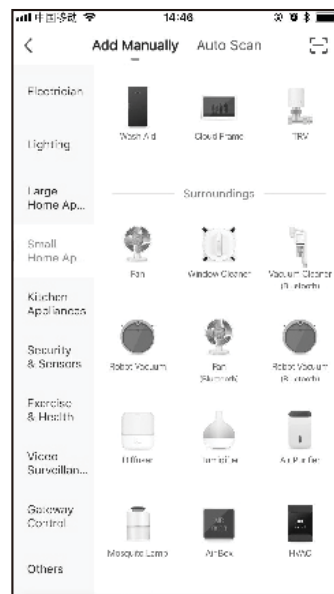

Step 7. Enter your WIFI password and click next.

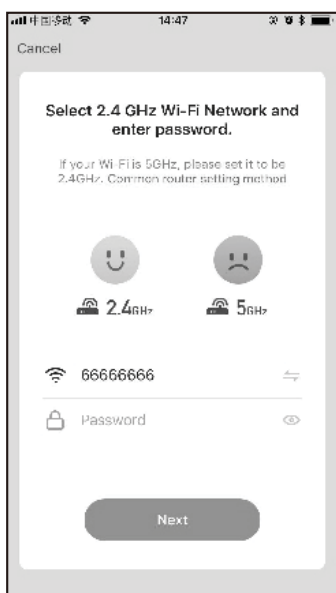

Step 8. Make sure the machine is powered on, confirm that the indicator light flashes, and click next.

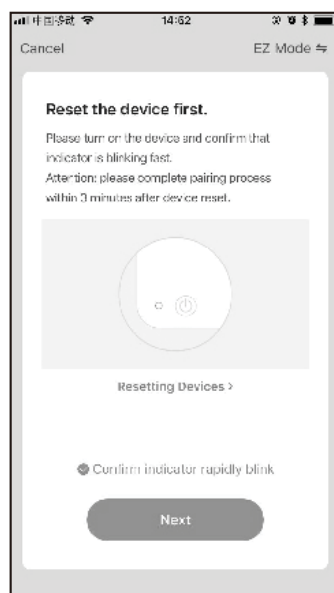

Step 9. Enter the device and router configuration interface.

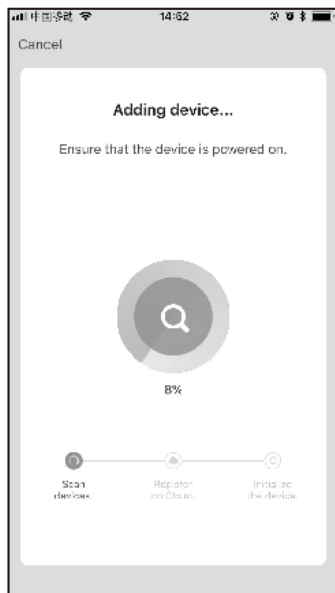

Step 10. After you find the device, click Finish.

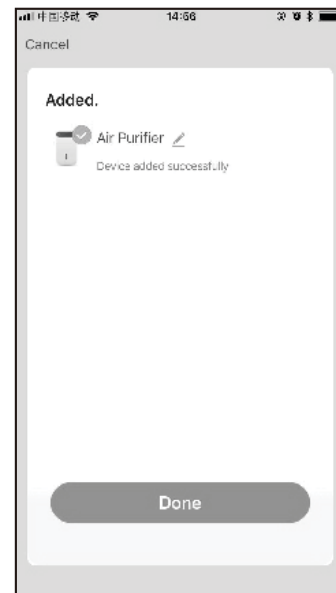

Step 11. Click the device and enter the device control page to operate the device.



TCL

Share TCL True HEPA Air Purifier, Share Purer Life