

# Quick Start Manual

## CONQUEST S20



www.conquest.net

### Description



- |   |                                |
|---|--------------------------------|
| 1.AI smart button<br>(Hands-free / Take photo)  | 11.Flash LED                   |
| 2.Fn button(Custom button)  | 12.Main rear camera            |
| 3.PTT walkie talkie button  | 13.Wide angle rear camera      |
| 4.Infrared remote module  | 14.Night vision lights         |
| 5.Front camera  | 15.IR night vision rear camera |
| 6.Type-C port   | 16.Macro rear camera           |
| 7.SIM card port   | 17.Fingerprint scanner         |
| 8.Volume + button   | 18.NFC area                    |
| 9.Volume - button   | 19.Wireless charging area      |
| 10.Power button<br>(Double click to enter the photo/<br>Power button & volume- quick<br>screenshot) | 20.Magnetic charging contacts  |

### Dual SIM Dual Standby

Dual + Standby, this means the phone supports dual SIM but in Standby mode. In simple words, when none of the SIM are used, then both the SIM's are active, but when you are using a particular SIM, the other SIM becomes inactive.

1. Dual SIM cards can't use voice services and data services at the same time.
2. In dual standby if a person is using SIM 1 and another person is calling on SIM 2, they will hear the message "Not reachable, try again later".
3. When one of the SIM cards uses data services, the data services of the other SIM card can't be accessed.

### Packing Include

CONQUEST S20 .....	1
Power adapter .....	1
Type-C data cable .....	1
Quick guide .....	1
Magnetic dock charger .....	1
Type-C to 3.5mm AUX adapter .....	1
Magnetic charging cable .....	1
Wireless charger .....	1
Waist clip .....	1
Lanyard .....	1

### Safety instructions

READ THIS INFORMATION BEFORE USING YOUR MOBILE DEVICE.

- 1.General Safety**
  - Please use the screen protector that does not block the light sensor to avoid affecting its normal use.
  - Please use the official original accessories to avoid damage to the phone.
  - Do not keep the magnetic stripe card with the mobile phone together for a long time, otherwise the magnetic stripe will out of action.
  - Do not expose your phone to strong sunlight to avoid damage due to overheat.
  - Do not connect with other Unauthorized equipment.
  - Do not disassemble the phone.
  - It is forbidden to put the mobile phone under high temperature or throw it into fire to avoid explosion.
- 2.Traffic Safety**
  - Please do not use the phones and follow the relevant traffic laws when driving.
  - Do not place the mobile phone above the car's airbag or inside the area covered by the airbag released.
  - Please comply with the relevant regulations of the airline. Do not use your phone in the area or during the time when it is forbidden. Please turn off your phone if necessary.
- 3.Medical safety**
  - The radio waves of mobile phones may affect some medical devices, such as pacemakers, cochlear implants, hearing aids, etc. The mobile phone and these medical devices should be kept at least 20 cm away. Feel free to consult the restrictions on the use of mobile phones with manufacturer when exception occurs.

### USE TIPS 1

Install SIM card quickly

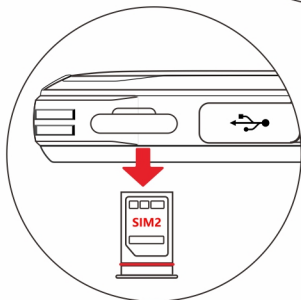
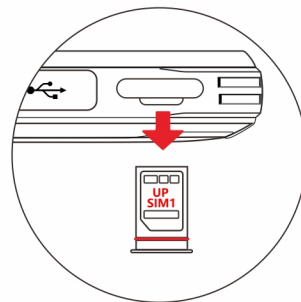

- 1.Take out the card tray directly
- 2.Place the SIM card securely in the SIM card tray.

**Note:** SIM1 is up, and SIM2 is down.

### USE TIPS 2

Before into the water

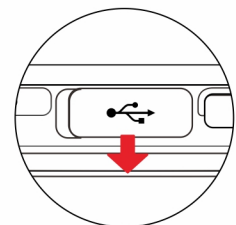

USB port should be firmly closed

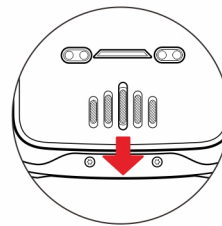

Keep the speaker completely dry

### WARNING

- 1.Before into the water, all ports and connections must be checked according to the above operations.
- 2.The phone's waterproof performance will be affected after a destructive fall.
- 3.Take the device out of the water, the speaker and receiver need to be completely dry before using, otherwise, it will affect the experience.

### THE BASICS OF TROUBLESHOOTING

Problem	Solution
Abnormal microphone/ Speaker/Receiver behavior post drop in water	Shake the phone dry to make sure the water is out of membrane.Use the hair dryer to quickly dry the excess water to restore the volume to normal.
App Crashes/Freezes/Unable to recharge/Restart frequently	Quick restart often solves minor issues with phone.On the right side of the phone you will find a power button.Restart the phone using that button.
Magnetic charger/Dock charger not working	Check the charger and the contact position for any signs of dirt or oxidation.A quick wipe with cotton swab and alcohol should solve the issue.
Abnormal power consumption	First, you should try to dim the screen brightness and turn off the GPS, WiFi and Bluetooth if you are not using them. Additionally, you should check your Battery Usage in your phone Settings and see which apps are using more battery. You can close or disable the ones that are draining more battery if you usually do not need them.
Unable to register the SIM card	If after proper installation of SIM card the phone doesn't recognize the network try switching the flight mode on-and-off or try restarting the phone.If the issue still persists clean the chip with alcohol and cotton swap.
MicroSD card does not work	Your microSD probably has errors and your phone is not recognizing that card. Try to connect a card reader to your PC and format the microSD card at least two times. Restart your mobile phone and insert the SD card again.
Mobile network not registering internet access	Go to settings-Network&internet-Mobile network-Mobile data-switch it on.Or slide the screen to shortcut menu-click the signal icon on upper right corner of the mobile data network- switch it on.
Restore to factory setting	Please note factory reset will erase all the data from the phone,so make sure you take the backup of data before you do a factory reset. Open settings-System-Advanced-Reset options-Erase all data (factory reset).

# CONQUEST



info@conquest.cn

#### **FCC Statement**

1. This device complies with Part 15 of the FCC Rules. Operation is subject to the following two conditions:

(1) This device may not cause harmful interference.

(2) This device must accept any interference received, including interference that may cause undesired operation.

2. Changes or modifications not expressly approved by the party responsible for compliance could void the user's authority to operate the equipment.

#### **NOTE:**

This equipment has been tested and found to comply with the limits for a Class B digital device, pursuant to Part 15 of the FCC Rules.

These limits are designed to provide reasonable protection against harmful interference in a residential installation.

This equipment generates uses and can radiate radio frequency energy and, if not installed and used in accordance with the instructions, may cause harmful interference to radio communications. However, there is no guarantee that interference will not occur in a particular installation. If this equipment does cause harmful interference to radio or television reception, which can be determined by turning the equipment off and on, the user is encouraged to try to correct the interference by one or more of the following measures:

Reorient or relocate the receiving antenna.

Increase the separation between the equipment and receiver.

Connect the equipment into an outlet on a circuit different from that to which the receiver is connected.

Consult the dealer or an experienced radio/TV technician for help.

#### **SAR Information Statement**

Your wireless phone is a radio transmitter and receiver. It is designed and manufactured not to exceed the emission limits for exposure to radiofrequency (RF) energy set by the Federal Communications Commission of the U.S. Government. These limits are part of comprehensive guidelines and establish permitted levels of RF energy for the general population. The guidelines are based on standards that were developed by independent scientific organizations through periodic and thorough evaluation of scientific studies. The standards include a substantial safety margin designed to assure the safety of all persons, regardless of age and health. The exposure standard for wireless mobile phones employs a unit of measurement known as the Specific Absorption Rate, or SAR. The SAR limit set by the FCC is 1.6 W/kg. \* Tests for SAR are conducted with the phone transmitting at its highest certified power level in all tested frequency bands. Although the SAR is determined at the highest certified power level, the actual SAR level of the phone while operating can be well below the maximum value. This is because the phone is designed to operate at multiple power levels so as to use only the power required to reach the network. In general, the closer you are to a wireless base station antenna, the lower the power output. Before a phone model is available for sale to the public, it must be tested and certified to the FCC that it does not exceed the limit established by the government adopted requirement for safe exposure. The tests are performed in positions and locations (e.g., at the ear and worn on the body) as required by the FCC for each model. The highest SAR value for this model phone when tested for use at the ear is **0.587W/Kg** and when worn on the body, as described in this user guide, is **0.775W/Kg**(Body-worn measurements differ among phone models, depending upon available accessories and FCC requirements). The maximum scaled SAR in hotspot mode is **0.775W/Kg**. While there may be differences between the SAR levels of various phones and at various positions, they all meet the government requirement for safe exposure. The FCC has granted an Equipment Authorization for this model phone with all reported SAR levels evaluated as in compliance with the FCC RFexposure guidelines. SAR information on this model phone is on file with the FCC and can be found under the Display Grant section of <http://www.fcc.gov/oet/fccid> after searching on FCC ID: **2AWTK-S20** Additional information on Specific Absorption Rates (SAR) can be found on the Cellular Telecommunications Industry Association (CTIA) web-site at <http://www.wow-com.com>. \* In the United States and Canada, the SAR limit for mobile phones used by the public is 1.6 watts/kg (W/kg) averaged over one gram of tissue. The standard incorporates a substantial margin of safety to give additional protection for the public and to account for any variations in measurements.

**Body-worn Operation**

This device was tested for typical body-worn operations. To comply with RF exposure requirements, a minimum separation distance of 10mm must be maintained between the user's body and the handset, including the antenna. Third-party belt-clips, holsters, and similar accessories used by this device should not contain any metallic components. Body-worn accessories that do not meet these requirements may not comply with RF exposure requirements and should be avoided. Use only the supplied or an approved antenna.