

52.0401.0122 30W YST-C款,遥控智能灯串-英文版说明书 YST-Novostella定制V1.1
尺寸: 100*142mm 材质: 铜版纸 装订: 骑马钉装订 印刷: 四色印刷

novostella

Smart Multicolor String Light User Guide



iOS



Android

Download "Smart Life" app for free

Contact Us

Have some issue? No worries! Please reach us via these channels.
Our customer services team is more than happy to help.



support@novostella.net



www.novostella.net



We are social. Get connected!



@Novostella_US



@novostella_official



@novostella_official



fb.com/novostella.fans



@Novostella_official

Smart Multicolor String Light User Guide

Before installation, let's know how the whole thing works.

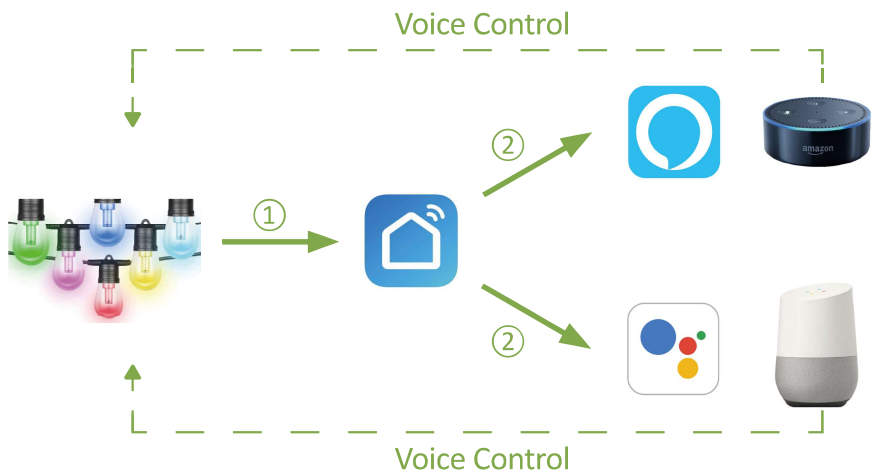

Step 1: Install the string light

Step2: Fundamental Set Up- Connect smart string light to 'Smart Life' App.

Step 3 & 4: Optional Set Up – Connect 'Smart Life' app to Alexa or Google Assistant.

After completing Step Two, you can remote control the light on Smart Life App.

After completing Step Three and Four, you can voice control the light with Alexa or Google Assistant. This manual consists of Four parts.

Part One - How to install the light ?3 - 12

Part Two - How to pair the light to Smart Life app?13 - 16

Part Three — How to control the light with Amazon Alexa?17 - 19

Part Four — How to control the light with Google Assistant? 20 - 21

Part One - How to install the light?

Warning

- (1) Please check if the light and the parts are intact before installation.
- (2) Make sure to cut off power before installation.
- (3) Please do not place this light in corrosive conditions.
- (4) If there is any damage to the cord, please cut off the power and stop using it immediately.
- (5) Please do not retrofit the light within the warranty period.

1. Product Information

Model	NVS14-RGBCW-US-F30	NVS14-RGBCW-US-F60
Power Supply	100-240V AC	100-240V AC
Frequency	50/60 Hz	50/60 Hz
Power Adapter	12V=3A	12V=3A
Wattage	20W	40W
Number of Lights	30	60
Color	RGBCW	RGBCW
Luminous Flux	400 lm	700 lm
Protection Rating	IP65	IP65
Ta	40°C	40°C
Battery (for Remote)	CR2025	CR2025

2. Components

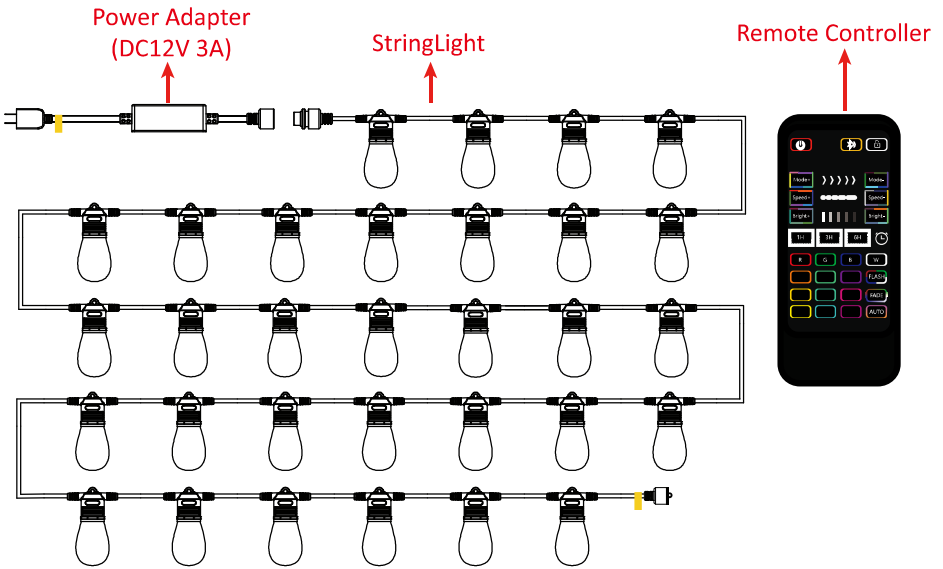

Package List

String Light	1 PC
Power Adapter	1 PC
Remote Controller	1 PC
User Manual	1 PC
Cable Ties	30/ 60 PCS

3. Dimension

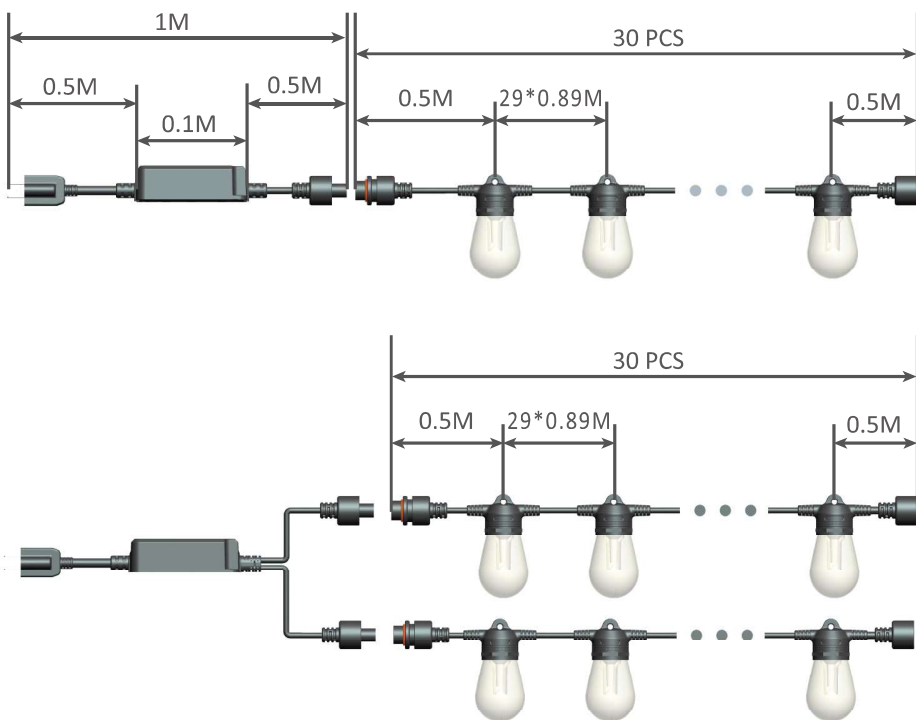

Note:

1. The string light cannot be extended. Please do not cut the cable.
2. Use this product with the provided power adapter only.
3. The power plug cannot be directly used outdoor. Please connect to a indoor socket, or use a waterproof box.

4. Installation

Step 1: Connect the string lights and power adapter.

(If not smooth when plug in, please adjust the angle to make sure the plug and jack match exactly as the picture below)

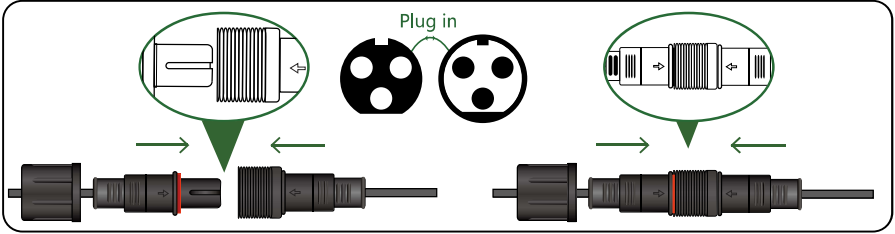

Step 2: Firmly screw the waterproof bolt.

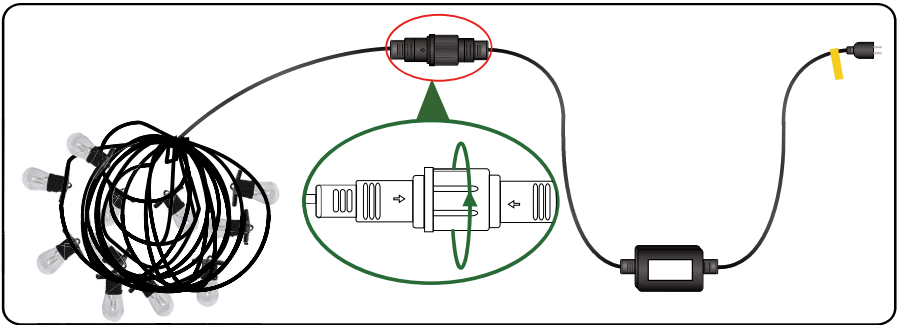

Step 3: Plug and play (AC 100-240V).

Warning: Plug the sting lights into the socket after installation is complete.

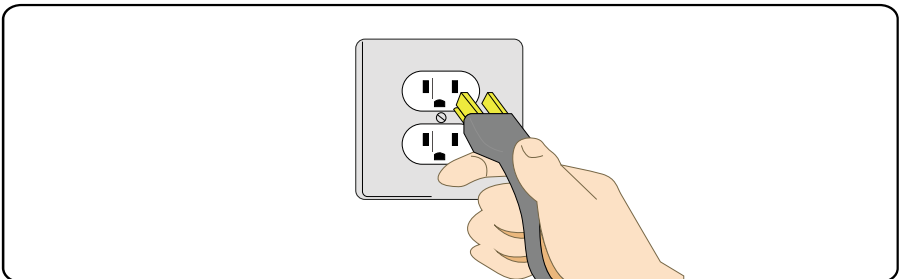

5. Remote controller

You can control the lights by the remote controller once powered on.

If the lights flash in red light, it's pairing mode. You can pair the Smart Life app with your lights or wait around 3 minutes until the pairing mode fade away.

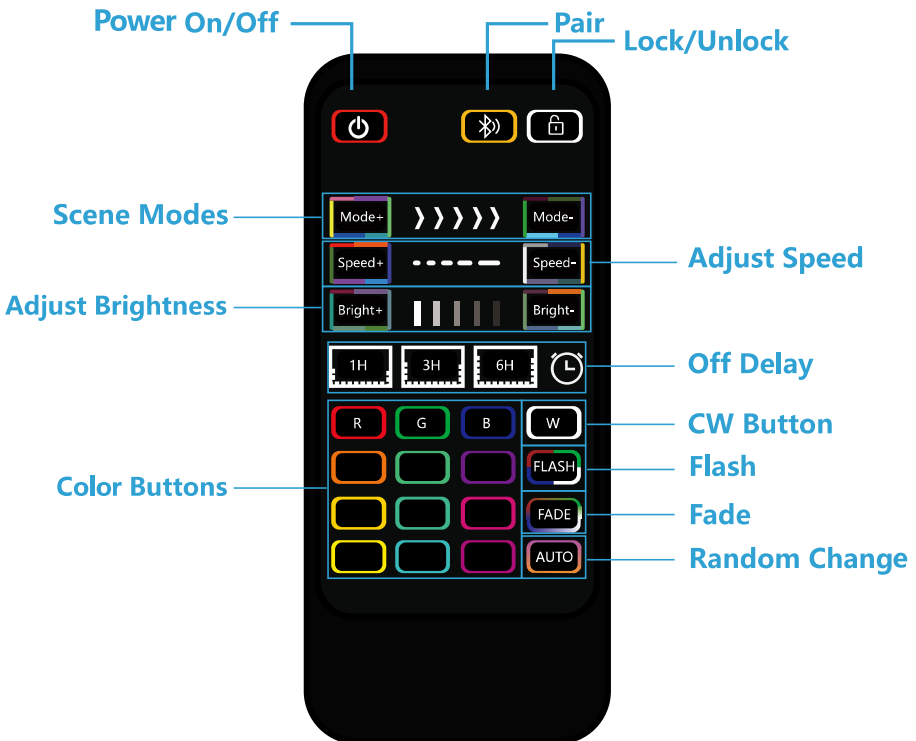

Buttons	Function
Power On/Off	Press to turn the string light on/off.
Pair	Long press the button for more than 10 seconds till the lights enter pairing mode with red light flashes.
Lock/Unlock	Short press to disable all the buttons with the lights flash one time or enable all the buttons with the lights flash two times.
Scene Modes	Press MODE+or MODE-button to change the modes.
Adjust Speed	Press the button to speed up or slow down the lighting effect among 5 levels.
Adjust Brightness	Press to adjust the light brightness among 8 levels.
Off Delay	Press in and the string light will be automatically turned off 1 or 3 or 6 hours later.
Color Buttons	Press to change the color.
CW Button	Press to switch color between warm yellow, warm white, nature white and cool white.
Flash	Press to flash the string light.
Fade	Press to fade the string light.
Random Change	Press to change the color automatically and randomly.

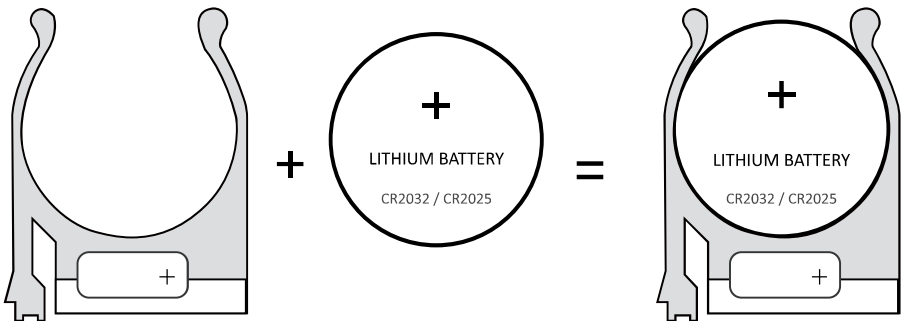

6. Pairing Mode

Method 1: Press and hold “Pair”  button on the remote controller for about 10 seconds until the string lights flash with red light, this means that the string lights have successfully entered the pairing mode. In this mode, you can connect the app with lights.

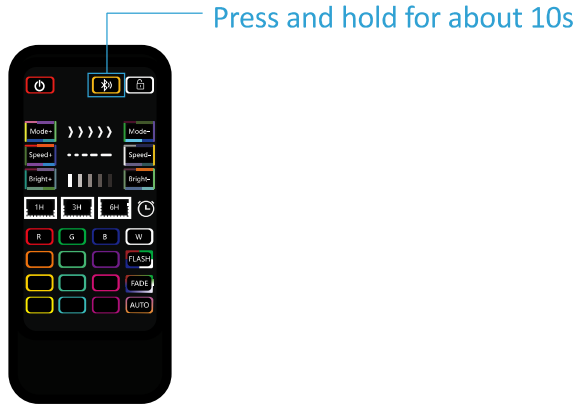

Method 2: Continuously switch the power supply more than 3 times until the string lights flash with red light.

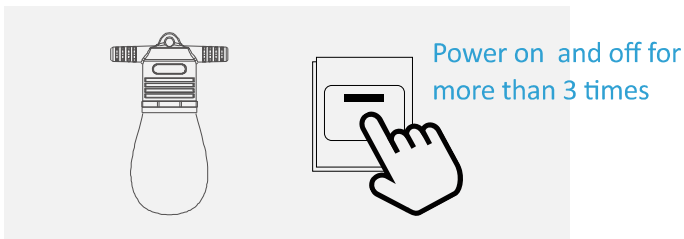

(Note: The pairing mode will last for 3 minutes, you need to complete the relevant settings before the red light stops flashing. If it fails to complete, please repeat the previous step.)

7. Coding and Decoding

Please note that the code matching and decoding of remote controller could only be done **within 1 minute** of powering on the string light.

A. Code Matching: Press and hold “1H” and “W” at the same time, the string lights will flash **once with blue color**, marks that the remote controller and the string lights have completed the matching process.

Why do we need code matching?

To make the string light not controlled by other remote controllers that have not paired with it. This can effectively reduce the signal interference, especially when there are multiple devices in the same place. Actually every product has completed the matching process before delivery.

B. Decoding: Press and hold “1H” and “W” at the same time, the string lights will flash **twice with blue color**, marks that the remote controller and the string lights have completed the decoding process.

Why do we need decoding?

Make the string lights can be controlled by all remote controllers without pairing. This helps you when you want to control multiple devices with the same remote.

Wireless Control Specification:

Wireless Frequency Range: 2.412-2.472 GHz

Wireless Communications Protocol: IEEE 802.11b/g/n

Wireless Conducted Power: 13-16 dBm

FCC ID: 2AWON-S14-WF01 (WiFi Receiver)

FCC ID: 2AWON-S14-RF01 (Remote Controller)

Federal Communication Commission(FCC)Statement for Users Warning:

Changes or modifications not expressly approved by the party responsible for compliance could void the user's authority to operate the equipment.

This device complies with part 15 of the FCC Rules.

Operation is subject to the following two conditions:

- (1) This device may not cause harmful interference, and
- (2) this device must accept any interference received, including interference that may cause undesired operation.

This equipment complies with FCC radiation exposure limits set forth for an uncontrolled environment.

NOTE: This equipment has been tested and found to comply with the limits for a Class B digital device, pursuant to part 15 of the FCC Rules.

These limits are designed to provide reasonable protection against harmful interference in a residential installation. This equipment generates, uses and can radiate radio frequency energy and, if not installed and used in accordance with the instructions, may cause harmful interference to radio communications. However, there is no guarantee that interference will not occur in a particular installation. If this equipment does cause harmful interference to radio or television reception, which can be determined by turning the equipment off and on, the user is encouraged to try to correct the interference by one or more of the following measures:

- Reorient or relocate the receiving antenna.
- Increase the separation between the equipment and receiver.
- Connect the equipment into an outlet on a circuit different from that to which the receiver is connected.
- Consult the dealer or an experienced radio/TV technician for help.

Important notes before starting :

- Please make sure the WiFi signal is strong enough. The WiFi signal receiving module is built into the power adapter. The distance between the power adapter and your WiFi router should be less than 65ft/20m.



- Before pairing, please turn on the Bluetooth and WiFi on your phone.
- It supports 2.4GHz WiFi network only. If your WiFi router supports both 2.4GHz and 5.0GHz, please separate the two frequency bands in the router settings and select the 2.4GHz.

Part Two - How to pair the light to Smart Life app?



Step A : Smart Life app installation.

Please choose either way below to download and install the app.

(1) As per your phone system, choose the QR code to scan.



iOS



Android

(2) Search keyword 'Smart Life' in App Store or Google Play.

Step B: Create an account on Smart Life and login.

Note: Please keep your account and password in mind for Alexa or Google Assistant App pairing later.

Step C: Set the light string to 'Pairing Mode'. (Check '*6. Pairing Mode' for details.)

Step D: Turn on the WLAN(2.4GHz WiFi), Bluetooth and Airdrop or Location function on your mobile phone.

(Note: not compatible with 5Ghz WiFi)



Step E: Open the 'Smart Life' app & complete the device adding process step by step.

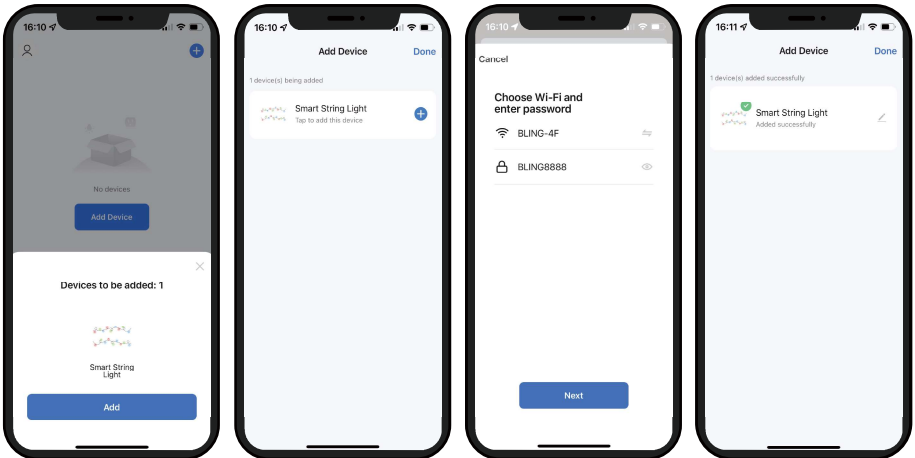

Step E: Now you can control the string light by 'Smart Life' app.

Main Interface

Power ON/OFF
Timer
Schedule

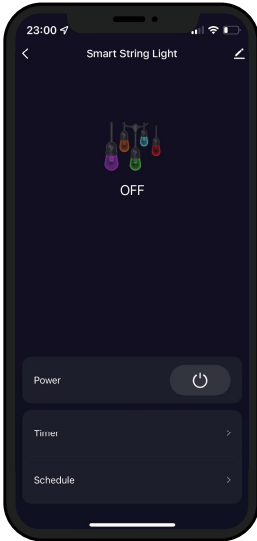

Scene Mode

15 scenes mode switching
for one-click

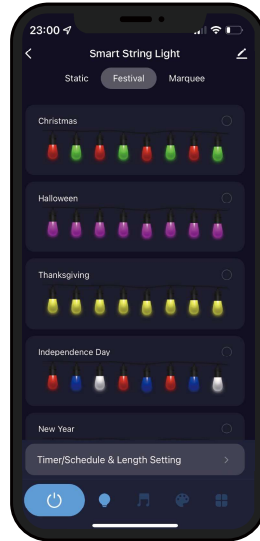

Custom Mode

Up to 8 custom scenes can be saved.

The color, mode and brightness of each bulb can be set individually.

Click “Preview” to preview the current effect.

Click “+ Save Scene”, go back to the “Scene Mode” module and you will find “Customize” at the top of the interface.

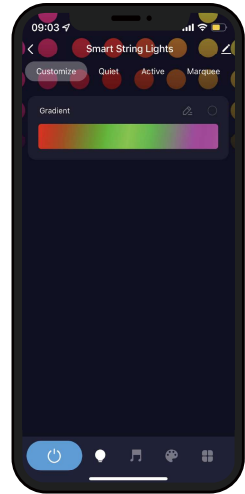
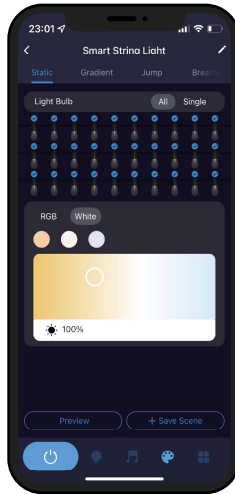
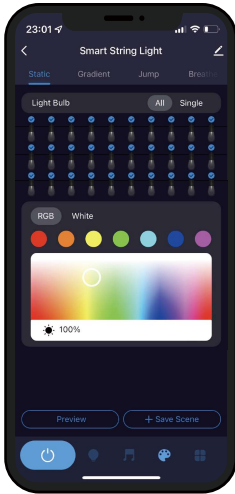

Music Mode

Randomly switch colors according to the rhythm of the music.

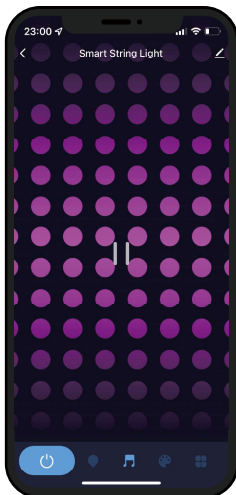

Settings

Timer / Schedule / Length setting

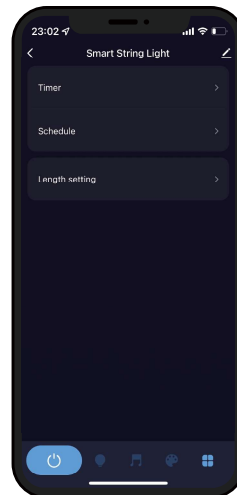

Part Three — How to control the light with Amazon Alexa?



Please make sure that your Alexa app is connected to Echo, and both work well under your WiFi network.

Step A: Log in your Alexa App, tap top left corner, and tap 'Skills'.

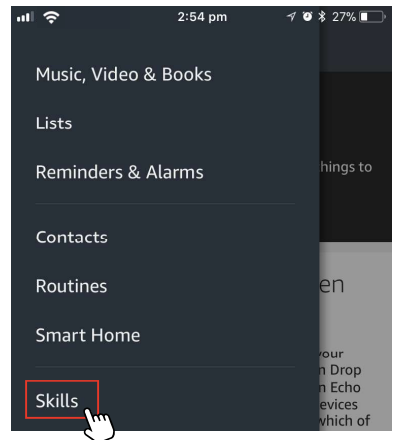
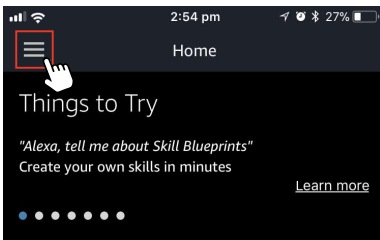

Your Alexa settings have been updated

Household Drop In was enabled from one of your Echo devices or from the Alexa app. The opt-in Drop In feature lets you automatically connect to an Echo device for a voice or a video chat. Your Echo devices with a screen and the Alexa app will indicate which of

Step B : Type 'Smart Life', find 'Smart Life' from the search result and tap it to enable the skill.

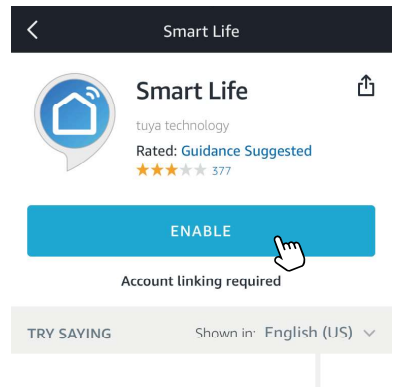
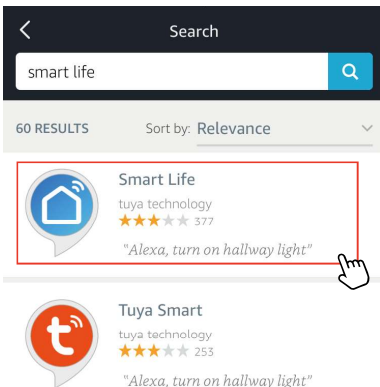

Step C: Enter your Smart Life App account and password. Tap 'Link Now', then tap 'Authorize' on the next page to bind Smart Life account to Alexa.

Step D : When your Smart Life account is bound to Alexa, tap 'DISCOVER DEVICES' to detect the light.

Step C

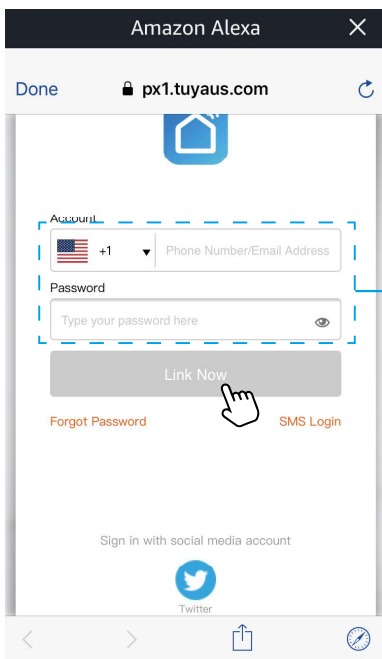

Same account and password
as Smart Life App

Step D

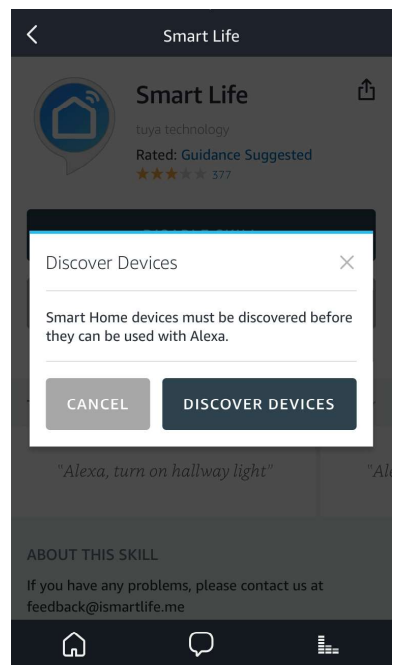

Step E : When the named light is paired to Alexa from Smart Life, it will show on the device page (see the 'smart light' example).

Step F: Now you can control the light with Alexa App on the setting page. To turn on or off the light, simply tap the bulb icon.

Step G : You can also voice control the light with Alexa by giving these commands: “Alexa, turn on ‘device name’”, “Alexa, set ‘device name’ to ‘color’”, “Alexa, set ‘device name’ to ‘number’”. Device name is the one you give to the light. The light is named ‘smart light’ in this user guide. For example, “Alexa, turn on ‘smart light’”, “Alexa, set ‘smart light’ to ‘blue’” etc.

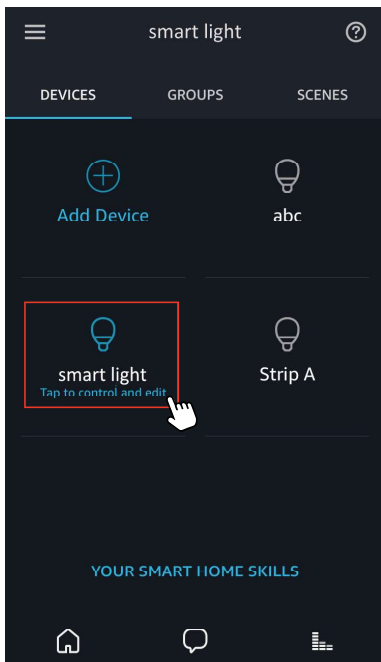

Note: To control the light with Google Assistant, please continue to read Part Four.

Part Four — How to control the light with Google Assistant?

Step A: Login Google Assistant App, tap 'Home Control' on the left side bar page.

Step B : Tap '+' button on the bottom right to enter next page.

Step C: Find 'Smart Life' from side bar list.

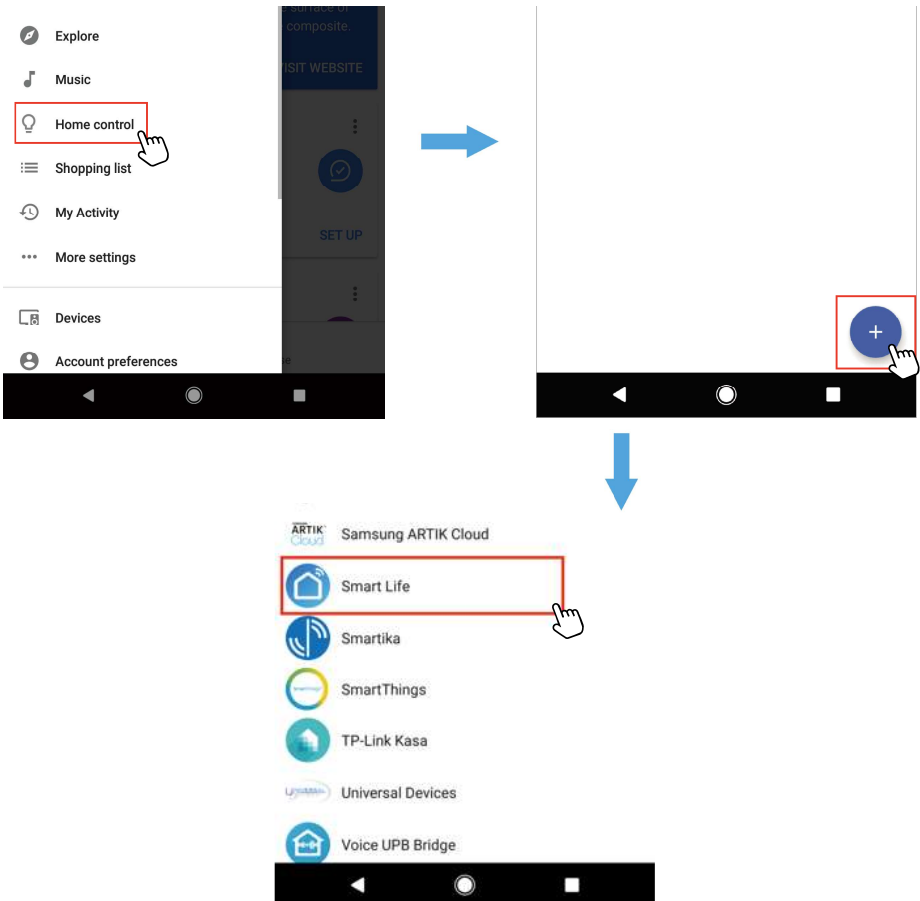

Step D: Enter your Smart Life App account and password to bind Smart Life account to Google Assistant.

Step E : You will find the named light shows on the Home Control page. Now you can control the light on Google Assistant App, or voice control it by giving these commands: “ok Google, turn on ‘device name’”, “ ok Google, set ‘device name’ ‘to color’”, “ ok Google, set ‘device name’ to ‘number’”.

Device name is the one you give to the light. The light is named ‘smart light’ in this user guide. For example, “ok Google, turn on ‘smart light’”, “ok Google, set ‘smart light’ to ‘blue’” etc.

Step D



Same account and password as Smart Life App

Step E

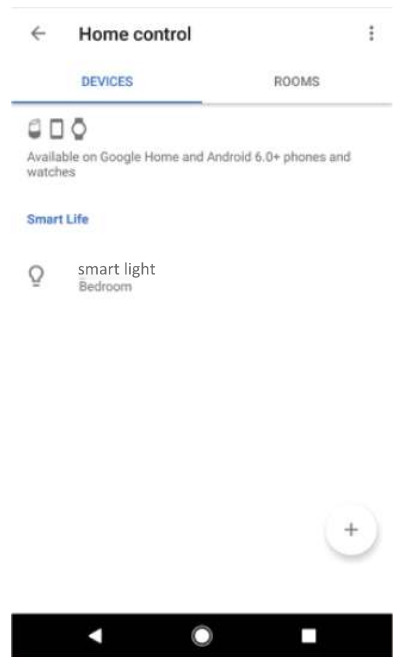



Manufacturer: Shenzhen Ustellar Technology Ltd
(shen zhen shi you shi tuo ke ji you xian gong si)
Address: 308A, 3/F, Building A, Youth Entrepreneur Hub, Jianshe East Road,
Qinghua Community, Longhua Street, Longhua District, Shenzhen, CHINA 518000

FCC Notice:

This equipment complies with FCC radiation exposure limits set forth for an uncontrolled environment. This equipment should be installed and operated with minimum distance 20cm between the radiator and your body.

-FCCID: 2AWON-S14-WF01

The device has been evaluated to meet general RF exposure requirement.

The device can be used in portable exposure condition without restriction.

-FCCID: 2AWON-S14-RF01

novostella

E-manual



Step 1: Scan the QR code

Step 2: Click E-manual PDF file

Step 3: Read file online or download



Go paper-free, make life easier, and do something good for the environment.



FC RoHS CE



MADE IN CHINA