

novostella

Permanent Outdoor Lights User Guide



iOS



Android

Download "Smart Life" app for free

Contact Us

Have some issue? No worries! Please reach us via these channels.
Our customer services team is more than happy to help.



support@novostella.net



www.novostella.net



We are social. Get connected!



@Novostella_US



@novostella_official



@novostella_official



fb.com/novostella.fans



@Novostella_official

Permanent Outdoor Lights User Guide

Before installation, let's know how the whole thing works.

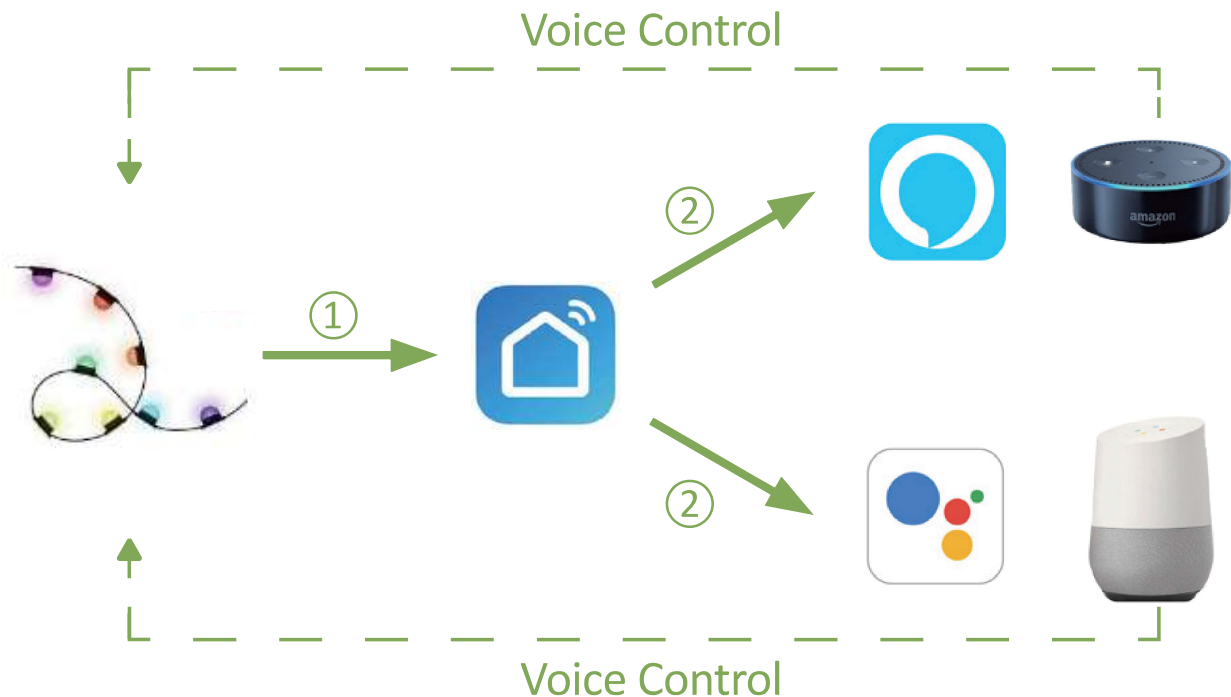

Step 1: Install the string light

Step2: Fundamental Set Up- Connect smart string light to 'Smart Life' App.

Step 3 & 4: Optional Set Up – Connect 'Smart Life' app to Alexa or Google Assistant.

After completing Step Two, you can remote control the light on Smart Life App.

After completing Step Three and Four, you can voice control the light with Alexa or Google Assistant. This manual consists of Four parts.

Part One - How to install the light ?	3 - 9
Part Two - How to pair the light to Smart Life app?	10 - 13
Part Three - How to control the light with Amazon Alexa?	14 - 16
Part Four - How to control the light with Google Assistant?	17 - 18

Part One - How to install the light?

Warning

- (1) Please check if the light and the parts are intact before installation.
- (2) Make sure to cut off power before installation.
- (3) Please do not place this light in corrosive conditions.
- (4) If there is any damage to the cord, please cut off the power and stop using it immediately.
- (5) Please do not retrofit the light within the warranty period.

1. Product Information

Model	NVS50-RGBIC-US-F	NVS100-RGBIC-US-F	NVS150-RGBIC-US-F
Power Supply	100-240V AC	100-240V AC	100-240V AC
Frequency	50/60 Hz	50/60 Hz	50/60 Hz
Power Adapter	24V \Rightarrow 1A	24V \Rightarrow 1.75A	24V \Rightarrow 3A
Wattage	21W	39W	60W
Number of Lights	40	80	80
Color	RGB Rainbow	RGB Rainbow	RGB Rainbow
Luminous Flux	200lm	400lm	600lm
Protection Rating	IP65	IP65	IP65
Ta	40°C	40°C	40°C
Battery (for Remote)	AAA*2	AAA*2	AAA*2

2. Components

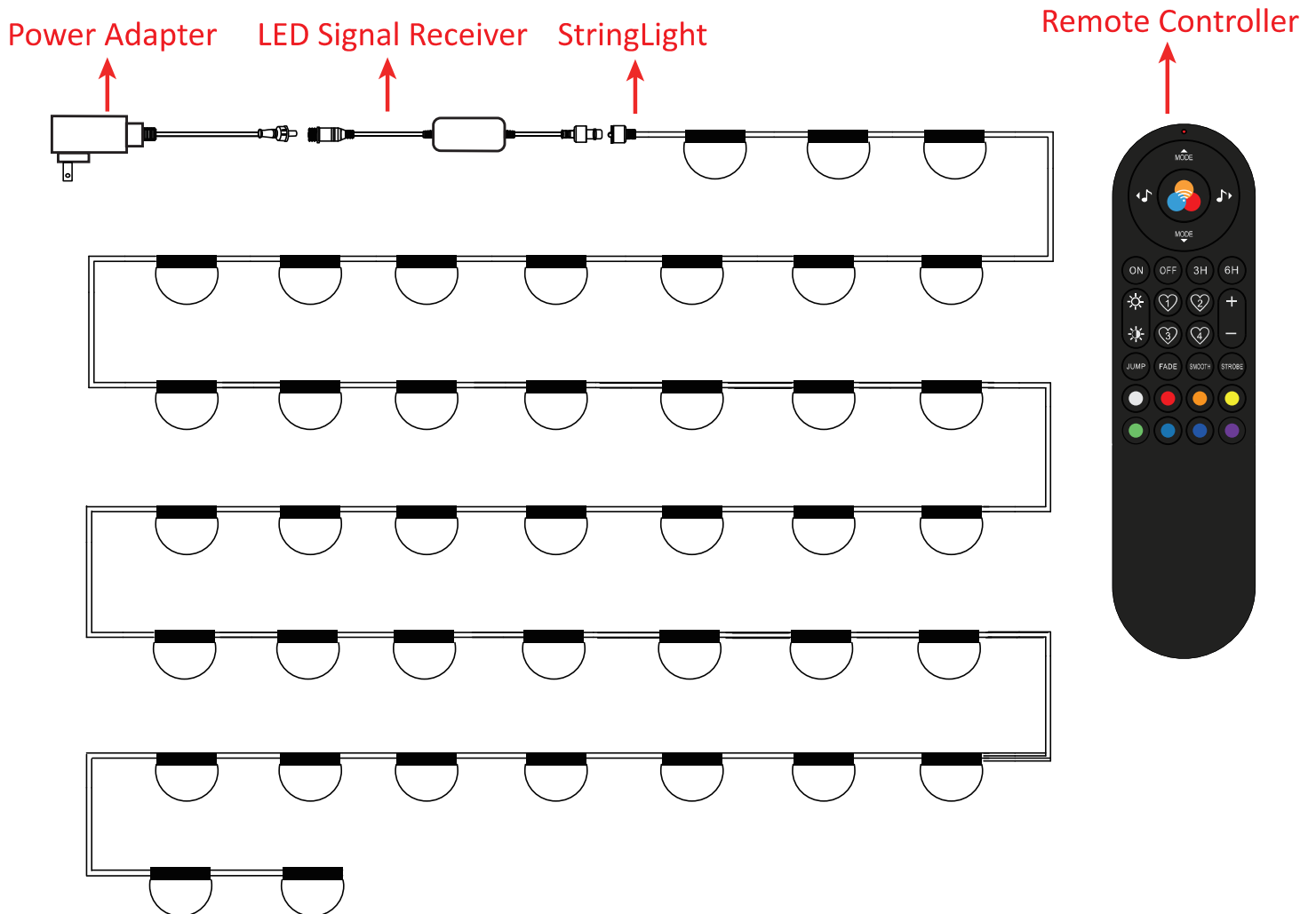

Package List

String Light	1 PC
Power Adapter	1 PC
Remote Controller	1 PC
User Manual	1 PC
Installation Bracket	40/80 PCS

3. Dimension

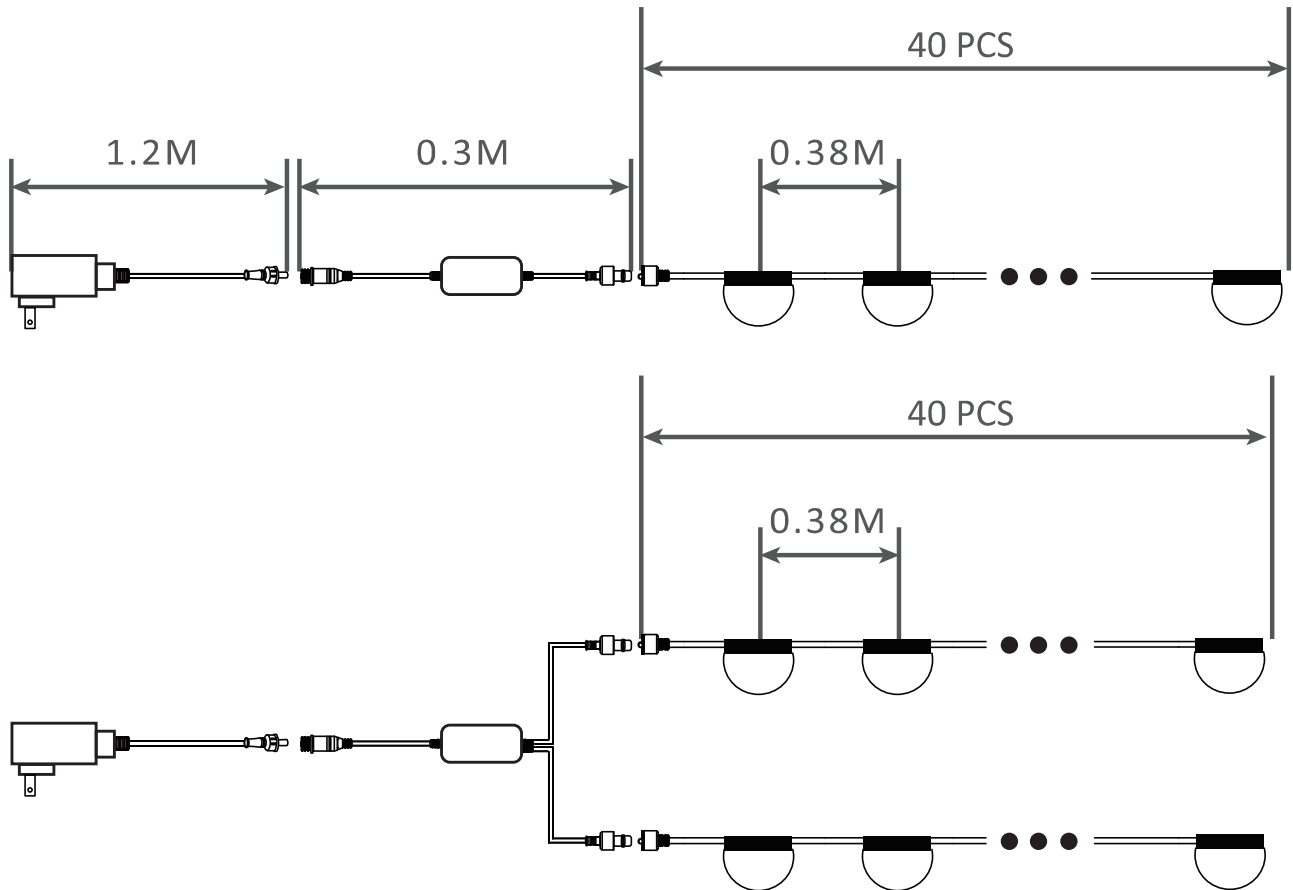

Note:

1. The string light cannot be extended. Please do not cut the cable.
2. Use this product with the provided power adapter only.
3. The power plug cannot be directly used outdoor. Please connect to a indoor socket, or use a waterproof box.

4. Installation

Step 1: Connect the string lights and power adapter.

(If not smooth when plug in , please adjust the angle to make sure the plug and jack match exactly as the picture below)

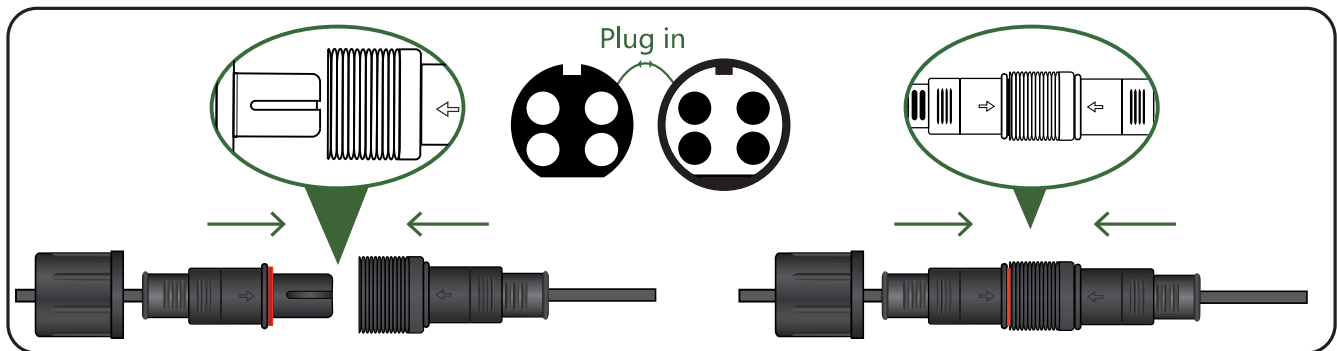

Step 2: Firmly screw the waterproof bolt.

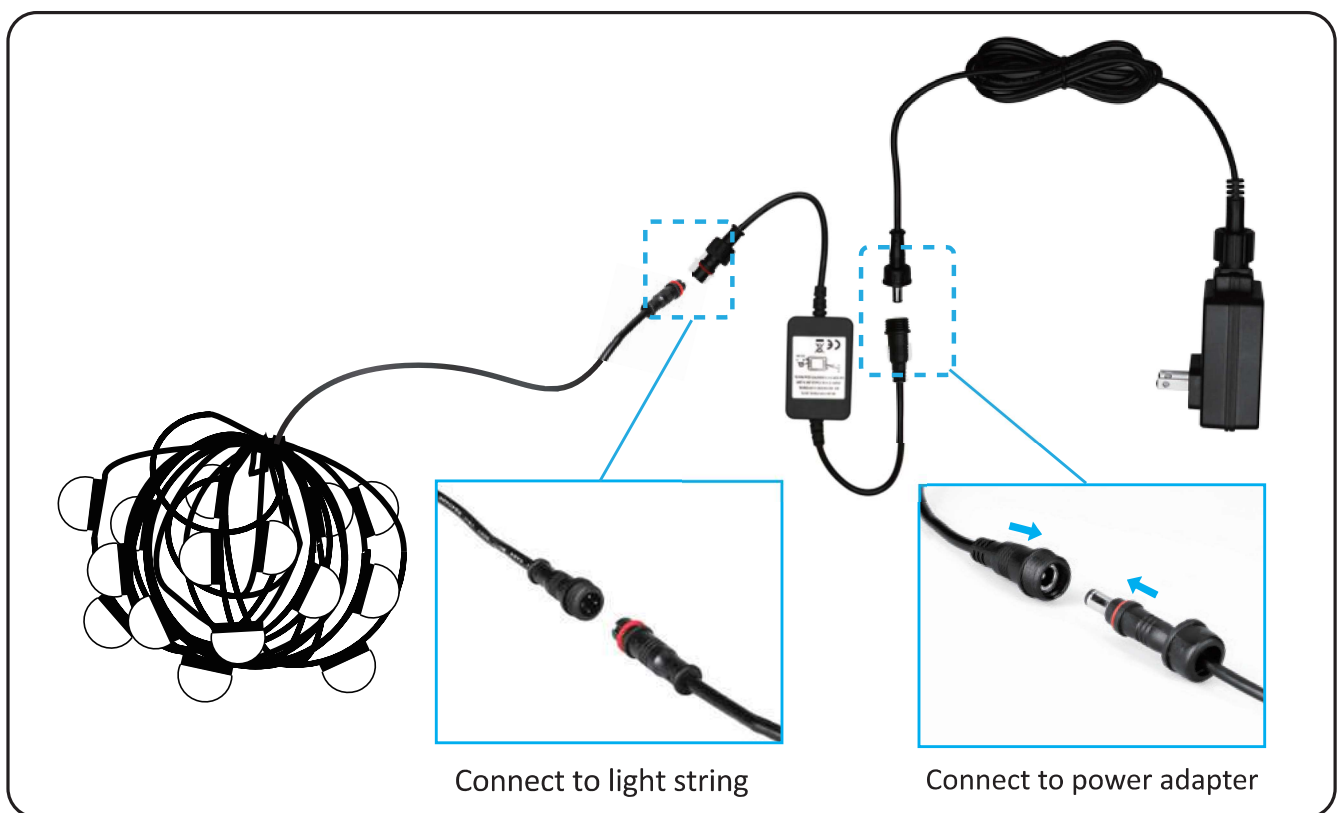

Step 3: Plug and play (AC 100-240V).

Warning: Plug the string lights into the socket after installation is completed.

5. Remote controller

You can control the lights by the remote controller once powered on.

If the lights flash in red light, it's pairing mode. You can pair the Smart Life app with your lights or wait around 3 minutes until the pairing mode fade away.

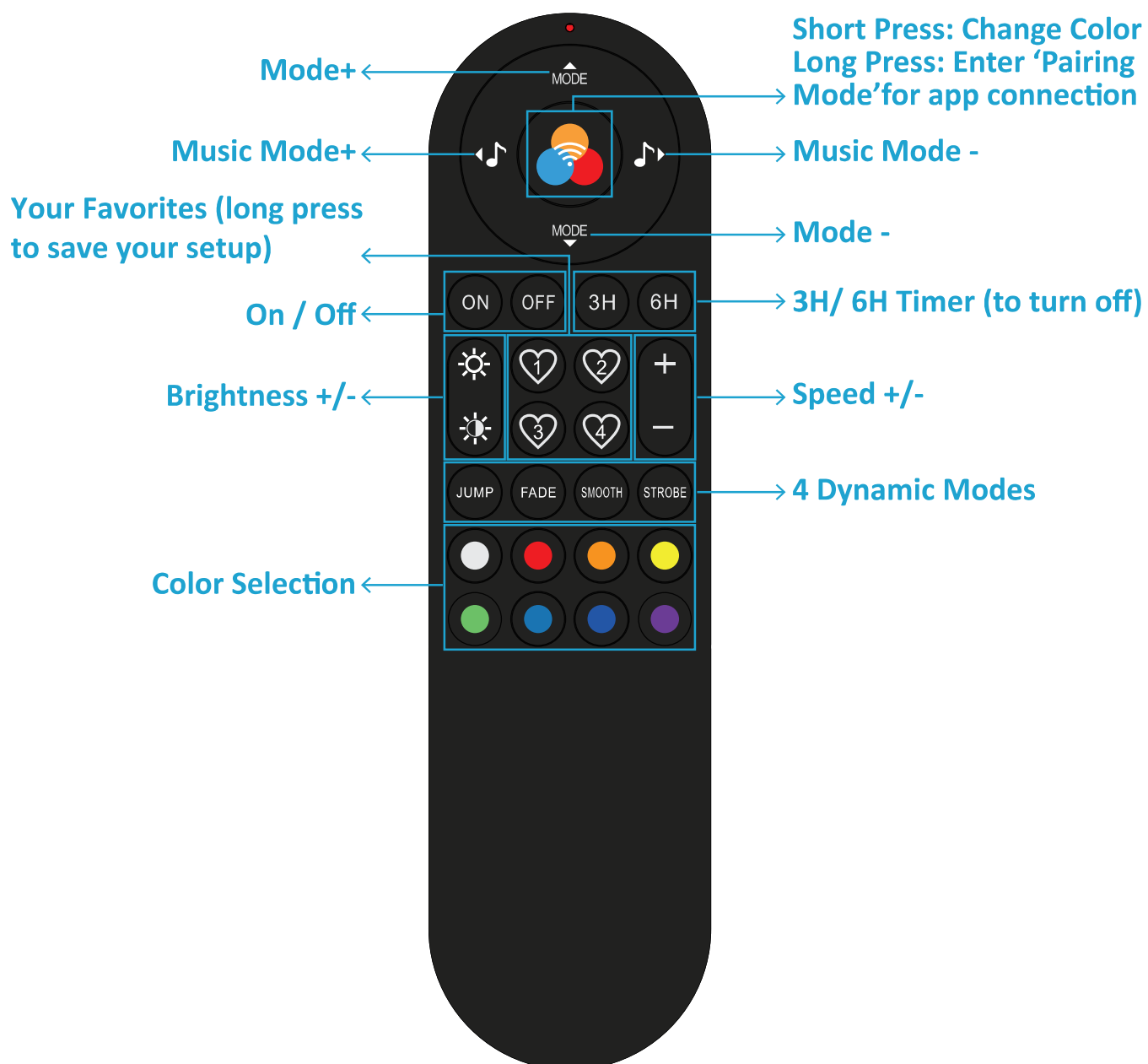

Battery for remote: AAA*2 (Not Included)

Wireless Control Specification:

Wireless Frequency Range: 2.412-2.462GHz(2.4GWiFi)

Wireless Frequency Range: 2.402-2.480GHz(Bluetooth LE)

FCC ID: 2AWON-NVS-WF01 (WiFi Receiver)

FCC ID: 2AWON-NVS-RF01 (Remote Controller)

Federal Communication Commission(FCC)Statement for Users Warning:

Changes or modifications not expressly approved by the party responsible for compliance could void the user's authority to operate the equipment.

This device complies with part 15 of the FCC Rules.

Operation is subject to the following two conditions:

- (1) This device may not cause harmful interference, and
- (2) this device must accept any interference received, including interference that may cause undesired operation.

This equipment complies with FCC radiation exposure limits set forth for an uncontrolled environment.

NOTE: This equipment has been tested and found to comply with the limits for a Class B digital device, pursuant to part 15 of the FCC Rules.

These limits are designed to provide reasonable protection against harmful interference in a residential installation. This equipment generates, uses and can radiate radio frequency energy and, if not installed and used in accordance with the instructions, may cause harmful interference to radio communications. However, there is no guarantee that interference will not occur in a particular installation. If this equipment does cause harmful interference to radio or television reception, which can be determined by turning the equipment off and on, the user is encouraged to try to correct the interference by one or more of the following measures:

- Reorient or relocate the receiving antenna.
- Increase the separation between the equipment and receiver.
- Connect the equipment into an outlet on a circuit different from that to which the receiver is connected.
- Consult the dealer or an experienced radio/TV technician for help.

RF Exposure Information

This equipment complies with FCC radiation exposure limits set forth for an uncontrolled environment. This equipment should be installed and operated with minimum distance 20cm between the radiator and your body.

Important notes before starting:

- Please make sure the WiFi signal is strong enough. The WiFi signal receiving module is built into the LED WiFi controller. The distance between the LED WiFi controller and your WiFi router should be less than 65ft/20m.

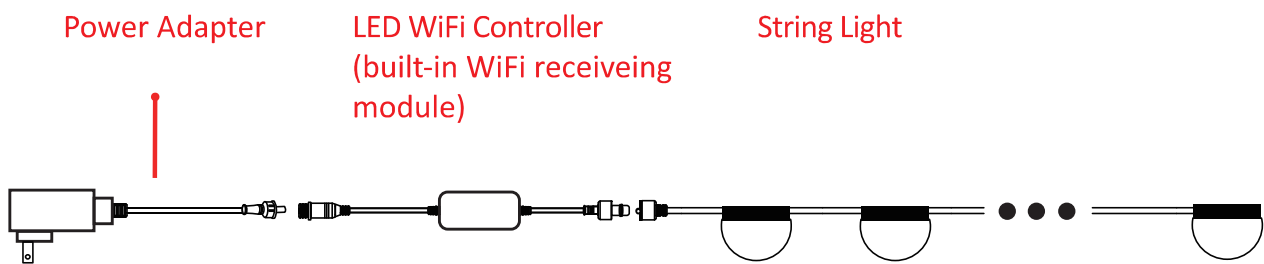

- Before pairing, please turn on the Bluetooth and WiFi on your phone.
- It supports 2.4GHz WiFi network only. If your WiFi router supports both 2.4GHz and 5.0GHz, please separate the two frequency bands in the router settings and select the 2.4GHz.

Part Two - How to pair the light to Smart Life app?



Step A: Smart Life app installation.

Please choose either way below to download and install the app.

(1) As per your phone system, choose the QR code to scan.



iOS



Android

(2) Search keyword 'Smart Life' in App Store or Google Play.

Step B: Create an account on Smart Life and login.

Note: Please keep your account and password in mind for Alexa or Google Assistant App pairing later.

Step C: Set the strip light to 'pairing mode' by the following ways.

Method 1: After powering the strip light, LONGPRESS the “ pairing ()” button for 5 seconds on the remote controller, the strip light will enter 'pairing mode' and blink.

Method 2: Power it on and off by plugging and unplugging the power adapter. Please repeat 3 times, and the light could be in pairing mode and blink.

Step D: Turn on the WLAN(2.4GHz WiFi), Bluetooth and Airdrop or Location function on your mobile phone.

(Note: not compatible with 5Ghz WiFi)



Step E: Open the 'Smart Life' app & complete the device adding process step by step.

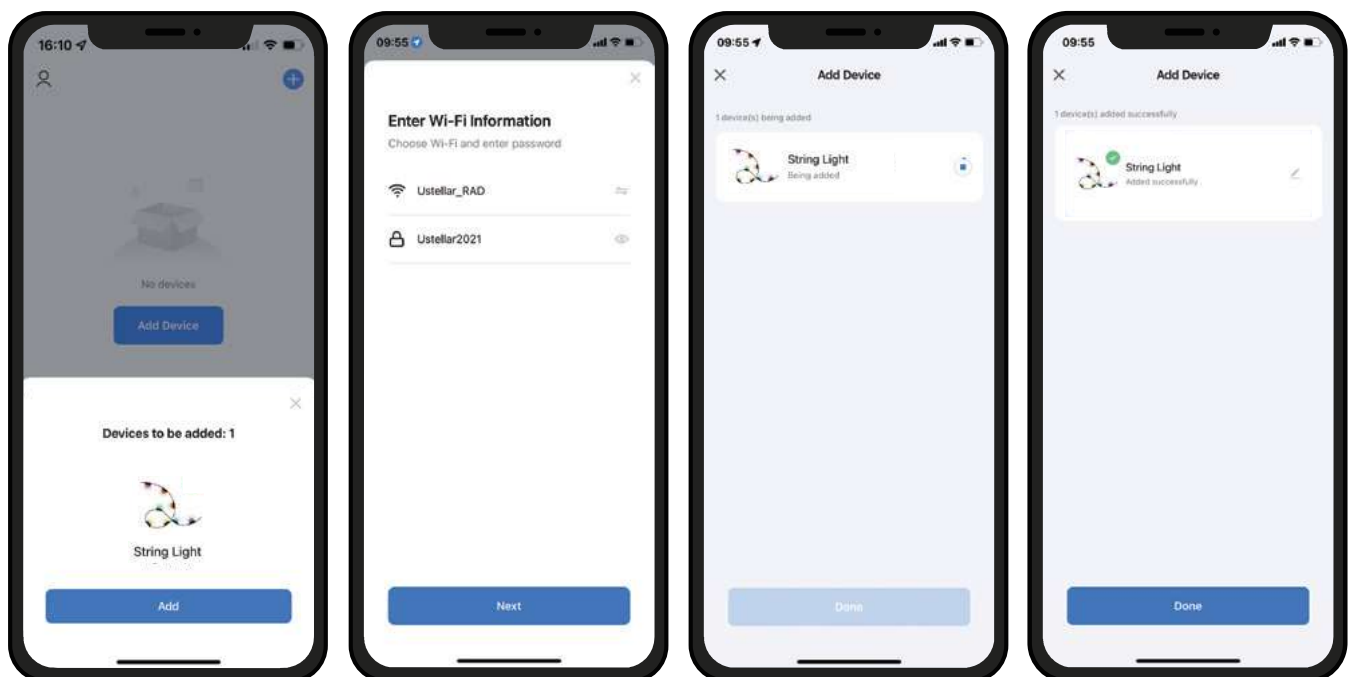

Step F: Now you can control the strip light by 'Smart Life' app.

Main Interface

Power ON/OFF
Timer
Schedule

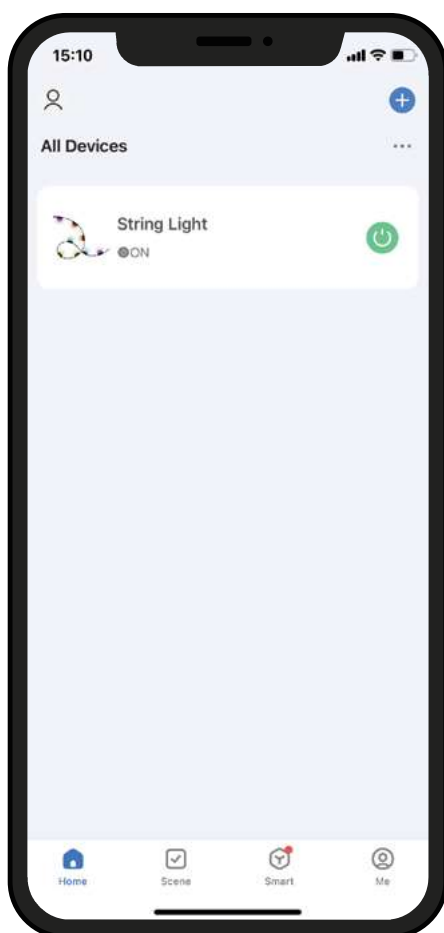

Scene Mode

15 scenes mode switching
by tap

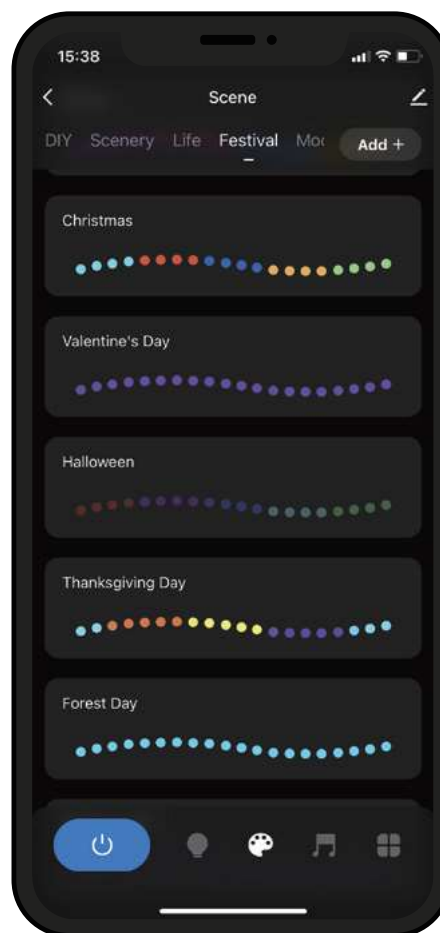

Custom Mode

Up to 8 custom scenes can be saved.

The color, mode and brightness of each bulb can be set individually.

Tap “Preview” to preview the current effect.

Tap “+ Save Scene”, go back to the “Scene Mode” module and you will find “Customize” at the top of the interface.

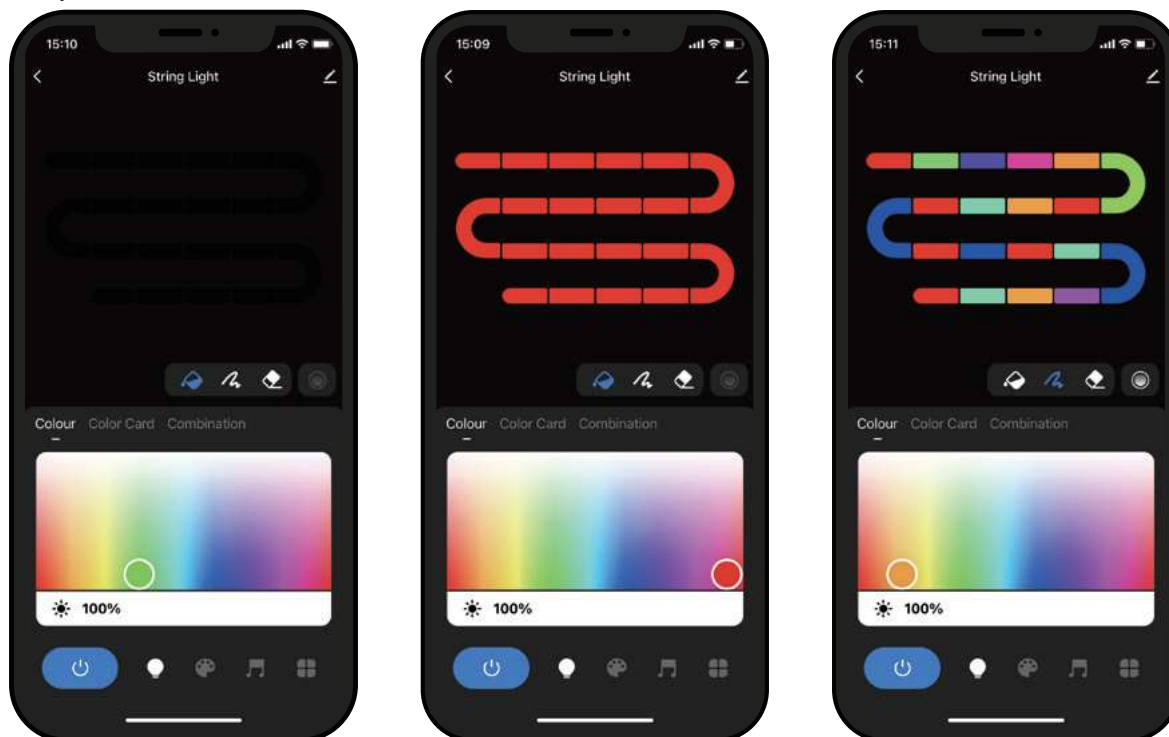

Music Mode

Randomly switch colors according to the rhythm of the music.

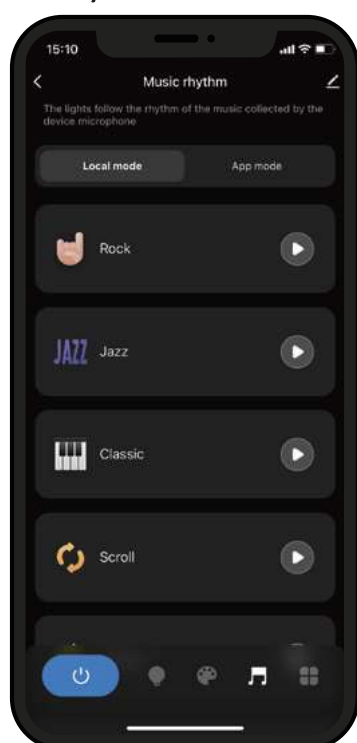

Settings

Timer / Schedule

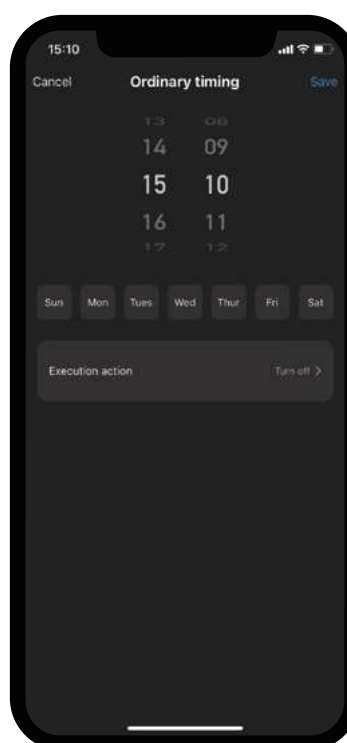

Part Three — How to control the light with Amazon Alexa?



Please make sure that your Alexa app is connected to Echo, and both work well under your WiFi network.

Step A: Log in your Alexa App, tap top left corner, and tap 'Skills'.

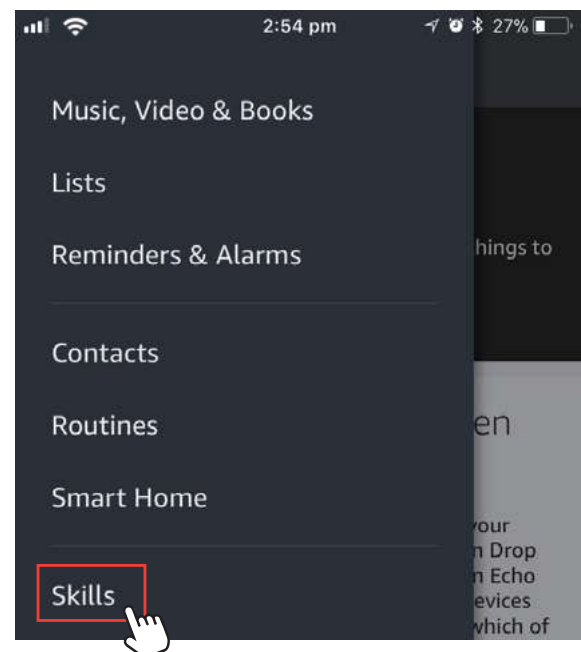
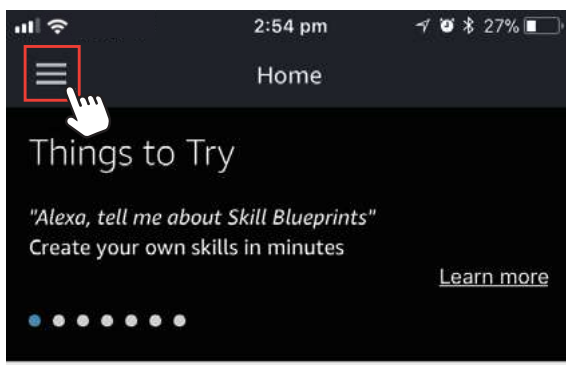

Your Alexa settings have been updated

Household Drop In was enabled from one of your Echo devices or from the Alexa app. The opt-in Drop In feature lets you automatically connect to an Echo device for a voice or a video chat. Your Echo devices with a screen and the Alexa app will indicate which of

Step B: Type 'Smart Life', find 'Smart Life' from the search result and tap it to enable the skill.

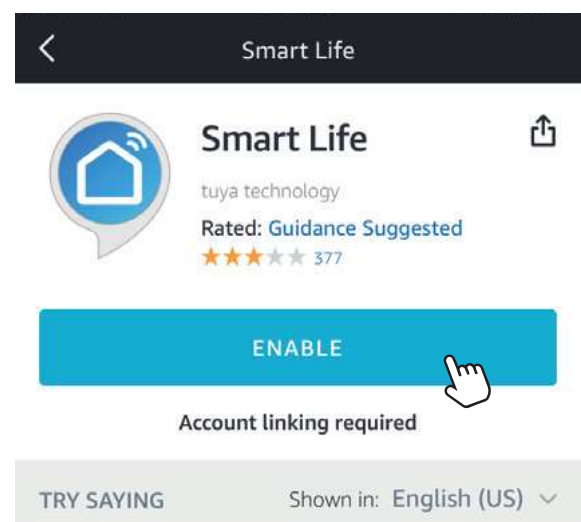
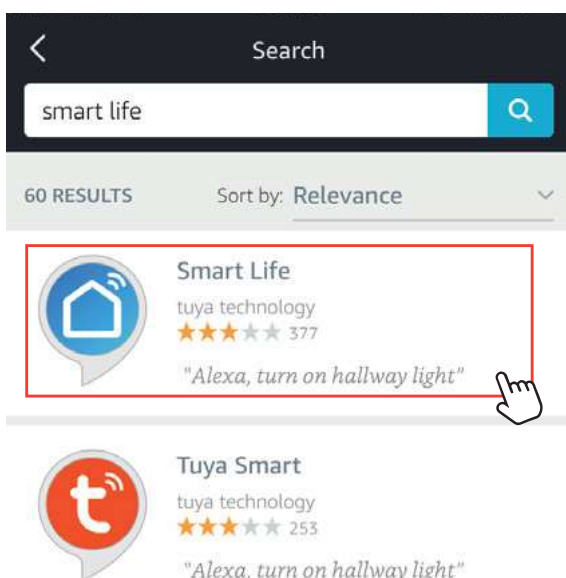

Step C: Enter your Smart Life App account and password. Tap 'Link Now', then tap 'Authorize' on the next page to bind Smart Life account to Alexa.

Step D: When your Smart Life account is bound to Alexa, tap 'DISCOVER DEVICES' to detect the light.

Step C

The screenshot shows the 'Amazon Alexa' app interface. At the top, there's a header with 'Amazon Alexa' and a close button. Below it, a browser-like address bar shows 'px1.tuya.us.com'. The main content area has a 'Done' button on the left and a refresh icon on the right. In the center, there's a 'Link Now' button with a hand icon pointing to it. Above this button are two input fields: 'Account' (with a dropdown for '+1' and a field for 'Phone Number/Email Address') and 'Password' (with a field for 'Type your password here' and an eye icon). Below the 'Link Now' button are links for 'Forgot Password' and 'SMS Login'. At the bottom, there's a section for 'Sign in with social media account' with a Twitter icon. A blue dashed box highlights the 'Account' and 'Password' fields, and a blue line connects this box to a text box at the bottom that says 'Same account and password as Smart Life App'.

Same account and password as Smart Life App

Step D

The screenshot shows the 'Smart Life' app interface. At the top, there's a header with 'Smart Life' and a close button. Below it, there's a section for 'Smart Life' with a logo, 'tuya technology', and a rating of 'Rated: Guidance Suggested' with 377 reviews. In the center, there's a 'Discover Devices' dialog box with a close button. The dialog box contains the text: 'Smart Home devices must be discovered before they can be used with Alexa.' Below this text are two buttons: 'CANCEL' and 'DISCOVER DEVICES'. At the bottom of the app, there's a navigation bar with icons for home, chat, and settings.

Step E: When the named light is paired to Alexa from Smart Life, it will show on the device page (see the 'smart light' example).

Step F: Now you can control the light with Alexa App on the setting page. To turn on or off the light, simply tap the bulb icon.

Step G: You can also voice control the light with Alexa by giving these commands: “Alexa, turn on ‘device name’”, “Alexa, set ‘device name’ to ‘color’”, “Alexa, set ‘device name’ to ‘number’”. Device name is the one you give to the light. The light is named ‘smart light’ in this user guide. For example, “Alexa, turn on ‘smart light’”, “Alexa, set ‘smart light’ to ‘blue’” etc.

Step F

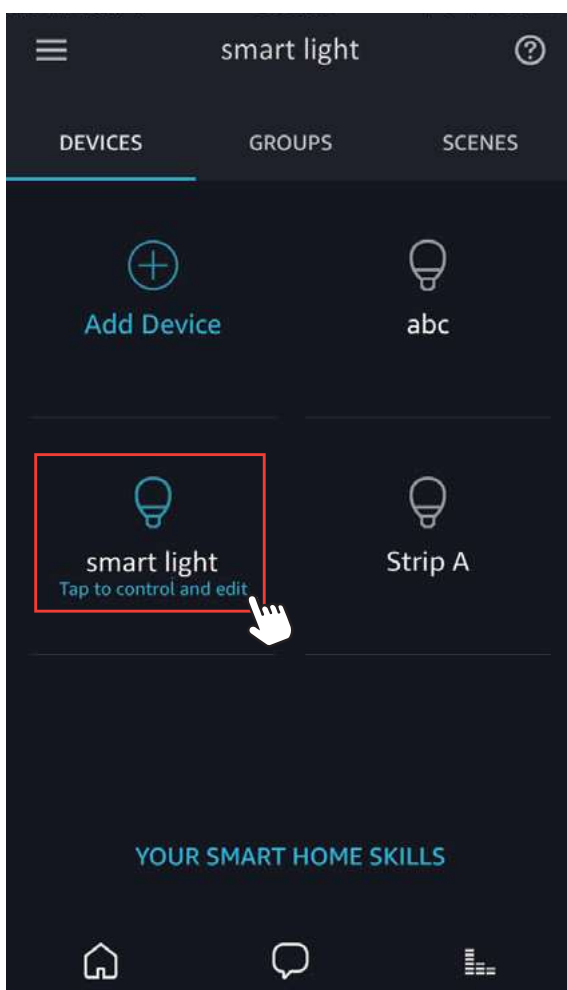

Step G

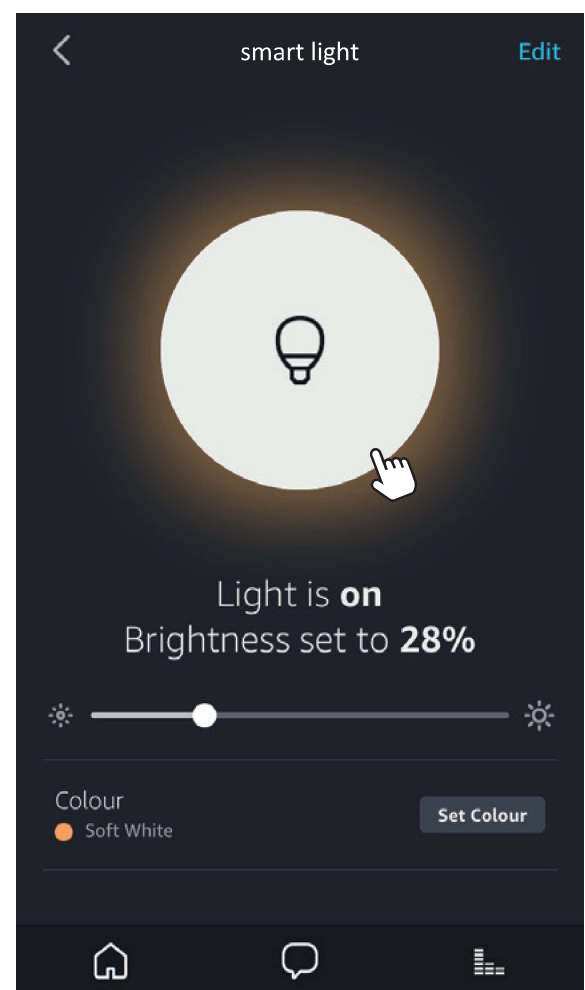

Note: To control the light with Google Assistant, please continue to read Part Four.

Part Four — How to control the light with Google Assistant?

Step A: Login Google Assistant App, tap 'Home Control' on the left side bar page.

Step B: Tap '+' button on the bottom right to enter next page.

Step C: Find 'Smart Life' from side bar list.

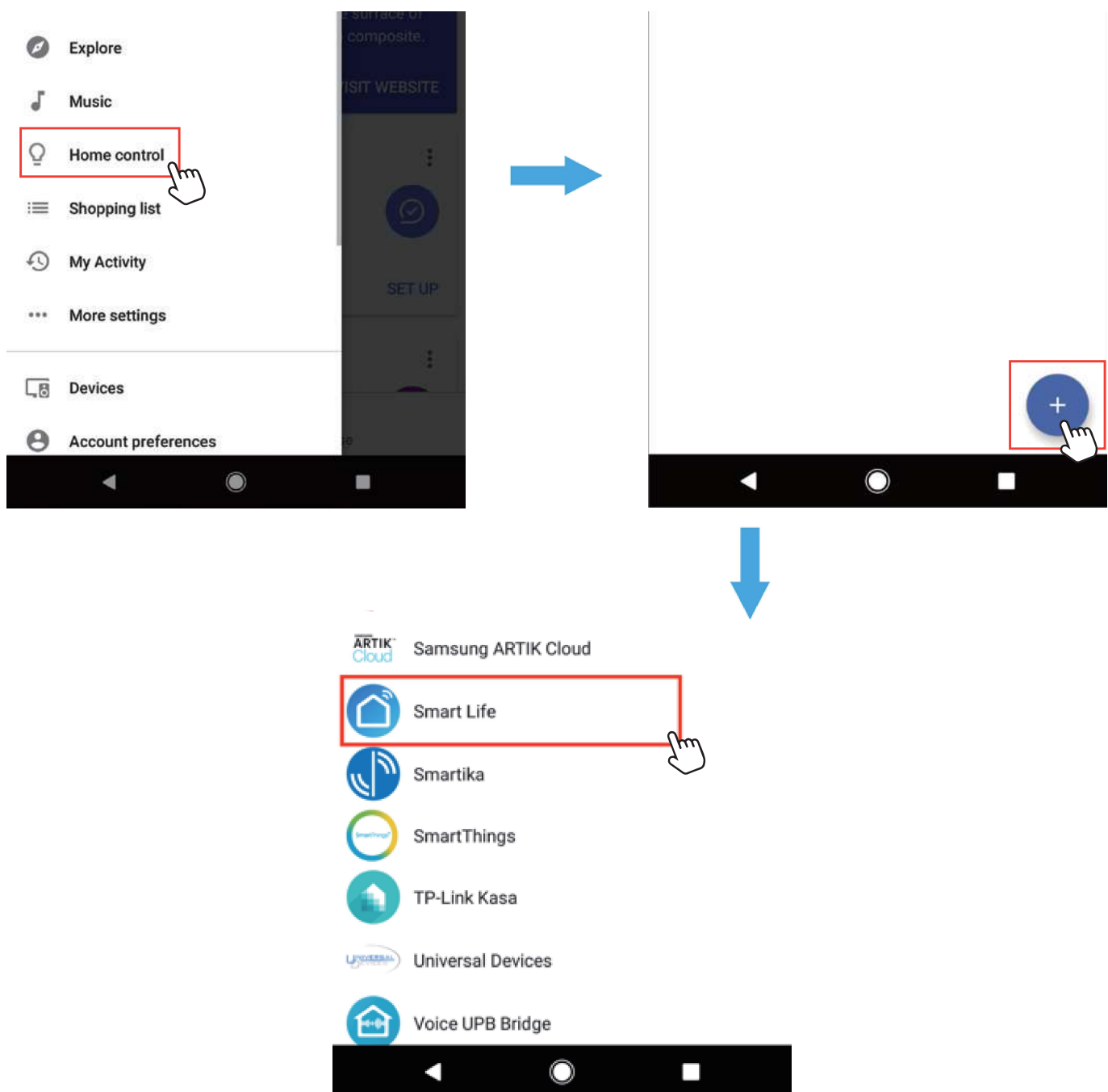

Step D: Enter your Smart Life App account and password to bind Smart Life account to Google Assistant.

Step E: You will find the named light shows on the Home Control page. Now you can control the light on Google Assistant App, or voice control it by giving these commands: “ok Google, turn on ‘device name’”, “ ok Google, set ‘device name’ ‘to color’”, “ ok Google, set ‘device name’ to ‘number’”.

Device name is the one you give to the light. The light is named ‘smart light’ in this user guide. For example, “ok Google, turn on ‘smart light’”, “ok Google, set ‘smart light’ to ‘blue’” etc.

Step D

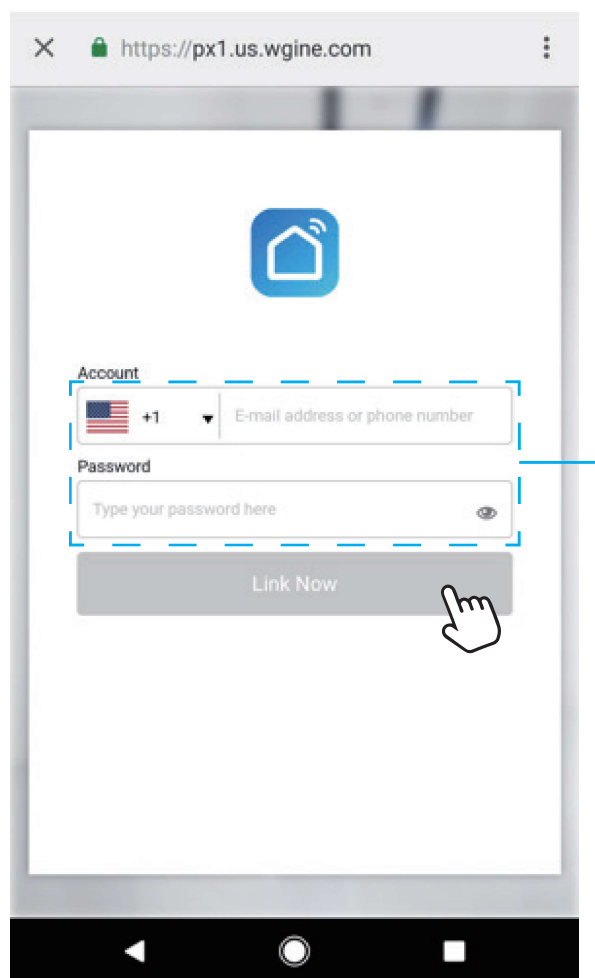

Same account and password
as Smart Life App

Step E

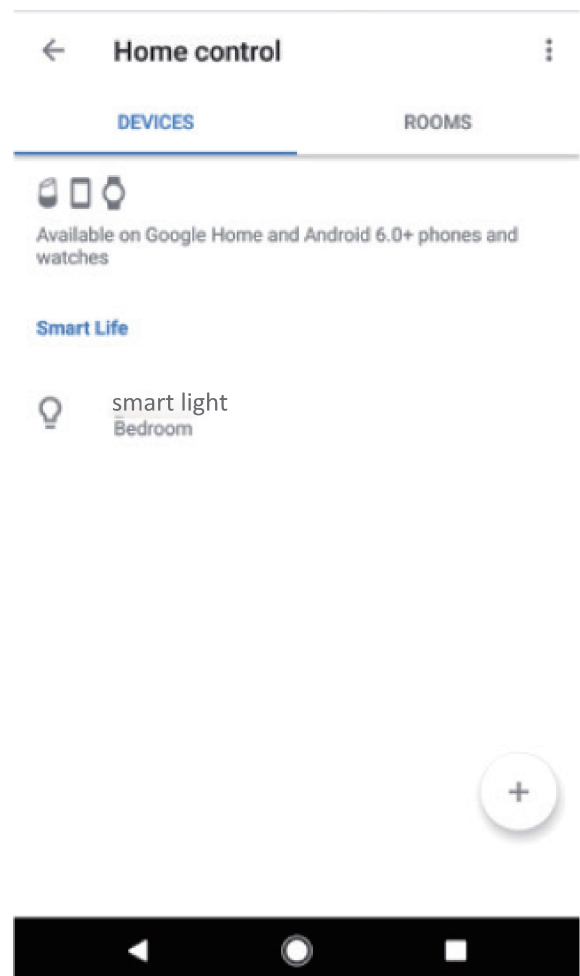

Manufacturer: Shenzhen Ustellar Technology Ltd

(shen zhen shi you shi tuo ke ji you xian gong si)

Address: 308A, 3/F, Building A, Youth Entrepreneur Hub, Jianshe East Road,

Qinghua Community, Longhua Street, Longhua District, Shenzhen, CHINA 518000

novostella



Go paper-free, make life easier, and do something good for the environment.



FC RoHS

CE



MADE IN CHINA