

User Manual for Business Bluetooth Headset

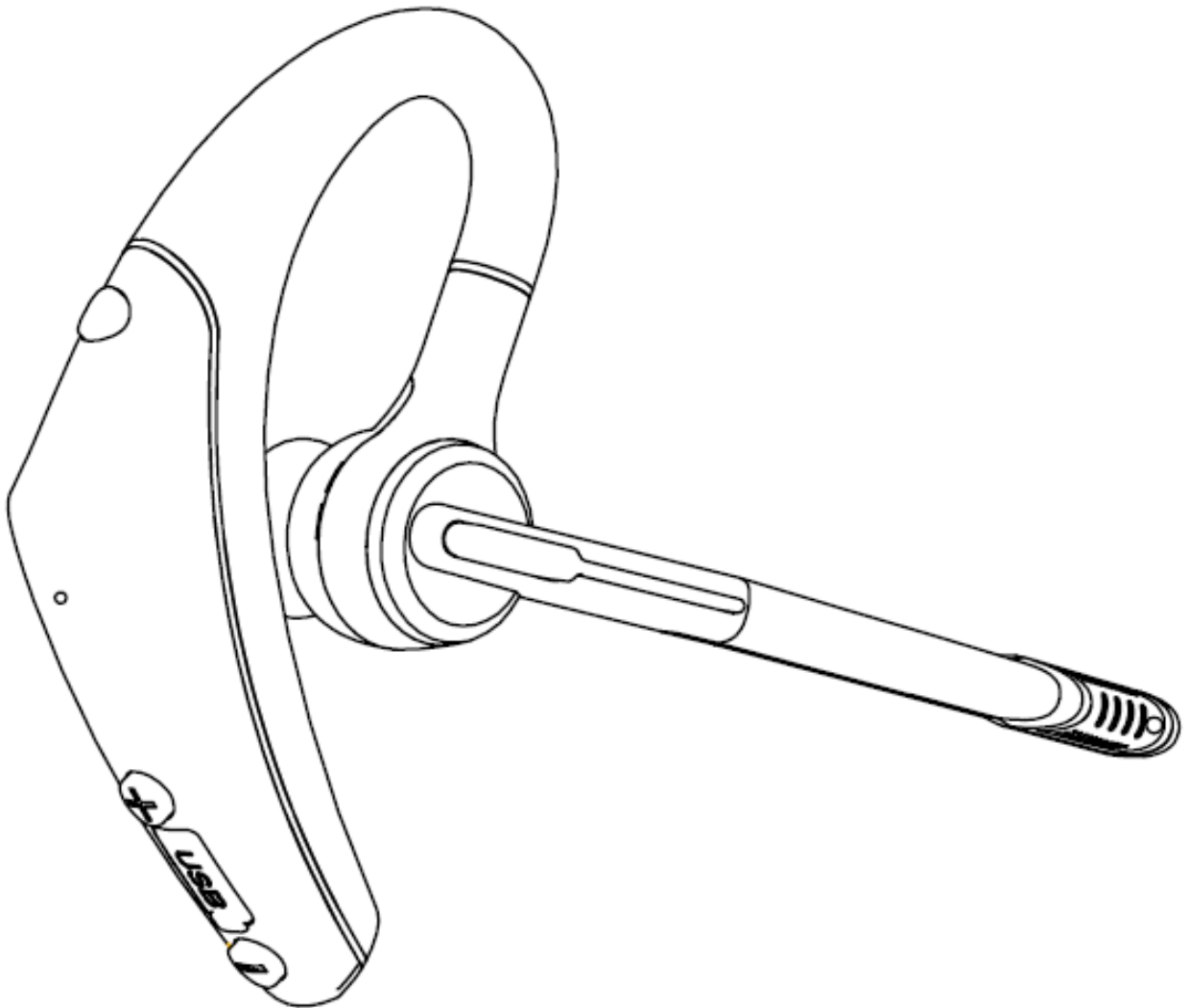

Please read the instructions carefully while using this product

I. How to connect

Connect to bluetooth devices

1. Power on: Press and hold the multi-function button until the indicator light flashes blue light, and you will hear the voice prompt "Power on"

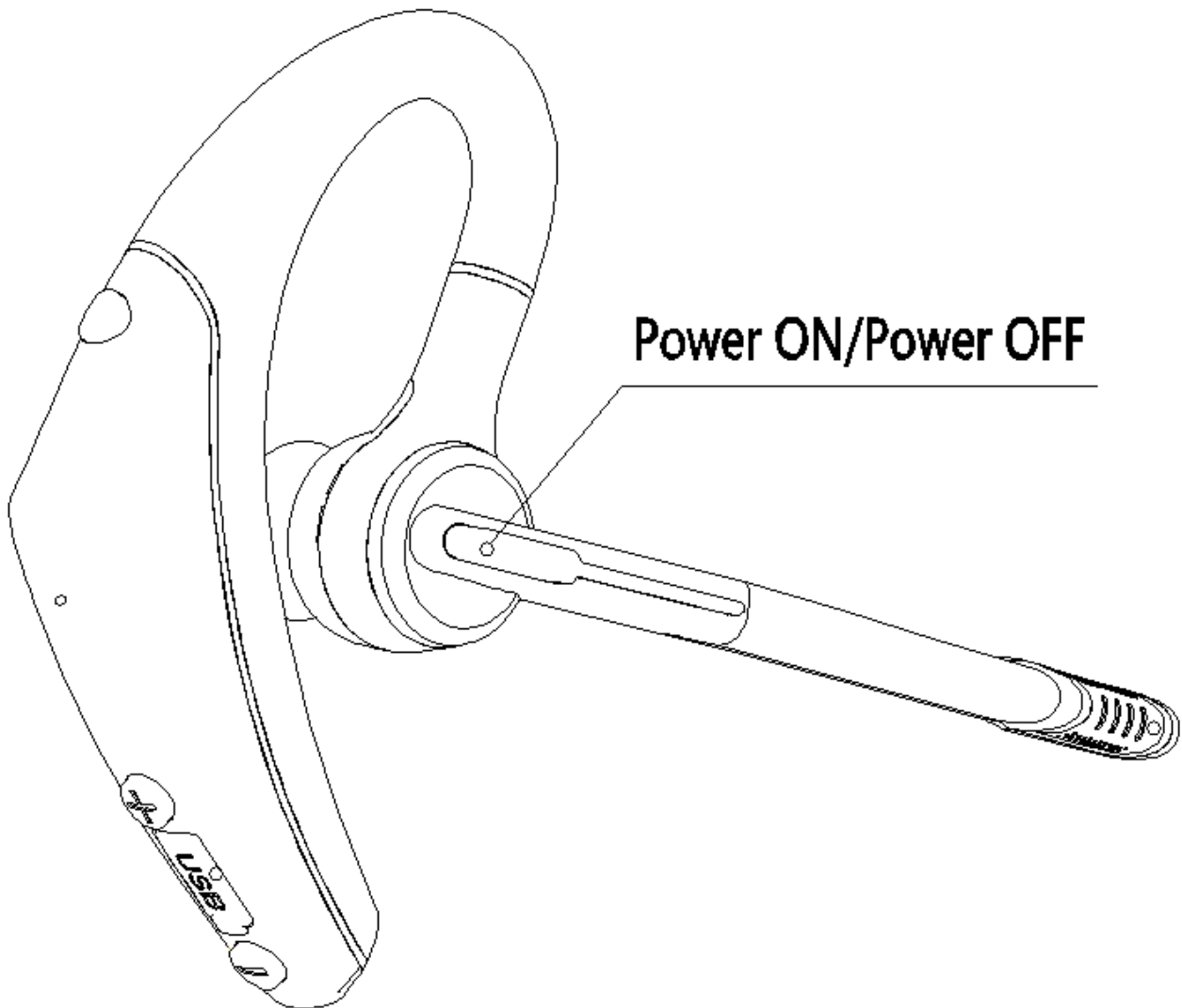

2. pairing status: After being powered on, the headset will automatically enter the pairing state, and the indicator light will flash Blue and Red lights alternately

3. Turn on the bluetooth function of the mobile phone/search the bluetooth device/select the corresponding model of headset to connect to the bluetooth.

II. Charging the headset

After being plugged into the power supply by using USB cable, the headset starts to charge. The charging voltage cannot be higher than 5V. During the charging, the red light will be on, and the blue light will be on after the headset is fully charged.

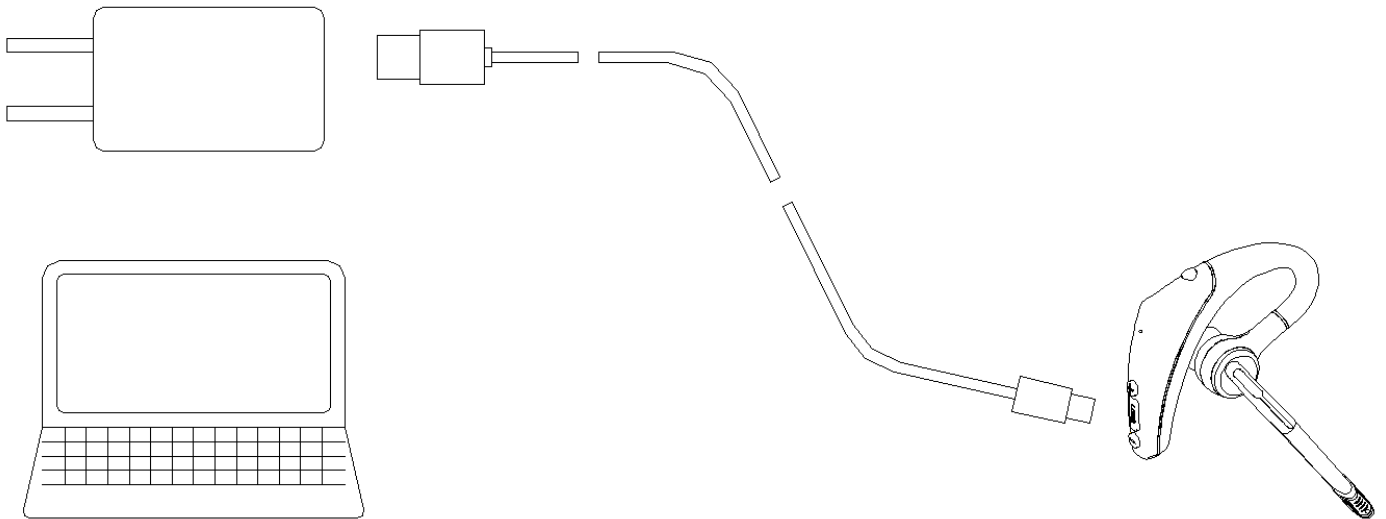

III. How to wear

1. Choose a ear glue cap that fits your ears

We provide three sizes of ear glue cap for this headset: Large size, medium size and small size, plz choose the most suitable one to get the best use experience and reduce noise.

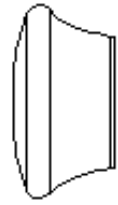
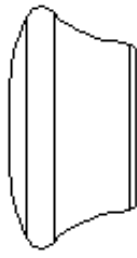
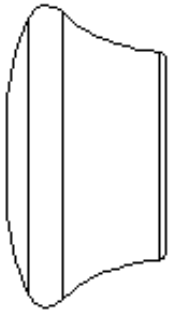

2. Right way to wear

1. Put the headset firmly into your ear and bend the boom mic toward your mouth



2. For wearing on the right and left ear, the horn can be rotated 180 degrees to adjust to the left and right ear

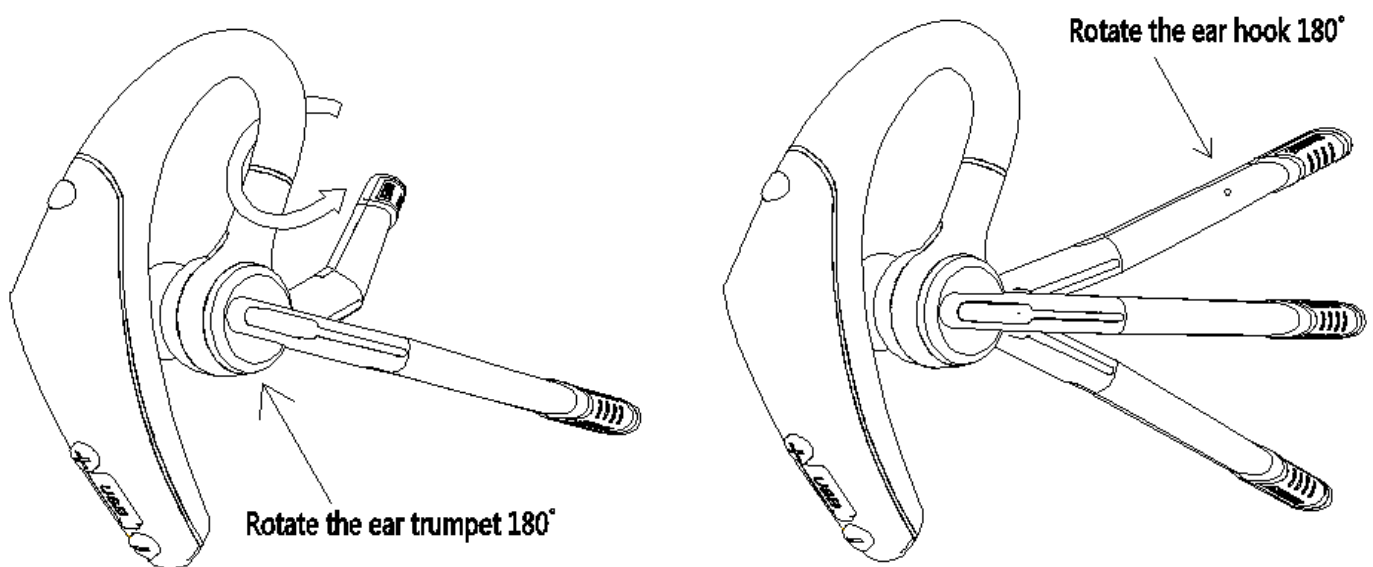

III. How to use

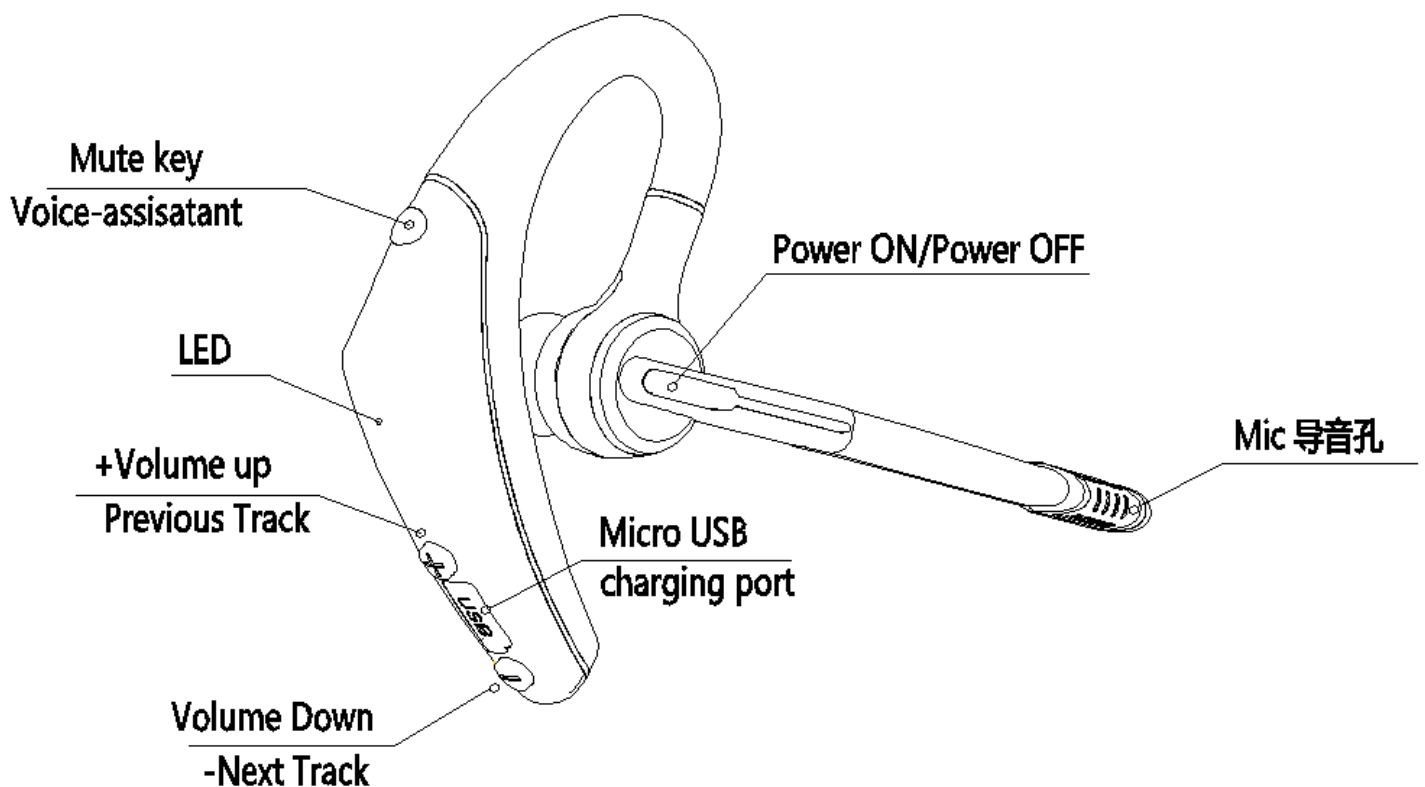

1. Answer the call: Single click the multi-function button of the headset to answer

2. Hang up the call: Single click the multi-function button of the headset to hang up
3. Reject the call: Long press the multi-function button for about 3S
4. Mute: During the call, single click the mute button to silence the microphone and the other party cannot hear any sound. Single click the mute button again to reactivate the microphone.
5. Redial: Double click the multifunction button of the headset to redial the last number
6. Music play/pause: Tap the multi-function button to play/pause music
7. Switch songs: Long press "volume +" about 2S to switch the previous song, and long press "volume -" about 2S to switch the next song
8. Volume control: Tap "volume +" or "volume -" to adjust the volume
9. Power off: Long press the multi-function button for 3S until the red light flashes and it enters the shutdown state
10. Restore factory settings; Long press the multi-function button about 6S in the charging state until the blue light flashes and release the hand to restore the factory setting

11.Connect two mobile phones; According to the pairing steps,turn off bluetooth device on mobile phone A after being successfully paired with headset, the headset enters the mode of being paired again into the state, turn off the headset after successfully pairing with mobile phone B, at this time, turn on the bluetooth device on mobile phone A, the headset will automatically connect the two mobile phones again after startup , any phone calls from mobile A or B can be answered by the headset

IV. Product parameters

- 1.Bluetooth Chip: CSR 8615 from UK
- 2.Bluetooth version: V. 5.0
- 3.Battery capacity: 110 MA
- 4.Talk Time: 10 hours
- 5.Charging time: 1 hour
- 6.Operating Range: 10 m.
- 7.Charging mode: Power adapter output (DC 5V 150mA)

V. Warning

1. The product is equipped with lithium battery. Please do not expose the product to intense sunlight, burn or throw it into the fire to avoid explosion.
2. This product can not be charged with a charger which output voltage is higher than 5V, otherwise it will burn out the headset by over-voltage.
3. Dispose the batteries referring to the local regulations instead of disposing as the household waste

FCC Statement

This device complies with part 15 of the FCC rules. Operation is subject to the following two conditions: (1) this device may not cause harmful interference, and (2) this device must accept any interference received, including interference that may cause undesired operation.

Changes or modifications not expressly approved by the party responsible for compliance could void the user's authority to operate the equipment.

NOTE: This equipment has been tested and found to comply with the limits for a Class B digital device, pursuant to part 15 of the FCC Rules. These limits are designed to provide reasonable protection against harmful interference in a residential installation. This equipment generates uses and can radiate radio frequency energy and, if not installed and used in accordance with the instructions, may cause harmful interference to radio communications. However, there is no guarantee that interference will not occur in a particular installation. If this equipment does cause harmful interference to radio or television reception, which can be determined by turning the equipment off and on, the user is encouraged to try to correct the interference by one or more of the following measures:

- Reorient or relocate the receiving antenna.
- Increase the separation between the equipment and receiver.
- Connect the equipment into an outlet on a circuit different from that to which the receiver is connected.
- Consult the dealer or an experienced radio/TV technician for help.

The device has been evaluated to meet general RF exposure requirement. The device can be used in portable exposure condition without restriction.