



PRODUCT INSTRUCTIONS AND SAFETY WARNINGS



©2018 Goldrabbit Co.,Ltd.

This user guide contains information helpful for using Maunzi. Please read closely before use.

Information on safety warnings and cautions are included (page 4) so make sure to read them and use the product for right purposes.

This user guide was written October 25, 2018. We are constantly making partial changes, modifications and improvements to Maunzi.

However, these changes are not reflected in this guide.

CONTENT

GENERAL GUIDE _____ 3

Product information
Customer service
Before use
Safety warnings and cautions
Note before charging
Charging
Details to check before use
Regarding errors
Cleaning
Storage
Disposal

CUBE GUIDE _____ 12

Window Cube
Bridge
Charger Cube
Motor Cube
Lighting Cube
Cannon Cube
Sub Cube
Angle Cube
Rotation Cube
Cube's operating process
Does Cube not move?
Cube - Lego

CHARACTER GUIDE _____ 20

Nick
Wily
Cobi

PRODUCT INFORMATION

PRODUCT NAME

Maunzi

KIT NAME

Refer to product composition

CERTIFICATION

Korea 10-1605059
 China 201711136991.6
 Europe 003414838-0001
 U.S 87/567443

DEVELOPMENT & MANUFACTURING

Godlrabbit Co.,Ltd.

ADDRESS

#104, 7 beon-gil, Yongso-ro, Nam-gu, Busan,
 Korea

CUSTOMER SERVICE

email info@maunzi.com
 tel 070-8885-2237
 site www.maunzi.com

PRODUCT COMPOSITION

Kit name	Classic Kit	Dynamic Wheeler Kit	Burning Cannon Kit	Full Performance Kit
Model No.	MZ S 17 01 01	MZ S 17 01 02	MZ S 17 01 03	MZ S 17 01 04
Window Cube	1	1	1	1
Motor Cube	1	2	2	2
Angle Cube	X	1	1	2
Rotation Cube	X	X	X	2
Lighting Cube	X	1	1	2
Cannon Cube	X	X	1	1
Bridge	1	3	5	6
Charger Cube	1	1	1	1
Sub Cube	X	X	X	2
Nick Brick Pack	1	1	1	X
Willy&Cobi Brick Pack	X	1	1	X
Wheel bar	2	4	4	4
Wheel	2	4	4	4
USB Cable	1	1	1	1
Adapter	1	1	1	1
Cannon Bombs	X	X	10	20
4X4 Block	2	6	10	12

Kit name	Expansion Box
Model No.	MZ S 17 01 05
Bridge	5
Sub Cube	4
4X4 Blocks	10

BEFORE USE

- 1 This product is module assembly type toy robot. This works in connection with Window Cube.
- 2 Before use, Window Cube should be charged. Follow the instructions in this guide to work properly.
- 3 Control module Cube (hereinafter referred to as Cube) can only be connected to "Maunzi." Do not connect to other manufacturer's products.

PREPARATION BEFORE USE

- 1 Get smart devices such as mobile or PC, smart pad(hereinafter referred to as tablet) ready. Maunzi is a robot that is remotely controlled by Bluetooth Connection.
- 2 Install mobile or tablet exclusive application(hereinafter referred to as app).

NOTE

Maunzi app is compatible with both Android and iOS.

mobile	Maunzi RC
tablet	Maunzi LAB

SAFETY WARNINGS AND CAUTIONS

- 1 Make sure to store the product in a safe place for safe use.
- 2 These are the safety alert symbols to emphasize potential dangers or cautions.

DANGER

This symbol is used to indicate serious danger or potential risks. If ignored, it can be life threatening and cause serious injury.

WARNING

This symbol indicates fatal elements that can cause danger to life or serious injury.

CAUTION

This symbol indicates elements that can cause minor injury or wound.

NOTE

This symbol indicates important information or information that requires attention.

DANGER : HIGH SAFETY RISK

Ignoring the following instructions can cause fatal dangers to life or severe injuries.

DANGER

Power supply device (page 7) and Charger Cube should be used by adult or under adult's supervision.

DANGER

This product is not a simple toy. It contains battery inside.

DANGER

Protect battery inside Window cube from overheating and fire.

⚠ DANGER

Make sure to use power supply device provided.

⚠ DANGER

When the product is deformed during charging or storage and Cubes become overheated, malfunctioning or damage occurs, then immediately separate power supply device from charring cube to prevent fire or electric shock.

WARNING : MID LEVEL DANGER

Ignoring the following instructions can cause life threatening damage or sever injuries.

⚠ WARNING

This toy is very dangerous to children under 3. Small components can cause suffocation.

⚠ WARNING

When used by children under 6, use it under adult's supervision

⚠ WARNING

Pay attention to children's throwing the product or breaking it with force.

⚠ WARNING

Lithium-polymer rechargeable battery is built inside the window cube that cannot be replaced.

⚠ WARNING

Battery inside Window cube can be damaged by external environment and impact.

⚠ WARNING

External impact and battery overheating can cause fire.

⚠ WARNING

If possible, do not use it in a fire prone areas or narrow and closed area.

⚠ WARNING

In case of fire, do not extinguish with water. Use blanket or fire extinguisher. Do not touch the product with bare hands. Instead use protective gloves and equipment to put out fire.

⚠ WARNING

When window cube is damaged or deformed, stop using immediately. Discard according to appropriate methods.

⚠ WARNING

Do not immerse it in water.

⚠ WARNING

Do not contact it with heat directly.

⚠ WARNING

Exposure to excessive humidity can cause malfunctioning.

⚠ WARNING

Window cube should be disassembled by professional.

⚠ WARNING

Window cube should be connected to the following power supply devices that are compliant with protection grade 2.

We call charging adapter and USB cable combined together as power supply device.

input	AC 100V-240V 0.26A
output	DC 5V --- 2A
material	PC+Metal(□□)

ⓘ Mode number and issued certification content are indicated on the back of charging adapter.

⚠ WARNING

Use power supply device in room temperature.

CAUTIONS : LOW LEVEL DANGER

Ignoring the following instructions can cause minor injury or wound.

⚠ CAUTION

Maunzi is children's toy and can be used for professional robot education purposes.

⚠ CAUTION

Do not immerse the product in water

⚠ CAUTION

Keep from actions such as assembling essential parts of Cube with excessive force or dropping from heights

⚠ CAUTION

Be advised to use it in relatively clean indoor environment.

⚠ CAUTION

For prolonged use, store Cube in clean area without dirt.

⚠ CAUTION

Window Cube and lighting Cube have built-in LED. Do not start at the light directly. Do not look at the light using microscope or magnifier. Staring at the LED light can be harmful to your eyes.

FCC Compliance Statement

This device complies with part 15 of the FCC rules. Operation is subject to the following two conditions:

(1) This device may not cause harmful interference, and (2) this device must accept any interference received, including interference that may cause undesired operation.

FCC Caution

Any changes or modifications not expressly approved by the party responsible for compliance could void the user's authority to operate this equipment. This transmitter must not be co-located or operating in conjunction with any other antenna or transmitter.

FCC Radiation Exposure Statement

This equipment complies with FCC radiation exposure limits set forth for an uncontrolled environment. This equipment should be installed and operated with minimum distance 20 cm between the radiator and your body. This transmitter must not be co-located or operating in conjunction with any other antenna or transmitter.

FCC Interference Statement

This equipment has been tested and found to comply with the limits for a Class B digital device, pursuant to part 15 of the FCC Rules. These limits are designed to provide reasonable protection against harmful interference in a residential installation. This equipment generates, uses and can radiate radio frequency energy and, if not installed and used in accordance with the instructions, may cause harmful interference to radio communications. However, there is no guarantee that interference will not occur in a particular installation. If this equipment does cause harmful interference to radio or television reception, which can be determined by turning the equipment off and on, the user is encouraged to correct the interference by one of the following measures:

- Reorient or relocate the receiving antenna.
- Increase the separation between the equipment and receiver.
- Connect the equipment into an outlet on a circuit different from which the receiver is connected.
- Consult the dealer or an experienced radio/TV technician for help.

FCC ID : 2AWO3-MZfv1701

These are parts that contain Bluetooth (BLE).

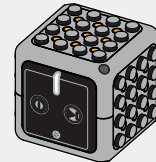

BEFORE CHARGING

WINDOW CUBE

NOTE

Window Cube doesn't have storage function.

NOTE

Charging is possible only in Window Cube. Do not charge other Cubes.

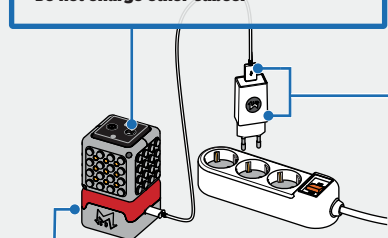

CHARGER CUBE

WARNING

Use only Maunzi Charger Cube provided. Do not use PC's or other manufacturer's power supply devices

DANGER

Obvious damage to or deformation of Charger Cube or malfunction or deformation by heat can cause fire or electric shock. Upon finding relevant symptoms, separate power supply from Charger Cube.

DANGER

Protect Charger Cube from overheating. Never break it. There is a risk of fire.

POWER SUPPLY DEVICE

The combination of Charging adapter and USB cable is called power supply device here.

WARNING

Use power supply device in room temperature.

DANGER

Power supply device can be replaced by same type of device.

DANGER

Use power supply device and Charger Cube by adult or under adult's supervision.

DANGER

Do not connect Charger Cube and power supply device to any devices other than window cube.

CHARGING

- 1 When battery is low, battery indication lamp on Window cube will display orange light.

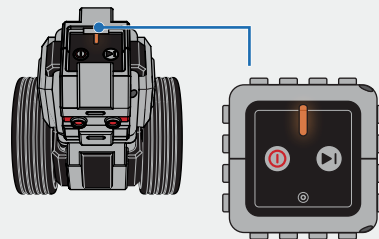

- 2** Remove all cubes and blocks connected to Window cube.

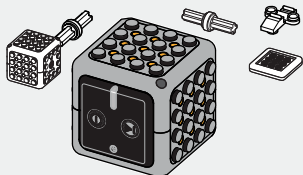

⚠ NOTE

1 window cube can be charged. If the window cube is connected to other cubes, disassemble all to leave Window cube.

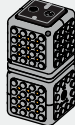

- 3** Turn off window cube by pressing power button for 3 seconds.

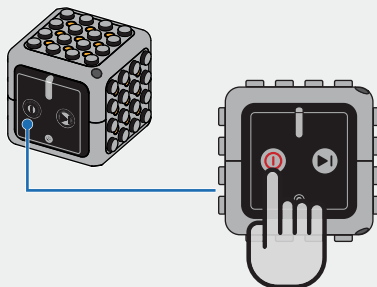

- 4** Connect Adapter provided to USB cable

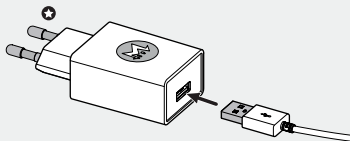

⊕ Shape of plug can vary depending on the country.

- 5** Connect Adapter **2** to an outlet.

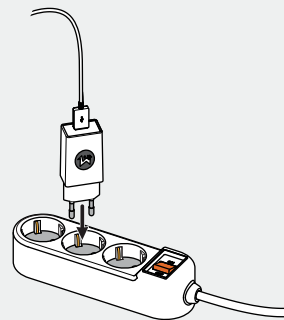

- 6** Connect USB cable with Charger Cube.

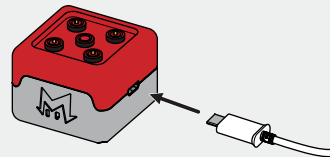

- 7** Connect Window cube **3** onto Charger Cube **6**.

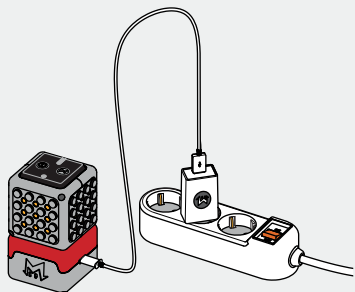

! NOTE

Connect so that red side of window cube is in contact with upper side of Charger Cube.

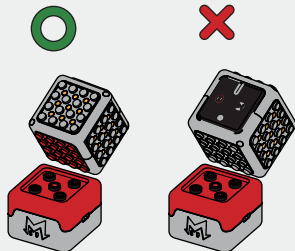

- 8** Press down until click sound.

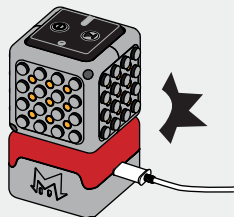

- 9** Indication lamp will display purple light as charging starts.

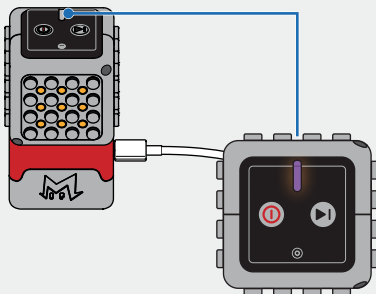

- 10** The purple light will disappear when charging is finished.

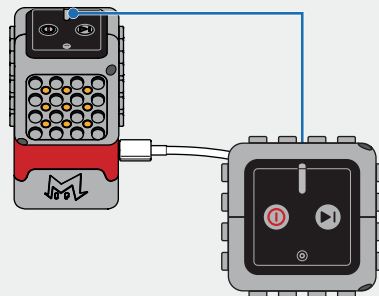

! NOTE

charging time : about 90 minutes¹
Operating time : about 50 minutes²

- 1 Time that takes from completely discharged battery to fully charged.
- 2 In case of fully charged Window connected to 6 cubes and then, continual running of Bluetooth control using Maunzi RC app.

! NOTE

When finished with use, immediately charge Window cube.

⚠ NOTE

Remove power supply device when charging is finished.

DETAILS TO CHECK BEFORE USE

⚠ NOTE

Start using when its temperature matches room temperature to prevent damage by condensation of inner parts after a low temperature shipping

⚠ NOTE

Do not force motion cubes (motor cube, angle cube, rotation cube) to move. Forcibly turning by hand can cause internal malfunction.

⚠ NOTE

Do not stop modules in motion by force. This can cause internal malfunction.

⚠ NOTE

Bluetooth communication distance is up to 15 meters when there is no obstacle.

⚠ WARNING

Do not connect more than 6 cubes(except bridge) to 1 Window cube to prevent deformation. If more than 8 cubes are connected, overload can occur and lead to malfunction.

⚠ WARNING

Make sure to turn off window cube's power after use. Do not leave it with power on to prevent damage to product such as overheating

REGARDING ERRORS

⚠ NOTE

Do not disassemble Window cube by force.

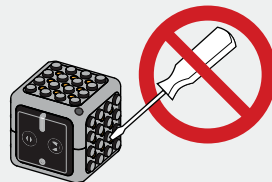

KEEP YOUR DEVICE UP TO DATE WITH THE LATEST FIRMWARE.

Most errors can be solved by installing latest firmware. Check the homepage frequently to update firmware regularly. Download relevant app to update firmware and follow instructions on the homepage and app.

⚠ NOTE

**SITE
DEFAULT APP**

**www.maunzi.com
Maunzi RC**

AUTOMATIC POWER CONTROL IN CASE OF OVERHEATING

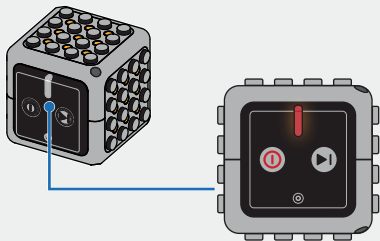

When cube is overheated, the indication lamp will blink red. Window cube will be turned off for a few seconds automatically.

! NOTE

Automatic power control is built-in to prevent damage to product in case of overheating.

! NOTE

In case of repeated overheating, disconnect Window cube and other cubes and turn off power and cool down for 10-15 minutes

CLEANING

! WARNING

Always disconnect Window cube from power supply device before cleaning.

Use dry cloth or smooth brush for light cleaning.

Do not use chemical, detergent or liquid cleaning agent to prevent damage to product. Use dry material to wipe exterior.

STORAGE

Store in dry and cool area.

! NOTE

Avoid place over 40°C .

! NOTE

Do not store more than 2 weeks in temperature over 35°C.

Check charging status after 6 months and charge product frequently.

! NOTE

To prevent battery damage caused by full discharge of battery, never store battery in fully discharged state.

DISPOSAL

! NOTE

To minimize negative impacts on health and environment, dispose of products in accordance with each country's guidelines for electronic and electrical equipment.

Window Cube

NOTE

- L** : State indication lamp
- | | |
|----------------------------|-------------------------|
| ● : White | Power on |
| ● : White blinking | System is booting |
| ● : Green | manual operation |
| ● : Green blinking | Maunzi LAB playing |
| ● : Blue | Connecting to Bluetooth |
| ● : Orange | No battery |
| ● : Purple blinking | Charging |
| ● : Red blinking | Error/ malfunction |

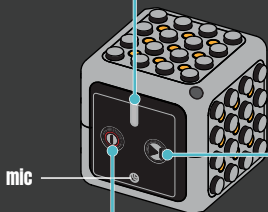

NOTE

If error continues, window cube turns off automatically to prevent overheating.

WARNING

To prevent product deformation, do not connect more than 6 cubes(except bridge) to one Window cube. Connecting to more than 8 cubes can cause malfunction due to overheating.

NOTE

⏪ : Manual operation switch
If pressed once, connected cube starts preset repetitive motion. Pressed once again, it stops repetitive motion.

NOTE

⏻ : Power switch

1 power on
press once and state indication lamp will blink white (indicating booting) and after a few minutes, white light (power on) will last.

2 power off
press about 3 minutes and then it turns off.

BRIDGE



NOTE

Insert bridge to connect each cube to others.

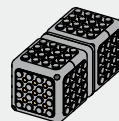

CHARGER CUBE

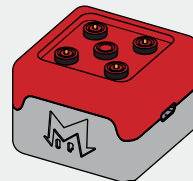

NOTE

Refer to Charging(page 7).