

USER MANUAL

N A R C I

LIP Plumper
NP-P100

Awake your —
hidden beauty.

S/N: NHF20203US01

Copyright © 2020 NODE Co., Ltd. All Rights Reserved

01

Before Using

- This product is a beauty device made exclusively for the lips that instantly increases the volume and color of lips using pressure. Any other use is prohibited.
- If used for a long time, bruise-like wounds may occur. After testing at short intervals (within five seconds), increase the time depending on the condition of your lips.
- Please be careful not to let the skin around the lips get sucked in with the product.
- Incorrect and excessive use can severely irritate the skin around the lips. Repeated use after issues have occurred can cause problems such as pigmentation and redness.
- Please consult with a specialist before using in the following situations:
 - If the condition of your lips and the skin around them is abnormal or you are seeking treatment.
 - If you have had cosmetic surgery/procedure on the lips and skin around them.
 - If you are taking medication.
 - If you have a disease or physical abnormality.
 - Women who are pregnant; the elderly.

Items Included

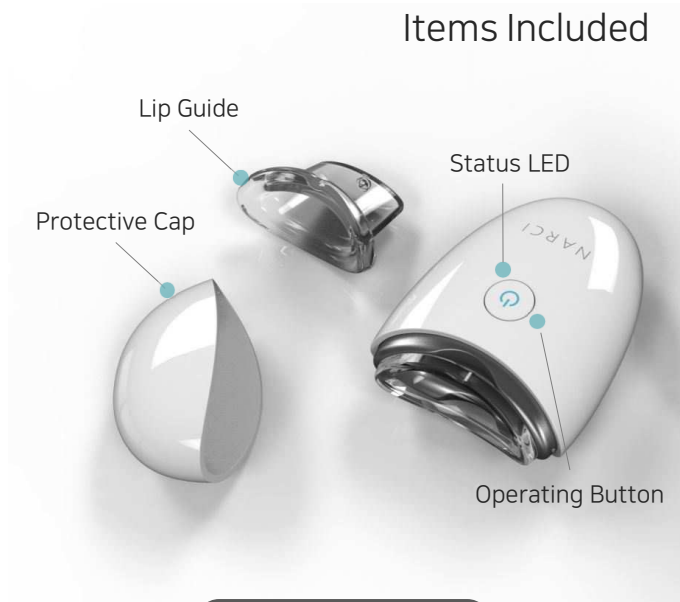

Items Included

- Main Body, Protective Cap, Lip Guide
- Product Manual, Warranty Card, Charging Cable

03

How to Use

1. Please check the battery condition before use. (Please fully charge the battery before using for the first time.)

LED	Status
Green	Free Battery Space
Red	Low Battery
Off	No Batteries

2. Remove the protective cap attached to the body and install the lip guide that fits your lips.
3. With your mouth closed, gently touch the lip guide to your lips.
4. Press the button to activate the product. Adjust the usage time and position of the lips accordingly so that the surrounding skin does not get sucked in as the lips are pulled.
5. Once your lips are enlarged enough to create the desired effect, press the button again to stop the product.
6. Remove and clean the lip guide periodically after use.
7. After washing the lip guide, dry it completely before using it again.

Product Specifications

■ Main Body

- Product Name: Lip Plumper
- Brand: NARCI
- Model Name: NP-P100
- FCC ID: 2AWNMP-P100
- Size: approx. 62mm x 100mm x 35mm
- Weight: 70g
- Maximum Operating Time: 90min
- Charging Time: about 3 hours
- Manufacturer: NODE Co., Ltd.
- Country of Origin: Republic of Korea

■ Rated input

- 5 VDC, 1.5 A

05

Battery Charger

- Before using any charging adapter, verify that the rated voltage and current matches the output voltage rating printed on the charging adapter.
- Connect the charging adapter to the charging terminal at the bottom of the main body.
- When connecting the adapter, you can check the charging status through the LED.

LED	Status
Blue	Charging
Off	Charging Complete

- Charge the product at least once a month to maintain battery life even if the product is not being used.
- Do not use the product while charging. Be sure to remove the charging adapter before using the product.

Electrical & Fire Safety

- Use only the indicated power/voltage.
- Secure the charging adapter so that it does not shake.
- Do not charge longer than necessary. A rise in temperature may cause a malfunction or fire.
- Avoid storage or use in temperatures above 50 ° C and high humidity.
- Turn off the power and charge when not in use.
- When unplugging the charging adapter, hold the terminal and unplug it. Pulling the cable may cause a malfunction.
- The body does not support a waterproof function. Do not immerse or wash the body and adapter in water. It may cause electric shock or a malfunction.
- Do not insert sharp objects into terminals or grooves. Doing so may cause electric shock or a malfunction.

07

Usage & Storage

- Do not use the product on any part of the body other than the lips.
- Use with dry lips after cleansing. If moisture or foreign matter are sucked in, it may cause a malfunction.
- When cleaning the lip guide, be sure to attach it to the body once it is completely dry.
- Do not leave the product on for a long time.
- Keep out of reach of children.
- When the product is not in use, attach the protective cap to the main body for storage.

08

Product Warranty

- If there is a defect in the product, the product can be repaired or exchanged within one year of the date of purchase.
- Warranty service and receipt of purchase (online card slip) may be required to receive service.
- If the date of purchase cannot be confirmed, the date of purchase will be set as 60 days after the date of manufacture.
- Customers will be charged for any defects caused by their own use, such as abnormal use, shock, incorrect power usage, natural disasters, non-compliance with manuals, and other failures and damages caused by customer negligence, regardless of the warranty period.
- Any disassembly, repairs, or modifications done by the user are not covered under the warranty policy, regardless of the warranty period.

After Sales Service

- After sales service is available through the site or store you purchased.
- Warranty repair and replacement are only available for products purchased through a full source of importation.

After Sales Service
www.narci.kr

FCC Interference Statement

This equipment has been tested and found to comply with the limits for a Class B digital device, pursuant to part 15 of the FCC Rules. These limits are designed to provide reasonable protection against harmful interference in a residential installation. This equipment generates, uses and can radiate radio frequency energy and, if not installed and used in accordance with the instructions, may cause harmful interference to radio communications. However, there is no guarantee that interference will not occur in a particular installation. If this equipment does cause harmful interference to radio or television reception, which can be determined by turning the equipment off and on, the user is encouraged to try to correct the interference by one or more of the following measures:

- Reorient or relocate the receiving antenna.
- Increase the separation between the equipment and receiver.
- Connect the equipment into an outlet on a circuit different from that to which the receiver is connected.
- Consult the dealer or an experienced radio/TV technician for help.

FCC Caution

- Any changes or modifications not expressly approved by the party responsible for compliance could void the user's authority to operate this equipment.

- FCC Compliance Statement(Part 15.19 (3))

This device complies with part 15 of the FCC rules. Operation is subject to the following two conditions: (1) This device may not cause harmful interference, and (2) this device must accept any interference received, including interference that may cause undesired operation