

3 To turn the Remote and Receiver on

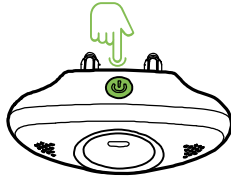

Press and hold the "⏻" for 3 seconds to turn on or turn off the Remote.



Press the button to turn on the Receiver, the green LED flashes.

5 Beep Tone command

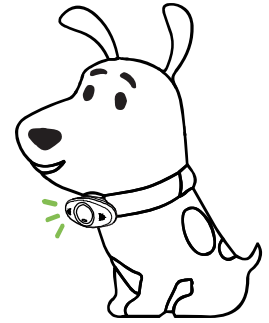
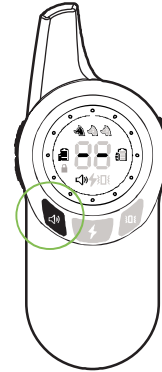

Delivers a beep tone with non-adjustable volume to the collar.

4 Keypad Lock

Press the "⏻" to lock or unlock the screen in the power-on.

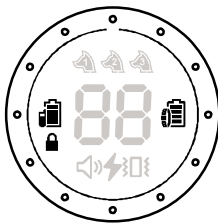
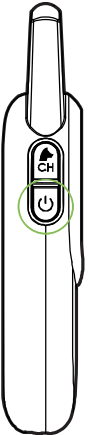

lock

6 Vibration command

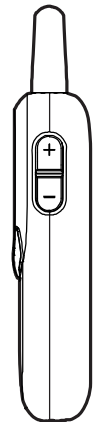
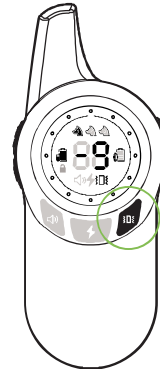

Delivers vibration to the collar.
Vibration Intensity adjustment: Press the "+", "-" button to set "0-9" levels of the Remote.

7 Static Stimulation command

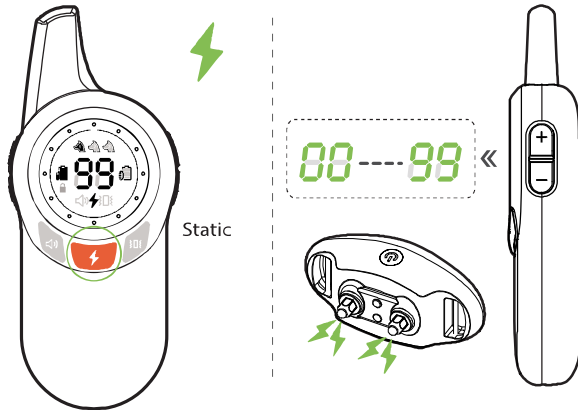

Delivers vibration to the collar.
Vibration Intensity adjustment: Press the "+", "-" button to set "00-99" levels of the Remote.

8 Select the dog to train

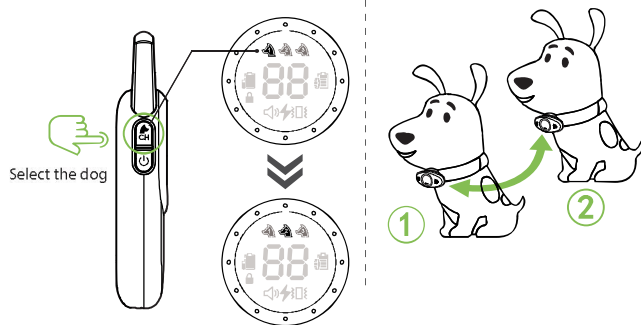

Press the remote "CH" button to select the dog. (For example select dog 2).

Main Features



Vibration, Tone and Static training model



9 adjustable vibration level and 99 adjustable static level



Mini and humanized design, simply setting



Receiver collar IPX7 waterproof (Remote non-waterproof)



Remote range 650-850 feet



Long life Lithium Polymer battery



Big digital display



Save the settings of training



Support maximum 3 receiver collars with one remote



Magnetic charging port

⚠️ How to find the Best Static Level for Your Dog ?

Very Important: Always start at the lowest level and choose the level that is best for your dog.

Have 1 to 99 different Stimulation Levels. Follow the steps below to find the best Level:

- Step 1: Starting at Level 10 on the Digital Display, press the static button to see dog's reaction.
- Step 2: Move up through the Stimulation levels until your pet reliably responds to the Stimulation.
- Step 3: If your dog continues to show no response at Level 50, check the fit of the Receiver Collar. If your dog has long or thick hair, change to a longer set of Contact Points, or dog's hair will need to be trimmed around the Contact Points.
- If all of these steps have been done and dog continues to show no reaction, see the "How to Use Test Light Tool" section.

This device complies with Part 15 of the FCC Rules. Operation is subject to the following two conditions: (1) this device may not cause harmful interference, and (2) this device must accept any interference received, including interference that may cause undesired operation

NOTE: This equipment has been tested and found to comply with the limits for a Class B digital device, pursuant to Part 15 of the FCC Rules. These limits are designed to provide reasonable protection against harmful interference in a residential installation. This equipment generates, uses and can radiate radio frequency energy and, if not installed and used in accordance with the instructions, may cause harmful interference to radio communications. However, there is no guarantee that interference will not occur in a particular installation.

If this equipment does cause harmful interference to radio or television reception, which can be determined by turning the equipment off and on, the user is encouraged to try to correct the interference by one or more of the following measures:

- Reorient or relocate the receiving antenna.
- Increase the separation between the equipment and receiver.
- Connect the equipment into an outlet on a circuit different from that to which the receiver is connected.
- Consult the dealer or an experienced radio/TV technician for help.

Warning: changes or modifications not expressly approved by the party responsible for compliance could void the user's authority to operate the equipment

The devices has been evaluated to meet general RF exposure requirement , the device can be used in portable exposure condition with restriction