

Automatic Pet Feeder

Quick Start Guide

PF56

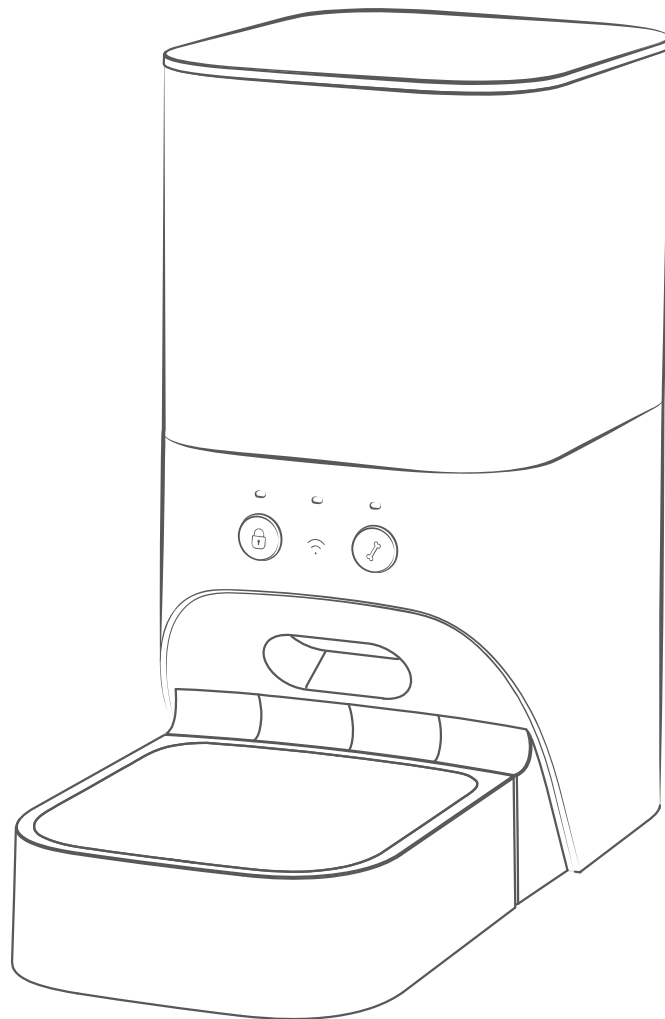

MENU

Customer Service	1
Product Structure	1
LED Indicator States	2
Automatic Feeder Installation	3
Quickly Setting Guide	6
FQA	13

Customer Service

Warranty

- Extend the Warranty to 24 Months via vip@hifaroro.com
- Timely customer service via support@hifaroro.com

Social Channel

- If you want to join Faroro VIP Club, contact +8619875189658 via WhatsApp or Telegram
- Facebook for New Release product information and Holiday Promotion - Faroro
- YouTube for instruction Videos - Faroro Official

Product Structure

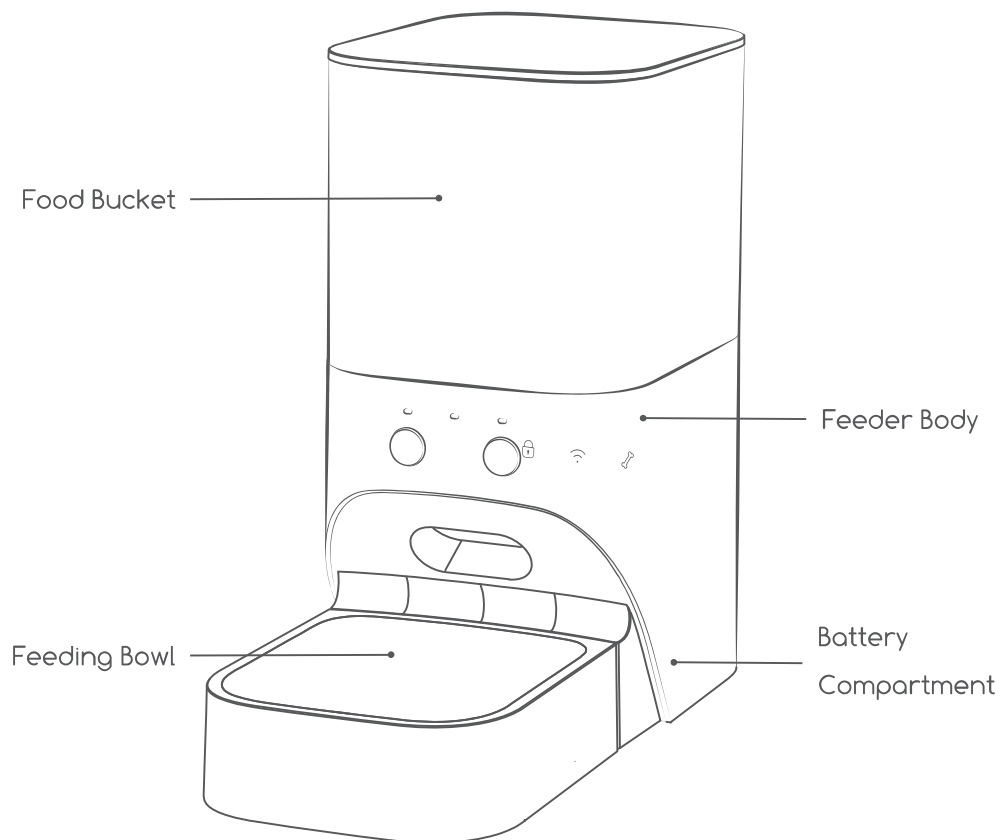

LED Indicator States

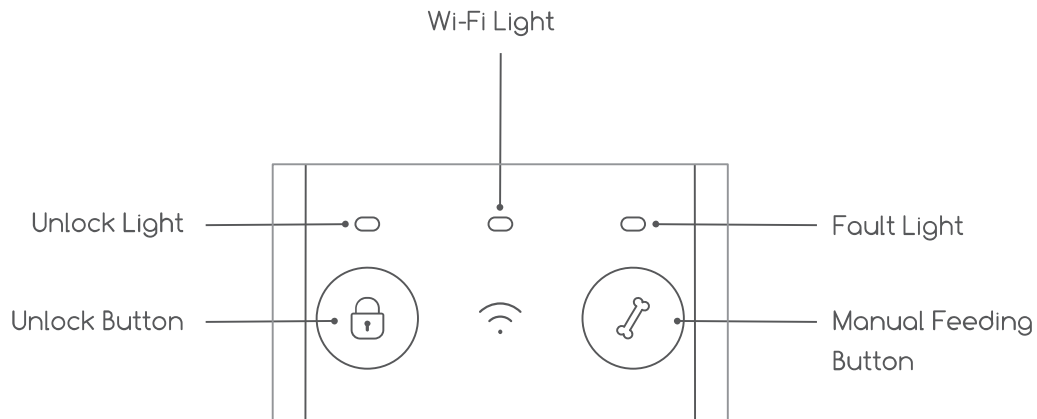

Power Indicator States / Button operation	Meaning
In standby mode (no food output), press the unlock button and the manual feeding button at the same time until the Wi-Fi indicator flashes.	The Wi-Fi reset, at this time, the device needs to be reconnected with the app.
Wi-Fi light flashing.	Waiting for connection.
The fault light is red.	There is not enough food in the food bucket. It will go out automatically after adding food.
Long press the unlock key, and the unlock light will turn green.	Unlocking status. It can be fed by manual feeding button.

Warm Tips:

1. When the Manual Feeding Button is clicked, the number of servings to be fed is determined by the number of servings during the scheduled feeding or the APP-controlled feeding. If the APP has never been operated, the default number of servings is 5.
2. In the unlocked state, the unlock indicator is on. One minute after unlocking, it will automatically enter the locked state, and then the unlocking light will go out.

Automatic Feeder Installation

1. Open the battery compartment at the bottom of the feeder.

- Use rechargeable battery to supply power: place the rechargeable battery in the "battery compartment", and insert the connector of the rechargeable battery into the "battery port".
- Use external power supply: insert the adapter power cord into the "adapter power interface", wind the excess power cord to the "winding rack" as needed, and exit at the "outlet".

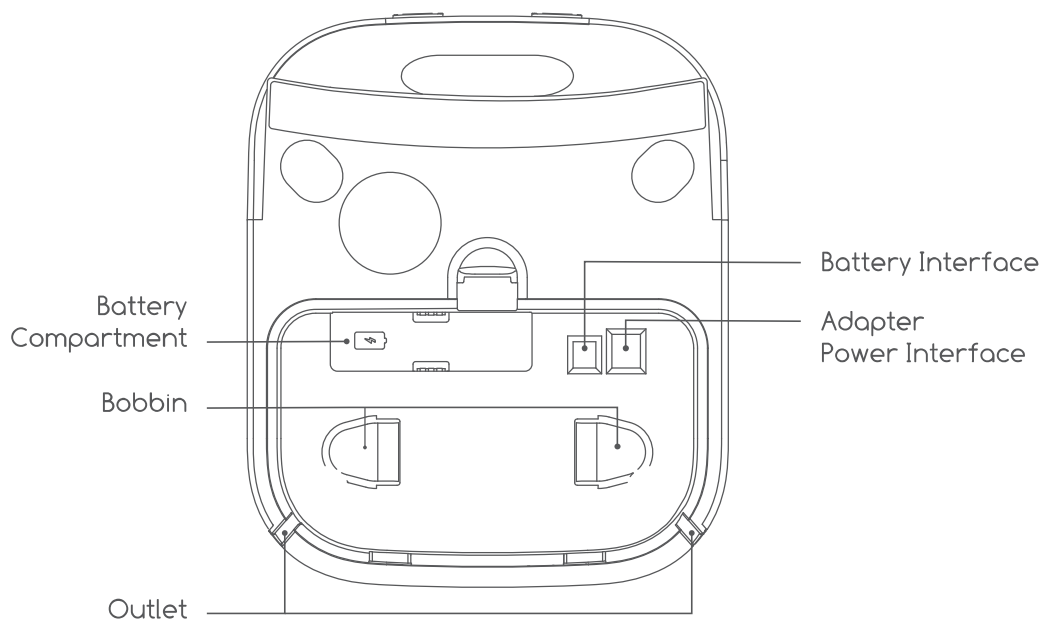

2. Automatic feeder assembly.

Tilt-up the feeder (feeder base and feeder bucket), close the side with the "ears" of the feeding bowl to the gap of the feeder, put down the feeder, and press down on the feeding bowl.

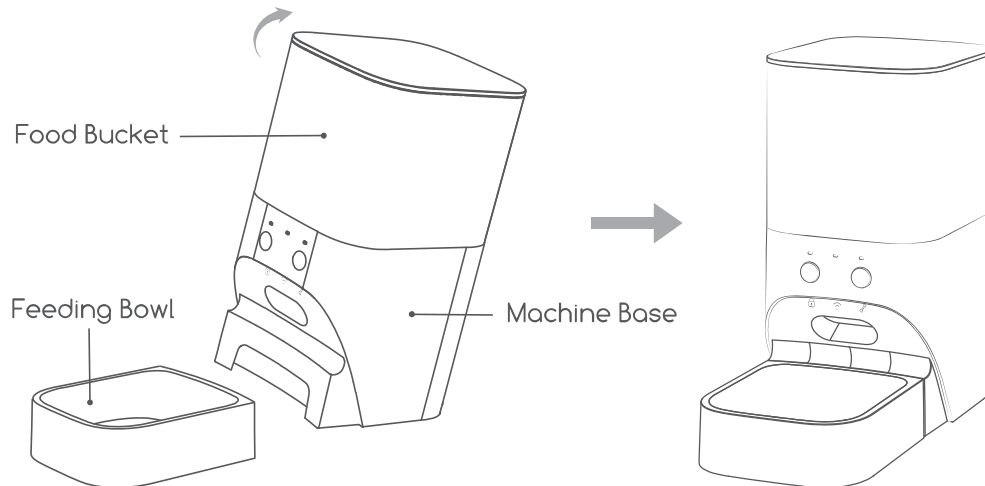

3. Add food to the food bucket

Open the lid of the food bucket: press the button on the back of the food bucket, and at the same time lift the lid up. Loosen the button on the other side to remove the lid. After adding food, close the food pail in the reverse order of removing the food pail cover.

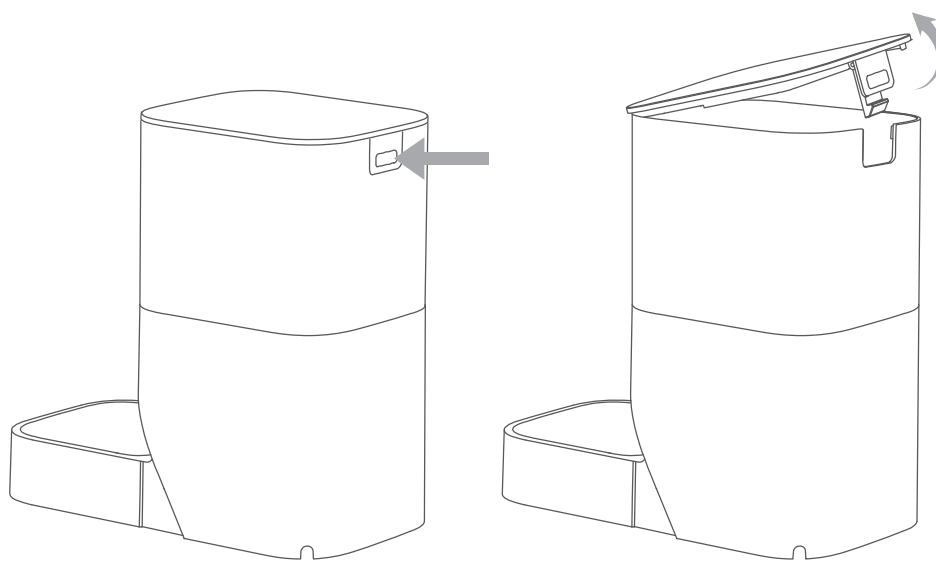

4. Remove and clean the food bucket

Remove the food bucket:

rotate the food bucket counterclockwise and lift it up;

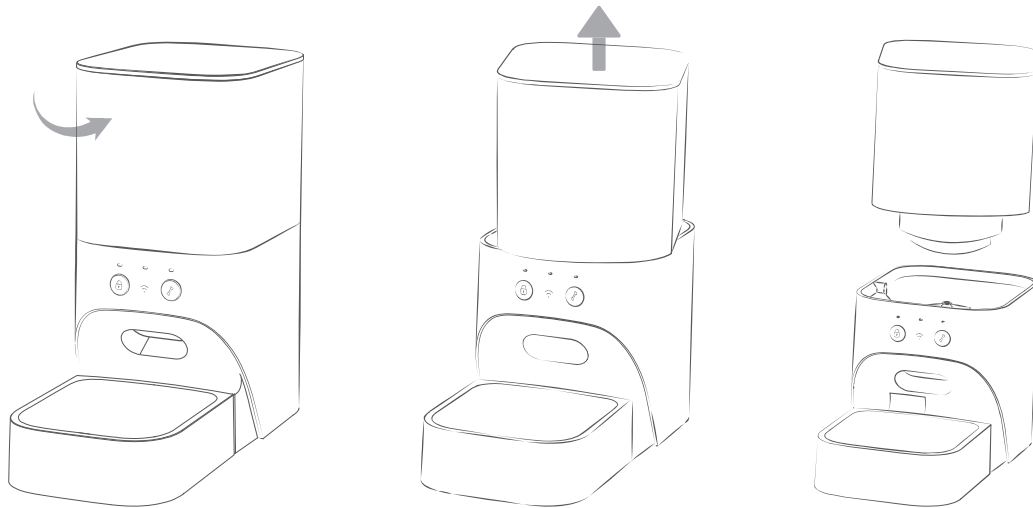

Remove the food tray: turn the food bucket over, grab the food tray, rotate the food tray counterclockwise and extract it from the top.

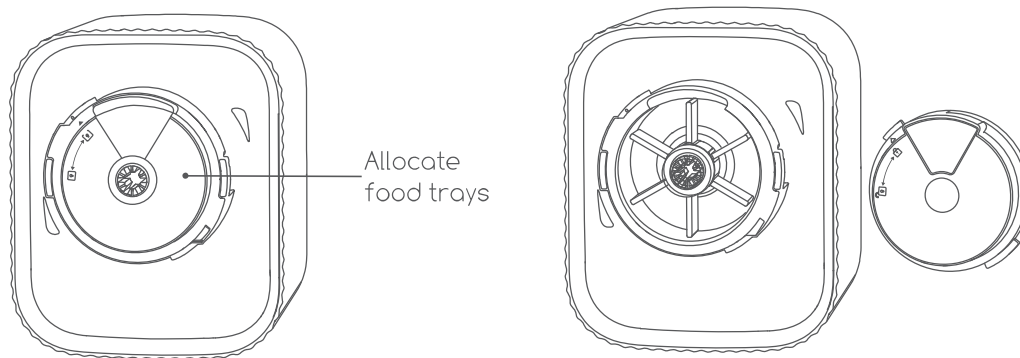

Warm Tips:

1. The main body cannot be washed with water, which will damage the electronic components. Please clean it with dry hands and a soft cloth.
2. The food bowl can be washed with water.

Quickly Setting Guide

Step1. Download the Faroro App

Search “Faroro” at App Store/ Google Play or Scan the QR Code to download the App and create your account.

Android



iOS



Step2. Ensure the feeder is waiting to be paired

Long press the unlock button and the blanking button at the same time until the Wi-Fi indicator flashes. Need to successfully connect with the feeder during the Wi-Fi indicator flashing.

Step 3. Wi-Fi Connection

(Two Wi-Fi Connection methods).

Connection method 1: Add Manually

1. Select Add Device then select “Wi-Fi Pet Feeder”.

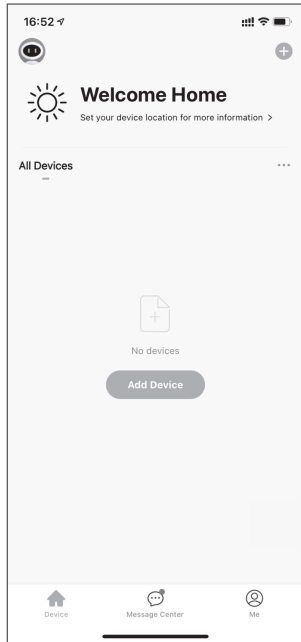

2. Select the 2.4G Wi-Fi network.

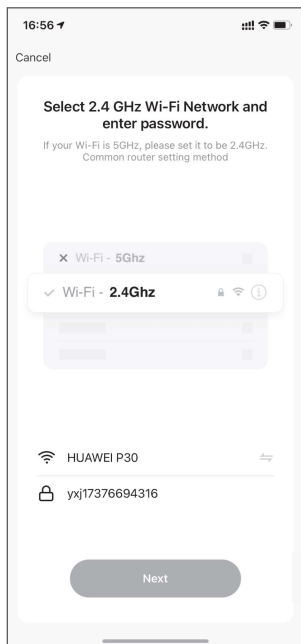

Warm Tips:

The feeder is 2.4G Wi-Fi only, if your Wi-Fi is 5G, please set it to be 2.4G.

How to set up 2.4G and 5G Wi-fi names?

If your router supports both the 2.4G and 5G bands, but only one Wi-Fi name is displayed on the Wi-Fi search page of your mobile phone, perform these steps.

- (1) Go to the Wireless page of the router. (The entry address is usually provided on the label attached to the back of the router).
- (2) Go to the 2.4G setting page, and set the Wi-Fi name (SSID) to xxx-2.4G, where xxx indicates the Wi-Fi name. Save setting.
- (3) Go to the 5G setting page, and set the Wi-Fi name (SSID) to XXX-5G, where xxx indicates the name. Save setting.

When the preceding settings are complete, the new Wi-Fi names will appear on the Wi-Fi settings page of your mobile phone.

Note:

After the Wi-Fi names are changed, you need to reconnect the devices that use this wireless router. The password remains the same if it has not been changed.

3. Select EZ Mode and ensure that the Wi-Fi indicator is blue and flashing rapidly then select "Next".

4. Wait for the connection.

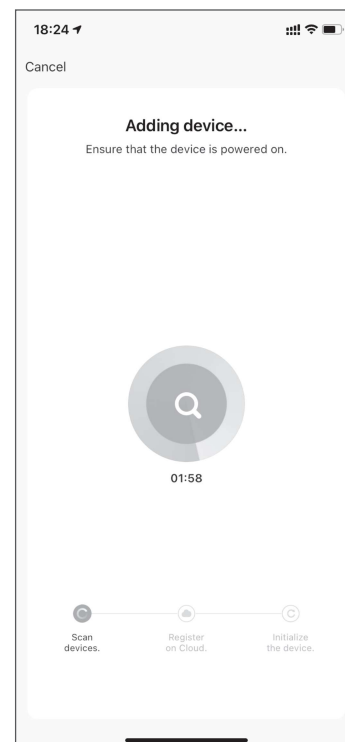
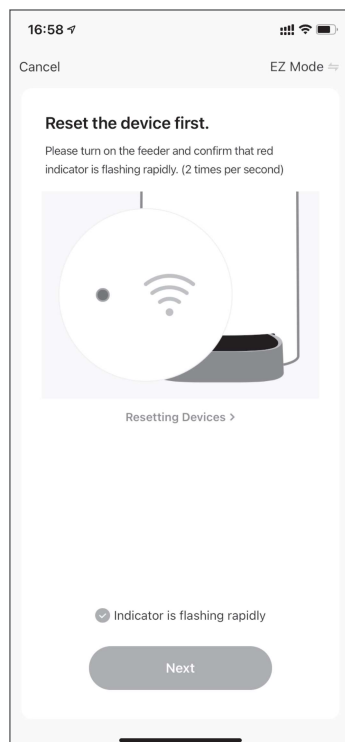

5. Connection Result.

- (1) Connect successfully, then you can refer to Step 4 and start your following settings.
- (2) Connect unsuccessfully.
 - Reset the feeder until the Indicator is flashing quickly
 - Check if it is 2.4G Wi-Fi
 - Verify the Wi-Fi password

All the checking finished, please back to Connection method 1 and connect your feeder again. if still fail to connect, please refer to Connection method 2.

Warm Tips:

If you still have troubles in connection, please feel free to connect us.

- (1) Timely customer service via support@hifaroro.com
- (2) Feedback via the "Faroro" app: Click "ME" in the navigation bar under the APP, you can find the "FAQ & Feedback", then submit your questions or advice here.

Connection method 2: Auto scan

1. Please make sure that the Bluetooth function of your phone is turned on.
2. Add Device and select "Auto Scan".
Select "Enable Bluetooth" and start searching.

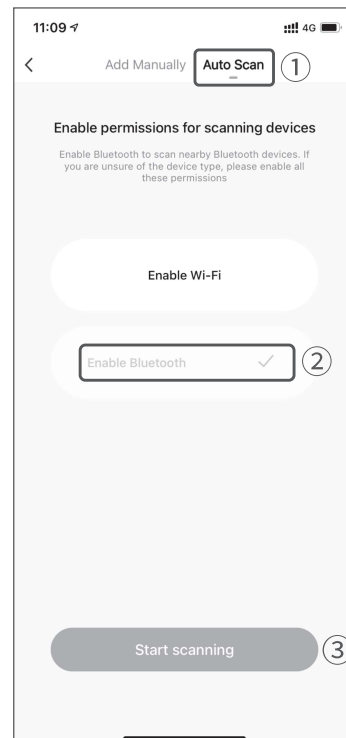
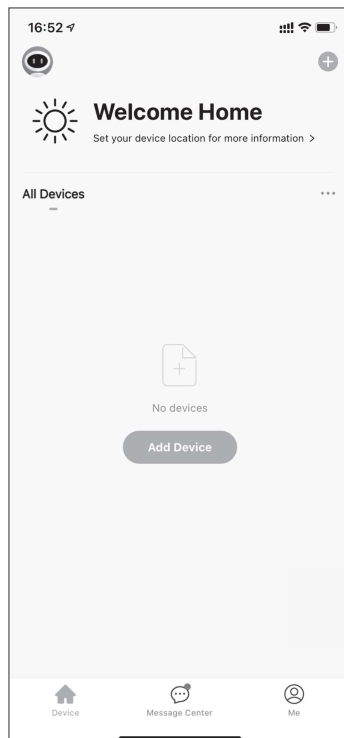

3. Wait for the search until the device appears and click "Next".

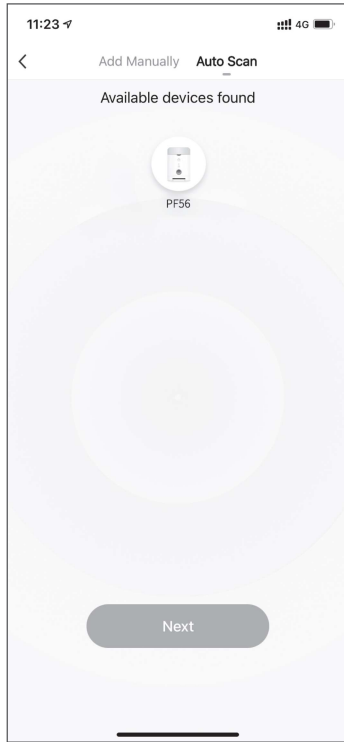

4. Connect 2.4GHz Wi-Fi in the pop-up window.

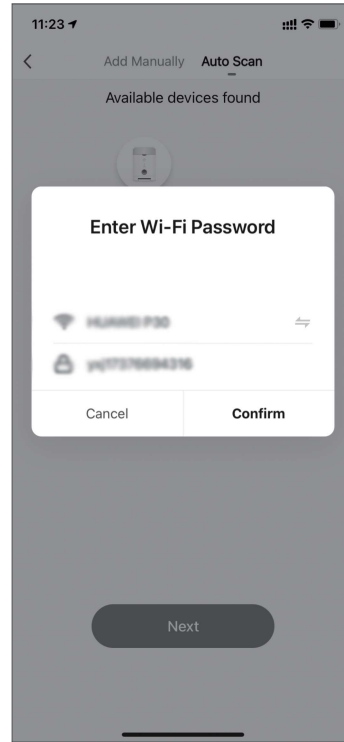

5. Waiting for connection.

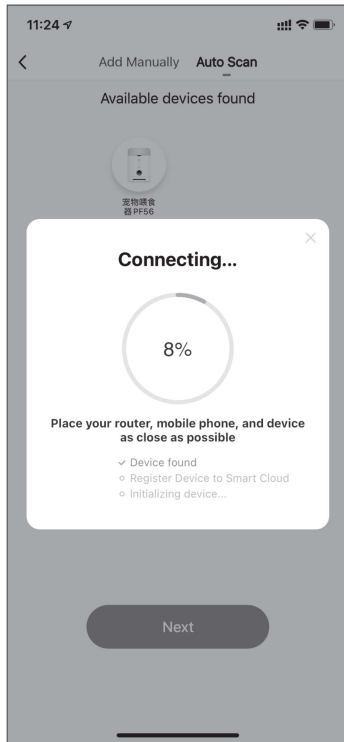

6. The connection is successful.

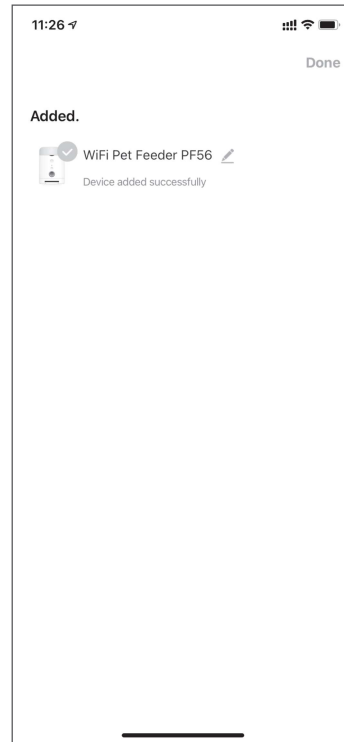

Step 4. Set the meals schedule and portions

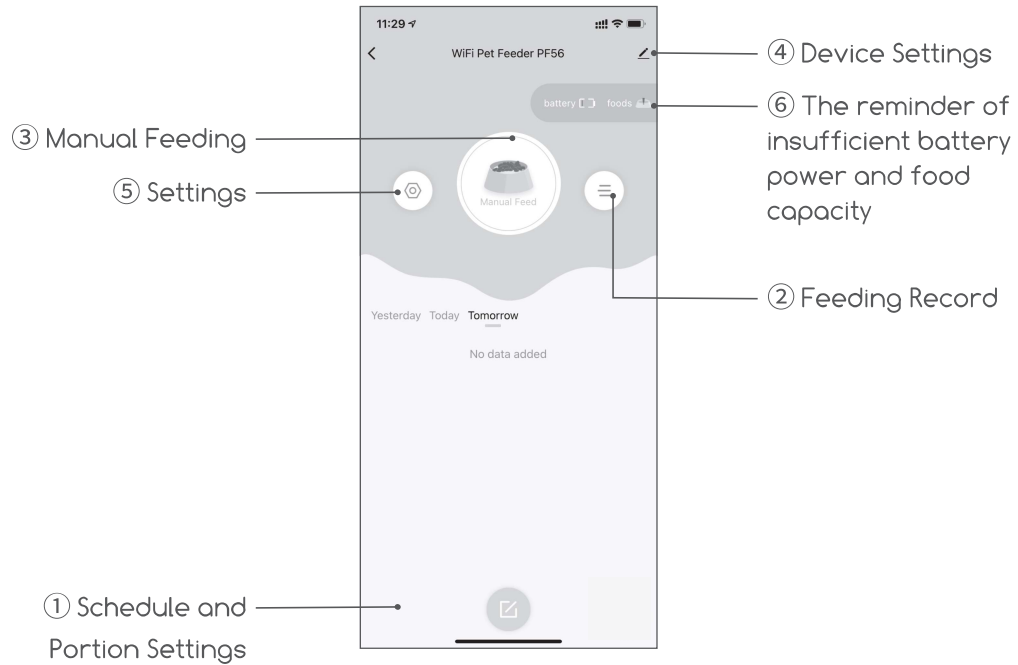

① Schedule and Portion Settings

You can set your feeding time, repeat and feeding portion of each meal here.

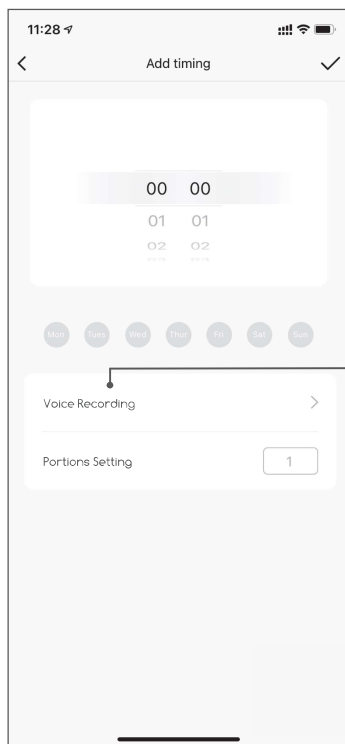

Voice Recording

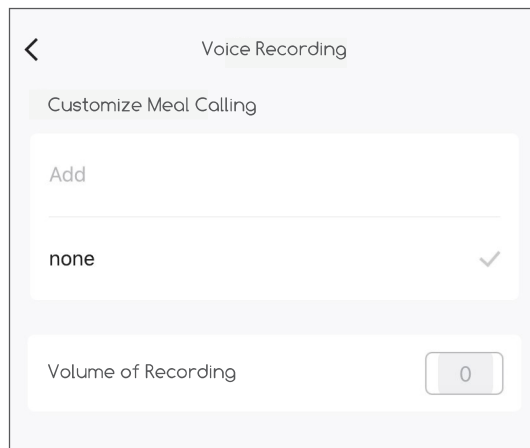

Warm Tips:

1. The feeding time is up to 15 meals a day.
2. We suggest you to set repeat from Monday to Sunday in case of any meal is missed
3. You can set almost 20 portions of each meal, and each portion depends on the food size, We suggest taking a few trials to provide the pet an appropriate portion.
4. You can record more than 60s customized voice message calling that played at each feeding dispenses to let your pet know when it's time to eat.

④ Device Settings

Here you can view and change your device information.

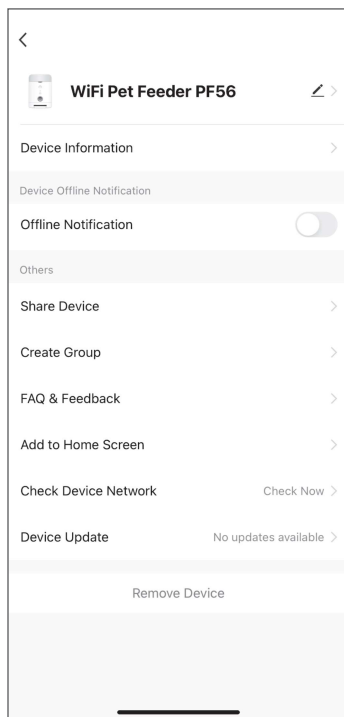

⑤ Settings

Adjust the device working settings here.

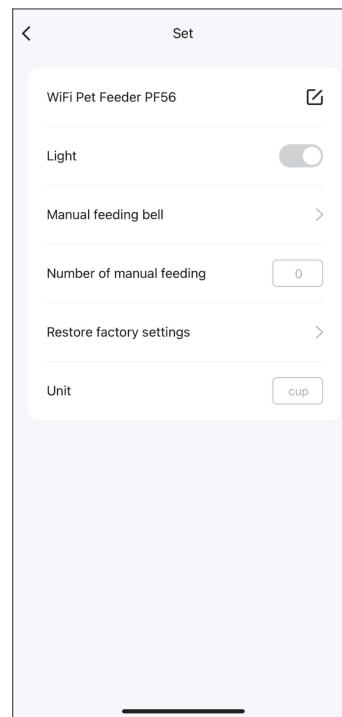

Warm Tips:

1. When the device is successfully connected to the network, the Wi-Fi light will always be on. You can turn it off in ⑤ Settings - Light.
2. Please set the number and unit of manual feeding by sliding up and down in the box.
3. Still don't know how to set? Please contact us by email: support@hifaroro.com
We will provide you with professional after-sales service.

FQA

Q1: How to restore factory setting?

A1: Long press the unlock button and the fault button at the same time until the wifi indicator flashes, the feeder is reset.

Please feel free to contact us at email support@hifaroro.com if this can't help you solve the problem.

Q2: Why the mobile phone could not connect to the feeder?

A2: The feeder supports 2.4GHZ Wi-Fi only. Make sure you are in 2.4G Wi-Fi circumstance, and ensure the Wi-Fi signal is good.

Please feel free to contact us at email support@hifaroro.com if this can't help you solve the problem.

Q3: How to do when have questions or suggestions?

A3: You can find us via the following two ways

- (1) Contact us to extend your Warranty to 36 Months via vip@hifaroro.com
- (2) Timely customer service via support@hifaroro.com. We will reply in 24h.



Made in China
Version 1.0

This device complies with Part 15 of the FCC Rules. Operation is subject to the following two conditions: (1) this device may not cause harmful interference, and (2) this device must accept any interference received, including interference that may cause undesired operation

NOTE: This equipment has been tested and found to comply with the limits for a Class B digital device, pursuant to Part 15 of the FCC Rules. These limits are designed to provide reasonable protection against harmful interference in a residential installation. This equipment generates, uses and can radiate radio frequency energy and, if not installed and used in accordance with the instructions, may cause harmful interference to radio communications. However, there is no guarantee that interference will not occur in a particular installation.

If this equipment does cause harmful interference to radio or television reception, which can be determined by turning the equipment off and on, the user is encouraged to try to correct the interference by one or more of the following measures:

- Reorient or relocate the receiving antenna.
- Increase the separation between the equipment and receiver.
- Connect the equipment into an outlet on a circuit different from that to which the receiver is connected.
- Consult the dealer or an experienced radio/TV technician for help.

Warning: changes or modifications not expressly approved by the party responsible for compliance could void the user's authority to operate the equipment

Radiation Exposure Statement

This equipment complies with FCC radiation exposure limits set forth for an uncontrolled environment.

This equipment should be installed and operated with minimum distance 20cm between the radiator and your body.