

# Quick start guide

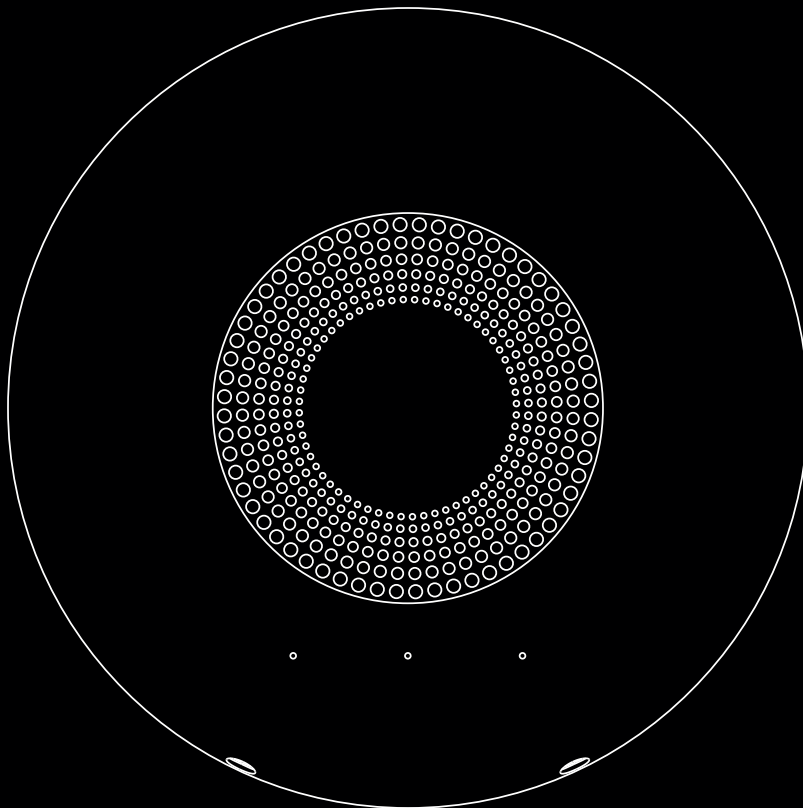

# What's included

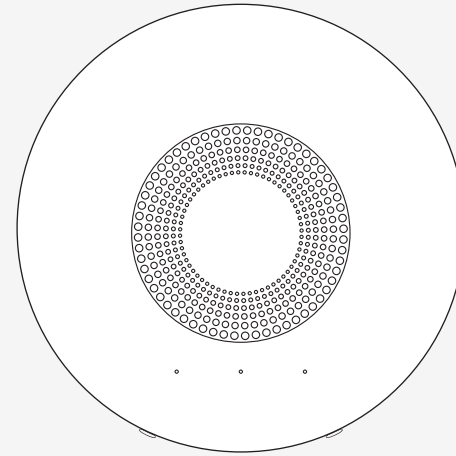

E1 device



Remote

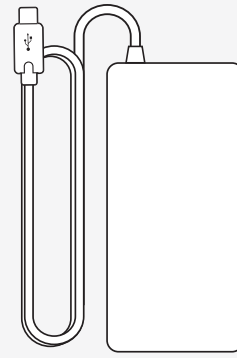

USB-C power supply

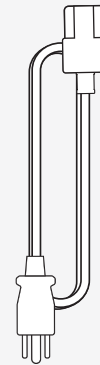

Power cable

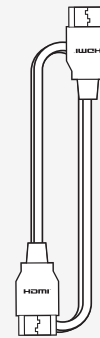

HDMI cable



USB-C to USB-A adapter

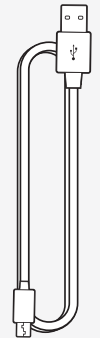

Micro-USB cable

# Remote

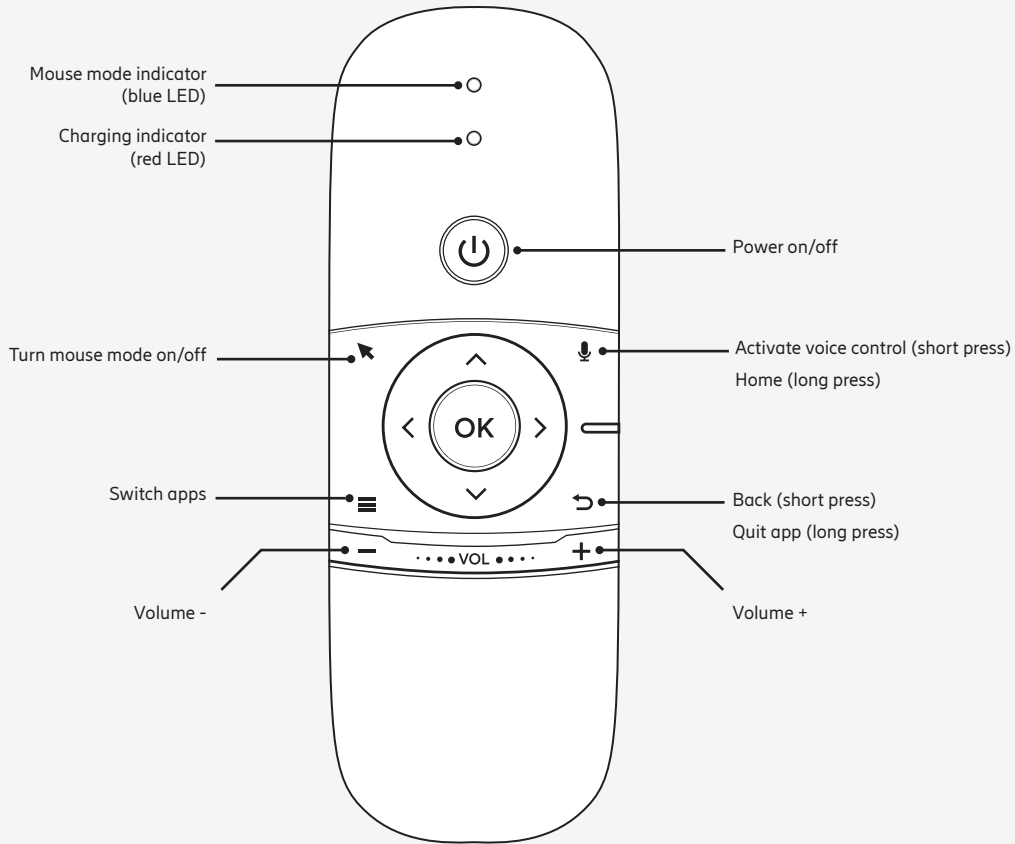

## 1 Turn upside down

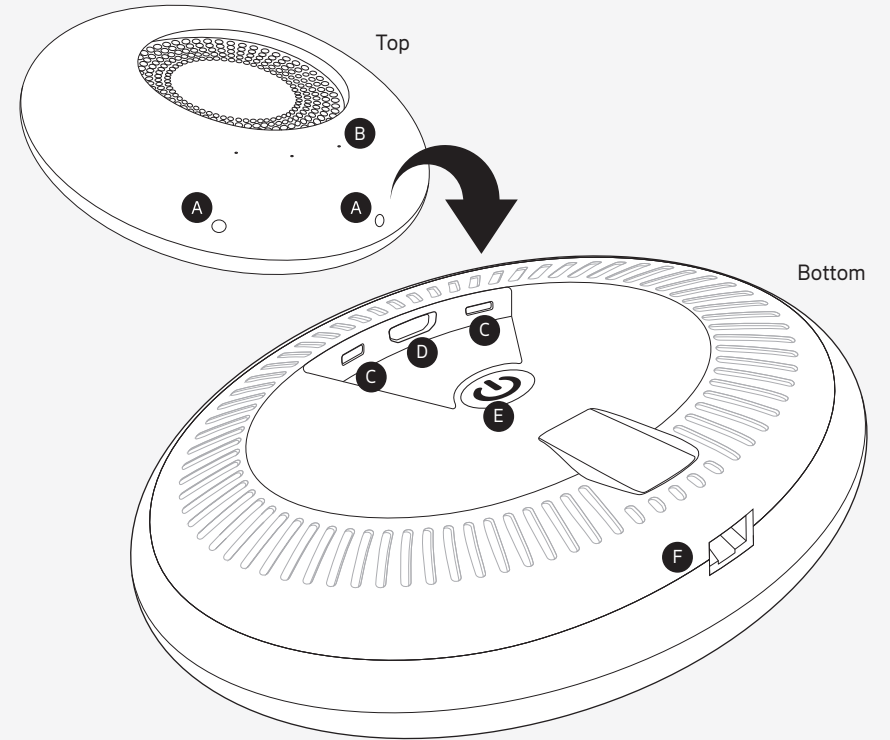

- A Cameras
- B Microphones
- C USB-C ports
- D HDMI port
- E Power button
- F Ethernet port(s) (if you have a router model it has two Ethernet ports)

## 2 Connect the E1 device to your TV

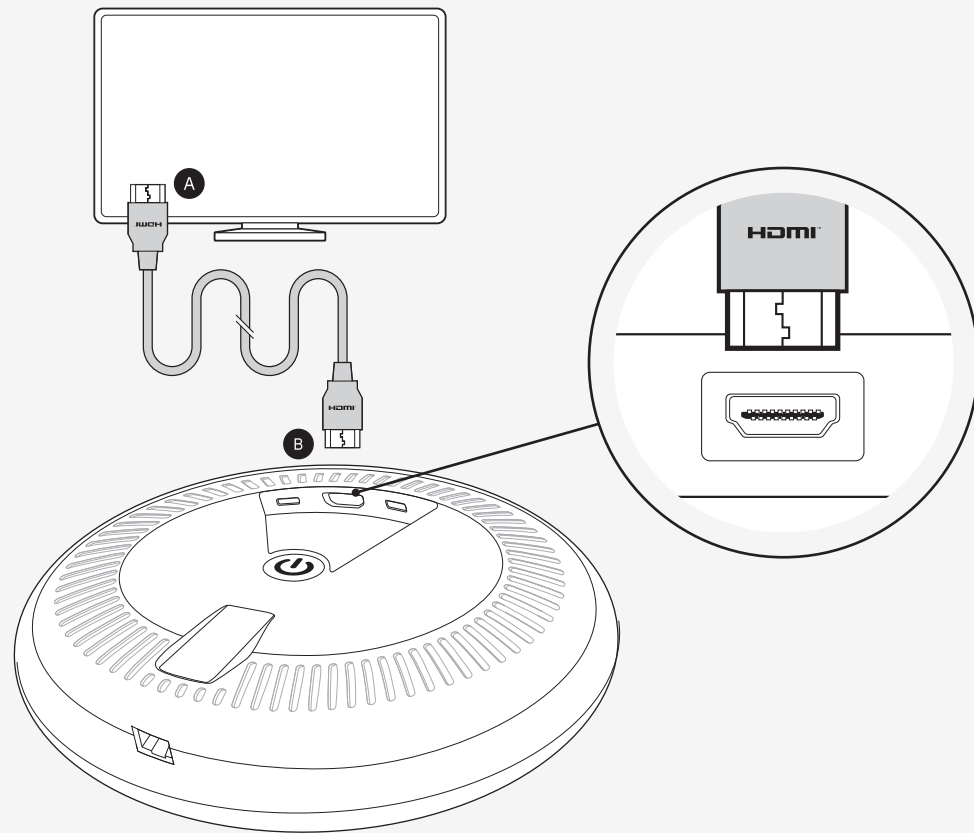

- A Plug an HDMI cable into your TV
- B Plug the other end of the cable into the HDMI port on the bottom of the E1 device

## 3 Connect the power supply

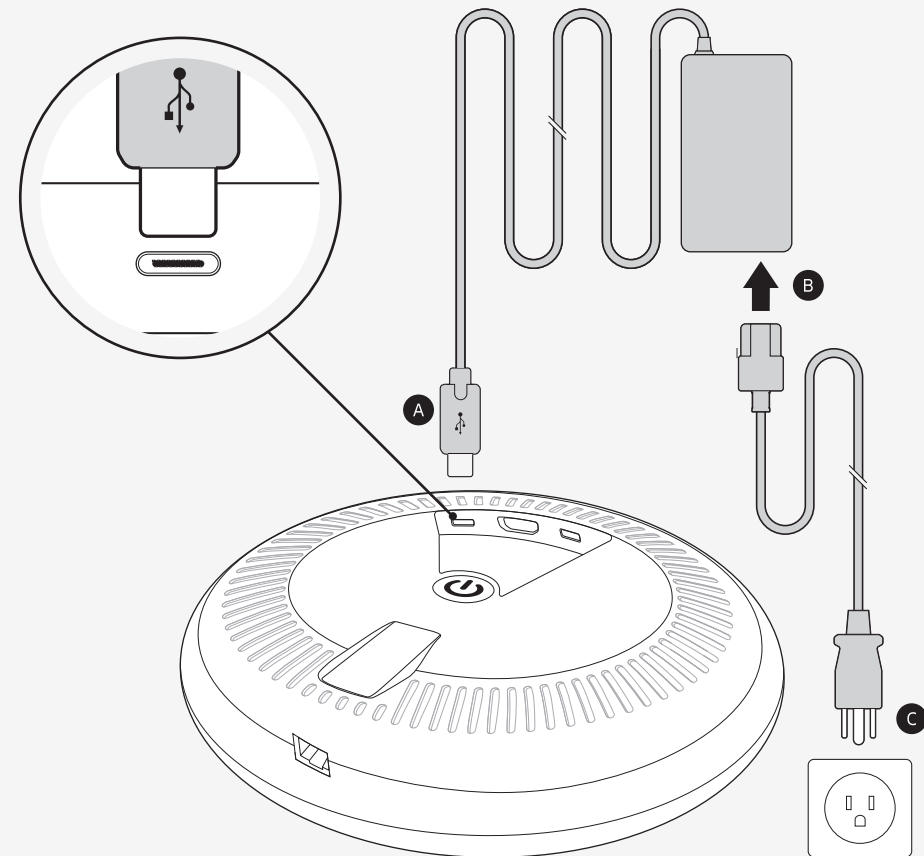

- A Connect power supply cable to USB-C port
- B Connect power cable to power supply
- C Plug into wall outlet

## \* Connect via Ethernet (optional)

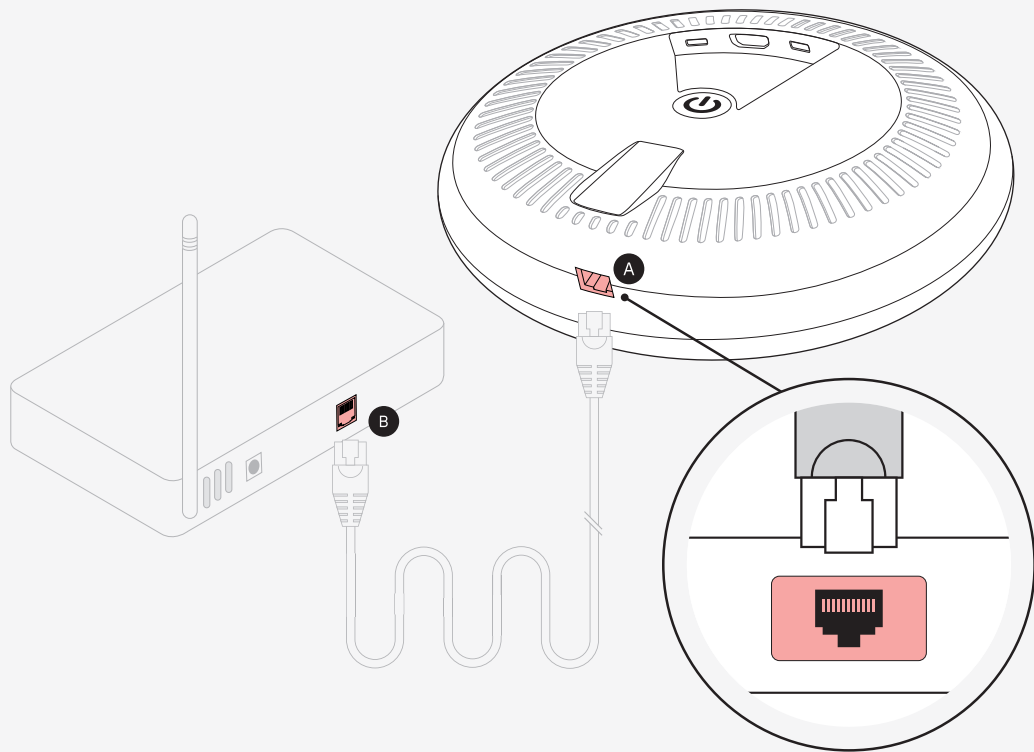

- A Plug an Ethernet cable into the E1 device
- B Plug the other end of the cable into your modem

If you would rather connect via Wi-Fi, you may do so using the on-screen setup once the E1 device is connected to your TV.

## \* Use as a wireless access point (optional - router model only)

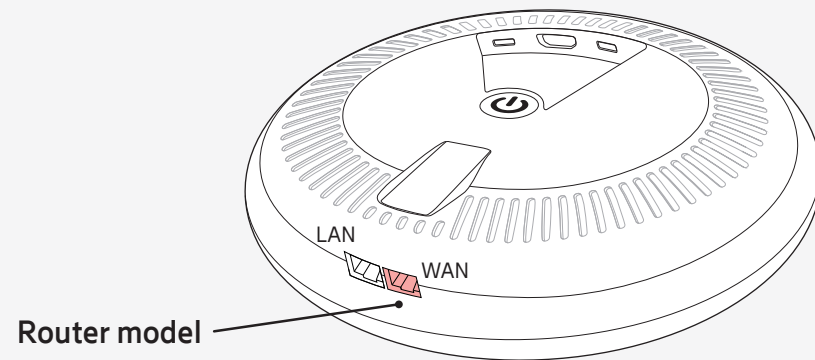

If you have a router model, you may use it as a wireless access point to connect other Wi-Fi devices. Refer to the router setup guide for more information.

## 4 Power on

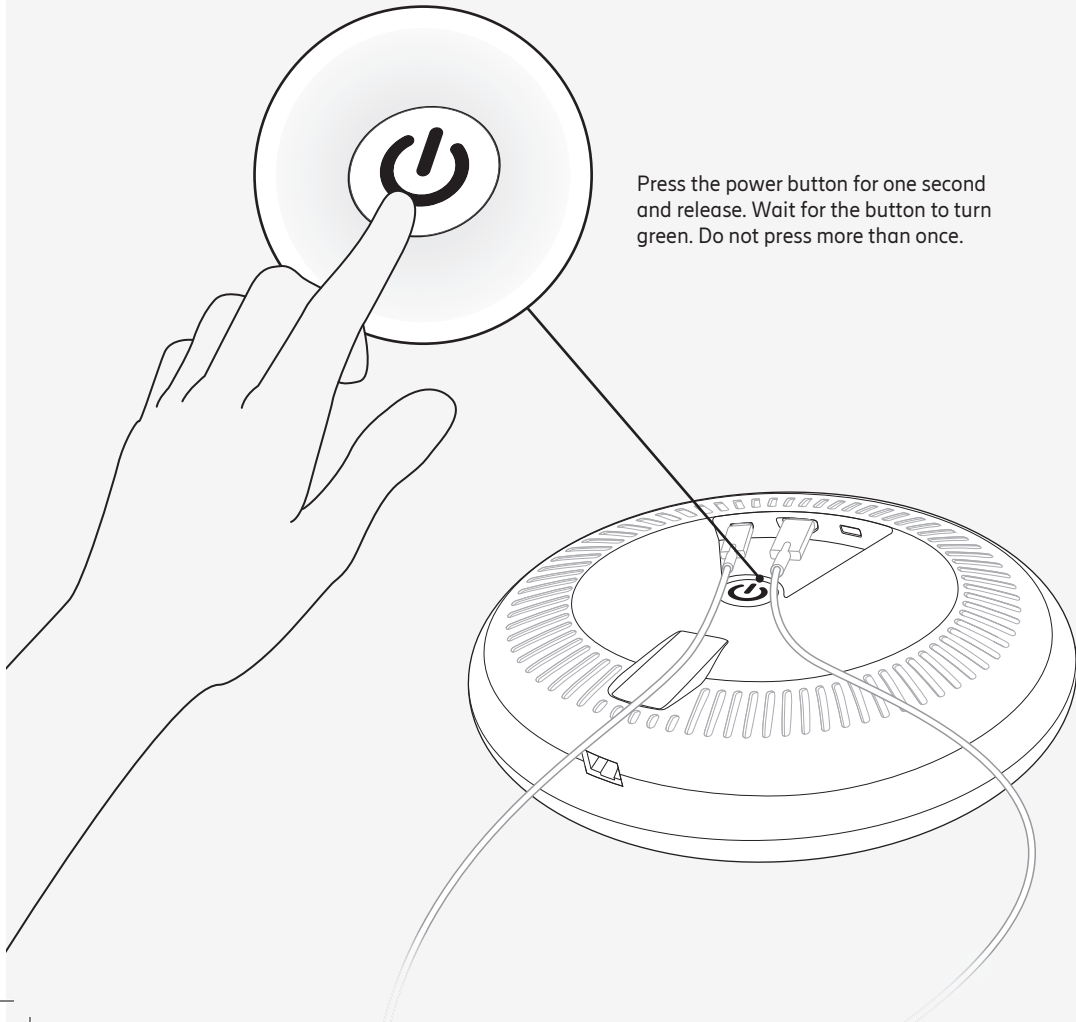

Press the power button for one second and release. Wait for the button to turn green. Do not press more than once.

## 5 Turn right side up

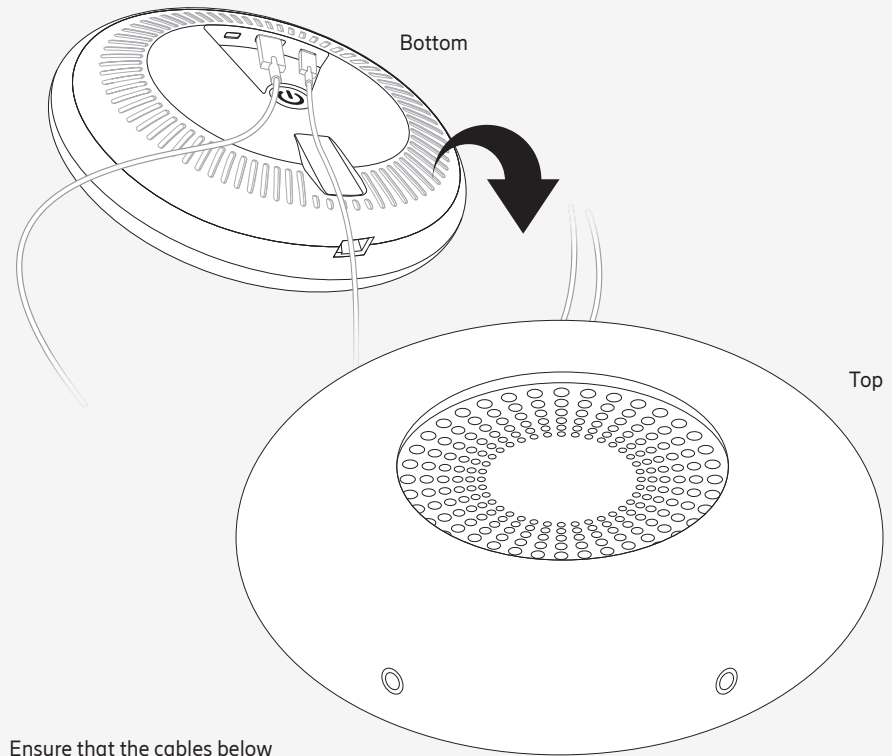

Bottom

Top

Ensure that the cables below the box aren't pushing the power button.

## 6 Placement

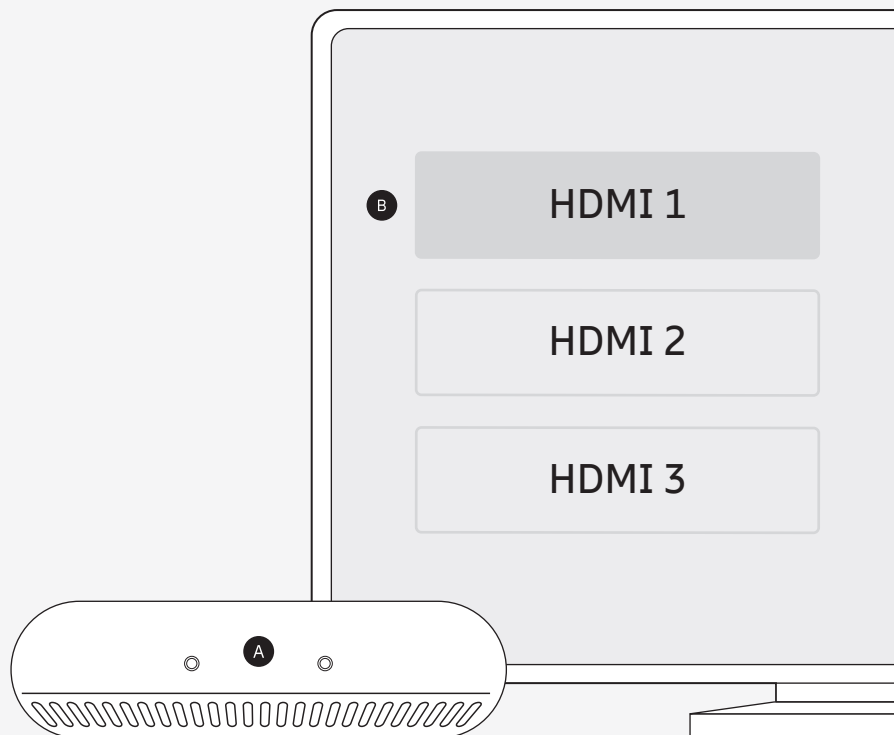

- A Position the E1 device right side up with cameras facing forward, and ensure the cameras have an unobstructed view of the room
- B Power on your TV, then select the HDMI input connected to the E1 device

## ✓ Success

Setup screen should appear on your TV.  
Press **OK** on the remote to begin. Follow the instructions on your screen.

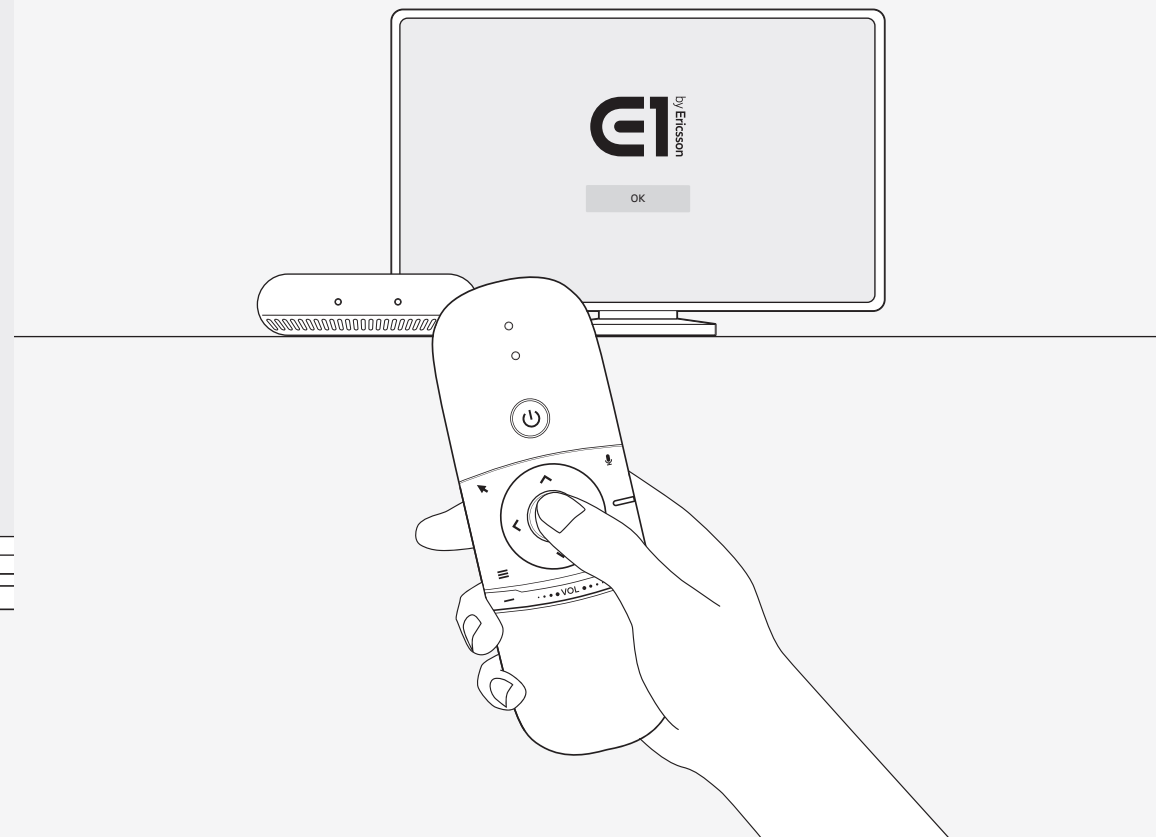



## Charging the remote

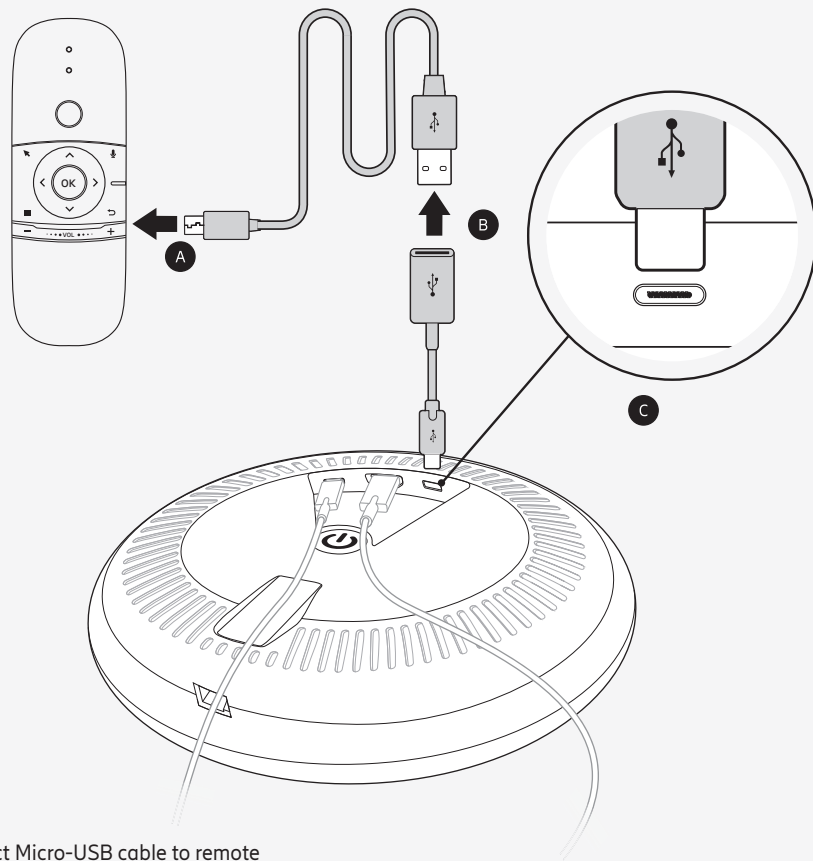

- A Connect Micro-USB cable to remote
- B Connect Micro-USB cable to USB-C to USB-A adapter
- C Connect USB-C adapter to USB-C port

Tip: Micro-USB cable can be plugged directly into any 5-Volt USB outlet



## Remote keyboard

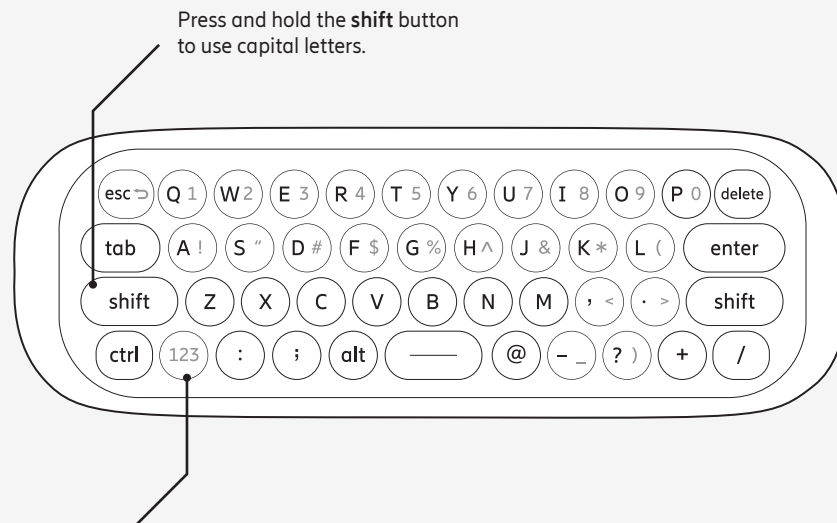

To use numbers and symbols in blue, hold down the 123 button while typing.





## Charging a game controller

(game controller not included)

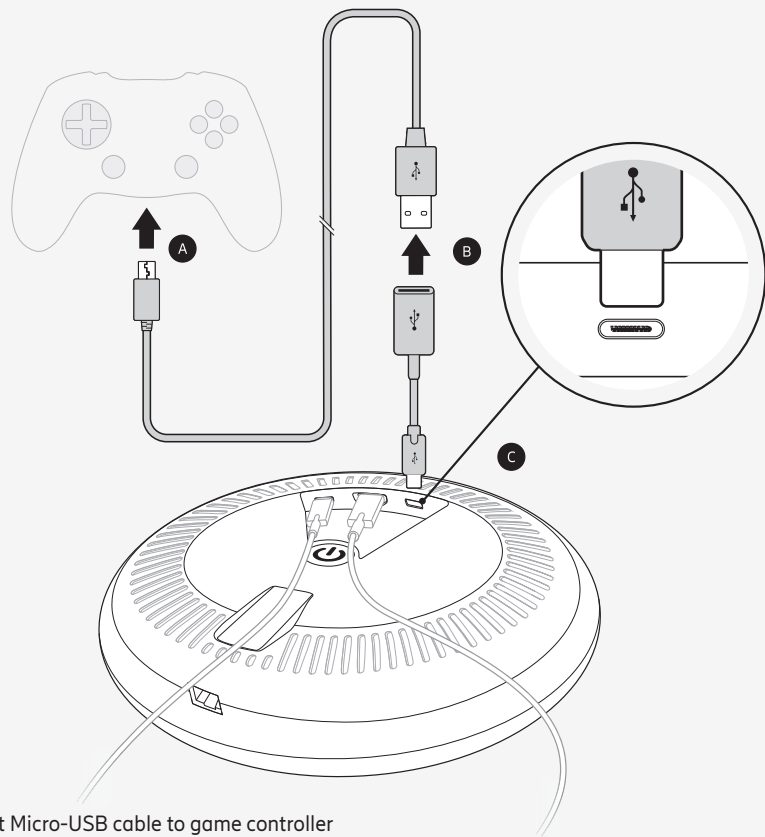

- A Connect Micro-USB cable to game controller
- B Connect Micro-USB cable to USB-C to USB-A adapter
- C Connect USB-C adapter to USB-C port

Tip: Micro-USB cable can be plugged directly into any 5-Volt USB outlet



## Common questions

### Why does my TV screen say "no input"?

Your TV may be set to the incorrect input or source. There's a quick fix for this! Just press the "input" or "source" button on your TV remote until you select the HDMI connection that matches the port your HDMI cable is plugged into on your TV.

### Why is there a mouse cursor on my screen?

If the remote moves a mouse cursor freely around the screen, it is in "mouse mode". Mouse mode is active if the blue LED on the remote is lit. To turn mouse mode on/off, press the mouse button  on the remote.

### How do I pair my remote?

The remote is pre-paired to the E1 device. If the blue LED on the remote is flashing slowly, pairing has been lost.

To re-pair:

- Turn off the E1 device and unplug power.
- Simultaneously press Volume + and - buttons on remote until the blue LED flashes rapidly.
- Plug in and power up the device.
- Hold the remote approximately 10 cm from the device during the pairing process.
- When the remote is paired, the blue LED will stop flashing and light up solid blue.

## ! Do not cover

Keep the upper vents clear and open.  
To prevent overheating, do not cover or  
place objects on top.

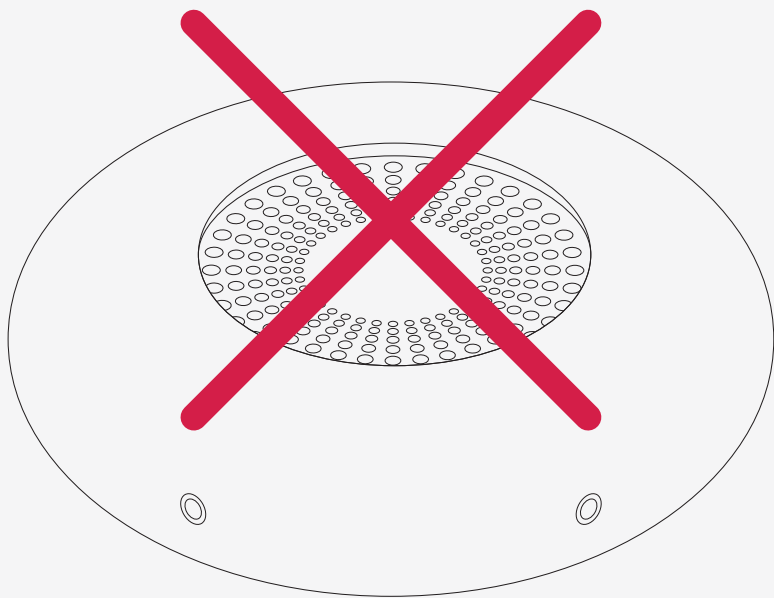

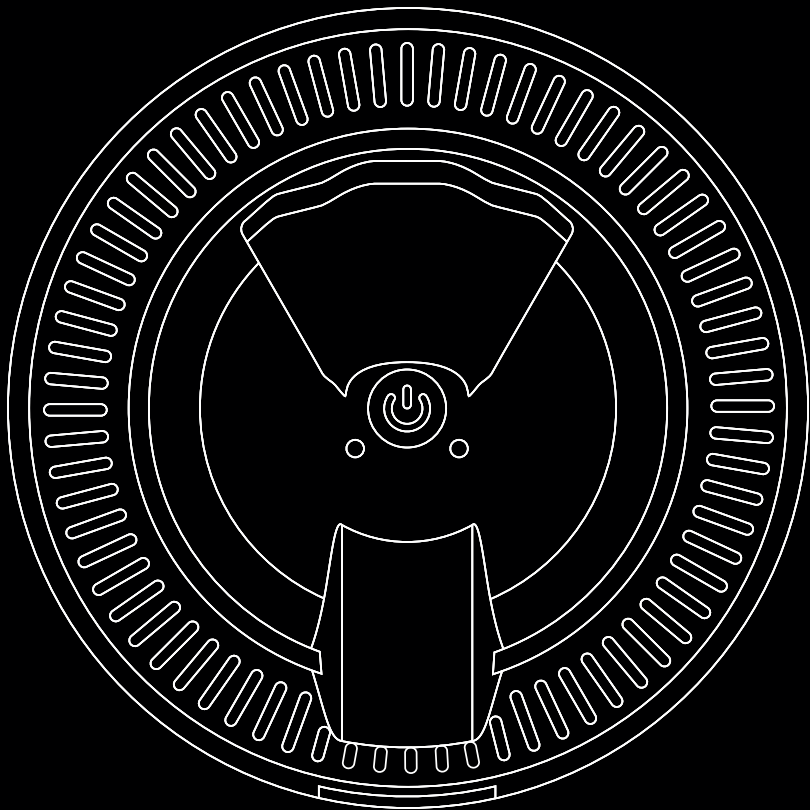

LZT 138 2195



## Regulatory Information

### **Federal Communication Commission Interference Statement**

This equipment has been tested and found to comply with the limits for a Class B digital device, pursuant to Part 15 of the FCC Rules. These limits are designed to provide reasonable protection against harmful interference in a residential installation. This equipment generates, uses and can radiate radio frequency energy and, if not installed and used in accordance with the instructions, may cause harmful interference to radio communications. However, there is no guarantee that interference will not occur in a particular installation. If this equipment does cause harmful interference to radio or television reception, which can be determined by turning the equipment off and on, the user is encouraged to try to correct the interference by one of the following measures:

- Reorient or relocate the receiving antenna.
- Increase the separation between the equipment and receiver.
- Connect the equipment into an outlet on a circuit different from that to which the receiver is connected.
- Consult the dealer or an experienced radio/TV technician for help.

**FCC Caution:** Any changes or modifications not expressly approved by the party responsible for compliance could void the user's authority to operate this equipment.

This device complies with Part 15 of the FCC Rules. Operation is subject to the following two conditions: (1) This device may not cause harmful interference, and (2) this device must accept any interference received, including interference that may cause undesired operation.

### **IMPORTANT NOTE:**

#### **FCC Radiation Exposure Statement:**

This equipment complies with FCC radiation exposure limits set forth for an uncontrolled environment. This equipment should be installed and operated with minimum distance 29cm between the radiator & your body.

## Safety Notice

This product is intended for indoor use only.

“CAUTION” Risk of explosion if the RTC battery is replaced by an incorrect type.

External surfaces that need not be touched to operate the equipment (< 1 s)

This unit is intended to be supplied by a Certified USB Type-C AC Power Adapter suitable for use at Tma 40 degree C whose output meets ES1, non-hazardous energy level, and is rated O/P: 5Vdc/3A or 9Vdc/ 3A or 15Vdc/ 3A or 20Vdc/ 5A. Use only the manufacturer supplied AC adapter approved for use with the device. Use of another AC adapter may change the compliance of the device and may present risk of fire or electric shock.



**WARNING** Do not use this product near water, for example, in a wet basement or near a swimming pool.



**WARNING** Avoid using this product during an electrical storm. There may be a remote risk of electric shock from lightning.



**WARNING** Do not block air ventilation holes.



**WARNING** Do not touch the bottom metal parts.



### Hot parts!

Burned fingers when handling the parts

Wait 20 minute after switching off before handling parts