

BOLLO

- USER MANUAL -

FOURING BOLLO Wireless Charger
- DA1121 -



CASE
MAX. 3MM

- 두께 3mm 이상의 보호 케이스는 사용하지 마십시오.
- Do not use protective mobile cases more than 3 mm thick.



USE
AE FILM

- 안전한 장착을 위해 동봉된 AE 필름을 부착 후 알파링을 장착하십시오.
- Use the enclosed AE film when attaching Alpha Ring.



BE
CENTERED

- 알파링을 휴대폰 뒷면 중앙에 장착해야 최적의 충전 효율을 낼 수 있습니다.
- For maximum charging efficiency, attach to the rear center of the phone.



AVOID
WATER

- 알파링에 물이 들어가지 않게 주의하시고, 물이 들어갔을 때는 완전히 자연건조 후에 사용하십시오.
- Avoid using product in wet conditions.

Categories	Specification	Remark
Product Name	FOURING BOLLO Wireless Charger	DA1121
Certified By	WPC 1.2	FOD (Foreign Object Damage) feature
Operating Frequency	110 ~ 123kHz	WPC Operating Area
Input	DC9V / 1.67A	RX Power : 9W (Max)
Operating Temperature	-20°C ~ +60°C	-
Manufacturer	WLT Co., Ltd.	Made in China
Address	#205, 175, LS-ro, Gunpo-si, Gyeonggi-do, Korea	-
A/S	+82-70-7720-5900	-

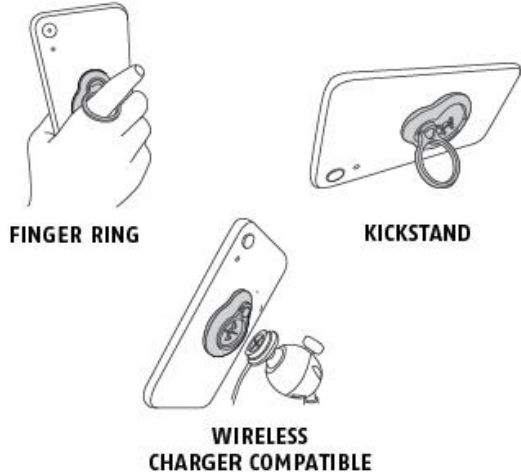

FINGER RING

KICKSTAND

WIRELESS
CHARGER COMPATIBLE

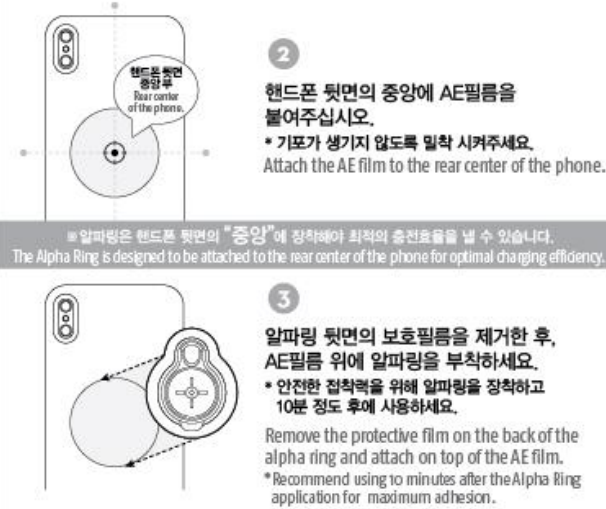
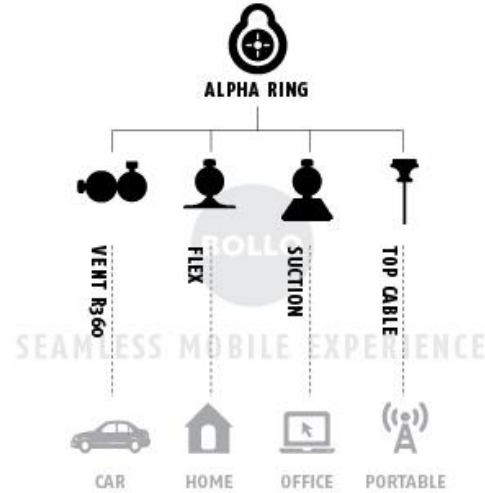

FCC Part 15.19

This device complies with part 15 of the FCC Rules. Operation is subject to the following two conditions: (1) This device may not cause harmful interference, and (2) this device must accept any interference received, including interference that may cause undesired operation.

FCC Part 15.21

Any changes or modifications (including the antennas) to this device that are not expressly approved by the manufacturer may void the user's authority to operate the equipment.

FCC RF Radiation Exposure Statement:

This equipment complies with FCC RF Radiation exposure limits set forth for an uncontrolled environment.
This device and its antenna must not be co-located or operating in conjunction with any other antenna or transmitter.]