



Data Logger Wifi Stick Quick User Guide

DLS Version: 2.4



Delivery Content

- 1 pc WiFi
- 1 pc WiFi external antenna
- 1 pc Data Logger Wifi Stick Quick User Guide

Introduction

Data Logger Wifi Stick is mainly used in inverters to realize simple and quick access to Internet. Users can easily check device information by logging in the monitoring center. The communication topology is as shown below:

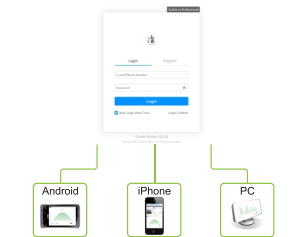

Description of Symbols

To ensure normal use of the datalogger, before using the datalogger, be sure that:

- The connected wireless router can normally access to Internet;
- The communication address of the inverter MUST BE "01", which is default value.
- A WiFi-enabled mobile phone is connected to this device for parameter setting.

1 Electrical Connection

Connect WiFi to the corresponding interface on the inverter. Solis-1P5K-4G is used as an example in this manual. Please perform relevant operations as indicated below:

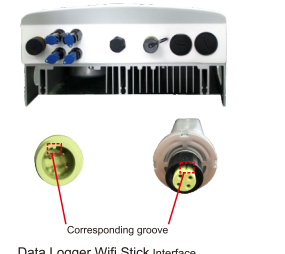

- Data Logger WiFi Stick Installation
- Insert WiFi Stick to COM port.
 - Rotate the black circle clockwise while pushing the datalogger. (do not rotate the datalogger housing directly)

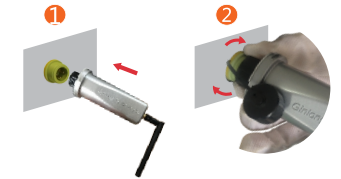

NOTES
The datalogger must be kept away from large metal objects and electrical devices with strong magnetic fields, such as microwave oven, refrigerator, cordless phone, concrete wall, PV panel and metal wall, to ensure the communication quality. Communication quality may be affected in lightning storms.

2 Create Solis monitoring account

Step 1: Mobile phone scan the QR code to download the APP, or in the APP Store or Google Play search Solis Home or Solis Pro.



Step 2: Click on the "Register".

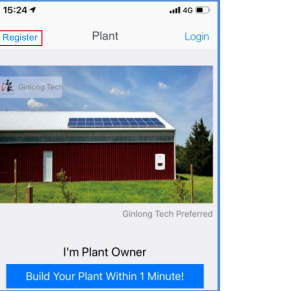

Step 3: Fill in the form as required and click the "Register".

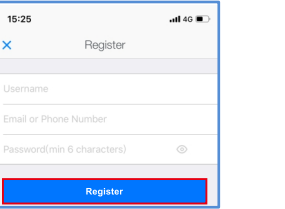

3 Create plant

Step 1: In the APP homepage and click "Build Your Plant Within 1 Minute!" in the middle of the screen. Or click the "+" in the upper right corner.

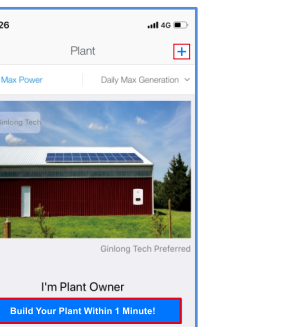

Step 2: Enter the SN of the datalogger. The datalogger SN can be automatically scanned by placing the purchased device bar code in the scan box. If you can't scan, you can also manually enter the datalogger SN (just enter the digital serial number).

Note: Please scan the SN number on the datalogger, not the SN number on the inverter.



Step 4: Enter the plant name and contact information of the plant owner. Then click the "Done".

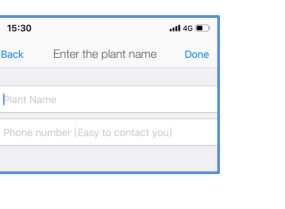

4 Configure WiFi

Step 1: Click the "Connect" on the Device interface.

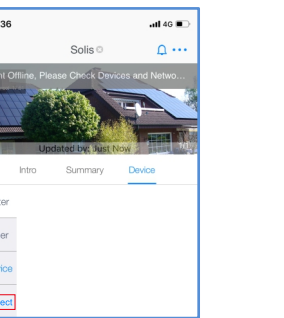

Step 2: Make sure phone connected to yourself router WiFi network. Then click the "Next".

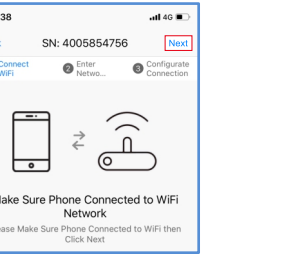

5 Distributor/Installer create plant

Step 3: Enter WiFi Password and click the "Ensure".

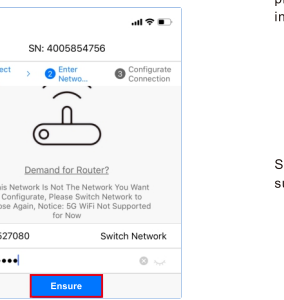

Tip: if you cannot connect to WiFi, try the following.

- If the signal strength of the selected network is <15%, the connection is unstable, please adjust the router's antenna position or increase the relay.
- The router's SSID and password do not use!@#\$%&*.,:()'"? and other special characters.
- Some enterprises may limit the WiFi connection, so it is recommended closing limit function of the Qos.
- Support the normal routing encryption (WEP/WPAPSK WPA2PSK), does not support mixed multiple encryption methods.
- Open the router's DHCP function, otherwise unable to connect to router wifi.

Step 4: Switch to the WLAN interface, connect your phone to "AP_XXXXXXX", and switch to the APP interface.

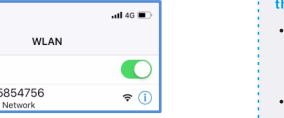

Step 5: Wait 1-3 minutes, until the configuration is successful.

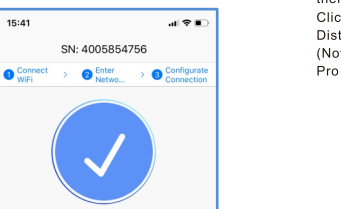
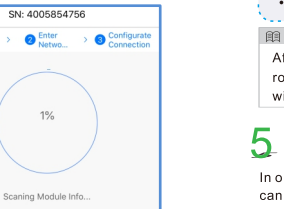

6 Link distributor/installer

Step 1: In order to easy manage to your plant. Select the plant and enter Intro. Click the "Installer" or "distributor".

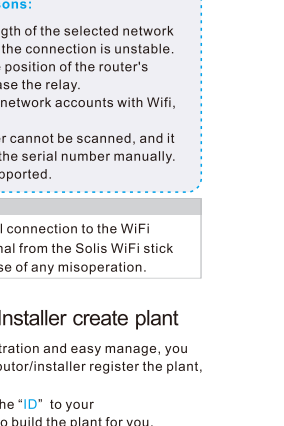

Step 2: Enter the company name of the installer or distributor. Then click the "Search".

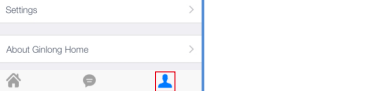

7 FCC Certification

This device complies with part 15 of the FCC Rules. Operation is subject to the following two conditions: (1) This device may not cause harmful interference, and (2) this device must accept any interference received, including interference that may cause undesired operation.

FCC warning:
Any Changes or modifications not expressly approved by the party responsible for compliance could void the user's authority to operate the equipment.

Note:
This equipment has been tested and found to comply with the limits for a Class B digital device, pursuant to part 15 of the FCC Rules. These limits are designed to provide reasonable protection against harmful interference in a residential installation. This equipment generates uses and can radiate radio frequency energy and, if not installed and used in accordance with the instructions, may cause harmful interference to radio communications. However, there is no guarantee that interference will not occur in a particular installation. If this equipment does cause harmful interference to radio or television reception, which can be determined by turning the equipment off and on, the user is encouraged to try to correct the interference by one or more of the following measures:
-Reorient or relocate the receiving antenna.
-Increase the separation between the equipment and receiver.
-Connect the equipment into an outlet on a circuit different from that to which the receiver is connected.
-Consult the dealer or an experienced radio/TV technician for help.

This equipment complies with FCC radiation exposure limits set forth for an uncontrolled environment. This equipment should be installed and operated with minimum distance 20cm between the radiator & your body.

Contact

If you have any technical questions about our products, please contact us. Before contacting us, please confirm the following items:

- Equipment model
- Serial number of the datalogger
- Problem description
- Screenshot of the Status page in the configuration interface

Ginlong Technologies Co., Ltd.
No. 57 Jintong Road, Binhai Industrial Park, Xiangshan, Ningbo, Zhejiang, 315712, P.R.China.
Tel: +86 (0)574 6578 1806
Fax: +86 (0)574 6578 1606
Email : info@ginlong.com
Web : www.ginlong.com