

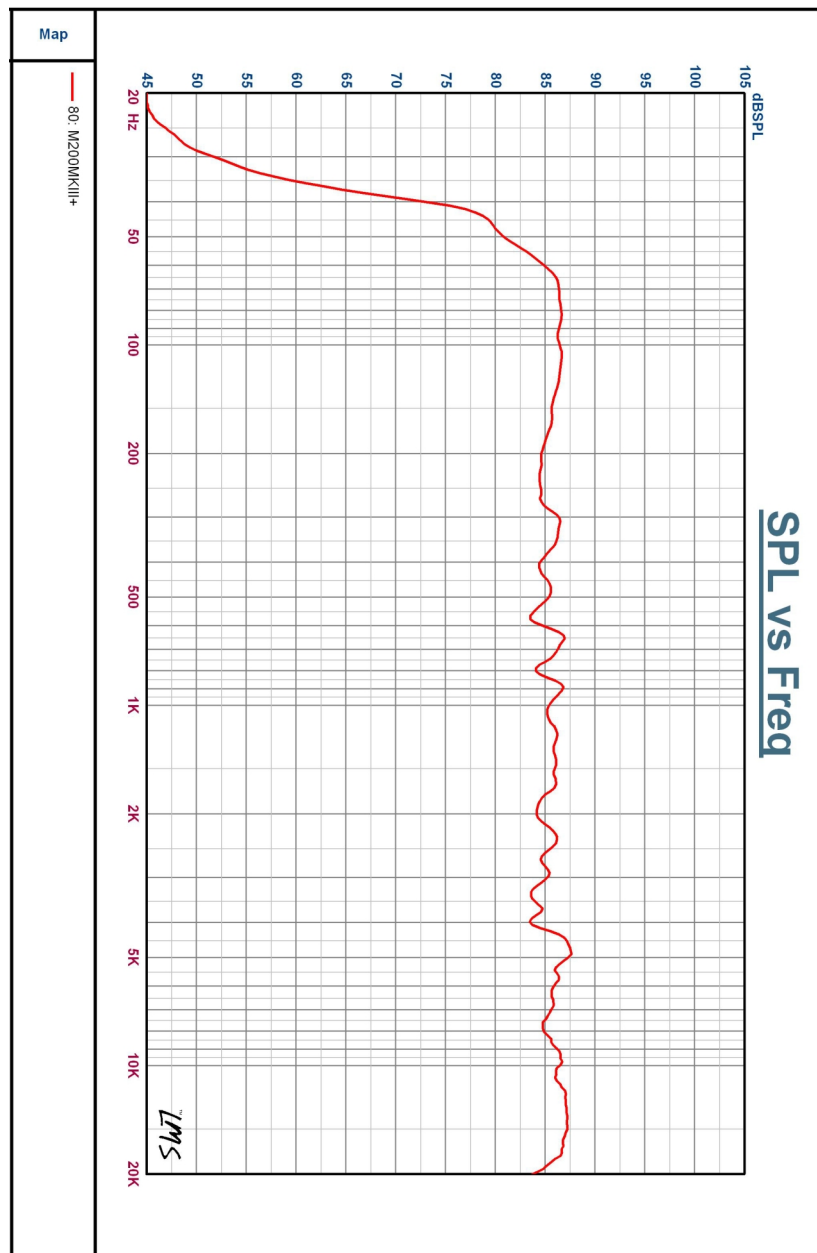

you can hear the difference  
High performance speakers from HiVi



*M*200MKIII +  
Multimedia Active Speaker System



## I. Unpacking

This speaker adopts fine packing material to protect it from damage during shipping. Please check if all accessories are in the box.

- ✓ Active speaker 1 piece
- ✓ Passive speaker 1 piece
- ✓ Speaker connection cable 1 piece
- ✓ Remote control 1 piece
- ✓ Power cable 1 piece
- ✓ 3.5mm to RCA audio cable 1 piece
- ✓ Manual 1 piece
- ✓ Optical cable 1 piece

## II. Figures of speaker functions and electrical parts

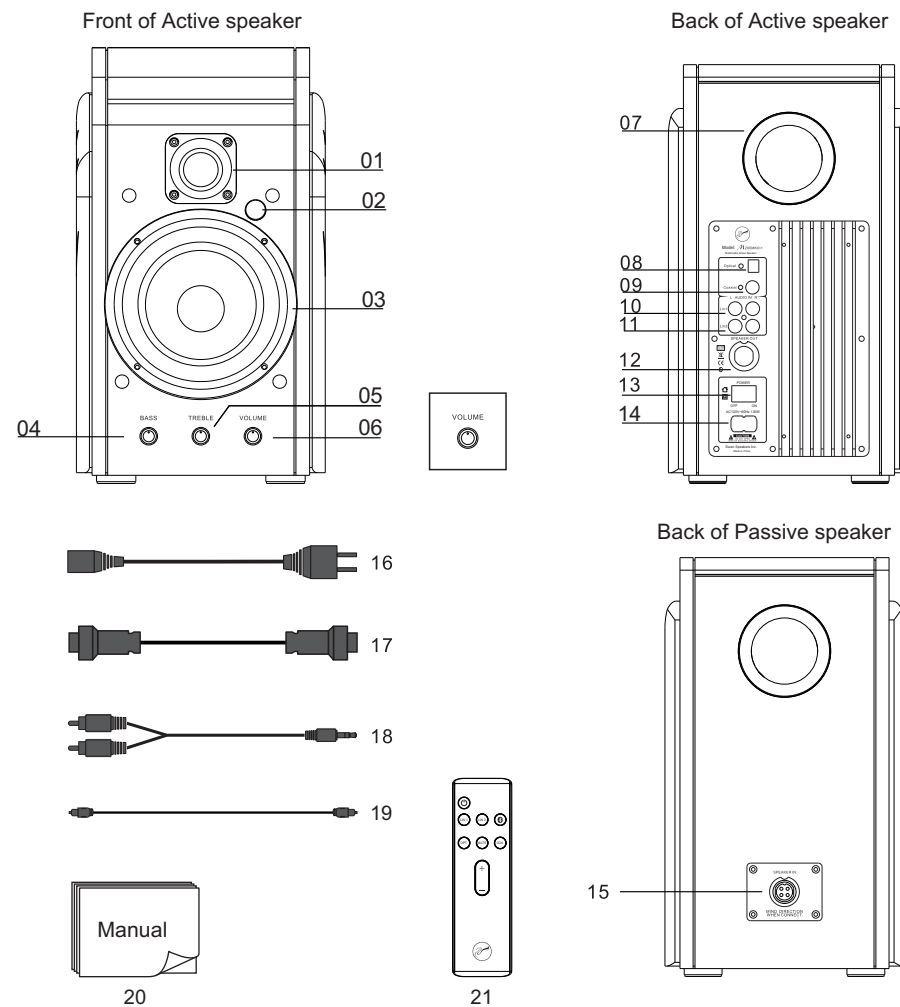

- |                           |                                     |                              |
|---------------------------|-------------------------------------|------------------------------|
| 01. Tweeter               | 09. Coaxial input                   | 16. Power cable              |
| 02. Signal Indicator      | 10. RCA input Line1                 | 17. Speaker connection cable |
| 03. Woofer                | 11. RCA input Line2                 | 18. 3.5mm to RCA audio cable |
| 04. Bass volume control   | 12. Speaker output                  | 19. Optical cable            |
| 05. Treble volume control | 13. Power switch                    | 20. Manual                   |
| 06. Volume control        | 14. Power plug                      | 21. Remote Control           |
| 07. Rear port             | 15. Speaker input to active speaker |                              |

### Volume control function

- You can switch input mode by pressing the volume control. The indicator will change accordingly.
- If the speaker is in "mute" mode, press volume control then the speaker is unmute.
- Indicator color:

RCA input LIN1 (green)	Optical input (grass green)	Standby(red breathing light)
RCA input LIN2 (purple)	Mute (Red flashing light)	
Bluetooth input (blue)	Coaxial(white)	

### III. Remote Control

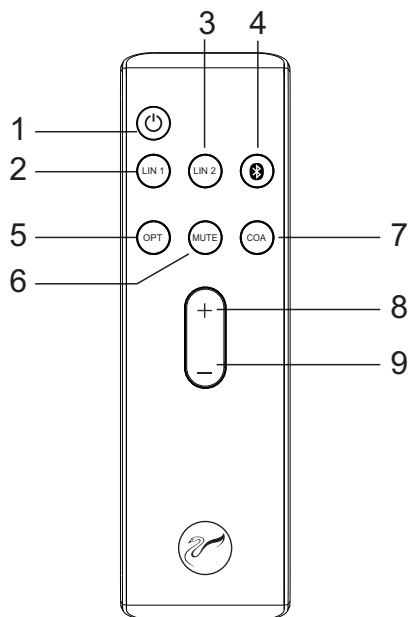

- Standby
- RCA audio input LIN1
- RCA audio input LIN2
- Bluetooth input
- Optical
- MUTE
- Coaxial
- Volume up
- Volume down

#### Notice:

- Please do not put the remote under any objects heavy in case it is destroyed.
- Take the battery off if you are not going to use the remote in a long period of time.
- Keep the remote under a cool and dry place and do not get it wet.

## XI. Specification

Model	HiVi M200MKIII+
Series	HIVI Professional active crossover 2.0 multimedia speaker series
System Type	Two-way 4th order vented speaker system
Drivers Configuration	5.25 inch mid range driver, 28mm soft dome tweeter
Frequency Range	53Hz-20kHz ±3dB(Free Space)
Harmonic Distortion	90Hz-20kHz ≤1%(2.83V/1m)
Wireless Input	Bluetooth 4.0
Rated Power	Each channel power60W RMS , both channels 120W RMS
Signal-to-Noise	>89dB
Input Sensitivity	680mV
Input Impedance	28kΩ
Maximum Input	3000mV
Finish	Luxury fine wood/black matte finish
Dimensions(WXDXH)	194 x 273 x 338mm
Net Weight	12.9kg

## FCC Warning

This device complies with Part 15 of the FCC Rules. Operation is subject to the following two conditions:

- (1) This device may not cause harmful interference, and (2) this device must accept any interference received, including interference that may cause undesired operation.

#### NOTE 1:

This equipment has been tested and found to comply with the limits for a Class B digital device, pursuant to Part 15 of the FCC Rules. These limits are designed to provide reasonable protection against harmful interference in a residential installation. This equipment generates uses and can radiate radio frequency energy and, if not installed and used in accordance with the instructions, may cause harmful interference to radio communications. However, there is no guarantee that interference will not occur in a particular installation. If this equipment does cause harmful interference to radio or television reception, which can be determined by turning the equipment off and on, the user is encouraged to try to correct the interference by one or more of the following measures:

- Reorient or relocate the receiving antenna.
- Increase the separation between the equipment and receiver.
- Connect the equipment into an outlet on a circuit different from that to which the receiver is connected.
- Consult the dealer or an experienced radio/TV technician for help.

#### NOTE 2:

Any changes or modifications to this unit not expressly approved by the party responsible for compliance could void the user's authority to operate the equipment.

This equipment complies with the FCC RF radiation exposure limits set forth for an uncontrolled environment. This equipment should be installed and operated with a minimum distance of 20cm between the radiator and any part of your body.



Avoid Magnets



Do not touch the drivers with hands



Avoid corrosive liquids and gases



Do not place in high heat and humidity for extended period of time

## IX. Trouble shooting

### 1. Problems with sound quality

- Please check and make sure all drivers have sound or not? Is there any problem with the speaker?
- Please check if the connection cables are firmly connected with the OUTPUT of the computer sound card or OUTPUT of the line output.
- Please check if the connection cable is inserted to the right position.

### 2. No sound at all

- Please check if the power cable is connected well, if the power switch is on.
- Please check if the signal cable between the speaker and the sound source is short-circuited?
- Please check if the sound source is set up properly.

### 3. Only one speaker has sound

- Please check the balance controls on the sound source and make sure it is set to the middle position.
- Please check the cable between active speaker and passive speaker is inserted properly.

## X. Warranty

If the problems still exist after you checking as No. IX shows, please contact the local dealer.

### Remote control introductions

- After the speakers are connected properly, turn on the power when the indicator light is red, the speaker is in Standby mode. Press the Standby button, the indicator is green when the speaker is in working mode and default input is LIN1.
- Press other button and it can be switched to LIN2, bluetooth, optical or coaxial input and the indicator will change accordingly.
- Press MUTE the speaker is in Mute when the indicator is red light flashing then press again, the speaker is unmute.
- Long-press the volume up, the volume can go up quickly.
- Long-press the volume down, the volume can go down quickly.

### How to replace the remote's battery

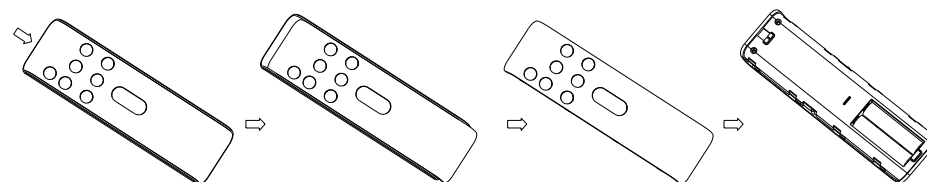

Hold the remote control and press the upper body to slide down.

The body and shell are separated.

Hold the Shell and take up the body.

Pull out the battery and replaced with new ones.

## IV. Speaker placement and listening environment

### 1. Speaker placement

Put the main speaker on the right and passive speaker on the left When listening to music, the distance between the two speakers should be over 70cm so that a natural sound field can be achieved. Adjust the angle and distance of the speakers until optimal sound accuracy and imaging are achieved.

In order to get best sound, not only do we recommend using high quality components to match the speakers, but also a good listening environment. The placement and the size of the listening area will influence the sound quality.

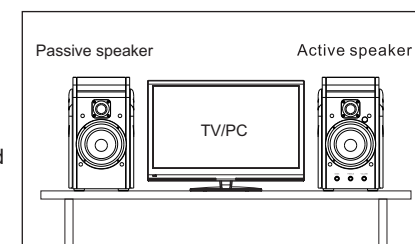

### 2. A few simple suggestions to optimize your listening environment:

- Carpet the floor to avoid the sound reflection.
- Decorate the wall with cloth or other sound absorbing materials to improve sound quality.
- Use thick curtain to avoid the sound reflection by glass windows.

## V. Speaker Connections

The M200MKIII+ is built in with amplifier. On the back there are power outlet, audio in and volume control. The connection diagram is as below:

### 1. Diagram of active speaker connected to passive speaker

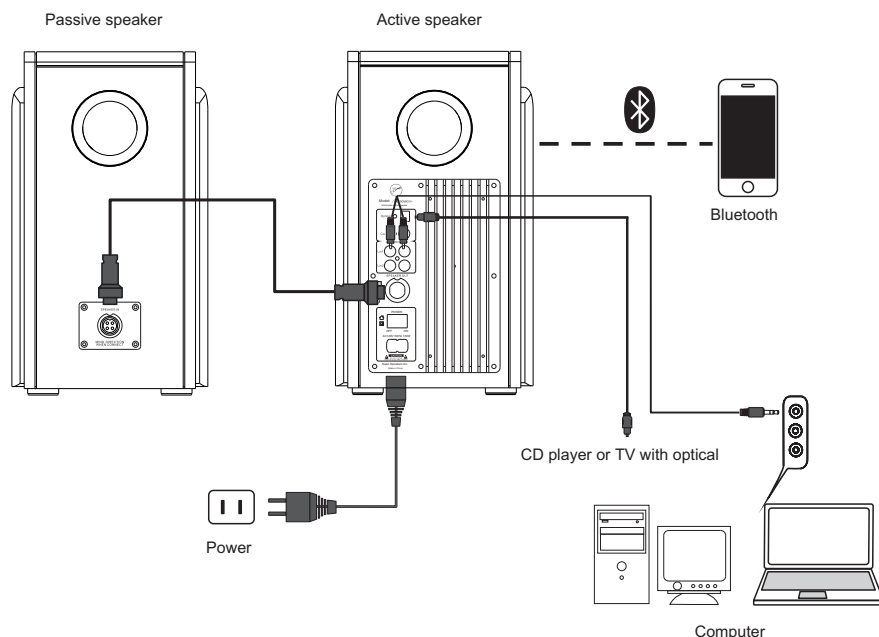

### 2. Active speaker connection to passive speaker

Insert the end of the speaker connection cable into the SPEAKER OUT of the active speaker and the SPEAKER IN of the passive speaker. Make sure the pins are fully inserted to avoid loose connection.

### 3. Connecting with computer or other sound source

Insert the RCA connectors of the RCA to 3.5mm cable into the audio input terminals of the active speaker, red to red and white to white. Then insert the 3.5mm stereo jack to the stereo output of your computer.

### 4. Connecting the power

Make sure the power switch is off, plug the power cable into the power outlet.

#### Notice:

- Please make sure the power is switched off when connecting the power cable.
- The speaker is built-in with amplifier. Please do not stuff the rear port with anything. It can destroy the amplifier.
- Make sure connections are firm to avoid influencing sound quality.
- The quality of cables will directly influence the sound quality. We suggest using the original cable.

## VI. Listening

- Turn on the computer or other sound source, turn on the volume control to minimum(0).
- Play the MP3, CD, and turn up the volume gradually.
- You can use the three function knobs on the back panel to adjust the volume to meet your listening habit.

#### Notice:

- Turn off the power when you are not going to listen.
- We suggest using a high quality sound card so that it can produce the best possible high-fidelity sound. Using a poor quality sound card will degrade the sound quality.

## VII. Break-in

Break-in refers to the aging period for the speakers to where they perform best acoustically. Upon purchase the speakers are not broken-in. A period ranging from 48-400 hours of usage is recommended before both the amplifier and speaker drivers behave optimally.

## VIII. Maintenance

The M200MKIII+ can be operated under normal conditions without requiring any maintenance. Avoid using any corrosive liquids or gasses on the surface of the cabinet or on the speaker drivers. Do not place in high temperatures, moist conditions, or sunshine for long periods of time. For cleaning be sure to use a detergent without any strong chemicals.