

VANMOOF

S3 & X3

User manual



Table of contents

1

Build your bike

The toolbox	p.5
Take the bike out of the box	p.7
Get your toolbox ready	p.7
Adjust the stem	p.8
Wheel position	p.8
Brake disc covers	p.10
Brake disc alignment	p.11
Wheel alignment	p.12
Connect the motor cable	p.12
Attach the pedals	p.14
Check your handlebar	p.15

2

The first ride

Matrix Display	p.17
Inflate your tires	p.18
Activating your Electrified	p.18
Handlebar buttons	p.19
Locking your bike	p.20
Unlocking when connected	p.20
Unlocking when not connected	p.21
Power assist level	p.22
Controlling the lights	p.23
Power and reset	p.23
Charging	p.24

3

Find your fit

Saddle adjustment	p.26
Adjusting the handlebar height	p.28

4

Love your bike

Bike basics	p.31
Chainguard and cleaning	p.32
Screw connections	p.32
Replacing parts	p.33
Warranty	p.34
Warnings	p.35

1

Build your bike

We know you can't wait to get riding
– this won't take long, promise.

The toolbox

Take the bike out of the box

Get your toolbox ready

Adjust the stem

Wheel position

Brake disc covers

Brake disk alignment

Wheel alignment

Connect the motor cable

Attach the pedals

Check your handlebar

The toolbox

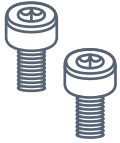

Cable cover bolts 2x



Anti-theft nut 2x



Anti-theft nut tool



Anti-theft torx key

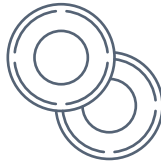

Washers 2x



Anti-theft wrench



Handlebar spacers



Allen key #3, #5 & #6



Cable cover

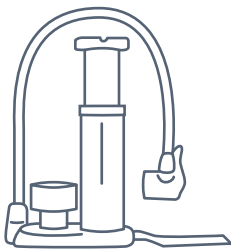

Tire pump



Chain lubricant

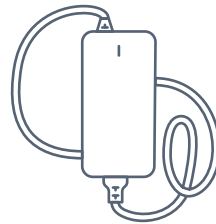

Charger

BUILD YOUR BIKE

VanMoof X3



VanMoof S3



BUILD YOUR BIKE

1. Take the bike out of the box

1.1 To take the bike out of the box, gently pull the yellow strap.

1.2 Remove (and recycle) all protective packaging. Squeeze the tab on the cable ties to remove them without cutting – you can reuse them later.

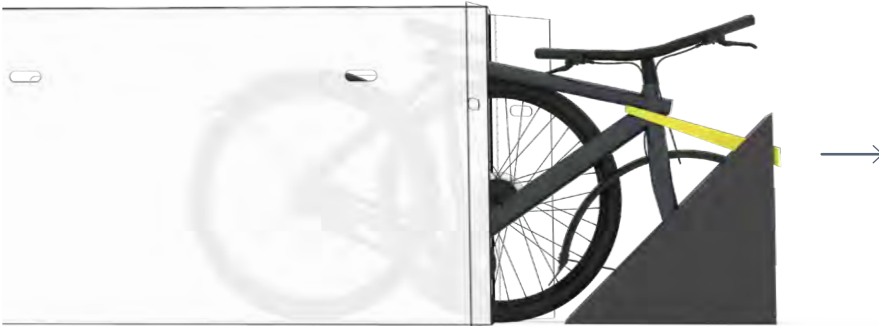

2. Get your toolbox ready

2.1 Take the toolbox out of the triangular front wheel stand – you'll find it at the front side of the stand.

2.2 Make sure you detach the wheel from the bike frame.

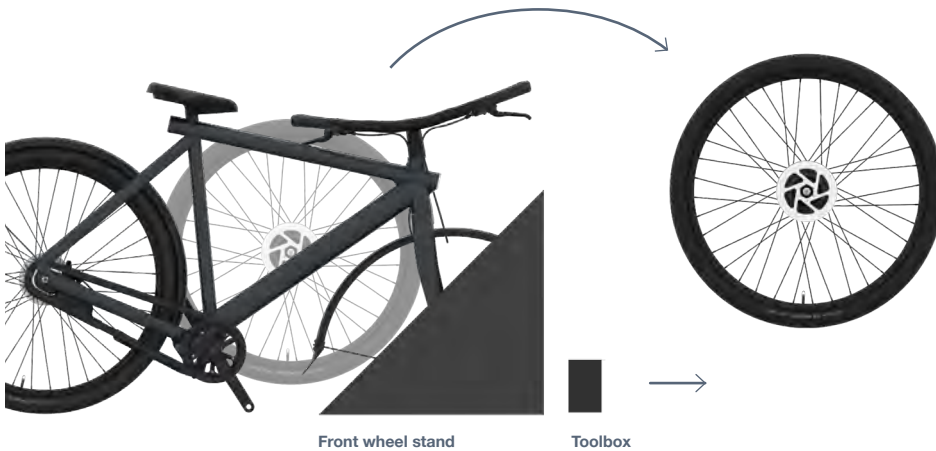

BUILD YOUR BIKE

3. Adjust the stem

3.1 Rotate the stem 90° clockwise so it's in line with the front fender.

3.2 Now tighten the two bolts using the Allen key #5, making sure the stem stays in line with the front wheel.

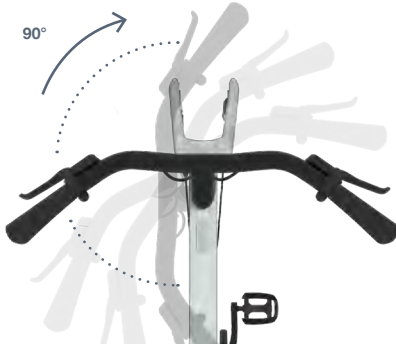

Note

See page 28 to learn how to adjust the handlebar.

4. Wheel position

4.1 Take the bike out of the front wheel stand and place it on the floor.



BUILD YOUR BIKE

4.2 Put the front wheel in the front wheel stand.

4.3 Looking down from a riders position, the motor cable attached to the wheel should be on the right side and facing down.

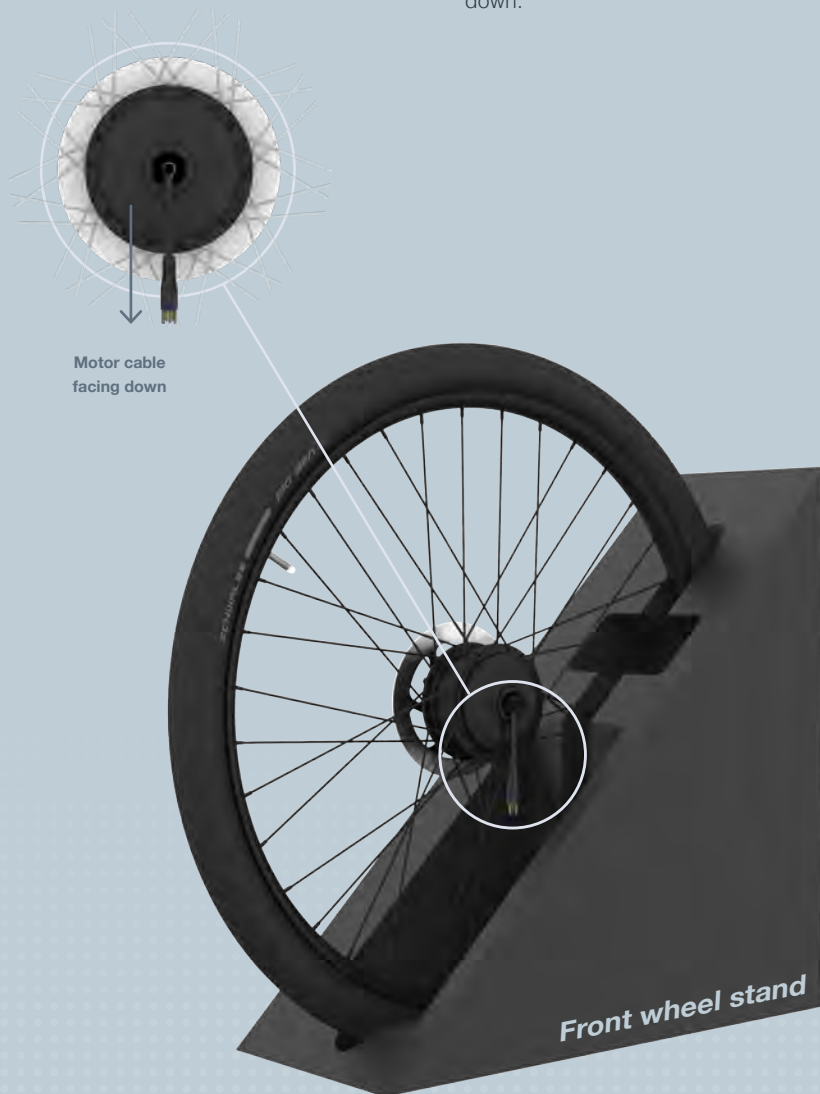

BUILD YOUR BIKE

5. Brake disc cover

- 5.1** Remove the plastic insert from the brake calliper. Make sure you don't squeeze the brake levers while doing this.

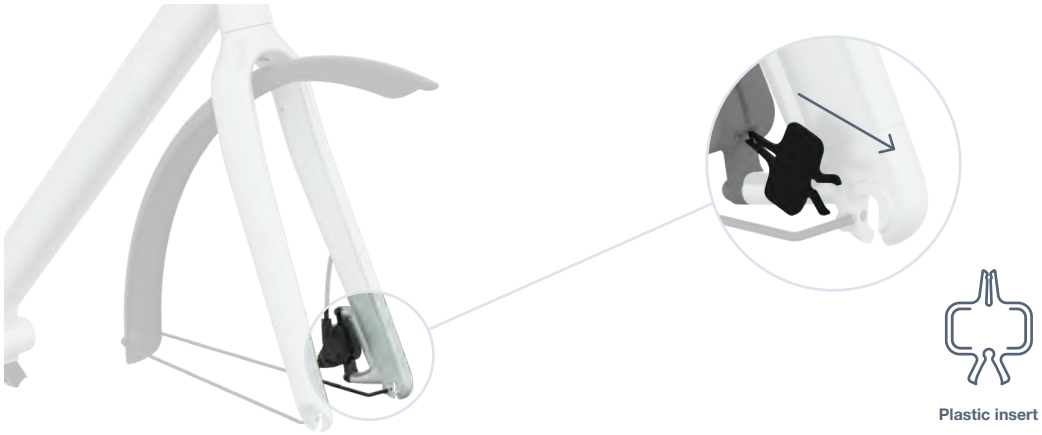

- 5.2** Carefully lift up the bike and guide the front fork onto the wheel.



6. Brake disc alignment

- 6.1** The brake disc should be aligned with the brake calliper pads, with room for the wheel to spin freely.

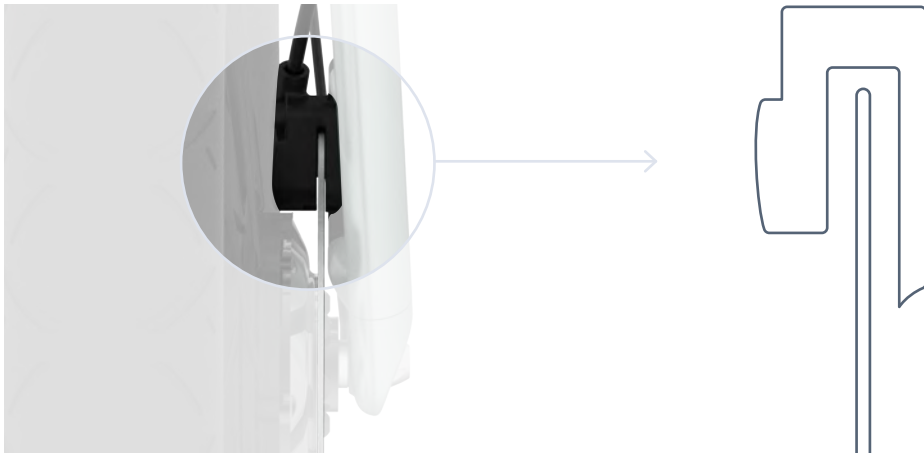

- 6.2** Tighten the left side of the wheel (clockwise) using the anti-theft wrench. Make sure to place both the washer and the nut when tightening.

- 6.3** Double check that the wheel is still centered and tighten the right side (clockwise) using the anti-theft wrench.

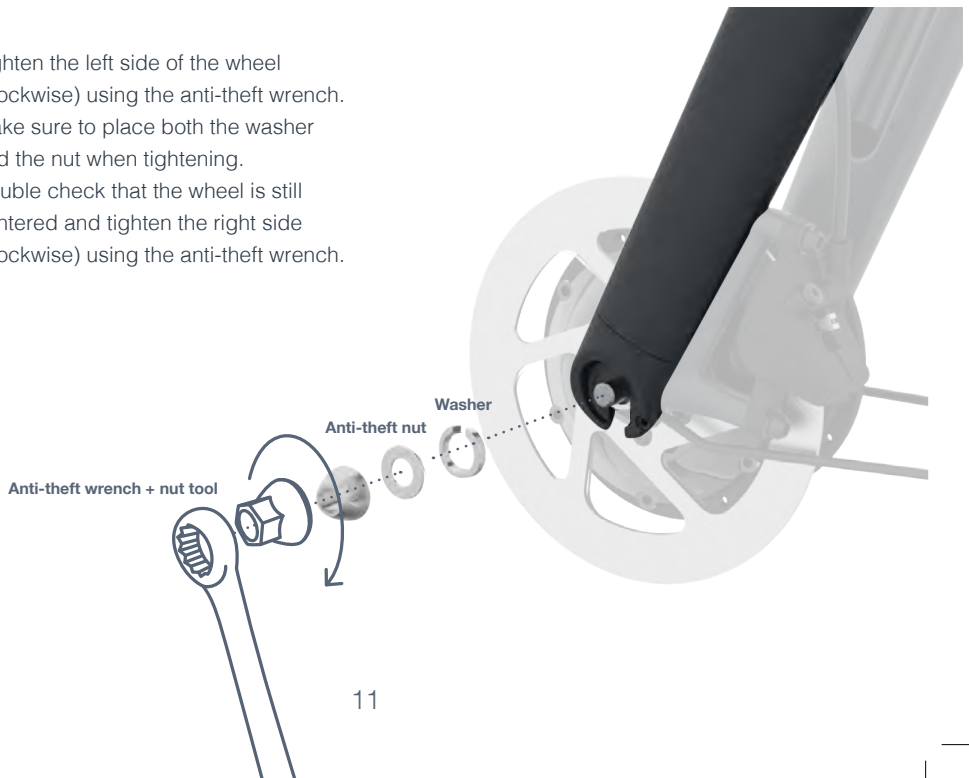

7. Wheel alignment

- 7.1** Check both sides of the front fork dropout to see if the installation is correct, the anti-theft nut should sit in the center of the dropout.



Installation incorrect

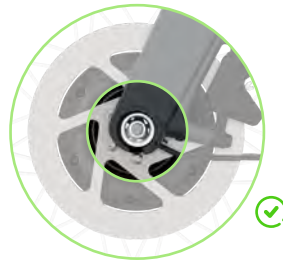

Installation correct

8. Connect the motor cable

- 8.1** Make sure that the motor cable (A) runs between the motor and fender stay (B).

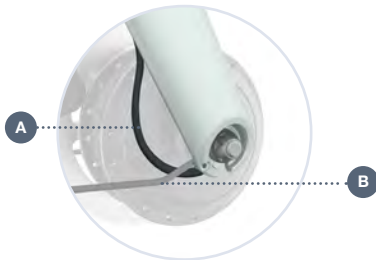

- 8.2** To connect the motor cable, both arrows should be aligned (C). Then, tuck the motor cable into the front fork as far as possible (D).

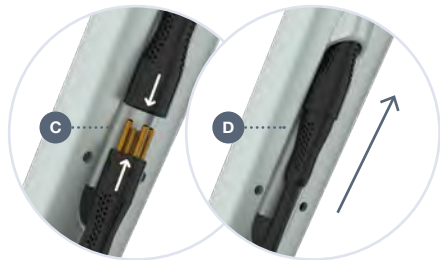

- 8.3 Slide the motor cable cover in the opening (E), and tighten the two bolts with Allen key #3 (F).

Tip

Use the round side on the long end of Allen key #3 in order to mount the screws from an angle

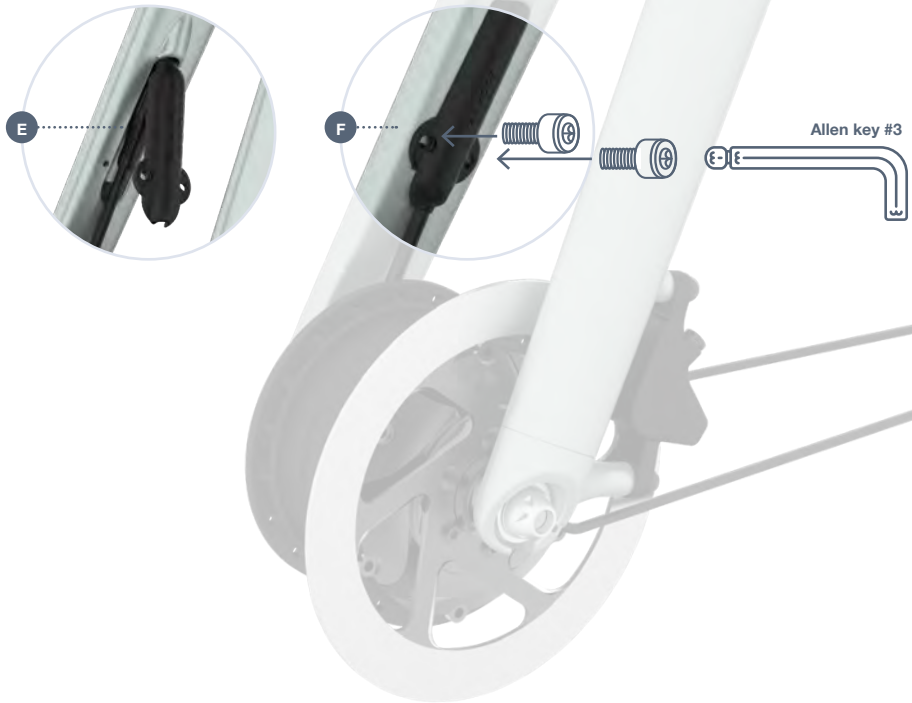

Congratulations!

That was the hardest part – take a moment to celebrate.

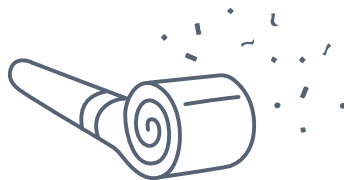

BUILD YOUR BIKE

9. Attach the pedals

9.1 Identify the left pedal – Looking down from a riders position it's attached to the left side of the bike and has an engraved 'L'.

9.2 Screw onto the left crank by hand in an **anticlockwise** direction.

9.3 Tighten the pedal using Allen key #6.



BUILD YOUR BIKE

9.4 Identify the right pedal – Looking down from a riders position it's attached to the right side of the bike and has an engraved 'R'.

9.5 Screw onto the right crank by hand in a **clockwise** direction.

9.6 Tighten the pedal using Allen key #6.



10. Check your handlebar

10.1 Hold the front wheel between your knees and try to rotate the handlebar. If you can feel any play, use Allen key #5 to secure the handlebar.

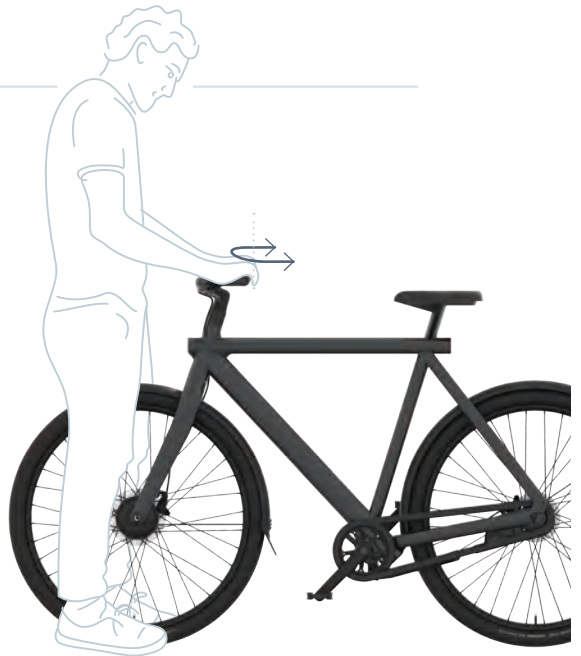



The first ride

Ready for take off? Here's how to get the most from your new Electrified.

Matrix Display
Inflate your tires
Activating your Electrified
Handlebar buttons
Locking your bike
Unlocking when connected

Unlocking when not connected
Power assist level
Controlling the lights
Power and reset
Charging

THE FIRST RIDE



When charging, a lightning bolt will appear on the Matrix Display.



While riding, you'll see your speed, gear, and current battery level.



When stationary, you'll see the standby icon – time to get moving!



When changing settings, the Matrix Display will show what you're currently adjusting.



The alarm will be activated if anyone tampers with your bike.



If something goes wrong, an error message will appear.

THE FIRST RIDE

1. Inflate your tires

- 1.1** Using the included pump, inflate your tires to 2.5 - 3.5 Bar / 50 Psi (the recommended pressure is printed on the tires, if you need a reminder).

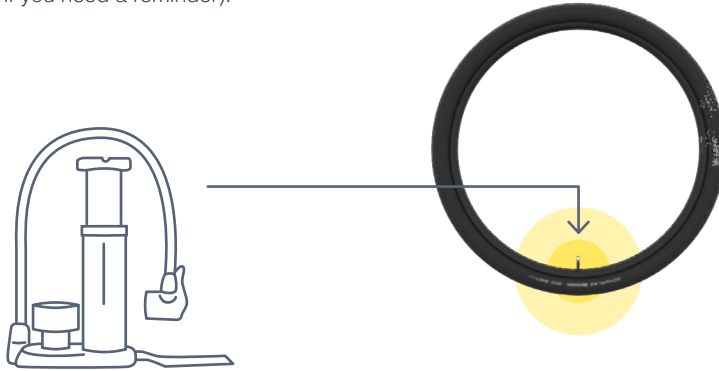

2. Activating your Electrified

- 2.1** Before you ride your bike, you'll have to get it out of shipping mode. To do this, insert the charging plug or press the reset button (see page 24 for charging information).

- 2.2** Open the VanMoof app to create an account and register the bike (if you haven't already). The app will connect automatically, and guide you through setting your personal unlock code (see page 20 for unlock code information). If connection fails, check if your phone is near the bike and Bluetooth is enabled.

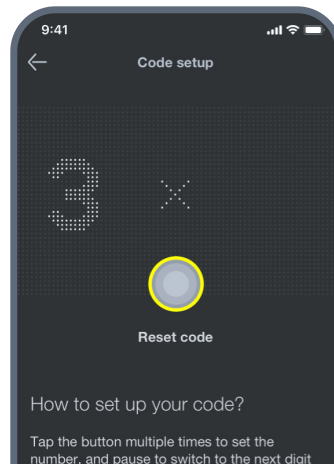
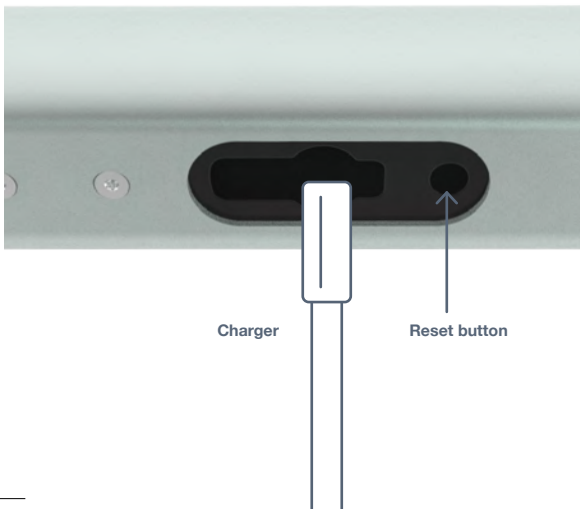

THE FIRST RIDE

3. The left handlebar button

- 3.1 **When riding**, this button will sound the bell.
- 3.2 **When the app isn't connected and the bike is locked**, a long press will prompt you to enter your unlock code.
- 3.3 **When the app is connected and the bike is locked**, a short press will unlock your bike – make sure Touch Unlock is enabled in the app.
- 3.4 **When standing still and the bike is unlocked**, the bike will enter standby mode after five minutes – press this button to wake up the bike.

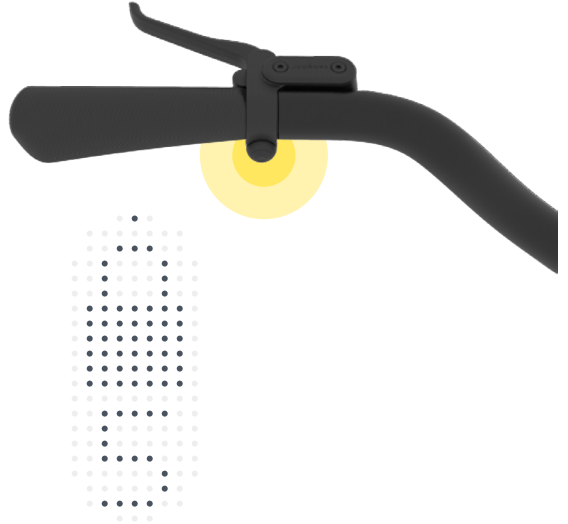

4. The right handlebar button

- 4.1 **When riding**, this button activates the Turbo Boost. The Turbo Boost increases the pedal assist power for as long as you hold the button, helping you to accelerate quickly.
- 4.2 **When standing still**, press and hold this button to cycle through power assist levels.



5. Locking your bike

- 5.1 To lock your bike, align the stripe on the chainguard with a stripe on the rear hub.
- 5.2 Gently kick the Kick Lock button near the left rear dropout. You'll hear a locking sound, and the rear wheel will be immobilized.
- 5.3 If the alarm is activated in the app, locking the bike will automatically arm the alarm. Unlock your bike to disarm the alarm.



6. Unlocking when connected

- 6.1 When your phone is connected to your bike, press the unlock icon in the app to unlock your Electrified. A five-second timer will appear on the Matrix Display of your bike, and you'll hear a ticking sound – move the bike forwards or backward to release the wheel.
- 6.2 If Touch Unlock is activated in the app, just press the left handlebar button to unlock your Electrified. A five-second timer will appear on the Matrix Display, and you'll hear a ticking sound – move the bike forwards or backward to release the wheel.

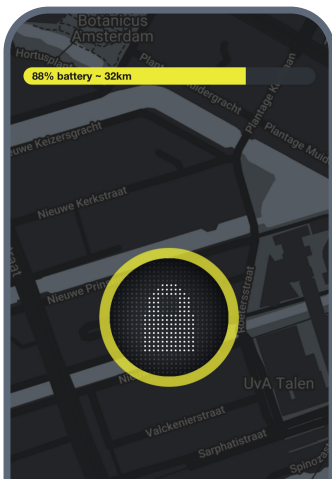

7. Using your unlock code

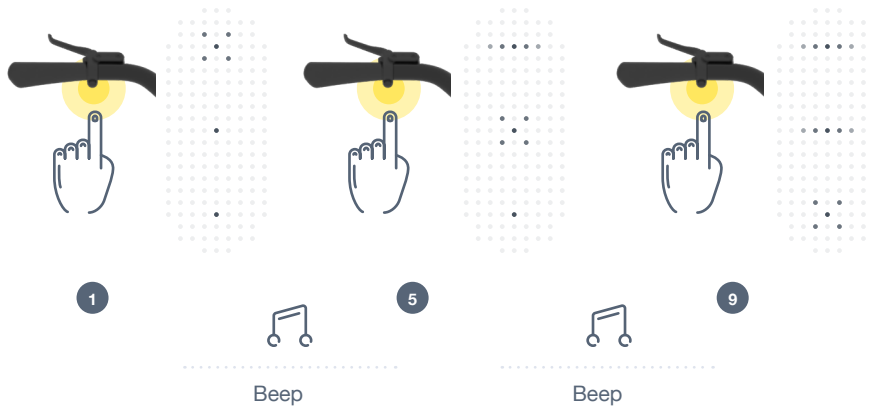

7.1 Let's say your code is 1-5-9. Here's what to do:

- A. Hold the left handlebar button – this will switch to the personal code unlock mode.
- B. Enter the first digit of your code – in the example above that means pushing the button 1 time. You'll hear a beep as confirmation.
- C. Enter the second digit of your code – pushing the button another 5 times. You'll hear a beep again.
- D. Enter the third digit of your code – pushing the button 9 times. You'll hear a final beep.
- E. After the last confirmation, move your bike forwards or backwards within 5 seconds – now you're ready to ride.



8. Power assist level

- 8.1 When the bike isn't moving, press and hold the right handlebar button to cycle through the power assist levels. Release the button to select the level.
- 8.2 You can also change power assist levels in the app, when it's connected to the bike.
- 8.3 The motor will deliver power intelligently depending on your current speed.
- 8.4 The motor will only engage while the pedals are turning. Stop pedalling to slow down.
- 8.5 Your maximum speed depends on local regulations – you'll be prompted to choose your country in the VanMoof app.

Note

Your choice of power assist level will affect the maximum distance you can ride. A lower level will provide less support, but allow you to ride further. Higher levels will provide more support, but you'll need to charge your bike sooner.



Level 0
Motor is
switched off



Level 1
Low motor
support



Level 2
Medium motor
support



Level 3
High motor
support

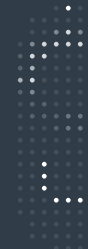

Level 4
Maximum
motor support



9. Controlling the lights

9.1 Open the VanMoof app to control the front and rear lights.

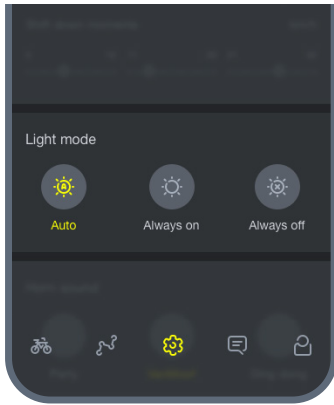

9.2 We recommend the Auto setting – the bike will automatically activate the lights when it gets dark.



10. Power and reset

10.1 To power your bike on and off (when unlocked), press either one of the handlebar buttons or the reset button once to power the bike on.

10.2 To reset your bike, press and hold the button on the underside of the top tube next to the charging port for eight seconds. You'll hear your bike resetting. Your bike has now been reset. Press either handlebar button to power the bike on and use as normal.

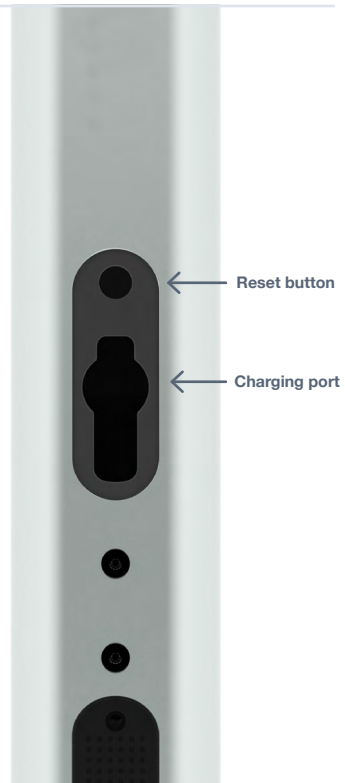



11. Charging

11.1 Open the rubber cover and gently insert the charging plug in the charging port. When fully charged, the LED on the charger will change from red to green. It takes about five hours to fully charge the battery.

Follow these simple tips to keep your battery running in perfect condition for longer:

- Only use the official VanMoof battery charger.
- Charge the Electrified indoors, in a well-ventilated dry location (moisture and extreme temperature fluctuations can affect the charging process).
- The bike will charge best at temperatures between 0 - 30°C (32 - 86°F).
- Place the charger on a hard surface and make sure it is never covered. Never place it on carpet or textile surface.
- Always keep the plug and connector free of dirt and moisture.
- Do not charge your bike if the charger or plug is damaged. If in doubt, contact us immediately.
- If you don't plan to use your Electrified for a long period of time, make sure the battery gets a full charge cycle every six months.



Find your fit

Comfort is king – here's how to tweak your bike for the perfect ride.

Saddle adjustment

Adjusting the handlebar height