

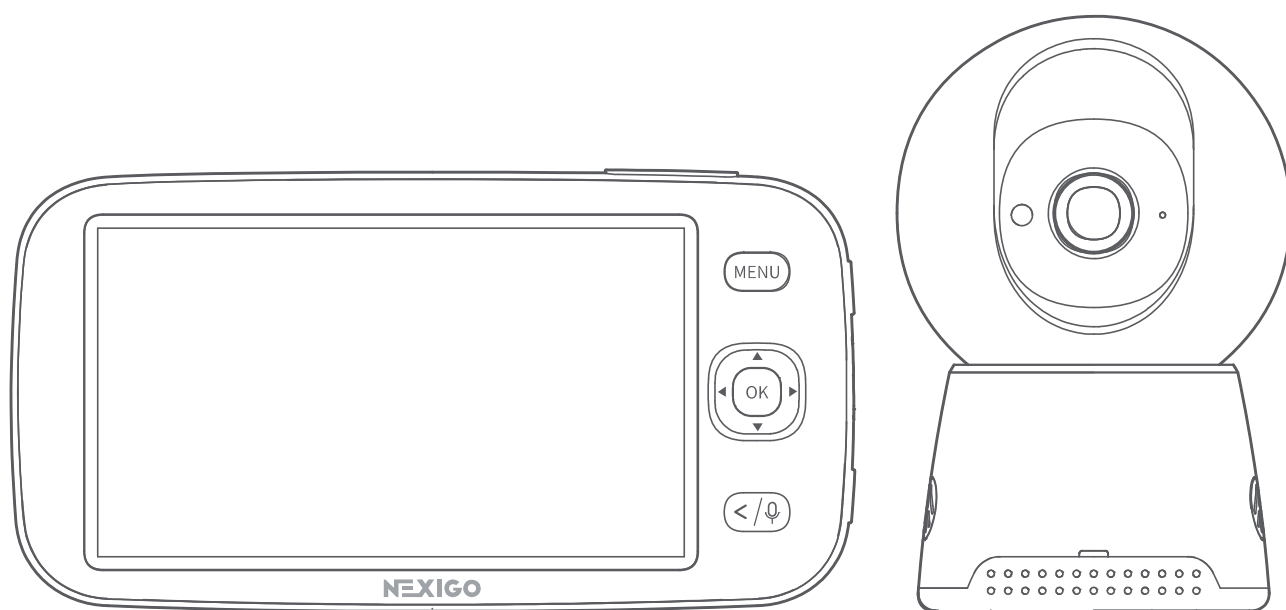

User Manual

NexiGo Video Baby Monitor



B200



Scan the QR code or visit our link to download the latest manual here: **www.nexigo.com**

Welcome to the NexiGo Family!

Thank you for choosing the NexiGo B200 Video Baby Monitor! You are now part of an exclusive club: the NexiGo family! It's our job to make sure you enjoy your membership. If you have any problems please contact us at **cs@nexigo.com** at any time for further assistance. This product is covered by our industry-leading 1-year manufacturer's warranty. Make sure to register your purchase at **nexigo.com/warranty** within 14 days of the delivery date to extend your warranty coverage to TWO Years!

From all of us here at NexiGo, we want to welcome you again to the family. We thank you deeply for your trust and for your business. We know you'll love it here. We look forward to serving you again in the near future.

Yours Sincerely,
The NexiGo Team

Contact Information:

Website: www.nexigo.com

Manufacturer: Nexight INC

Email: cs@nexigo.com

Tel: +1(458) 215-6088

Address: 11075 SW 11th St, Beaverton, OR, 97005, US

Product Description:

The NexiGo B200 Video Baby Monitor is a two-way video monitor that can be used in a wide variety of scenarios. With two way voice capability you can both listen to your child sleeping as well as speak directly to them when they wake up, perfect for those ultra late nights when they just need to hear your voice. The B200 is sound activated so the moment your baby starts crying the monitor will kick on and let you know and with included sound alerts it can let you know even if you stepped out of your room for a minute.

The built-in camera has a night vision mode so even in total darkness you can still see what is going on in the room. With nine brightness levels for the monitor you will never have the "Bright Light" effect where you can't see what is there. And with features like temperature monitoring, and zoom with pan and tilt options, you can make sure that everything is exactly the way you want in your child's room.

Finally, with built-in lullabies if you just are not able to get them to go to sleep you can put on the music and leave the room so they are not overstimulated and monitor them from a distance. And with programmable event reminders for feeding, diaper changing, etc, you never have to worry about being too distracted to remember to do the things. The Nexigo B200 is here to help your sleep-addled brain and to make sure you always know exactly what is going on in your baby's room.

What's in the Box?

- 1 x Video Baby Monitor
- 1 x Video Baby Camera
- 1 x Camera Wall Bracket
- 1 x Mounting Screws Pack
- 1 x 3M Double-Sided Adhesive Tape
- 1 x Monitor Power Adapter (5V / 2A)
- 1 x Camera Power Adapter (5V / 1A)
- 1 x Monitor Micro-USB Power Cable (3.28ft)
- 1 x Camera Micro-USB Power Cable (9.84ft)
- 1 x Instruction Manual

Monitor Diagram:

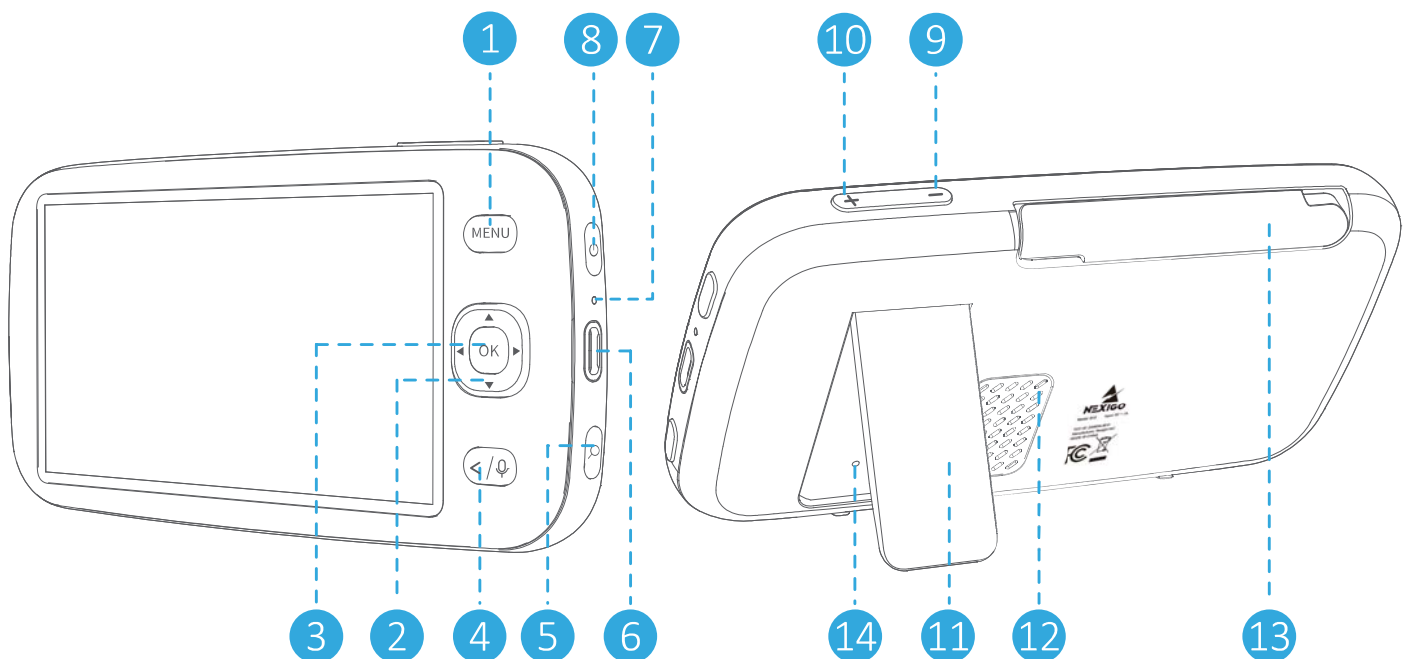

- ① Menu Button
- ② Navigation Buttons
- ③ OK Button
- ④ Return / Talk Button
- ⑤ Zoom Button
- ⑥ Micro USB Port
- ⑦ LED Indicator
- ⑧ Power Button
- ⑨ Volume Down
- ⑩ Volume Up
- ⑪ Support Stand
- ⑫ Speaker
- ⑬ Antenna
- ⑭ Reset Button

Camera Diagram:

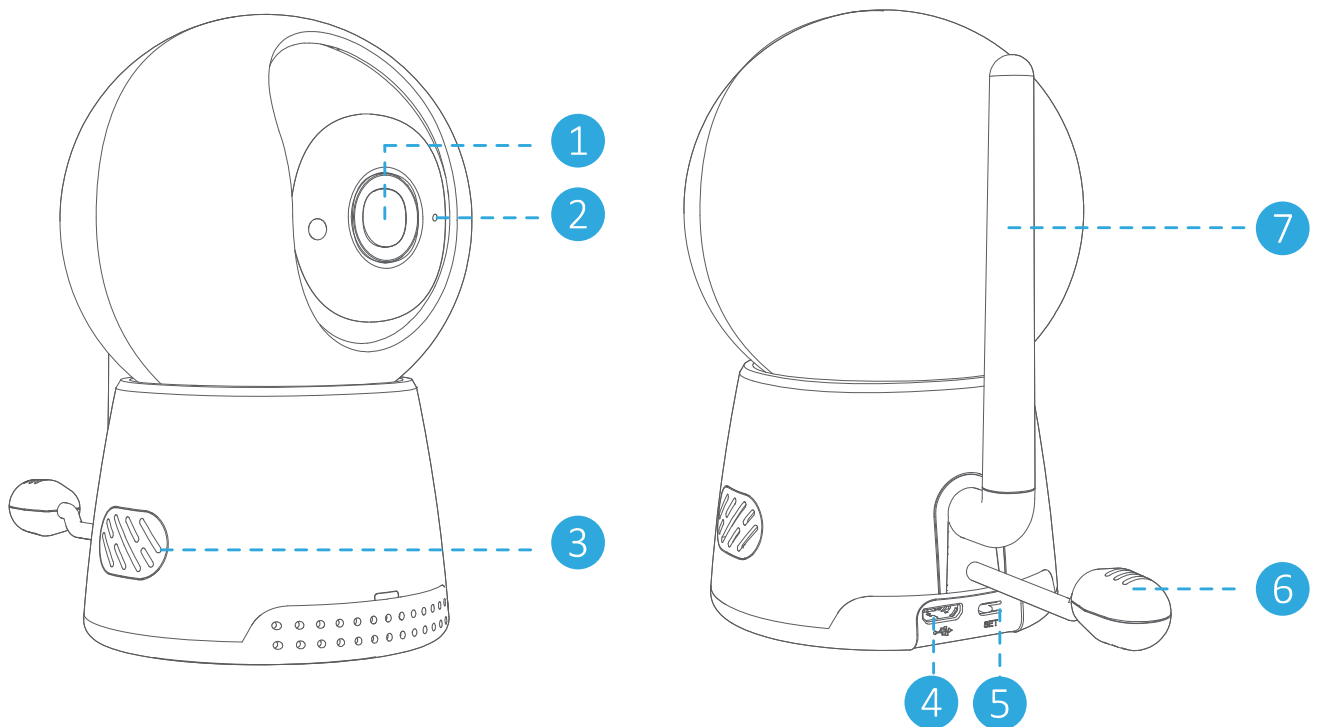

- ① Wide-Angle Lens
- ② Microphone
- ③ Speaker
- ④ Micro USB Port
- ⑤ Pairing Button
- ⑥ Temperature Sensor
- ⑦ Antenna

Specifications:











Product Name		NexiGo Video Baby Monitor
Model		B200
Transmission Range		300~500ft - Inside a standard home; 1000ft - In an open area
Monitor	Imaging Technology	LCD
	Sensor Size	5"
	Native Resolution	1280 x 720
	Battery Capacity	4800mAh
	Charging Time	Fully charged in 3 hours
	Working Time	About 9 hours with the screen on (in 40% brightness)
	Standby Time	About 25 hours
	Power Input	AC 5V / 2A
	Working Temperature	-10°C ~ +50°C
	Storage Temperature	-20°C ~ +60°C
	Speaker	1W

Camera	Field of View	D=108.19° / H=91.69° / V=50.29°
	Power Input	AC 5V / 1A
	Native Resolution	1280 x 720
	Working Temperature	-10°C ~ +50°C
	Storage Temperature	-20°C ~ +60°C
	Speaker	1W

On-Screen Menu Icons:



Icon	Icon Description
	Current battery power
	Battery low
	Charging
	Wireless signal strength
	Sound alert mode is enabled
	Sound level in the room the Camera is in
	Only one Camera connected

	A subscript identifying the current camera appears (When two or more cameras are connected)
	When Multi-Camera Cycling Mode is activated in display mode, a subscript referring to the current camera as well as a cycling icon will appear
	Alarm is enabled
	No Camera is connected
	Night vision mode is enabled
	The temperature of the room in which the Camera is located. You can toggle between Fahrenheit or Celsius in the menu
	The Monitor is playing white noise sleep sounds
	The Monitor is cycling between the white noise tracks
	The Camera is playing a lullaby
	The Camera is cycling between lullabies
	Current time

Note: When the corresponding function is disabled the icons shown below will not appear on the screen:

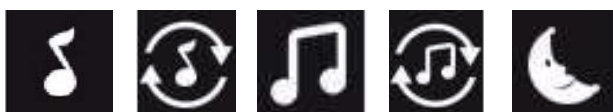

Setting up the Camera and Monitor:

Charge the Monitor

- 1) Plug one end of the **Monitor Micro-USB Power Cable** into the **Baby Monitor**, and then insert the other end to the **Monitor Power Adapter**.
- 2) Plug the adapter into a power outlet. The LED indicator on the right side of the Baby Monitor will display a red light indicating that it is charging. (**Note:** The monitor does have a battery. Once fully charged, the Monitor can be used without a connection to a power outlet.)

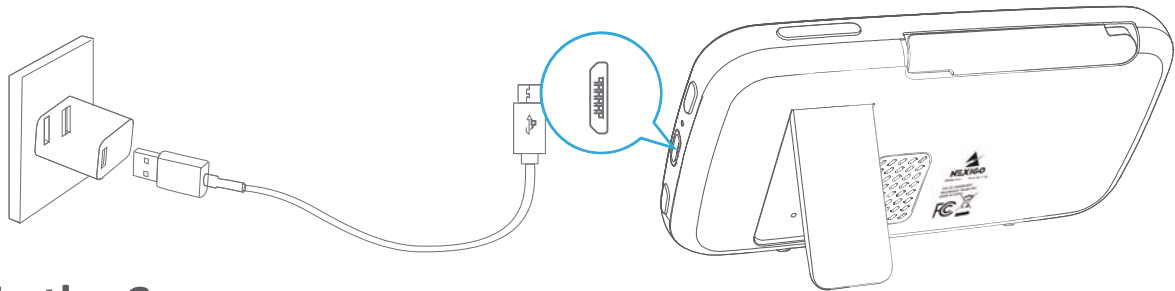

Plug in the Camera

- 1) Plug the **Camera Micro-USB Power Cable** into the **Camera**, and then insert the other end of the cable into the **Camera Power Adapter**.
- 2) Plug the adapter into a power outlet. The Camera does not have a battery and requires a power connection to function.

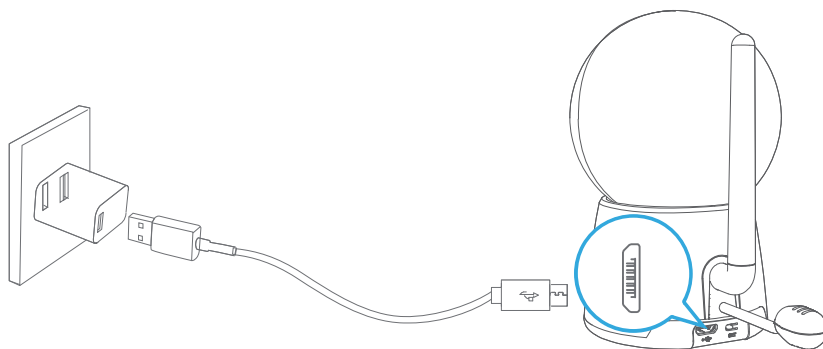

Connection Instructions:

1. Place the **Monitor** within the operating range of the **Camera**.
2. Press and hold the **Power Button** on the right side of the **Monitor** for two seconds to turn it on.

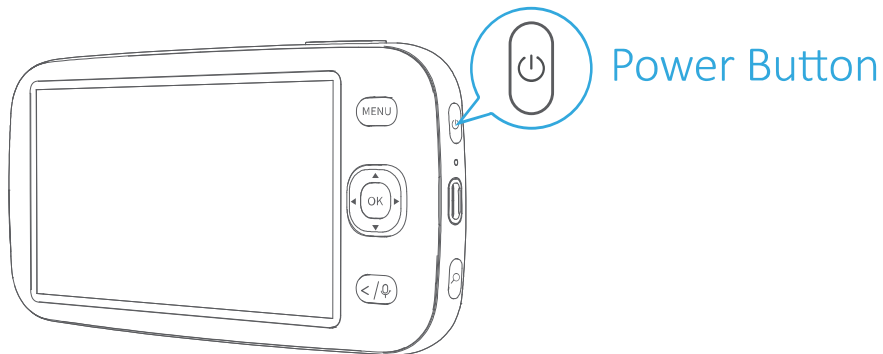

The first time you turn on the Monitor it will ask you to set up the **Language** and **Time**.

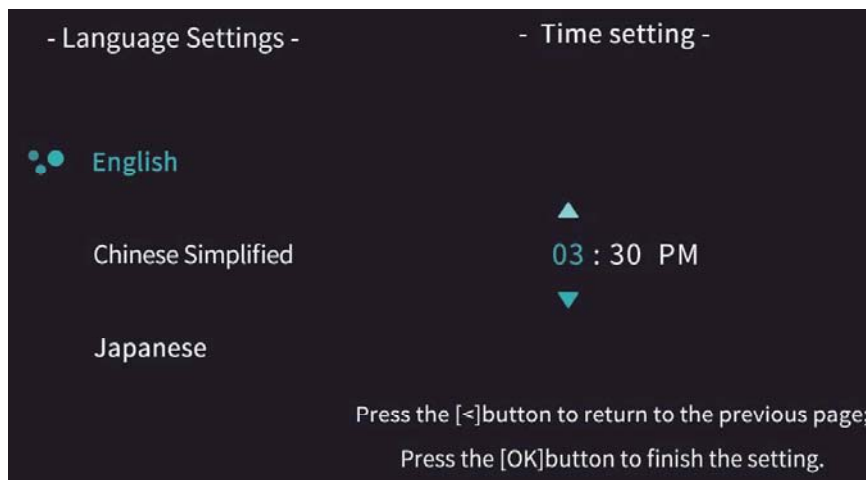

3. The following image will then appear. Press the **OK Button** to enter the **Camera Settings** Interface.

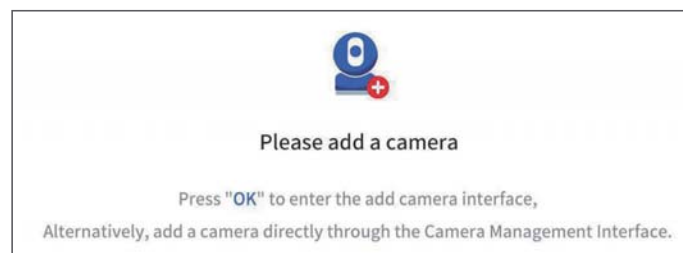

4. Select **Camera Pairing** from the list below. Choose the Camera number you wish to add, then press **OK Button** to confirm. Select **Add** to begin pairing.

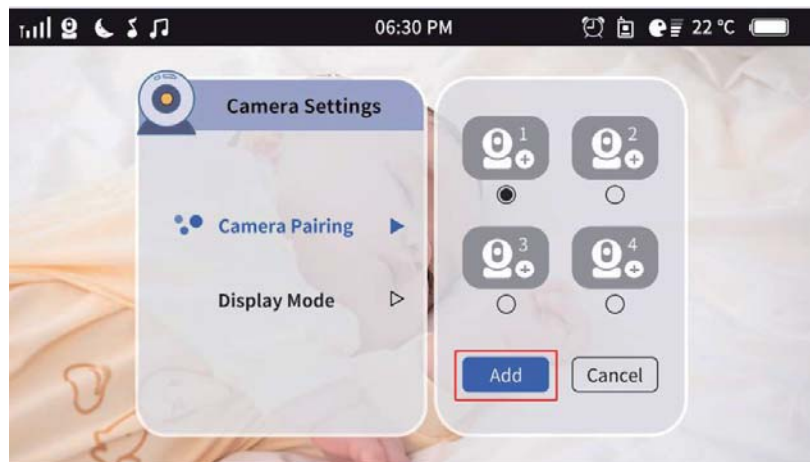

5. Press and hold the **Pairing Button** on the rear of the Camera until a "beep" is heard. You must perform this step within 60 seconds after starting the pairing process.

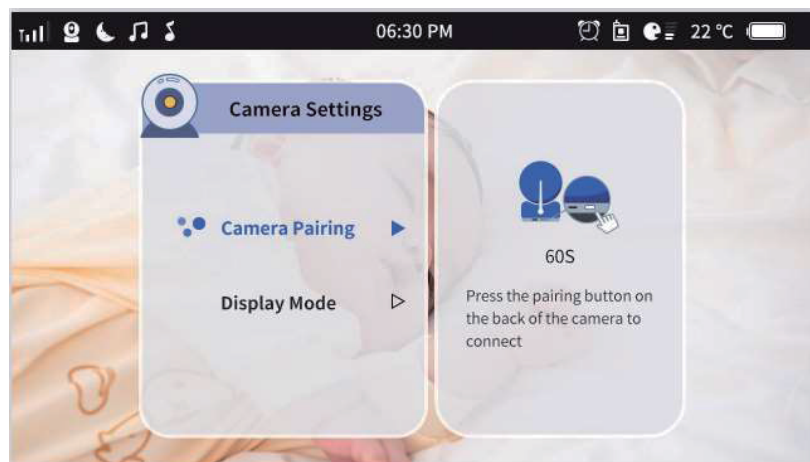

6. A "Camera added successfully" notice will be displayed on the screen. The connection is now active.

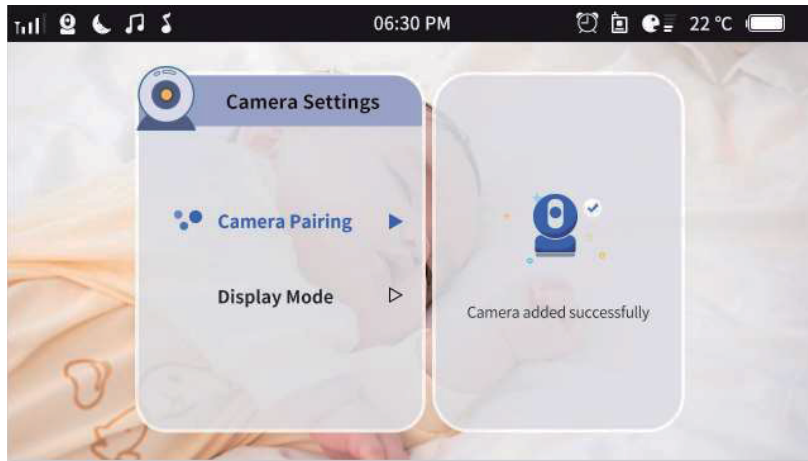

7. You may repeat this process for up to three additional Cameras by navigating to: **Menu > Camera Settings > Camera Pairing**.



Disconnection Instructions:

1. To disconnect a camera, navigate to: **Menu > More Settings > Camera Settings**. Select the Camera you wish to disconnect, then select **Delete** to disconnect the camera.

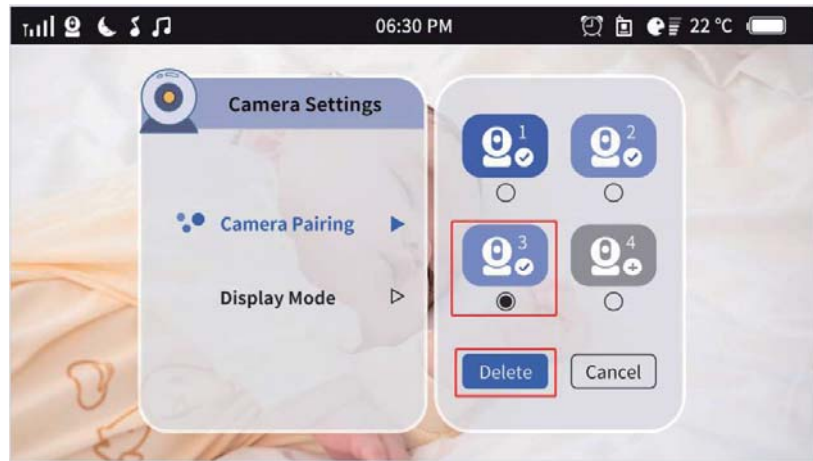

2. If a Camera becomes disconnected unexpectedly for any reason, an alarm tone will play and the image below (or a similar one identifying the specific camera that has been disconnected) will appear on the Monitor alerting you to which Camera has lost its connection. Press any button to stop the alarm.

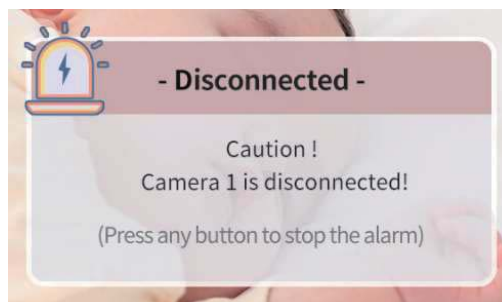

Mounting the Camera:

Option 1 - Use screws to secure the Camera Wall Bracket

Consider the following factors when selecting a location to mount the camera:

- The mount can be positioned on a **corner** or on a **flat surface**. Do not mount this from a ceiling, it is not intended to hang and may

become detached and fall.

- The camera must have an unobstructed view of the crib or bed from where it is mounted.
- The camera must have a nearby power outlet that can be reached without using an extension cord.

When a suitable location has been found that meets these criteria you may then begin the installation process.

1) Position the **Camera Wall Bracket** where you want it and locate the screw holes in the mount. Mark each hole carefully with a pencil / pen to ensure that the tapping process is accurate.

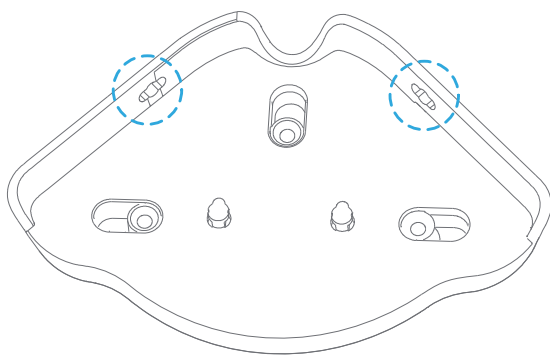

a. For Corner Mounting

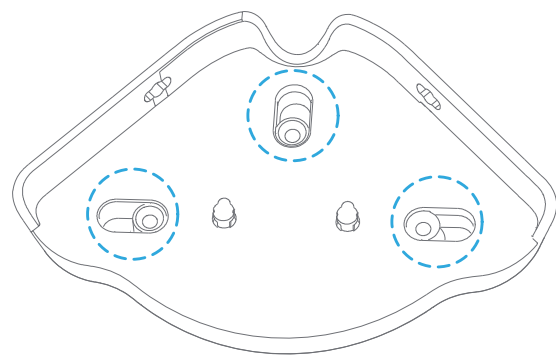

b. For Flat Walls

2) Set aside the bracket and then drill a hole at least 6.0 mm deep at each mark. (Drill and drill bits NOT included.)

3) Insert a plastic wall anchor into each hole and hammer in the anchors so they are nearly flush with the wall surface. (Hammer NOT included.)

4) Place the bracket back on the wall in the chosen location and using the provided screws attach the bracket to the wall. Tighten the screws firmly. Ensure that you do not over-torque or strip the screw heads.

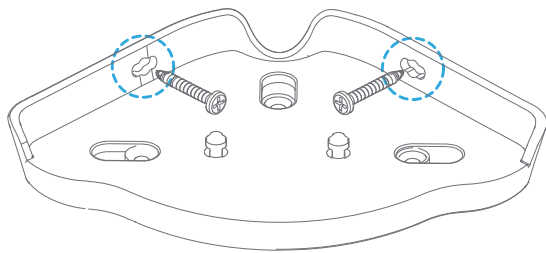

a. For Corner Mounting

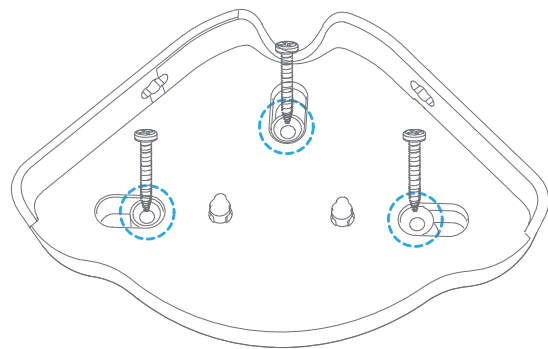

b. For Flat Walls

Note: If mounting on a flat wall please make sure to mount this unit with the notch in the back facing upwards as shown below. DO NOT mount this unit with the notch facing any direction other than up.

5) Align the **Slide Locks** on the **Camera Wall Bracket** with the holes on the bottom of the Camera, then push the Camera body forward until it gets stuck to secure it in place.

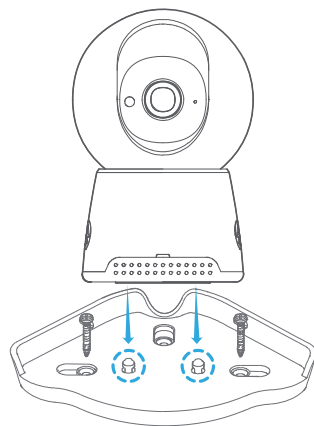

6) Optimize your viewing angle by rotating the Camera manually, or utilize the remote pan and tilt functions with the **Navigation Button** on your Monitor.

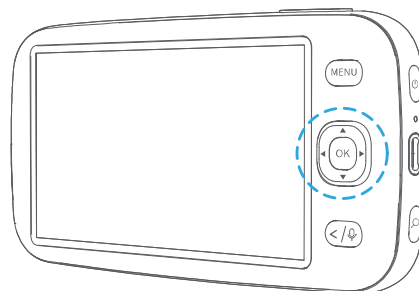

Option 2 - Use 3M Double-Sided Adhesive Tape to secure the Camera Wall Bracket

Consider the following factors when selecting a location to mount the camera:

- The mount can only be positioned in a corner.
- The camera must have an unobstructed view of the crib or bed from where it is mounted.
- The camera must have a nearby power outlet that can be reached without using an extension cord.

When a suitable location has been found that meets these criteria you may then begin the installation process.

- 1) Adhere the **3M Double-Sided Adhesive Tape** to both outer sidewalls of the **Camera Wall Bracket** as shown below.

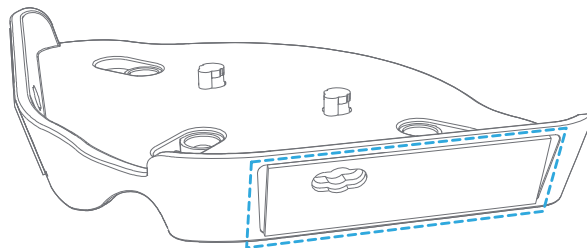

- 2) Position the **Camera Wall Bracket** at the desired location and press firmly towards the wall. Ensure that both pieces of the tape are securely touching the wall.

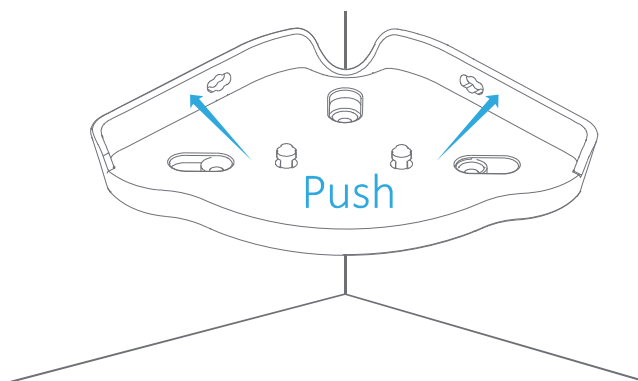

3) Align the **Slide Locks** on the **Camera Wall Bracket** with the holes on the bottom of the Camera, then rotate the Camera body to secure it in place.

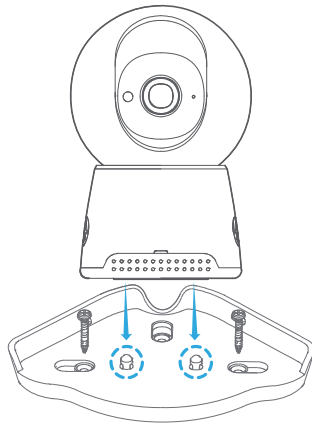

4) Optimize your viewing angle by rotating the Camera manually, or utilize the remote pan and tilt functions with the **Navigation Button** on your Monitor.

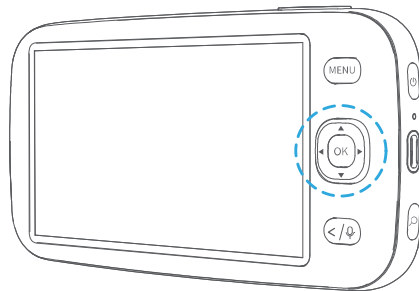

Features and Settings:

Volume

Press the **Volume Buttons** on the Monitor to adjust the volume level. The volume bar will appear on the display to show the selected volume.

Battery Power Alert

When the remaining power on the Monitor falls below either 20%, 10%, or 5%, an alarm tone will play and the image shown below will

appear on the Monitor to alert the user.



Zoom and Pan Image

- You can zoom in **1.5X** or **2X** while viewing images on the Monitor by pressing the **Zoom Button** on the right side of the Monitor.
- Press and hold the ▲ or ▼ to tilt the image upward or downward.
- Press and hold the ◀ or ▶ to pan the image left or right.

Two-Way Talk Function

You can use the Two-Way Talk Intercom function to speak to someone on the other side of the camera or comfort your baby.

- Press and hold the **Talk Button** on the Monitor. Speak into the microphone and your voice will be broadcast to the Baby Camera, and you will still be able to hear the sound from the room as well. As long as the button is held, the connection will remain opened.
- Release the **Talk Button** to close the connection.

Sound Activation

Press the **Menu Button** on the Monitor to enter the menu interface. Under the **Sound Activation** tab you will find the options listed below:

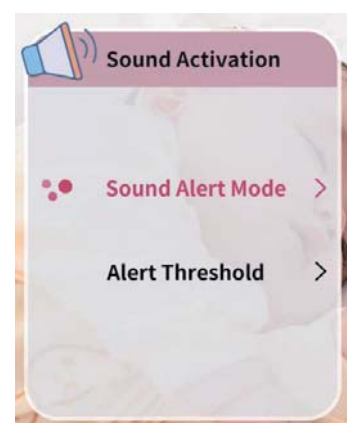

- **Sound Alert Mode:** If the camera picks up a noise in the room that exceeds the threshold level that you set, the system will be woken up and the monitor will turn back on automatically.
- **Alert Threshold:** Adjust the sound detection sensitivity level of the Camera unit. The higher the sensitivity level is, the more likely the Camera is to pick up softer sounds and transmit them to the Monitor. The sensitivity bar will appear on the right-hand side of the display to show the selected level.

Alert Function

Press the **Menu Button** on the Monitor to enter the menu interface. Under the **Alert** tab you will find the options listed below:

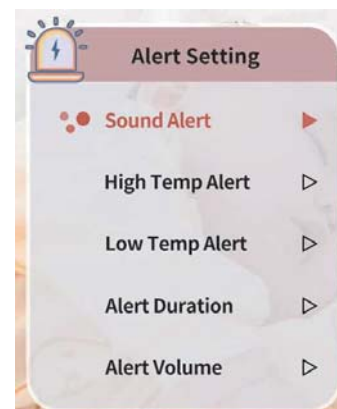

- **Sound Alert:** The Baby Monitor will alert you when a specific noise level is detected by the Camera. The sensitivity bar will appear on the right-hand side of the display to show the selected level. Please be aware that ambient noise such as a passing car or loud animal may cause false positives.
- **High Temp Alert:** The Camera monitors room temperature with its built-in temperature sensor. If the temperature increases above a set value the Monitor will provide an alert and play an alarm tone. The set value must be higher than the Low Temperature Alarm Value that you set.
- **Low Temp Alert:** The Camera can also detect if the temperature of the room is falling below a set value. If the detected temperature falls below the set range the Monitor will provide an alert and play an alarm tone. The set value must be lower than the High

Temperature Alarm Value that you set.

● **Alert Duration:** Select a duration for the alert when one of the above triggers occurs. The options available are **10 / 20 / 30 / 60** seconds.

● **Alert Volume:** Adjust the volume of the alert when one of the above triggers occurs.

Lullaby Function

Press the **Menu Button** on the Monitor to enter the menu interface. Under the **Lullaby** tab you will find the options listed below:

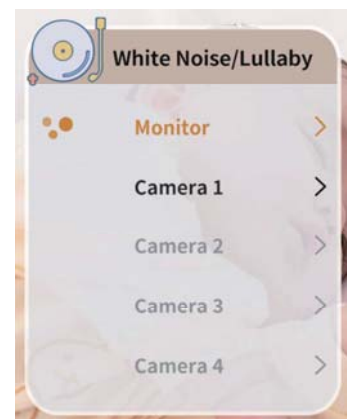

● **Monitor:** The Monitor is capable of emitting white noise to help facilitate sleep. There are six different types of white noise to select from. The

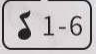
 icon cycles through all of the different tracks in order. The volume of this white noise can be adjusted by using the **Volume Buttons** on the Monitor.

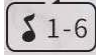
● **Camera:** The Camera is capable of playing lullabies to help facilitate sleep. There are six different lullabies to select from. The  icon cycles through all of the different tracks in order. The volume bar on the Monitor allows you to adjust the volume of the music. If you have paired additional Cameras to this Monitor they can also be set to have sound played as well.

Note: Sound Alerts are automatically disabled when a lullaby is playing. The music will keep playing for 30 minutes and then stop.

Alarms

Press the **Menu Button** on the Monitor to enter the menu interface. Under the **Alarms** tab you will find the options listed below:

- **Feeding:** Set an alert for common feeding times. The options available are: **1 / 1.5 / 2 / 2.5 / 3 / 3.5 /** or **4** hours, or just at a specific time. **OFF** indicates that this alarm is not active.
- **Diaper Changing:** Set an alert for a diaper check or reminder. The options available are: **1 / 1.5 / 2 / 2.5 / 3 / 3.5 / 4** hours, or just at a specific time. **OFF** indicates that this alarm is not active.
- **Other:** Set a generic alarm on your Monitor. The options available are: **1 / 1.5 / 2 / 2.5 / 3 / 3.5 / 4** hours, or just at a specific time. **OFF** indicates that this alarm is not active.

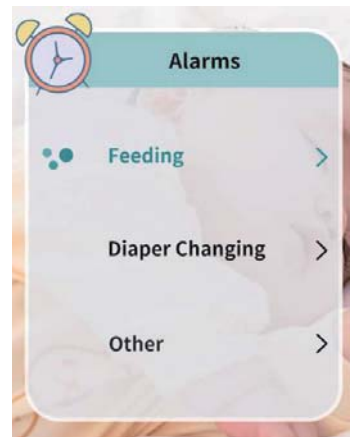



Note: Please press "OK" to stop the alarm or it will activate again after 10 minutes.

Camera Settings

Press the **Menu Button** on the Monitor to enter the menu interface. Under the **Camera Settings** tab you will find the options listed below:

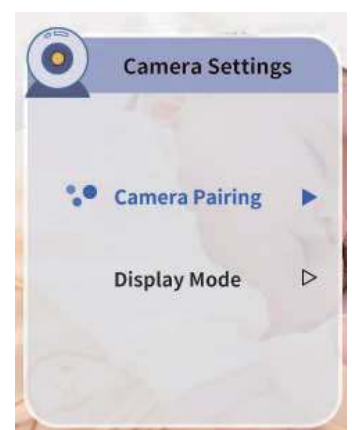
- **Camera Pairing:** Pair or disconnect any Cameras from here. You can pair up to four (4) cameras per Monitor.
- **Display Mode:** When two or more Cameras are connected to the Monitor, you can select between different viewing modes to view each camera feed.



1. To view all cameras simultaneously there are four different modes. Those are: **Full Screen / Dual-Split Screen / Triple-Split Screen / Quad-Split Screen** (as shown below).
2. Use **Multi-Camera Cycling Mode**  to move between each camera at a preset interval.

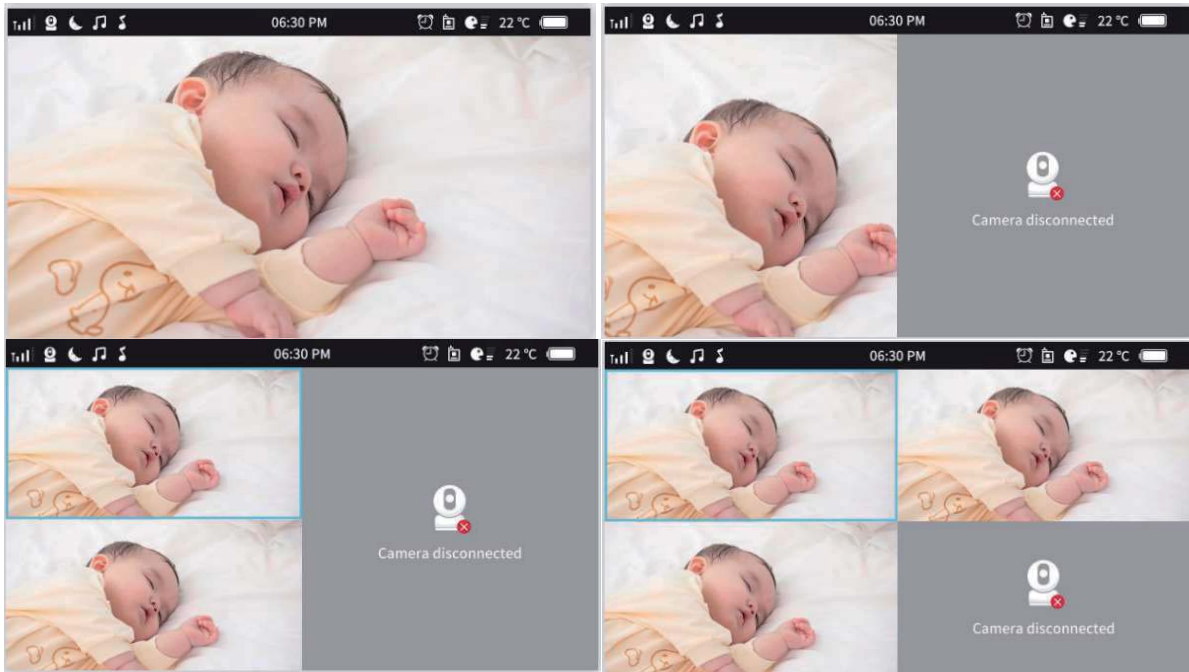

More Settings

Press the **Menu Button** on the Monitor to enter the menu interface. Under the **More Settings** tab you will find the options listed below:



- **Night Vision Mode:** This enables the Camera to let you see your baby more clearly at night or in a dark room by increasing the camera's sensitivity to light. When this mode is enabled the  icon will appear on the screen. Night Vision is effective within a viewing range of up to 5 meters (16.4 ft). When disabled and / or in a completely dark room, the Camera will have limited ability to pick up visual information.
- **Time Setting:** Change the time.
- **Brightness:** Adjust the Monitor's brightness level. The brightness bar will appear on the right-hand side of the display to show the selected brightness. Higher brightness levels will increase battery drain.
- **Sleep Mode:** Activate Sleep Mode to automatically turn the Monitor screen off after a set amount of time. The options available are **1 / 3 / 5** minutes when not in use. **OFF** indicates that Sleep Mode is not active.
- **Language Setting:** Select the language you wish to display on the Monitor. The options available are **English / Japanese / Chinese Simplified**.
- **Temperature Unit:** Select the unit of temperature you wish to display on the Monitor. The options available are **Celsius (°C)** and **Fahrenheit (°F)**.
- **Anti-Screen Flicker:** Helps reduce flickering on the monitor's screen caused by power differences from country to country. If you notice flickering please switch to the other frequency. The options available are 50Hz and 60Hz.
- **Default Settings:** Use to restore the unit to factory default settings.
- **Version Information:** Information about this unit and available

updates.

- **Contact Us:** Email us at **cs@nexigo.com** for more information.

Notes:

- Only use the charger provided by the manufacturer. Unauthorized chargers may cause damage to the products and void any warranty.
- Strangulation Hazard: Cords may be a strangulation hazard and should be properly stored out of reach of children.
- Never use extension cords with AC Adapters.
- Only use the AC Adapters provided with this product.
- Do not use or store the Monitor or Camera in temperatures below 14°F or above 122°F (-10°C to 50°C).
- This product may be damaged by prolonged exposure to direct sunlight. If in direct sunlight ensure that it is shaded and has appropriate ventilation.

FCC Requirement:

Changes or modifications not expressly approved by the party responsible for compliance could void the user's authority to operate the equipment. This device complies with Part 15 of the FCC Rules. Operation is subject to the following two conditions:

- (1) this device may not cause harmful interference, and
- (2) this device must accept any interference received, including

interference that may cause undesired operation.

Note: This equipment has been tested and found to comply with the limits for a Class B digital device, pursuant to Part 15 of the FCC Rules. These limits are designed to provide reasonable protection against harmful interference in a residential installation. This equipment generates, uses, and can radiate radio frequency energy, and if not installed and used in accordance with the instructions, may cause harmful interference to radio communications. However, there is no guarantee that interference will not occur in a particular installation. If this equipment does cause harmful interference to radio or television reception, which can be determined by turning the equipment off and on, the user is encouraged to try to correct the interference by one or more of the following measures:

- Increase the separation between the equipment and receiver.
- Connect the equipment into an outlet on a circuit different from that to which the receiver is connected.
- Consult the dealer or an experienced radio / TV technician for help.



Register to get an **EXTRA ONE** year warranty. Only valid if registering within 14 days of product delivery.

nexigo.com/warranty



Get in touch with **FREE** online services

facebook.com/nexigo1

Model: B200

FCC ID: 2AWDN-B200

