

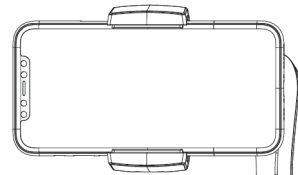

DESIGNED BY YANGGUO TECH



S M A R T X R



ZHONGSHAN YANG GUO ELECTRONIC TECHNOLOGY CO.,LTD.

Address : No.9,Huayuan road,Xiaolan town, Zhongshan city

Telephone : +86(0)760-22289841

Fax : +86(0)760-22289842

Website : www.yg-free.com

Mailbox : as@yg-free.com

Product instruction manual

Portable triaxial folding stabilizer

Product list

Before using this product, please carefully check whether the product package contains all the following items, if there is any missing items, please contact customer service or the merchant.

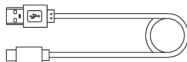
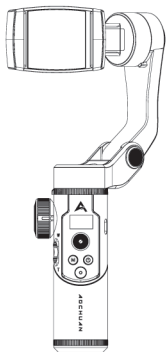

Type-C USB Charging cable x 1



Hand rope x 1



User manual x 1

Four steps of using SMART XR

1. APP downloading

IOS can search "AC play" through APP Store to download.



IOS

Android can be downloaded via the QR code below or by searching for AC play on the Myapp/Google play APP platform.



Google



Android

2. Install phone and adjust balance

Pull open the phone clip, put the phone into the phone clip.

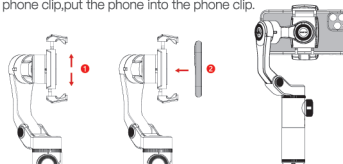

▲ Please do not switch on before the phone is installed.
▲ Please make sure that the back camera of the phone is located outside the gimbal, ensure that normal use is not affected.

Hold the camera face up and push the phone from side to side until it is at rest and level with the ground.

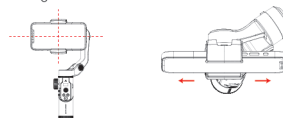

▲ The balance of the phone has a significant effect on the duration of the stabilizer. The stabilizer will still work when the phone is unbalanced, but it will consume more power, and the torque needed to stabilize it will be reduced.

Four steps of using SMART XR

3. Connect the APP

1. Turn on the Bluetooth and the power to the stabilizer.
2. Open "AC paly", select the product page corresponding to the SMART XR, and click "connect now" .

4. Get a tutorial on using



Aochuan official subscription number:

Brand trends/ video teaching / Online Mall / Business Cooperation, Stay tuned for more.



official Tik Tok number:

Follow Tik Tok for more video teaching and excellent video constantly updated.

Know the SMART XR

Device introduction

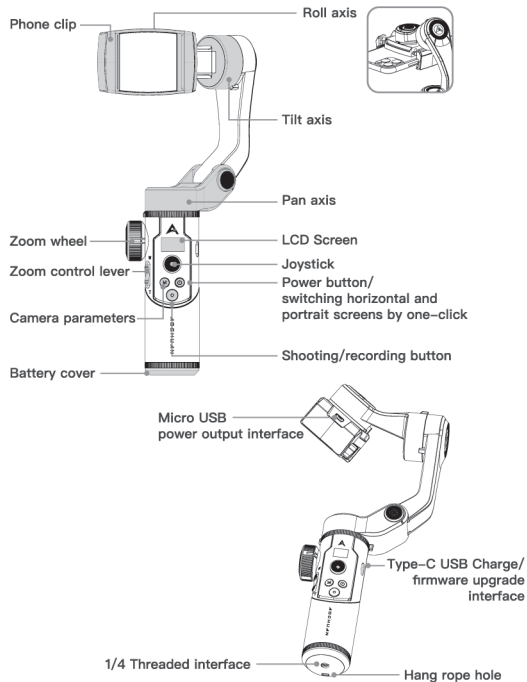

Know the SMART XR

LED screen content introduction

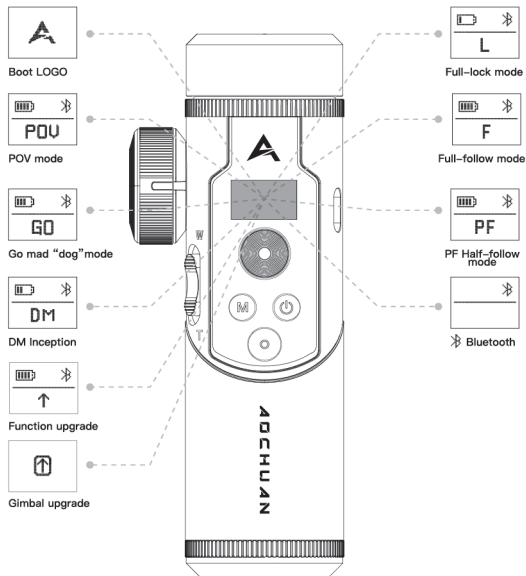

Know the SMART XR

Battery and charging instruction

The SMART XR uses a 18650 lithium-ion battery, which has loaded into the battery compartment when it leaves the factory. Before the first use, please fully charge the SMART XR to activate the battery and ensure the smooth use of the product.

Charging method: connect the power adapter (self-provided, recommended 5v2a) and the stabilizer handle interface using the TYPE-C USB cable provided in the package. The LCD screen will light up to indicate the charging status. When the symbol of [battery icon] is full, the charge is completed.

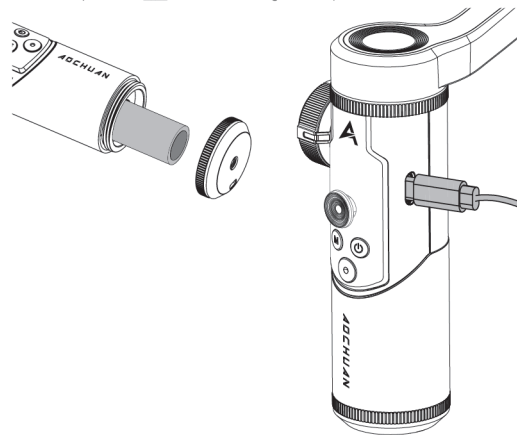

If you need more batteries or battery replacement suggested in the official website to buy.

Function introduction

Instruction of folding use

Fold in the direction indicated by the red arrow

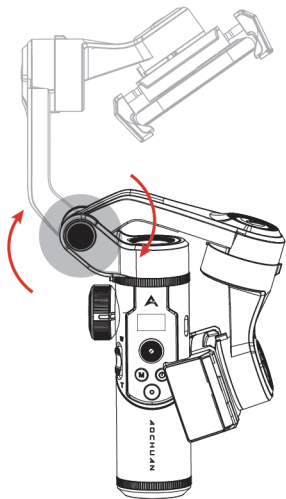

Function introduction

Instructions of using for switching horizontal and portrait screen

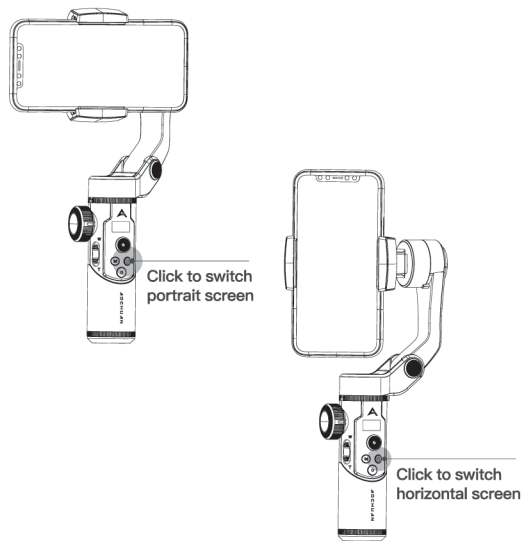

Function introduction

Description of working mode

Switch the joystick to use

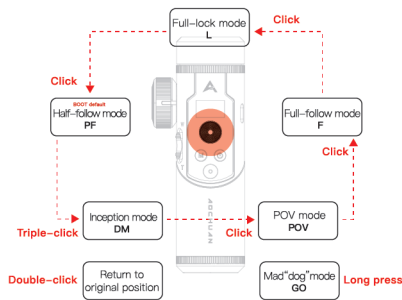

Half-follow mode(PF)

The roll axis and the tilt axis are both locked, and the horizontal direction of the phone follows the handle rotation. Push the joystick up/down to change the tilt angle.

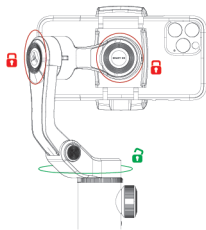

Function introduction

Description of working mode

Full-follow mode(F)

The tilt axis is locked, roll axis and pan axis follow the handle rotation. Push the joystick left or right to change the roll angle.

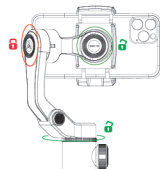

Full-lock mode(L)

All three motors are locked, phone will not follow the movement of the handle. Push the joystick up/down to change the tilt angle and push left/right to change the pan angle.

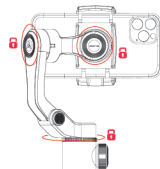

POV mode

All three motors are locked and follow handle rotation.

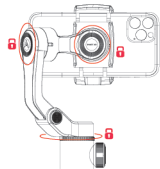

Function introduction

Manually position

In half-follow mode (PF) and full-lock mode (L), you can rotate the phone to a certain angle by hand, after releasing hand, the angle of the phone can be fixed. The tilt axis angle can be adjusted manually in half-follow follow mode (PF), the tilt axis and pan axis angle can be adjusted manually in full-lock mode (L).

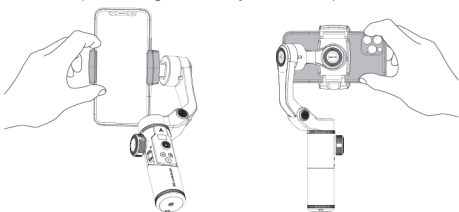

Mobile phone charging

Use a Micro USB port at one end and the other end is the charging cable corresponding to the charging interface of the phone. Connect the stabilizer to the phone, which can be charged when the stabilizer is turned on.

This interface is only used for the stabilizer to charge the phone.
It is forbidden to charge the stabilizer through this interface, otherwise the circuit board may be short-circuited and burned out.

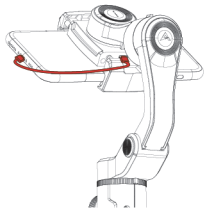

Function introduction

Quick standby

- When the stabilizer is turned on, the cross arm can be manually rotated down to withdraw. When the cross arm is stuck into the built-in locking device, the stabilizer will automatically enter the standby state. Before the stabilizer is restarted or awakened, the cross arm must be manually pulled out of the locking device.
- Reawaken the stabilizer by righting the arm.

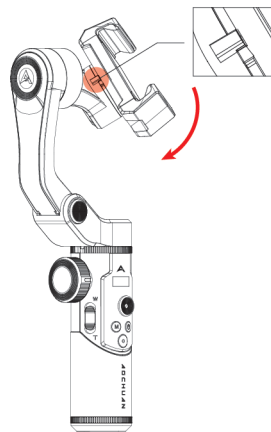

Equipment calibration

In which case calibration is required

Please calibrate the stabilizer as needed.

Calibration reason	Calibration Method
1.After the stabilizer is turned on,the tilt angle of the phone is deviated from the horizontal plane. 2.After the stabilizer is turned on,the roll angle of the phone is deviated from the horizontal plane. 3.The roll axis quiver slightly when it's still.	Initialization
1.After initializing the stabilizer, the horizontal Angle is still deviated. 2.Long-term unused stabilizer. 3.Using environment temperature difference is too large.	Six sides calibration
The tilt angle and roll angle of the stabilizer still deviates from the horizontal plane after initialization and six sides calibration.	Motor fine-tuning

Six – sided calibration method

- 1.Push the joystick down+press the power button to start the six-side calibration,and the steps indicated(L1 to L6).
- 2.Place the device according to the step diagram. When you hear the prompt sound and switch step prompt, you can proceed to the next step until all the six steps are completed.

1. Refer to the following pictures for the procedure of six-sided calibration,After completing the calibration, restart the stabilizer and it can be used normally.
 2. The six-sided calibration operation can be simply understood as making the six planes of the phone clip perpendicular to the horizontal plane.

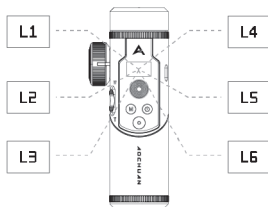

Six-sided calibration screen display

Six-sided calibration pictorial view

Diagram of six-sided calibration steps

STEP 1	L1		
STEP 2	L2		
STEP 3	L3		
STEP 4	L4		
STEP 5	L5		
STEP 6	L6		

Device parameters and function support

Device parameters

Product model	SMART XR		
Product information	Product dimension	236*112*75(Expand size) 154*112*68(Folding size)	
	Product weight	375g(Battery included)	
	Bearing weight	<250g	
Battery specification	Working time	About 8(half-charged state)	
	Charging time	About 2 hours and 40 minutes	
	Working voltage	3.7V	
	Power input	5V/1A	
	Power output	5V/0.3A	
	Charging working temperature	0-45°C	
Gimbal parameters	Li-Ion battery	3.7V/3200mAh	
	Applicable Width of mobile phone	55-90mm	
	Angular accuracy	±0.02°	
	Pan angle	340°Horizontal rotation	
	Roll angle	330°	
	Tilt angle	340°	
	Mode key switches with each click	L Full-lock mode	
		PF Half-follow mode	
		POV POV mode	
		F Full-follow mode	
Triple-click	DM Inception		
	Mode key double-click	Return to original position	
	Long press the mode key	Mad "dog" mode	

Function support

The following functions are the basic functions. For more functions, please further understand the APP

Basic function	IOS	Android
Face tracking	Support	Support
Object tracking	Support	Support
White Balance	Support	Support
Camera parameters	Support	Support
Time lapse	Support	Support
Time lapse move	Support	Support
Hitchcock	Support	Support

*Any data involved in this manual are the internal test results of yangguo laboratory. Under different objective conditions, the data will have different degrees of error. Please refer to the real machine experience.

Matters needing attention

- 1.Do not put into the fire or near high temperature objects.
- 2.Dropping or external force collision will damage the product please use it carefully.
- 3.Do not approach the liquid or clean with detergent.
- 4.Do not disassemble,repair or refit by yourself.
- 5.This product is not suitable for children.

Thank you for purchasing Smart XR.All mentioned in this article is related to your safety and legal rights and responsibilities.Before using this product, please read this article carefully and operate the equipment according to the instructions and warnings of the product to avoid causing injury and damage to you and the people around you.The company reserves the right to interpret all relevant documents.If there is any update without prior notice.Please visit the official website of www.yg-free.com for the latest product information.

Once using this product, it is deemed that the disclaimer and warning have been carefully read.Understand, endorse and accept all terms and contents of this statement.You promise to take full responsibility for the use of the product and the consequences that may result.You undertake to use this product only for legitimate purposes and agree to these terms and to any regulations, policies and guidelines formulated by the company.

We shall not be liable for any loss, injury or legal liability caused by direct or indirect use of the products. Users should follow all security guidelines not limited to those mentioned in this article.

This guide is for reference only, does not constitute any form of commitment, products (including color, size, etc.)Please refer to the actual product.

FCC Requirement

Changes or modifications not expressly approved by the party responsible for compliance could void the user's authority to operate the equipment.

This device complies with Part 15 of the FCC Rules. Operation is subject to the following two conditions:

- (1) this device may not cause harmful interference, and
- (2) this device must accept any interference received, including interference that may cause undesired operation.

Note: This equipment has been tested and found to comply with the limits for a Class B digital device, pursuant to Part 15 of the FCC Rules. These limits are designed to provide reasonable protection against harmful interference in a residential installation. This equipment generates, uses, and can radiate radio frequency energy, and if not installed and used in accordance with the instructions, may cause harmful interference to radio communications. However, there is no guarantee that interference will not occur in a particular installation. If this equipment does cause harmful interference to radio or television reception, which can be determined by turning the equipment off and on, the user is encouraged to try to correct the interference by one or more of the following measures:

- Reorient or relocate the receiving antenna.
- Increase the separation between the equipment and receiver.
- Connect the equipment into an outlet on a circuit different from that to which the receiver is connected.
- Consult the dealer or an experienced radio/TV technician for help.

Warranty service

Warranty regulation

- 1.You may return or replace the product according to the invoice price if the product occurs performance failure within 7 days from the date of receipt.
- 2.Within 1 year from the date of receipt, if there is any quality problem, you can enjoy free maintenance.
- 3.No self-disassembly machine, modification and other acts.
- 4.Proof of purchase required.

Non-warranty regulation

- 1.Disassemble,modify or unintentional falls.
- 2.Damage caused by force majeure (fire, flood, etc).
- 3.Damage caused by not following instruction.
- 4.Beyond the warranty period.

Matters needing attention

- 1.Uses need to send the problem product back,After the after-sale service center received the product,the product failure detection will carry out to determine the responsibility of the problem.
- 2.After inspection, if the product does not meet the conditions of free maintenance, we will charge the maintenance cost according to the nature of the problem.Users can choose to repair or return the original.
- 3.Customers are required to send the product and attach the purchase invoice and warranty card.The warranty card shall not become effective until it is sealed by the seller;The warranty card cannot be altered, otherwise it will be regarded as invalid certificate.
- 4.YangGuo reserves the right of final interpretation.

Warranty card

User information

Name

.....

Telephone

.....

E-mail

.....

Address

.....

Distributor information

Name

.....

Telephone

.....

E-mail

.....

Address

.....

Product information

Model

.....

Identification of product

.....

Date of purchase

.....

Date of inspection	Maintenance date	Failure cause	Result of handling	Signature of maintenance personal