



QUICK MANUAL
Model Name: CMA-030-A

  E-mail: chowis@chowis.com
Skype ID: Hello Chowis Skype

CHOWIS
YOUR CHOICE OF DIAGNOSIS

For more information visit us at www.chowis.com.

Chowis Co., Ltd.
Tel: +82 31 706 7950 / Fax: +82 31 272 7950
Address: A1301-2, 184, Jungbu-daero, Giheung-gu, Yongin-si,
Gyeonggi-do, Republic of Korea, 17095

DEVICE DESCRIPTION



- 1. Moisture sensor
- 2. Magnetic attachment
- 3. Serial Number and Product ID
- 4. Micro USB port (Charging)
- 5. Non-removable lens
- 6. Power Switch (On/Off)
- 7. Light Indicator

SPECIFICATIONS

	Magnification	x30
	Battery	250mAh Li-Polymer
	Product size	46 mm(width) × 106 mm(height) × 31 mm(depth)
	Product weight	75g - Device Only
	Analysis result	Index per measurement (0–99)
	Measurement	 HAIR DENSITY  SCALP SEBUM  SCALP IMPURITIES  SCALP HYDRATION  DEAD SCALP CELL

TURN ON & OFF DEVICE

1. Charge device using USB charger, Charging time is 2 hours maximum.
2. To turn on the device, press the power switch of the dpi Harris device for 3 seconds until LED light blinks
3. To turn off the device, press the power switch for 3 seconds until LED light blinks
4. Put paper film guide on your phone and attach the metal guide

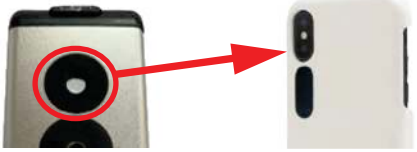

5. Align the device's eyepiece to camera lens.
- 

6. Attach the dpi Harris device on the metal guide of the smart phone (or the phone cover)



USING APP

INSTALLING THE DPI HAIR PICO APP

1. Open App Store/Play Store and search “Chowis.”
2. Select DermoPico Hair app and tap get to install.

CONNECTING DEVICE TO PHONE

1. Turn on Bluetooth on your phone.
2. Open DermoPico Hair app.
3. Choose Product ID of device to connect via bluetooth.
4. Follow device initialization instructions, press start.

NOTE: If connection was successful, Bluetooth indicator will change to blue, if not, it is grey.

USING APP

DERMO PICO HAIR ANALYSIS

1. At the Home Screen, tap Start button to open Analysis.
2. There are 2 choices; **Customer and Quick Analysis.**



Quick Analysis - minor info needed then go to analyze.



REGISTERING NEW CUSTOMER

1. Select Customer and tap on “New Customer” button.
2. Fill up required data on fields, all fields with asterisk * are all important and must not be blank. Then press “Save” button.
3. Select the registered customer on the table and then press “Analysis” button at the bottom.

HOW TO MEASURE

1. DermoPico Hair Measurements

- a. Total Program covers all measurements
 - Scalp Hydration
 - Scalp Sebum
 - Hair Density
 - Dead Skin Cells
 - Scalp Impurities

3. How to Capture Images.

- a. Tap specific measurement on the screen
- b. Place handset on the head
- c. Make use lens touches the scalp of the head
- d. Press Capture button to take image, do not move the headset positions away from the head.

NOTE: All measurements can have the same image taken.

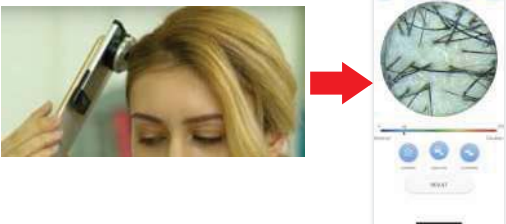

HOW TO ANALYZE

1. Analyzing after all measurements

- a. Tap on every menu on tab to show measurements
- b. On every tab analyze one by one.

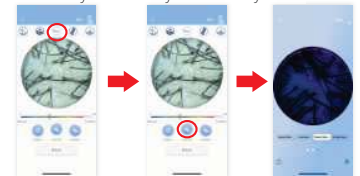

2. Shows all results here

- a. Comparison, compare taken image with professional data set that includes different range of images.



3. Full Results

- a. Tap **RESULT** results button to show results
- b. Results of all measurements will be shown in the horizontal bar graph.
- c. In addition, users can check the results in pie chart on the next page.

This device complies with part 15 of the FCC rules and RSS-247 of Industry Canada. Operation is subject to the following two conditions: (1) this device may not cause harmful interference, and (2) this device must accept any interference received, including interference that may cause undesired operation.

NOTE: The manufacturer is not responsible for any radio or TV interference caused by unauthorized modifications to this equipment. Such modifications could void the user's authority to operate the equipment.

NOTE: This equipment has been tested and found to comply with the limits for a Class B digital device, pursuant to part 15 of the FCC Rules. These limits are designed to provide reasonable protection against harmful interference in a residential installation. This equipment generates uses and can radiate radio frequency energy and, if not installed and used in accordance with the instructions, may cause harmful interference to radio communications. However, there is no guarantee that interference will not occur in a particular installation. If this equipment does cause harmful interference to radio or television reception, which can be determined by turning the equipment off and on, the user is encouraged to try to correct the interference by one or more of the following measures:

- Reorient or relocate the receiving antenna.
- Increase the separation between the equipment and receiver.
- Connect the equipment into an outlet on a circuit different from that to which the receiver is connected.
- Consult the dealer or an experienced radio/TV technician for help.
- This device and its antenna(s) must not be co-located or operating in conjunction with any other antenna or transmitter.