

# K1 Plus User Manual

## Components

### K1 Plus Smart Lock

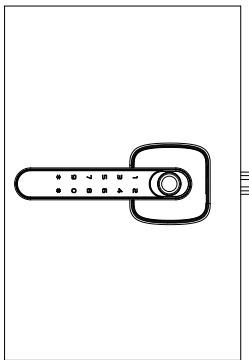

Thanks for choosing our K1 Plus smart lock. Please check the user manual carefully before operation and installation.

### Front Handle

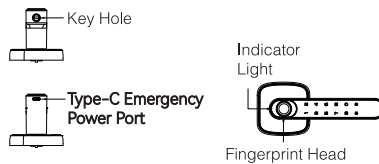

### Back Handle

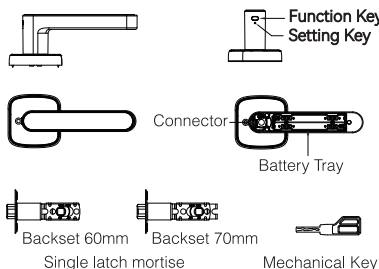

### Packing List

No	Item	Quantity
1	Front Handle	1
2	Back Handle	1
3	Accessories	1
4	User Manual	1
5	Template	1
6	Mortise Lock	1
7	Mechanical Key	2

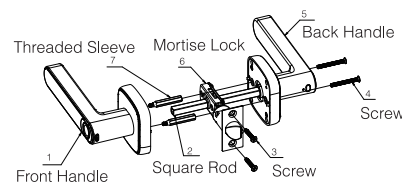

## Installation steps

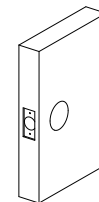

1. Drill a hole on the door as the template required.

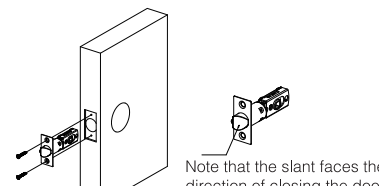

2. Insert the mortise lock into the door. Then use 2 pcs of self tapping screws to fix it.

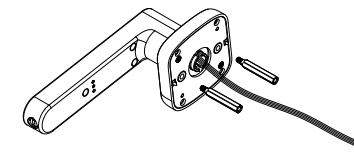

3. Install 2pcs threaded sleeves to the front handle.

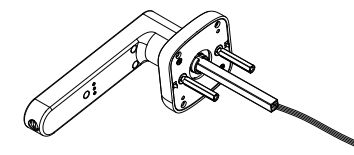

4. Thread the front handle wire through the square hole, then install the square rod.

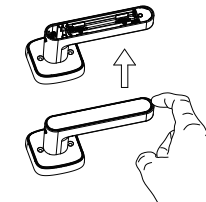

5. Open the plate from the tail of back handle (as shown).

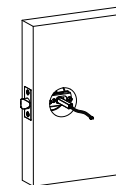

6. Thread the front handle wire and square rod through the mortise lock.

## Instructions

### Emergency power supply and reboot system

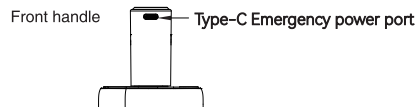

If in low power or the system died, please use Type-C wire to connect to portable power bank and insert in emergency power supply interface. Then you can open properly.

### Restore default settings

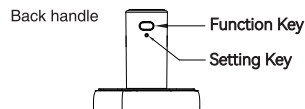

This procedure will delete all user codes associated with the lock. Long-press the setting key by using a needle when the power is on. After hearing the voice prompt, please continue to press the key until restore the factory settings.

### Key

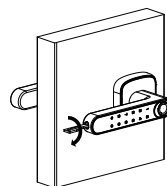

Rotate 90°, then press the handle to open the door.

### Adjust mortise lock length, if necessary

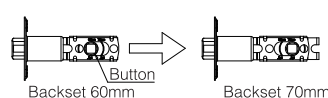

If the backset of your door was 60mm, you do not need to do anything. If the backset of your door was 70mm, you need to adjust your mortise lock. Just push the button to the 70mm space.

### Key Function

Function key: turn on/off Passway mode  
Setting Key: Short click: Enter Setting mode  
Long press: Restore default settings

### Front Handle keyboard operation instructions

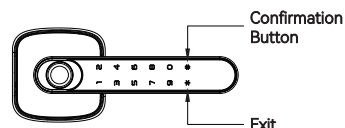

### Back handle

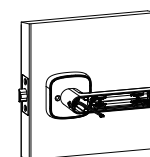
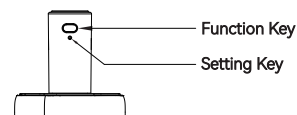

7. Thread the wire from the front handle through the hole in the back handle.

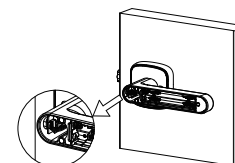

8. Insert the front handle wire into the corresponding sockets on back handle.

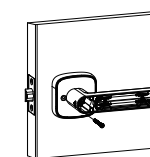

9. At first, fasten the back handle and front handle with one screw (as shown).

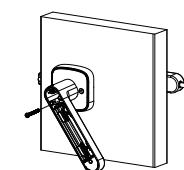

10. Then press the back handle and fasten them with one screw.

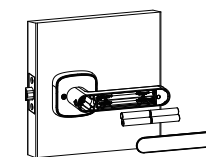

11. At last put into 4\*1.5v AAA alkaline batteries and cover them.

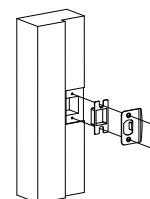

12. Install strike plate and strike box to the door frame, then fasten them with 2 pcs self tapping screws.

## Operating process

### ① Demo mode

After installation, the current state is demo mode, any fingerprint or password can open the door. You can try the system under the voice prompt.

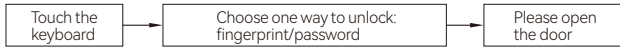

### ② Registered administrator

The first fingerprint or password you registered is the administrator. Subsequent registration and deletions require administrator authorization.

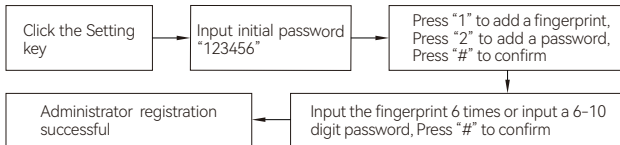

**Note:**After successfully adding the administrator, the Initial password "123456" will automatically lose effectiveness.

### ③ Registered user

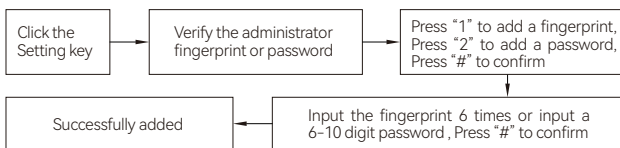

**Note:** 1.Fingerprint capacity is 20, Password capacity is 20.  
2.Cannot register duplicate fingerprints or passwords.

### ④ Delete user

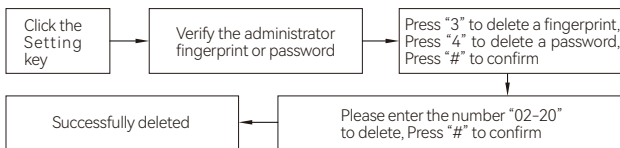

**Note:** Unable to delete administrator information, number 01 is the administrator.

## Attention

1. Operating the lock requires special environment. Please use it in specified field technology ranges. The long time overload and exceed usage will reduce the life length. Please keep your finger clear and prevent this product from long time in sunshine when use it.

2. After a period of time, there will be dirt on the fingerprint reader and may affect normal use. Please use soft cotton to clear the fingerprint reader. The fingerprint head and screen are the fragile glass materials, please do not hit or touch by hard object.

3. If the lock voltage is insufficient when open door, the lock will prompt with alarm sound and red light flash. Please change the battery timely. Please do not use with mixed old and new battery.

### ⑤ Passway mode

Any user can open the door in passway mode.

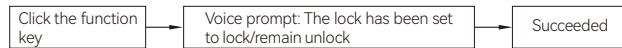

**Note:** You can set it on the App. Turn on the "Tuya" App and select Smart Lock K1 Plus. Click "Settings" and turn on/off the "Auto Lock" button.

### ⑥ Restore default settings

This procedure will delete all user codes associated with the lock and the system will revert to demo mode.

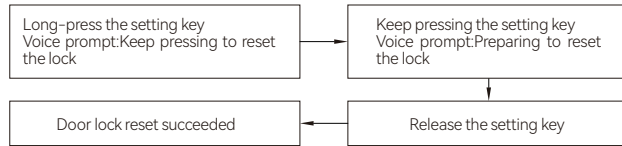

**Note:** If released in the second step, the door lock reset will be canceled.

### ⑦ Bluetooth function

Please download the "Tuya" App from the App stores before using this function.

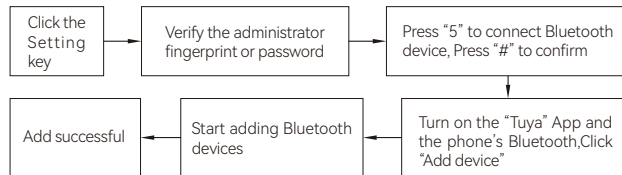

**Note:** If you have not registered administrator before binding the "Tuya" App, please register the administrator from the "Tuya" App. The first fingerprint or password you registered is the administrator.

Before binding Tuya App, you can directly use the smart lock to add and delete users as well as passwords. However, after binding Tuya App, operations for adding and deleting users and passwords can only be performed through the Tuya app.

4. The lock handle is the necessary auxiliary tool to open door. Please do not hang any heavy object on the handle.

5. Please choose professional worker to install the door lock and follow with our installation standard. Please do not disassemble this lock personally and take care of relevant label to avoid unnecessary trouble for warranty.

6. Please register administrator fingerprint and keep the mechanical keys after lock is installed well. When the fingerprint and password and other methods can't open door, you can open door by mechanical key.

## Tuya App operation instructions

### ① Unlock

1. Turn on the "Tuya" App and select Smart Lock K1 Plus
2. Turn right the key button to unlock

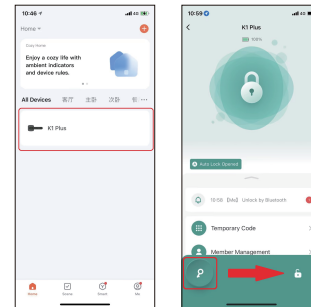

### ② Temporary code settings

1. Select "Temporary code"
2. Choose the code type and enter a 6-10 digit password
3. Setting the effective time and expiration time
4. Click "Save" successful

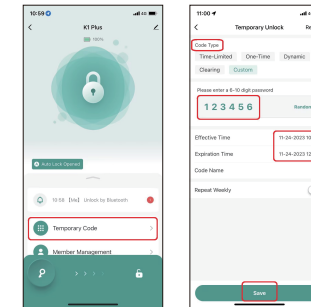

### ③ Member Management settings

1. Select "Member Management"
2. Choose the family member
3. Click the "+Add" to registered user fingerprint or code
4. According to the prompt, finish registration

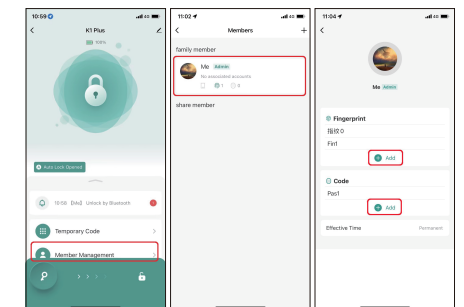

### ④ Turn on/off mute mode

There is no voice prompt when opening the door in mute mode (retain light prompt). Other operations still have voice prompts.

1. Select "Settings"
2. Turn on/off the "Mute Control" button
3. Succeeded

### ⑤ Language settings

1. Select "Settings"
2. Click "Language settings", choose English or Chinese, Press "OK" to confirm
3. Succeeded

### FCC ID:2AW72-K1PLUS

This device complies with Part 15 of the FCC Rules. Operation is subject to the following two conditions: (1) this device may not cause harmful interference, and (2) this device must accept any interference received, including interference that may cause undesired operation.

This equipment complies with FCC radiation exposure limits set forth for an uncontrolled environment. This equipment should be installed and operated with minimum distance 20cm between the radiator and your body.

## FCC WARNING

Warning: Changes or modifications to this unit not expressly approved by the party responsible for compliance could void the user's authority to operate the equipment.

## FCC STATEMENT

NOTE: This equipment has been tested and found to comply with the limits for a Class B digital device, pursuant to Part 15 of the FCC Rules. These limits are designed to provide reasonable protection against harmful interference in a residential installation. This equipment generates uses and can radiate radio frequency energy and, if not installed and used in accordance with the instructions, may cause harmful interference to radio communications.

However, there is no guarantee that interference will not occur in a particular installation, If this equipment does cause harmful interference to radio or television reception, which can be determined by turning the equipment off and on, the user is encouraged to try to correct the interference by one or more of the following measures:

- Reorient or relocate the receiving antenna.
- Increase the separation between the equipment and receiver.
- Connect the equipment into an outlet on a circuit different from that to which the receiver is connected.
- Consult the dealer or an experienced radio/TV technician for help.