

Fast Wireless Charger

10W Fast Charging for Samsung / 7.5W Max Charge for iPhone

USER
MANUAL



- ◆ USB-C Input: 5V/2A, 9V/1.8A
- ◆ Wireless Output: 5V/1A, 9V/1.1A
- ◆ Size: $\Phi=60$ mm
- ◆ Product weight: 51±10g

WHAT'S INCLUDED

- 1X MagSafe compatible Wireless Chargers
- Quick Start Guide

CHARGING WITH WIRELESS CHARGING PAD

Connect the USB (Type-C) end of the Wireless Charger to your Computer, AC charger or car charger. For fast charging make sure to use an AC Adapter that supports at least 9V.

Place your mobile device on the center of the charging pad, if you are using an iPhone 12 or later equipped with MagSafe the Wireless Charger will magnetically attach to the Wireless Charger and begin charging the iPhone. For other mobile devices try to align the wireless charging coils on your mobile device and the charging pad as accurately as possible. Your mobile device should indicate charging in the first few seconds.

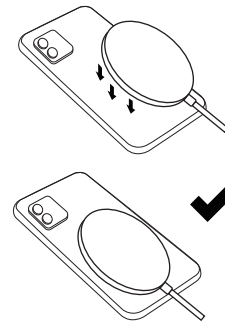

▲ NOTE: Distance between your mobile device and the charging pad should be no more than 6mm, most phone cases should not obstruct phone charging unless they are more than 6mm thick. Make sure there are no magnets or cards between your device and the charging pad, any types of metal will obstruct charging.

▲ NOTE: Increased or warm temperature on a mobile device or the wireless charging pad while charging is normal.

▲ NOTE: Wireless charging only compatible with mobile devices that support Qi Charging standard.

SAFETY INSTRUCTIONS

FAILURE TO FOLLOW THE SAFETY INSTRUCTIONS CAN LEAD TO FIRE, ELECTRICAL SHOCK, PERSONAL INJURY OR PROPERTY DAMAGE OR DAMAGE TO THIS PRODUCT. MAKE SURE TO READ THE ENTIRE MANUAL.

- Do not use this unit for anything other than its intended use.
- Keep the unit away from heat source and direct sunlight.
- Do not expose the unit to extremely high or low temperatures.
- Use the product in a location with a temperature of 32°F (0°C) - 95°F (35°C)
- Do not let the unit come in contact with water or any other liquid. If the unit becomes wet, immediately unplug it from the power source.
- Do not handle unit, USB cord or wall charger with wet hands.
- Do not let dust or other things accumulate on the product or wall charger.
- Do not use the unit if it has been dropped or damaged in any way.
- Repairs to electrical equipment should only be performed by a qualified electrician. Improper repairs may place the user at serious risk.
- If you have an electrical device such as a pacemaker, consult a physician before using this product.
- Do not place magnetic cards or similar items near this product.
- Use the specified power source and voltage.
- Do not use voltage converter /travel adapter.
- Keep out of reach of children.
- Do not place the mobile device on a wireless charger with conductive materials between them, such as metal objects and magnets (some cases may have metal inserts).
- Phone case friendly; 1-6mm, if the phone case is too thick, remove before charging.
- In case of bulging, leaking or strong smell, please stop using the device immediately.
- When fully charged, disconnect the device from the electricity network.

- Dispose of properly or send to recycling center to save the environment.
- Charging time will vary depending on brand of adapters being used due to different specifications.

Warning: Changes or modifications to this unit not expressly approved by the party responsible for compliance could void the user's authority to operate the equipment.
NOTE: This device complies with part 15 of the FCC Rules. Operation is subject to the following two conditions: (1) This device may not cause harmful interference, and (2) this device must accept any interference received, including interference that may cause undesired operation.

NOTE: This device complies with part 18 of the FCC Rules. Information to the user. The device has potential interference, but the interference is very small and meets the requirements of the FCC rule

- Equipment system maintenance is simple, please refer to the manual
- The user can take simple measures to correct the interference. Such as staying away from interference sources, turning off interference sources, etc.
- FCC Statement: This equipment has been tested and found to comply with the limits for a Class B digital device, pursuant to part 15 of the FCC Rules. These limits are designed to provide reasonable protection against harmful interference in a residential installation. This equipment generates, uses and can radiate radio frequency energy and, if not installed and used in accordance with the instructions, may cause harmful interference to radio communications. However, there is no guarantee that interference will not occur in a particular installation. If this equipment does cause harmful interference to radio or television reception, which can be determined by turning the equipment off and on, the user is encouraged to try to correct the interference by one or more of the following measures:
 - Reorient or relocate the receiving antenna.
 - Increase the separation between the equipment and receiver.
 - Connect the equipment into an outlet on a circuit different from that to which the receiver is connected.
 - Consult the dealer or an experienced radio/TV technician for help.
- RF exposure compliance statement:
This device has been evaluated to meet the general RF exposure requirement

95 mm

95 mm

190 mm

95 mm

95 mm

190 mm

95 mm