

MIBHUVAN

Thank you for purchasing
and using this product!

To bring you a better experience, read this manual carefully
and please refer to your mobile phone or your
electronic product manual.

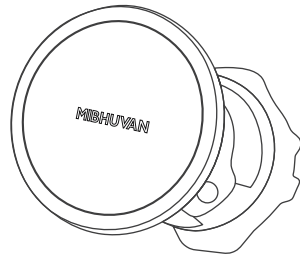

Product Overview

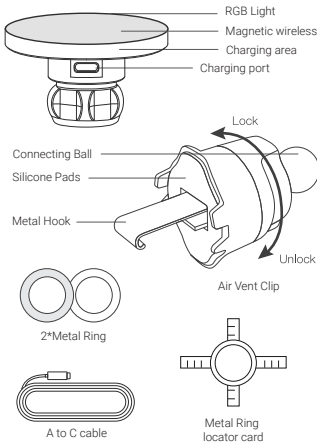

About the mechanism for using refrigeration:

1. After plugging into DC power, the LED remains on for 3S and then goes out.
2. When Wireless Charger has devices connected to it, when the mobile phone is charged, the LED goes out Automatically; when the mobile phone is removed, the LED remains on.
3. When not charging, the LED turns on and the surface temperature keeps normal temperature; when charging, the surface temperature is below 40 °C.

① How to mount the metal ring?

Instruction

1. Use wet & dry tissue to wipe first
2. Determine the center by using a metal ring locator card(Align the metal ring locator card up and down and place it on the back of the iPhone/iPhone case)
3. Stick the protective film on the center of the iPhone/iPhone case;
4. Tear off the protective film of the metal ring and stick it on the center.

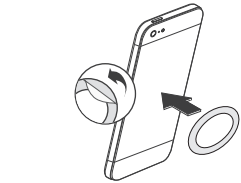

② How to use this clip of air vent?

1. Turn the nut counterclockwise to release the metal hook slowly to the maximum length.
2. Along the ventilation blades' gap, insert the metal ends, then adjust the position slowly until the ventilation blade snaps into the metal hook.
3. Adjust the angle of the upper and lower ventilation blades to snap into the grooves on both sides of the clip. Finally, turn the nut clockwise to fix.

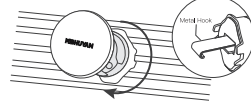

Instruction

1. Unscrew the fixed nut, let the connecting ball through the fixed nut (The thread must face the groove), then turn the nut clockwise to fix.

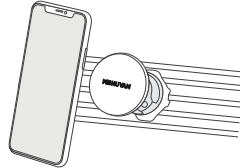

③ Instruction A

iPhone 13/12 Series & Magsafe Cases:

Fasten your iPhone 12/13 series phone directly to the magnetic mount without attaching extra metal rings/tools.

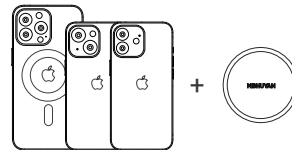

④ Instruction B

Suitable for Other Phones & Cases:

When you use an iPhone 12 or iPhone 13 with a case (not a Magsafe case), or another iPhone(not iPhone 12/13), you need to use the metal ring and hold it close to the magnetic stand.

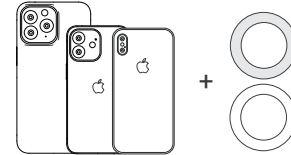

⑤ Question Answer:

Q1: Can both iPhone 13/12 series and Magsafe case use this magnetic phone holder directly?

A1: Yes, iPhone 13 Pro Max/ 13 Pro/ 13/ 13 Mini/ 12 Pro Max/ 12 Pro/ 12/ 12 Mini/ Magsafe Case/ Magnetic Case, etc., you can use this magnetic wireless car charger directly.

Q2: When do I need to use a metal ring, and when do I not?

A2: The metal ring is not required when you use the iPhone 13/12 series without a case or with a Magsafe case; the metal ring is required when you use another iPhone(not iPhone 12/ 13 series), or iPhone 13/12 but with a normal case (not a Magsafe case).

Q3: Will this metal ring affect wireless charging with Magsafe or other chargers?

A3: Don't worry. Can use it with branded chargers like Magsafe.

Precautions

1. Please use QC2.0 3.0 or PD car charger.
2. Metal accessories (metal pad, popsocket) or credit cards will interfere with charging. The cases containing metal, such as Pitaka, Evutec and Spigen QNMP, will trigger foreign object detection and interrupt charging.
3. Using the phone for GPS or listening to music while charging will significantly affect the charging speed. When using GPS applications, the power consumption may be higher than the charging speed.
4. It is normal for the wireless charger to have slight heating during use. If you encounter serious heating, please suspend use and contact us.

Product Specifications

Product name	MagSafe magnetic suction wireless charging bracket
Model	CT5-49
Size	Φ 61*35.8 (mm)
Net Weight	130g
Applicable Places	Air Vent
Applicable Model	iPhone
Output	5W/7.5W/10W/Q1 15W
Product List	2 * Metal Ring, 1 * Alcohol Pad, 2 * Protective film, 1 * locator card, 1 * Mag-safe Car Charger, 1 * Air Vent Clip

Please read this operation instruction carefully and keep it properly before using this product.

FCC Statement

Changes or modifications not expressly approved by the party responsible for compliance could void the user's authority to operate the equipment.

This equipment has been tested and found to comply with the limits for a Class B digital device, pursuant to Part 15 of the FCC Rules. These limits are designed to provide reasonable protection against harmful interference in a residential installation. This equipment generates uses and can radiate radio frequency energy and, if not installed and used in accordance with the instructions, may cause harmful interference to radio communications. However, there is no guarantee that interference will not occur in a particular installation. If this equipment does cause harmful interference to radio or television reception, which can be determined by turning the equipment off and on, the user is encouraged to try to correct the interference by one or more of the following measures:

- Reorient or relocate the receiving antenna.
 - Increase the separation between the equipment and receiver.
 - Connect the equipment into an outlet on a circuit different from that to which the receiver is connected.
 - Consult the dealer or an experienced radio/TV technician for help.
- This device complies with part 15 of the FCC rules. Operation is subject to the following two conditions: (1) this device may not cause harmful interference, and (2) this device must accept any interference received, including interference that may cause undesired operation.

The distance between user and products should be no less than 20cm.