

XTOOL

Web: www.xtooltech.com

Programmable universal tire pressure sensor

TS100 Uni-Sensor (Metal Cycle Valve)1-Sensor



! Attention: Before use the Xtool TS100 tire pressure sensor, must use Xtool tire pressure programming device to program first, suggest finishing programming before install tires. When driving the vehicle which is equipped with this type of tire pressure sensor, suggest maintaining vehicle driving speed≤240km/h.

Security guidance

Before install TS100 tire pressure sensor, please reading this security instruction. As the reason of security and optimized operation, we suggest all of the maintaining and repairing work only trained personnel according to vehicle manufacturer guiding principle to operate. Cycle valve is related to vehicle security parts, use only for professional installation, otherwise it may be result in TPMS tire pressure sensor damage. If the product appear error or incorrect installation, Shenzhen Xtooltech Co., Ltd do not undertake any responsible.

Attention

- TS100 tire sensor module is equipped with tire pressure monitor system vehicle of leave factory replaceable and maintaining parts.
- Make sure using Xtool tire pressure sensor programming tool before install via select specific vehicle series, vehicle type and the year of manufacture to program TS100 tire pressure sensor.
- Please do not install TPMS tire pressure sensor into the broken tire which have programmed.
- In order to guarantee optimum performance, please do not install cycle valve and parts which are not belong to Xtool on Xtool TS100 tire pressure sensor. After finish installation, according to original vehicle manufacturer user guide
- steps to test vehicle TPMS to confirm correct installation.

Warranty repair

Shenzhen Xtooltech Co., Ltd (Hereinafter referred to as "Company") promise to all this product original retail buyers, since the day of delivery and under two years or under 40000 km, if in the case of normal use, this product or any parts is confirm that exist material or the flaw of craft aspect result in device breakdown, via proof of purchase, company will as the circumstances may require free of charge for you to repair or replace (New product or parts) . Because the product misuse、 misoperation or rig up error bring about additional damage or indirect damage, company assume no responsibility.

This warranty repair is not adjust to following situations:

1. Product rig up error;
2. Misuse;
3. Because crash or tire defect bring about product damage;
4. Racing or other unconventional use bring about product damage;
5. Over the specific use restriction of product.

TS100 tire pressure sensor detail sketch

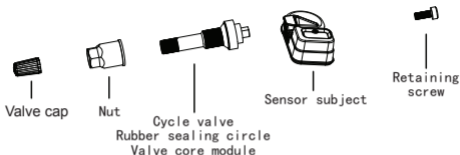

TS100 tire pressure sensor technical parameters

TS100 tire pressure sensor weight (Do not contain cycle valve)	13.8 g
Boundary dimension	About 46.4*25*16.2mm
Maximum pressure	900 kPa

⚠ Attention

Every time tire servicing or teardown or TS100 tire pressure sensor teardown or replace, must use our parts to replace rubber washer、washer、nut and valve core, make sure sealing good.

If it is external damage, must replace TS100 tire pressure sensor.

Correct TS100 tire pressure sensor nut torque: 4Nm。

Installation guide

⚠ Significance: before install TS100 tire pressure sensor, please read this instruction carefully, please pay special attention to safety warning and announcements of this instruction. Please according to this instruction to use TS100 tire pressure sensor correctly, otherwise may be result in TS100 damage or personal injury, and make the warranty repair lose efficacy.

① Loosen tire

Take down valve cap and valve core, deflate the tire.

Use wind pressure shovel to strip tire rubber cover tire away from rim.

⚠ Attention: please let the cycle valve via 180° face to wind pressure shovel.

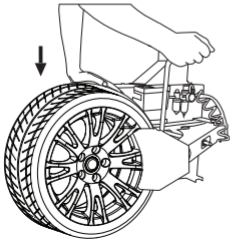

② Unload tire

Let the tire clamp on tire changer , adjust cycle valve to relative to tire separated plug 1 o'clock location , insert tire tool and lift the tire bead on installation plug to remove tire bead.

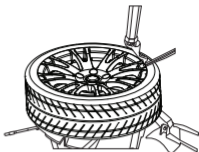

⚠ Attention: In the whole removal process must abide by this beginning location.

③ Remove TS100 tire pressure sensor

Remove the valve cap、nut、washer from cycle valve rod , then remove TS100 tire pressure sensor module from rim.

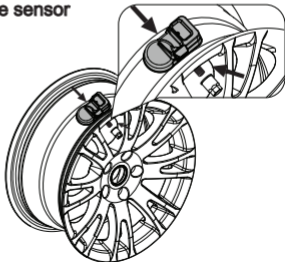

④ Install TS100 tire pressure sensor and cycle valve

Step1. Connect cycle valve and TS100 tire pressure sensor subject firmly.

Attention: Make sure module connect firmly.

Step2. Remove the valve cap、nut and washer from cycle valve.

Step3. Valve rod across the valve opening, let TS100 tire pressure sensor located in rim interior, assemble washer、nut on valve rod fist and last.

Step4. Use 4.0 N•m torque screw up nut, then assemble bonnet back on valve rod.

Step 1

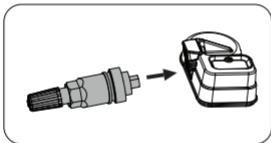

Step 2

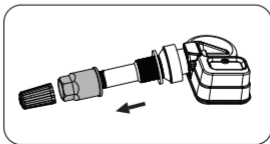

Step 3

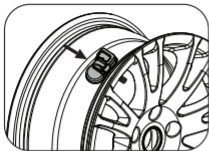

Step 4

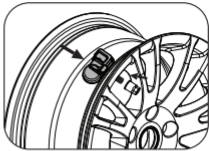

⑤ Install tire

Put tire on the rim, make sure cycle valve via 180° face to separated plug, install tire on the rim.

▲ Attention: Should abide by change tire machine manufacturer instruction to install tire on rim.

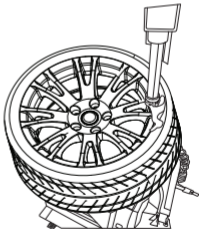

XTOOL

Web: www.xtooltech.com



Programmable universal tire pressure sensor

TS100 Uni-Sensor (Rubber cycle valve)1-Sensor

- ⚠ Attention:** Before use Xtool TS100 tire pressure sensor must use Xtool tire pressure device to program, suggest finish programming before tire mounting. When driving the vehicle which is equipped with this type of tire pressure sensor, suggest maintaining vehicle driving speed ≤ 210 km/h.

Security guidance

Before install TS100 tire pressure sensor, please reading this security instruction. As the reason of security and optimized operation, we suggest all of the maintaining and repairing work only trained personnel according to vehicle manufacturer guiding principle to operate. Cycle valve is related to vehicle security parts, use only for professional installation, otherwise it may be result in TPMS tire pressure sensor damage. If the product appear error or incorrect installation, Shenzhen Xtooltech Co., Ltd do not undertake any responsible.

Attention

- TS100 tire sensor module is equipped with tire pressure monitor system vehicle of leave factory replaceable and maintaining parts.。
- Make sure using Xtool tire pressure sensor programming tool before install, via select specific vehicle series, vehicle type and the year of manufacture to program TS100 tire pressure sensor.
- Please do not install TPMS tire pressure sensor into the broken tire which have programmed.
- In order to guarantee optimum performance, please do not install cycle valve and parts which are not belong to Xtool on Xtool TS100 tire pressure sensor.
- After finish installation, according to original vehicle manufacturer user guide steps to test vehicle TPMS to confirm correct installation.

Warranty repair

Shenzhen Xtooltech Co., Ltd (Hereinafter referred to as "Company") promise to all this product original retail buyers, since the day of delivery and under two years or under 40000 km, if in the case of normal use, this product or any parts is confirm that exist material or the flaw of craft aspect result in device breakdown, via proof of purchase, company will as the circumstances may require free of charge for you to repair or replace (New product or parts) . Because the product misuse、 misoperation or rig up error bring about additional damage or indirect damage, company assume no responsibility.

This warranty repair is not adjust to following situations:

1. Product rig up error;
2. Misuse;
3. Because crash or tire defect bring about product damage;
4. Racing or other unconventional use bring about product damage;
5. Over the specific use restriction of product.

TS100 tire pressure sensor detail sketch

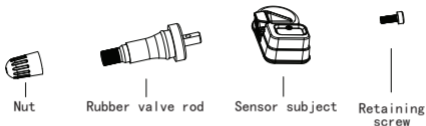

TS100 tire pressure sensor detail sketch

Without cycle valve TS100 tire pressure sensor weight	13.8 g
Boundary dimension	About 46.4*25*16.2mm
Maximum pressure	900 kPa

⚠ Attention

Every time tire servicing or teardown or TS100 tire pressure sensor teardown or replace, must use our parts to replace rubber washer、washer、nut and valve core, make sure sealing good.

Please avoid extreme temperature.

Installation guide

▲ Significance: before install TS100 tire pressure sensor, please read this instruction carefully, please pay special attention to safety warning and announcements of this instruction. Please via this instruction to use TS100 tire pressure sensor correctly, otherwise may be result in TS100 damage or personal injury, and make the warranty repair lose efficacy.

① Loosen tire

Remove bonnet and core, and deflate the tire.

Use bead loose actuator unload tire bead.

▲ Attention: Lock washer must face to cycle valve.

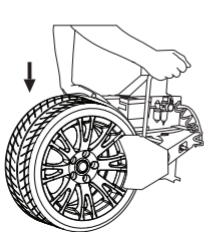

② Unload tire

Clamp the tire on tire changer, and it is relative to tire separated plug in 10 o'clock location to adjust cycle valve.

Insert tire tool and lift tire bead on installation plug to unload tire bead.

▲ Attention: In the whole removal process must abide by this beginning location.

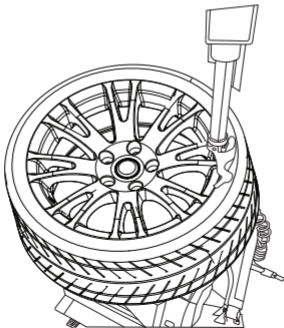

③ Unload TS100 tire pressure sensor

Screw out the screw at the end of rubber valve rod, fetch the sensor subject carefully. Carve up rubber snap joint and connect a standard cycle valve extractor to rubber valve, according to pull the margin to unload cycle valve from valve clack.



④ Install TS100 tire pressure sensor and cycle valve

Step 1. Tighten the screws to connect the cycle valve and sensor subject firmly. Paint grease or lubricating oil on rubber valve rod.

Step 2. Insert the valve rod into valve opening from rim interior, and connect a standard valve cycle extractor to the end of valve rod.

Step 3. Pull the valve rod to stuck on the valve opening firmly, then assemble the bonnet back on valve rod.

▲ Attention: cycle valve and margin opening should be concentric.

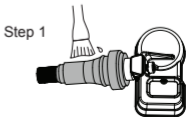

Step 2



Step 3

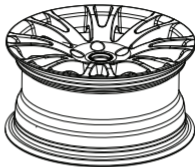

⑤ **Install tire**

Put the tire on the rim, make sure cycle valve via 180° face to separated plug. Install the tire on the rim.

▲ **Attention:** Should use change tire machine manufacturer instruction to install tire on rim.

