

# USER MANUAL

## Portable Power Bank

MODEL: B01PW

Thank you for purchasing our products. For optimum performance and safety, please read this manual carefully before operating the Power Bank and keep this manual for future reference.

-1-

## Layout

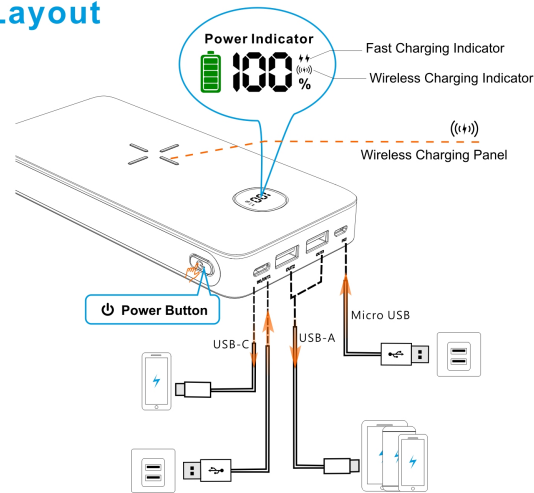

## Specification

Item	B01PW
Output	5V=3A / 9V=2A / 12V=1.5A
Input	5V=3A / 9V=2A
(+) Wireless Charging Function	10W(max)
Dimensions	6.1 x 2.9 x 0.9 in (15.5 x 7.5 x 2.4 cm)
Operating Temp Range	32°F to 113°F (0°C to 45°C)

-2-

## Charge Your Phone or Tablet.

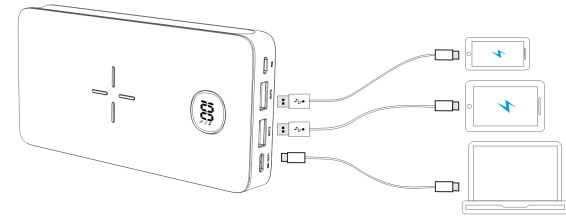

## Recharge your Power Bank. (Use PD/QC adapter to achieve faster charging.)

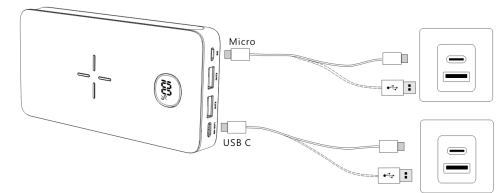

When the power bank is fully charged, the screen will show 100%. Please fully charge the power bank by wall charger before the first use.

-3-

## Digital LED screen shows the accurate readout.

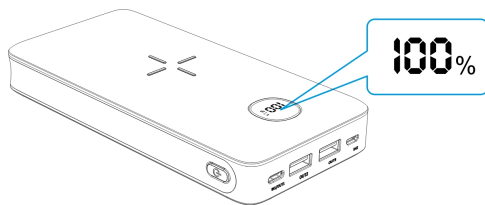

## How to Charge Your Phone by Wireless Charging Function?

P.S. Your phone must be equipped with Qi charging function.

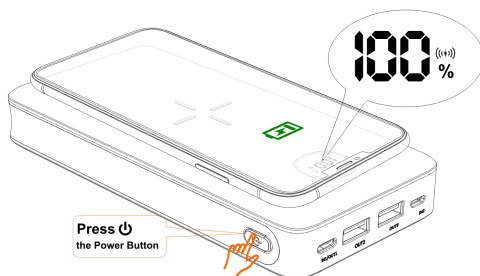

-4-

1. Press the Power Button to activate the wireless charging function, then the wireless charging indicator will light up. Place your phone on the wireless charging panel, making sure that the center of the phone is aligned with the center of the wireless charging panel. In this way, your phone will be charged within 2s, if not, please adjust the location of the phone.
2. The distance between the phone and the wireless charging panel must be less than 3mm, if the phone case is too thick, it will affect the wireless charging function.
3. No metal objects, such as metal phone case, coins, metal sheet etc., can be placed between the device to be charged and the wireless charging panel.

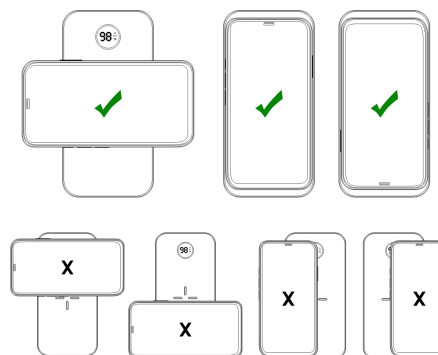

-5-

## WARNING

1. This product is not a toy, please keep it out of the reach of children to avoid accidents, please don't let children use or play it.
2. Please note that this power bank can't be used in rainy nor can it be washed or placed in water. If there is liquid penetrating into the product, it may cause short circuit or damage, then please stop using it immediately and dispose of it properly.
3. The operating temperature of this product is 32°F to 113°F (0°C to 45°C), so please don't put it in temperatures above 140 (60°C). (Including places close to heat sources, such as stoves, heating etc.)
4. This product contains Li-polymer battery, so it is strictly bidden to disassemble, squeeze and puncture the product put it into water or fire, as this may result in damage to the battery, short circuit, fire, and burning.
5. If there is bulge, deformation, liquid leakage, overheating or a significant drop in power, please stop using it immediately and dispose of it properly, and contact us and we will offer you a replacement or a full refund.
6. Please fully charge your Power Bank by a wall charger before first use.
7. When charging your phone, please use the original cable of your phone to connect with the charger to achieve intelligent recognition and rapid charging.
8. Fully charge the unit every 3 months to extend battery life.

-6-

## FCC statement

This device complies with Part 15 of the FCC rules. Operation is subject to the following two conditions: 1) this device may not cause harmful interference, and 2) this device must accept any interference received, including interference that may cause undesired operation.

Note: This equipment has been tested and found to comply with the limits for a Class B digital device, pursuant to part 15 of the FCC Rules. These limits are designed to provide reasonable protection against harmful interference in a residential installation. This equipment generates uses and can radiate radio frequency energy and, if not installed and used in accordance with the instructions, may cause harmful interference to radio communications. However, there is no guarantee that interference will not occur in particular installation. If this equipment does cause harmful interference to radio or television reception, which can be determined by turning the equipment off and on, the user is encouraged to try to correct the interference by one or more of the following measures:

- Reorient or relocate the receiving antenna.
- Increase the separation between the equipment and receiver.
- Connect the equipment into an outlet on a circuit different from that to which the receiver is connected.
- Consult the dealer or an experienced radio/TV technician for help.

Changes or modifications not expressly approved by the party responsible for compliance could void the user's authority to operate the equipment.

### FCC Radiation Exposure Statement

To maintain compliance with FCC's RF Exposure guidelines, This equipment should be installed and operated with minimum 20cm distance between the radiator your body.