

TOPDON

CarPal Quick User Guide

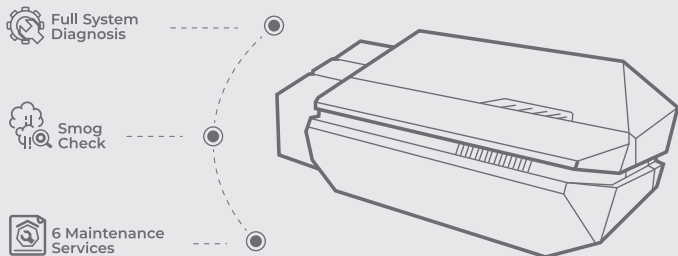

Thank you for purchasing the TOPDON CarPal. This quick user guide will walk you through the basic setup and operation of the CarPal wireless diagnostic dongle. For the best user experience, carefully read and follow all the instructions and warnings.

1 Download & Install the APP



Please go to the **App Store** or **Google Play** and search for the "TopDon CarPal" to download and install the App.

2 Register & Log In

a TOPDON account will be created automatically the first time you log in

Email

Next

I have read and agreed to the TOPDON's Privacy Policy and Terms of Services

Password Login

—Other Login Methods—

Log in to your account using your email and the verification code you received. (If you do not have an account, your email address will be used to register an account automatically the first time you log in.)

3 Add the VCI

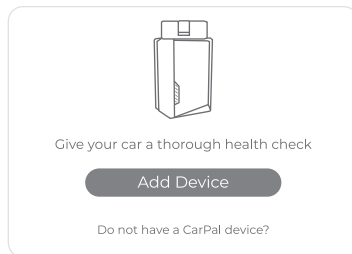

To add a device for the first time, tap **Add Device**.

If you need to add more devices, tap **Mine > VCI Management > Add VCI**.

4 Plug the CarPal into the vehicle's OBD-II port.

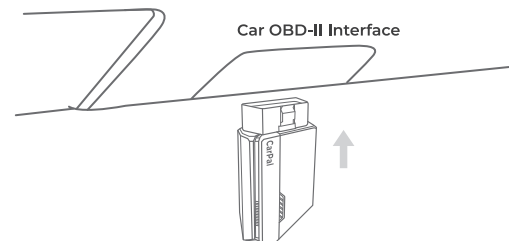

The vehicle's OBD-II port is usually located under the dashboard.

TEL	86-755-21612590 1-833-629-4832 (North America)
EMAIL	SUPPORT@TOPDON.COM
WEBSITE	WWW.TOPDON.COM
FACEBOOK	@TOPDONOFFICIAL
X	@TOPDONOFFICIAL

*This device complies with Part 15 of the FCC Rules. Operation is subject to the following two conditions: (1) this device may not cause harmful interference, and (2) this device must accept any interference received, including interference that may cause undesired operation.

*Any changes or modifications not expressly approved by the party responsible for compliance could void the user's authority to operate the equipment.



5

Turn the ignition to the "ON" position.

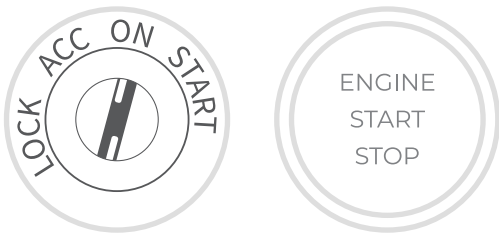

The red LED light on the CarPal indicates it is powered on.

6

Bluetooth Connection

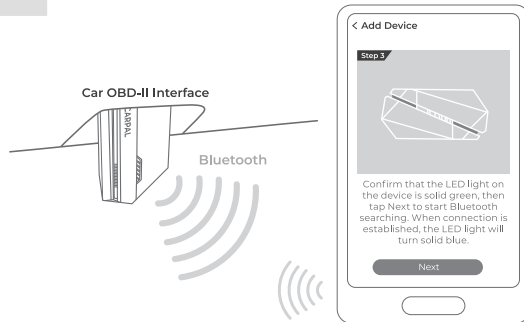

When the LED light is solid green, you can begin the Bluetooth connection. When connection is established, the LED light on the device will turn solid blue, and the VCI will be activated automatically.

7

Your CarPal is now ready for use.

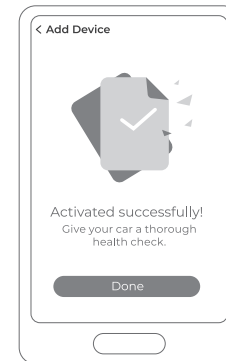

8

Start the first vehicle health check.

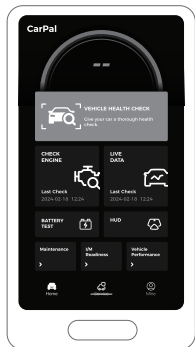

Tap Vehicle Health Check to start the first vehicle health check and get your vehicle's rating.

Update

The installed vehicle-specific software can be seen on the software download page. When a new version is available, an **Update** button will display. Tap the button to update the software.

For firmware updates, tap **Mine > Firmware Update** to update the firmware if a new version is available.

FAQ

Q: What should I do if a communication error occurs?

A: Follow the steps below to identify the problem:

1. Check if the ignition is ON.
2. Check if the CarPal is securely plugged into the vehicle's OBD-II port.
3. Turn the ignition off. Then, turn it on after 10 seconds and continue the operation.
4. Check if the vehicle's control module is defective.

Q: What special functions does the CarPal support?

A: The CarPal supports 6 special functions, including Oil Reset, Throttle Reset, EPB Reset, BMS Reset, TPMS Reset, and DPF Regeneration.

Q: Do I need to update the firmware before using it for the first time?

A: Yes. Firmware will automatically update to the latest version once the CarPal is connected with your phone via Bluetooth. You can also tap Mine > Firmware Update to update the firmware manually.

Q: Can multiple devices be bound to one TopDon CarPal App account?

A: Yes.

Note: This equipment has been tested and found to comply with the limits for a Class B digital device, pursuant to Part 15 of the FCC Rules. These limits are designed to provide reasonable protection against harmful interference in a residential installation. This equipment generates, uses, and can radiate radio frequency energy, and if not installed and used in accordance with the instructions, may cause harmful interference to radio communications. However, there is no guarantee that interference will not occur in a particular installation. If this equipment does cause harmful interference to radio or television reception, which can be determined by turning the equipment off and on, the user is encouraged to try to correct the interference by one or more of the following measures:

- Reorient or relocate the receiving antenna.
- Increase the separation between the equipment and receiver.
- Connect the equipment into an outlet on a circuit different from that to which the receiver is connected.
- Consult the dealer or an experienced radio/TV technician for help.

折后正面

折后背面

836-TP09-20000 快速操作指南 包装_Carpal_快速操作指南_风琴折_

80G书纸_单色印刷_297*140mm需折叠_V2

2024.04.10