

Product diagram

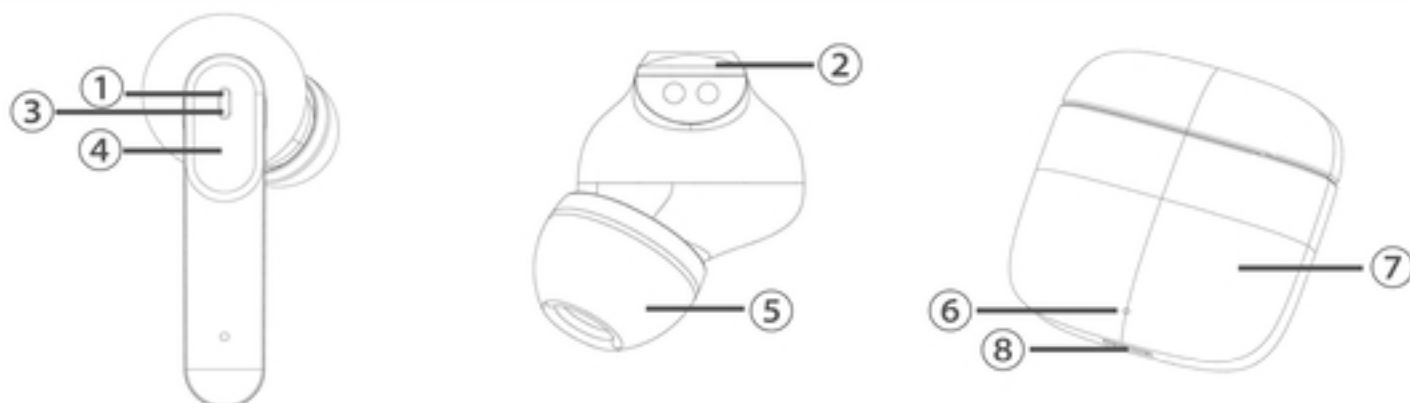

- ①Microphone 1 ②Microphone 2 ③Indicator light 1 ④Operating area
⑤Ear-tip ⑥Indicator light 2 ⑦Charging case ⑧Type-c interface

Pairing

After being taken out from the charging case, the earphones will be paired automatically.
Pairing with the smartphone :

- 1) Take out the earphones from the charging case and confirm that the earphones are waiting to be paired. At this time, the two earphones flash blue lights quickly.
- 2) Turn on the smartphone's Bluetooth, search Bluetooth devices and click 'ZIP20'. A voice prompt as 'Connected' will sound then.
- 3) After the pairing is successful, take out the earphones from the charging case and they will pair with the smartphone automatically.

On/off

Power on

Method 1: Take out the earphones from the charging case, the earphones will boot automatically.

Method 2: In the off state, press and hold the touch area of the earphones for 1 seconds, the earphones will turn on, and you can hear the prompt "power on".

Power off

Method 1: Put the earphones into the charging box, and the earphones will shut down automatically.

Method 2: Turn off the Bluetooth switch of mobile phone, and the earphone will automatically shut down in five minutes.

Method 3: Turn off the Bluetooth switch of mobile phone, press the earphone for 1 seconds and then it shut down.

Listen to the music

- Play/Pause: Touch the left or right earphone twice gently.
Previous: Press and hold the touch area of the left earphone for 2 seconds.
Next: Press and hold the touch area of the right earphone for 2 seconds.
volume+: Touch the right earphone once gently.
volume- : Touch the left earphone once gently.

Call

- Answer a call: Touch the left or right earphone once gently.
Hang up: Touch the left or right earphone twice gently.
Dialing cancellation: During dialing, press the left or right earphone for 2 seconds.
Reject a call: Press the left or right earphone for 2 seconds.

Voice assistant

Touch the left or right earphone three times gently.

Reset

- 1) Delete the connection between the earphone and the phone.
- 2) Tap left and right earphones respectively 5 times, and then red and blue lights of the earphone flash alternately and the earphones enter the state of waiting to pair. Within about 10 seconds, blue lights of the earphones flash alternately, indicating that two earphones complete re-pairing.
- 3) It can be used after reconnecting with the mobile phone.

Charge

Earphones:

Put the earphones into the charging box, the charging case will automatically charge the earphone, and the earphone will display a red light when charging.

Charging case:

Use the type-c charging cable which is included in the package to charge the charging case.

Special Instructions

- 1) Apple iPhones and some Android phones can support the adjustment of phone volume if you need to use headphones to adjust the volume, but for some Android phones, you can only adjust the volume of earphone itself. If you need to restore the default volume, put the earphones in the charging box and take them out after the red light turns on.
- 2) When holding the earphone, do not touch the touch panel area of the earphone to avoid misoperation.

Earphones indicator

Status	Indicator light
No pairing	Red and blue lights flash quickly
Waiting to be paired	One blue light flash quickly
Paired successfully	The indicator light is off
Power on	Red and blue light up quickly for 1 second
Power off	The indicator light is off
Play	The indicator light is off
Pause	The indicator light is off
Standby	The indicator light is off
Incoming call	Blue light flashes twice every 3 seconds
Calling	The indicator light is off
Charging	Red light is always on
End of charging	The indicator light is off

Voice prompts

Status	Voice prompt
Power on	power on
Power off	power off
Low battery	power low
Pairing	pairing
Paired successfully	connected
Disconnect	disconnected
Adjust the volume	"Di"
Adjust the volume to maximum	"DiDi"
Adjust the volume to minimum	"DiDi"

Charging case indicator

Status	Indicator light
Charging	When charging, the indicator light will gradually become bright or dim. Power indicator: Red light: 5-35%; yellow light: 35 -70 %; green light: 70-100%.
Earphones charging	When it is put in the charging box, the corresponding color light in it will be on according to its own power, flashing twice firstly and then continuously lighting for about 8 seconds.
End of charging	Green light turns off after 8 seconds.
Power shortage reminder	Red light flashes quickly.

Precautions

1. Listen with the volume setting as low as possible. Listening at high volume for an extended period may result in permanent damage to your hearing.
2. Keep your earphones and accessories out of reach of children. Children should use the earphones only under adult supervision.
3. Do not expose the earphones to water for a prolonged period. Do not use it when swimming, diving, or in the shower.
4. Using your earphones in a moist or dusty environment, or near a strong magnetic field, may result in an internal circuit failure.
5. Do not store your earphones in an environment where the temperature is below -15°C or above $+50^{\circ}\text{C}$.
6. Do not charge the earphones and the charging case in an environment where the temperature is below 0°C .
7. Do not expose your earphones or charging case to direct sunlight (such as on a window sill or on a car dashboard) for an extended period of time.
8. To avoid damage to your earphones, do not disassemble or tamper with them , and do not insert any foreign matter into them.

Note: This equipment has been tested and found to comply with the limits for a Class B digital device, pursuant to part 15 of the FCC Rules. These limits are designed to provide reasonable protection against harmful interference in a residential installation. This equipment generates, uses and can radiate radio frequency energy and, if not installed and used in accordance with the instructions, may cause harmful interference to radio communications. However, there is no guarantee that interference will not occur in a particular installation. If this equipment does cause harmful interference to radio or television reception, which can be determined by turning the equipment off and on, the user is encouraged to try to correct the interference by one or more of the following measures:

- Reorient or relocate the receiving antenna.
- Increase the separation between the equipment and receiver.
- Connect the equipment into an outlet on a circuit different from that to which the receiver is connected.
- Consult the dealer or an experienced radio/TV technician for help.

This device complies with part 15 of the FCC Rules. Operation is subject to the following two conditions:

(1) This device may not cause harmful interference,

and;(2) this device must accept any interference received, including interference that may cause undesired operation.

Any Changes expressly or modifications not approved by the party responsible for compliance could void the user's authority to operate the equipment.

FCC Radiation Exposure Statement:

This equipment complies with FCC radiation exposure limits set forth for an uncontrolled environment .

This transmitter must not be co-located or operating in conjunction with any other antenna or transmitter.