

LTE Antenna – On Engine

for Gen2A B1

LTE Antenna

Antenna Design

- ▶ Antenna is designed for CCU with housing, PCB and Connectors
 - ▶ 3D Folded U Shape Antenna is used
 - ▶ Higher Efficiency and Covers All the Regions
 - ▶ Max. Size: 73.5mm x 21.8mm x 33.2mm

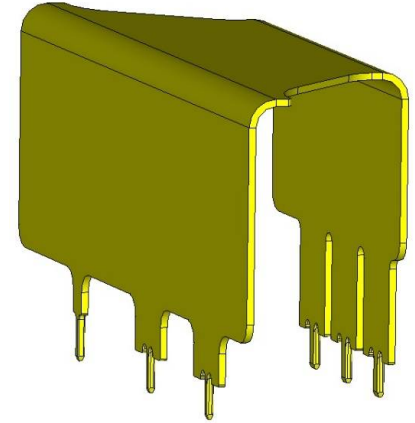
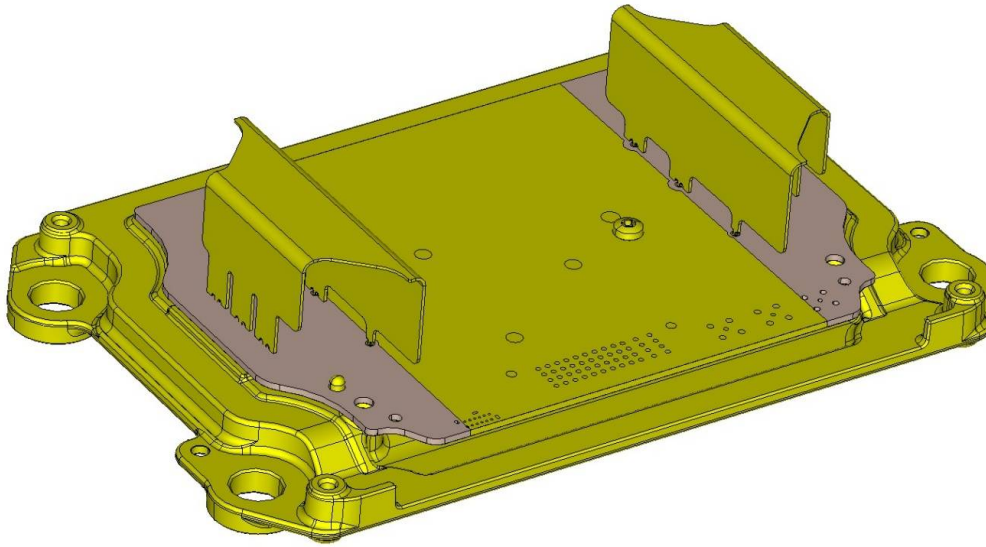

LTE Antenna

Antenna Specifications

Specifications	Value
Frequency Range (MHz)	LB: 700 to 960 HB: 1700 to 2700
VSWR	4:1 for LB 2:1 for HB
Impedance	50 Ohm
Efficiency	➤ 40% for LB ➤ 60% for HB
Polarization	Linear
Connector	Integrated (Through Hole)
Power Handling Capacity	4W (CW)
Dimensions	73.5mm x 21.8mm x 33.2mm

LTE Antenna

Effective Peak Gain – (Metal Antenna+Trace+RF_Switch)

Frequency (MHz)	Gain (dBi)
700	-3.3
750	-2.7
800	-1.8
850	0
900	0.4
960	0.35
1700	4.3
1750	4.4
1800	4.6
1850	5.2
1900	5.2
1950	5.2
2000	4.6

Frequency (MHz)	Gain (dBi)
2050	4.7
2100	5.2
2150	5.1
2200	5.1
2250	4.6
2300	4.4
2350	4.3
2400	4.6
2450	4.5
2500	3.8
2550	2.7
2600	1.9
2650	1.2
2700	1.7