

Quick Start Guide

AP8220 Wireless Access Point



Package Contents



1



2



3



4

1. AP8220 access point
2. One mounting bracket

3. One pack of screws
4. Documentation—*Quick Start Guide* (this document),
Certificate and Warranty card



Warning: For indoor use only. The access point and all connected cables are not suitable for outdoor use.

1 Install the AP

a. Install it on the Wall

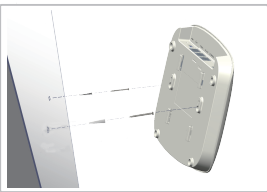

1. Fix two screws on the wall and 110 mm apart.
2. Slide the AP's wall mounting slots down onto the screws so that the unit is secure.

b. Install it on the Ceiling T-Bar

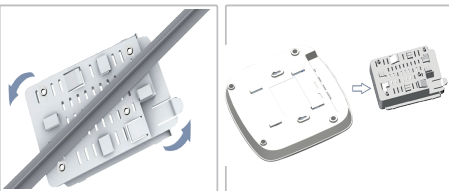

1. Rotate the bracket onto the T-bar of the ceiling.
2. Push the AP toward the bracket until it snaps into place.

c. Install it with Cable Ties (with or without bracket)

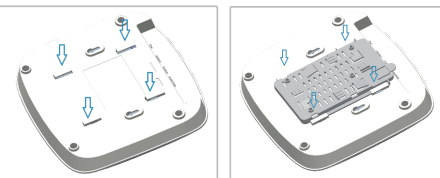

Mode 1: The hole on the back of the access point is threaded into the cable tie, and secured to the water pipe at the top.

Mode 2: First insert the mounting bracket into the AP then insert the cable tie at the show position of the bracket and fix the AP at the top position.

d. Install it on the Ceiling Bracket

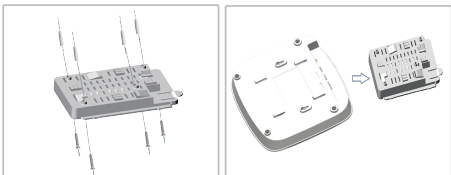

1. Use the included screws to attach the mounting bracket to the wall.
2. Push the AP toward the bracket until it snaps into place.

2 Connect Cables

a. Connect LAN cables

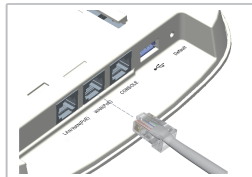

1. Connect the external cable to the WAN/PoE port. When connected the port connection provides power to the device.
 2. (Optional) Connect a local LAN switch or computer cable to the LAN port.
- b. (Optional) Connect AC power adapter (Input: DC 12V / 3A)

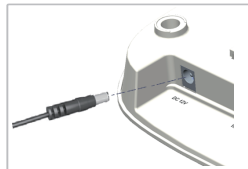

1. Connect the AC power adapter to the DC power jack on the AP and then plug the adapter into a nearby AC power source.

3 Check AP LEDs

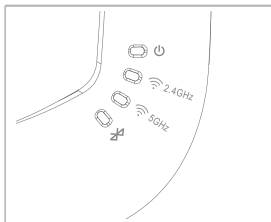

1. Power LED — on green for normal operation.
2. 2.4GHz and 5GHz LEDs — on green for radio enabled.
3. Bluetooth LED — on green for bluetooth enabled.

Port Description

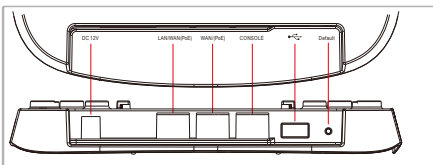

- | | |
|-------------------------------------|------------------------------|
| 1 DC port | |
| 1 2.5G WAN port | Support 10/100/1000M/2.5Gbps |
| 1 2.5G LAN/WAN port | Support 10/100/1000M/2.5Gbps |
| 1 Console RJ45 port | |
| 1 Default button | |
| 2 USB2.0 port(include the side one) | |

Hardware Specifications

Size(WxDxH)	201x195x39.8mm
Weight	0.7kg
Temperature	Working: 0°C to 45°C Storage: -20°C to 60°C
Humidity	5% to 95% (No-condensation)
DC input	12V DC
PoE	Dual Ethernet ports support PoE, 802.3 at power supply
IP rating	IP31



This device complies with Part 15 of the FCC Rules.Operation is subject to the following two conditions:

- (1) this device may not cause harmful interference.
- (2) this device must accept any interference received, including interference that may cause undesired operation.

FCC Statement

This equipment has been tested and found to comply with the limits for a Class B digital device, pursuant to part 15 of the FCC Rules. These limits are designed to provide reasonable protection against harmful interference in a residential installation.

This equipment generates, uses and can radiate radio frequency energy and, if not installed and used in accordance with the instructions, may cause harmful interference to radio communications. However, there is no guarantee that interference will not occur in a particular installation. If this equipment does cause harmful interference to radio or television reception, which can be determined by turning the equipment off and on, the user is encouraged to try to correct the interference by one or more of the following measures:

- Reorient or relocate the receiving antenna.
- Increase the separation between the equipment and receiver.
- Connect the equipment into an outlet on a circuit different from that to which the receiver is connected.
- Consult the dealer or an experienced radio/TV technician for help.

FCC Radiation Exposure Statement

This device complies with FCC radiation exposure limits set forth for an uncontrolled environment and it also complies with Part 15 of the FCC RF Rules. This equipment must be installed and operated in accordance with provided instructions and the antenna(s) used for this transmitter must be installed to provide a separation distance of at least 20 cm from all persons and must not be co-located or operating in conjunction with any other antenna or transmitter. End-users and installers must be provided with antenna installation instructions and consider removing the no-collocation statement.

Caution!

Any changes or modifications not expressly approved by the party responsible for compliance could void the user's authority to operate the equipment.

包装清单



1



2



3



4

1. AP8220无线接入点
2. 1个安装支架

3. 1包螺钉
4. 文档—快速入门指南(本文档)、合格证和保修卡



警告：仅限在室内使用。接入点和所有连接的线缆不适合在室外使用。

1 安装接入点

a. 在墙上安装

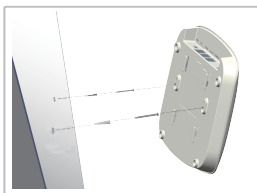

1. 用两个螺丝固定在墙上，螺钉间保持 110 mm 距离。
2. 将接入点的壁挂槽向下滑动到螺钉，以使设备牢固。

b. 在吊装T型杆上安装

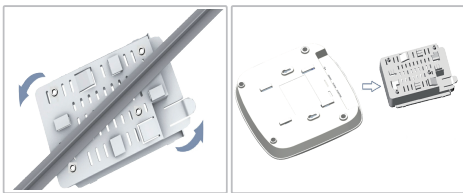

1. 将支架卡旋转吊顶的T型杆上。
2. 将接入点向支架方向推，直到其牢固卡扣到位。

c. 扎带固定安装(带支架或者不带支架)

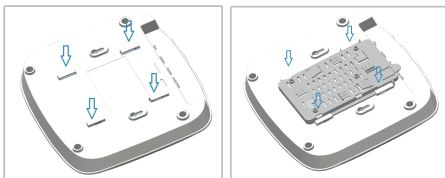

方式一：接入点背面的孔穿入扎带，固定在顶部的水管上。

方式二：先将安装支架卡入接入点，然后在支架的图示位置穿入扎带并将接入点固定在顶部的位置。

d. 在吊顶支架上安装

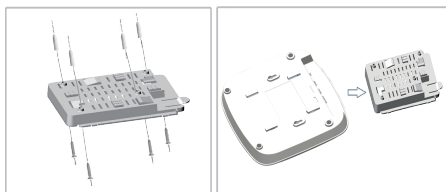

1. 使用附带的螺钉将吊顶支架安装到墙上。
2. 将接入点向支架方向推，直到其牢固卡扣到位。

2 连接线缆

a. 连接WAN线缆

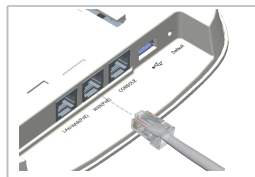

1. 将外部线缆连接到WAN(PoE)口。连接到 PoE 源时，端口为设备供电。
2. (可选)本地 LAN 交换机或计算机线缆连接到LAN口。

b. (可选) 连接交流电源适配器 (输入规格: DC 12V/3A)

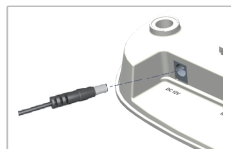

1. 将交流电源适配器连接到设备上的DC接口，然后将适配器连接到外部交流电源上。

3 检查指示灯

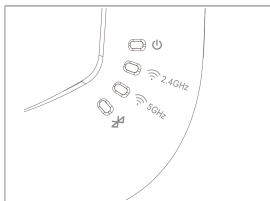

1. 电源指示灯—亮绿灯表示正常工作。
2. 2.4GHZ 和 5GHZ 指示灯—亮绿灯表示无线通讯已启用。
3. 蓝牙指示灯—亮绿灯表示蓝牙已启用。

端口说明

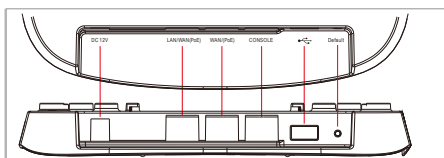

- 1个DC接口
- 1个2.5G GE WAN 接口 支持 10/100/1000M/2.5Gbps
- 1个2.5G GE LAN/WAN接口 支持 10/100/1000M/2.5Gbps
- 1个Console RJ45接口
- 1个复位按钮
- 2个USB2.0接口(含侧面1个)

硬件规格

尺寸 (WxDxH)	201x195x39.8mm
重量	0.7kg
温度	工作: 0° C 到 45° C 存储: -20° C 到 60° C
湿度	5% 到 95% (无冷凝)
DC输入	12V DC
PoE	双以太网支持 PoE, 802.3at 供电
IP等级	IP31