

# Motion Activated Dual Head Security Light with Camera

Model: PAC018 , PAC027



Please read all instructions thoroughly and carefully prior to installing this product. Retain these instructions for future reference.

We assume no liability or responsibility for claims arising from improper installation or improper use. Failure to follow these instructions could result in voiding the product warranty.

## ***IMPORTANT SAFETY INSTRUCTIONS***

Before you begin installing, servicing, or maintenance of this product, follow these general precautions.

- To reduce the risk of death, personal injury or property damage from fire, electric shock, falling parts, cuts/abrasions and other hazards please read all warnings and instructions included with and on this product prior to installation.
- **For commercial installation: service and maintenance of this product should be performed by a qualified, licensed electrician.**
- **For residential installation: If you are unsure about the installation or maintenance of this product, consult a qualified licensed electrician.**
- Do not mount the unit against flammable surfaces.
- This product is intended to be used outdoors, and be subject to the elements; such as rain and snow and we recommend it to be mounted at least 6' 6" off the ground
- This LED product must be powered directly to a switched circuit.
- Make sure that where this fixture will be mounted is structurally sound and that it will support the weight of this fixture
- This product should not be used in areas with limited ventilation or high ambient temperatures.
- This product is intended to be connected to a properly installed and grounded UL listed junction box.

## ***WARNING: RISK OF ELECTRICAL SHOCK***

- Turn off electrical power at fuse or circuit breaker box before wiring product to the power supply.
- Verify voltage is 100V-240V before installing.
- Make all electrical and grounded connections in accordance with the National Electric Code and any applicable local code requirements.
- All wiring connections should be capped with UL listed wire connectors.

## ***CAUTION: RISK OF PRODUCT DAMAGE***

- Never connect fixture with power on.
- Do not mount or support product in a manner that can cut the outer wire jacket or damage the wire insulation.
- Avoid covering LED products with insulation, foam, or other materials that will prevent convection or conduction cooling.
- Never connect an LED product directly to dimmer packs, occupancy sensors, timing devices, or other related control devices, unless individual product specifications deem otherwise.
- LED products are polarity sensitive, ensure proper polarity before installation.
- Electrostatic Discharge (ESD) can cause damage to LED products. Wear personal grounding equipment during installation and service of the product.

- Do not touch the individual electronic components, it may cause ESD (Electronic Discharge), shorten lamp life or alter performance.

**CAUTION: RISK OF INJURY**

- Wear gloves and safety glasses at all times when removing fixture from carton, installing or servicing the product.
- Avoid direct eye exposure to the light source while it is on.
- **LED LIGHTS ARE EXTREMELY BRIGHT, UNDER NO CIRCUMSTANCES SHOULD YOU LOOK DIRECTLY INTO AN LED LIGHT, THIS MAY CAUSE IRREPARABLE DAMAGE TO THE EYES.**
- Please dispose of packaging materials and account for all small parts as these can be hazardous to small children.

**WARNING: RISK OF BURN**

- Allow fixture to cool completely before handling.
- Do not exceed maximum voltage marked on the label.
- Keep combustible and other materials that can burn away from the light, lamp, and lens.

**Specifications:**

Electrical Rating	100-240VAC /35W
Motion Detection	Maximum1.80degree,10m
Lumen	2600lm
Colour temperature	3000k
Reording resolution	1080p
Clouding Reconrding	Yes
Local Recording	Yes
Micro SD card	Yes(not includes)
Waterproof	IP55

**Installation Instructions**

**\*\* Note: this fixture can be wall or eave mounted \*\***

Part	Description	Quantity
A	Light Fixture	1
B	Plastic Screw Cover	1
C	Cross Bar (Included, optional use)	1
D	Light Fixture Screw (pre-installed)	1
E	Quick Connect Mounting Plate	1
F	Long Mounting Screws (one pre-installed onto product)	2
G	Motion Detector	1
H	Short Mounting Screws (optional use)	2

Silicon Sealant recommended (not included)

**Tools Required for Installation:** Phillips screwdriver, level

**MOUNTING AND WIRING THE LIGHT**

Existing electrical wires from mounting surface

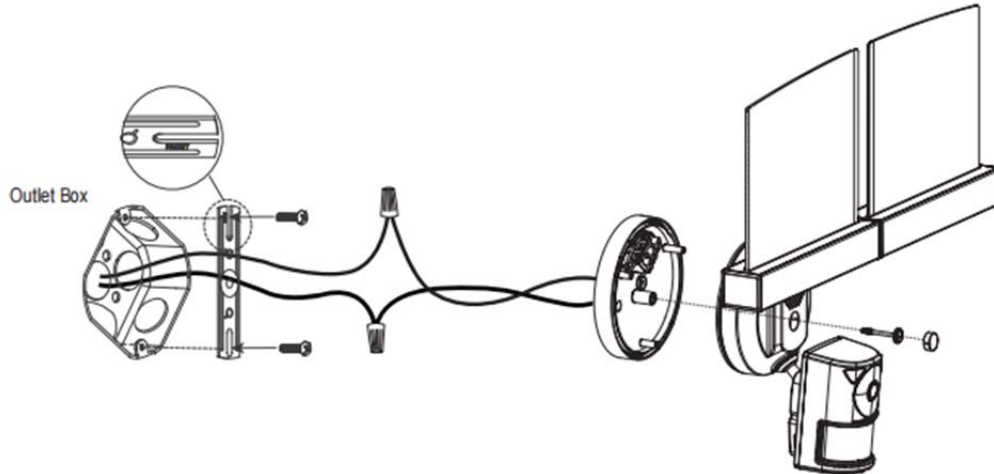

**NOTE: DO NOT MOUNT ON THE GROUND, RECOMMENDED INSTALLATION sHEIGHT IS 6 ½ FEET TO 10 FEET**

**\*\* Before you begin make sure that your power is turned off at your circuit breaker box \*\***

**\*\* Do not rely on the switch power being turned off \*\*\*\***

1. The fixture mounting bracket (A) is pre-assembled on the light fixture (B). Unscrew both the decorative cover (DD) and the fixture mounting screw (EE) in order to remove the mounting bracket (A).

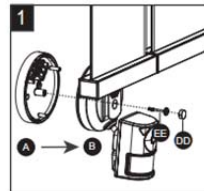

2. Install the mounting strap (CC) to the outlet box with the stamped word "FRONT" facing away from the outlet box, using two mounting screws (AA) that best fit the outlet box. Mounting bracket (A) should sit flush against wall surface when secured. (Choose one matching pair of suitable mounting screws (AA) from the 3 pairs provided).

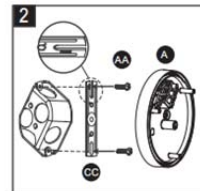

3. Pull out the source wires from the outlet box. Make wire connections using wire connectors (FF) as follows:
  - Connect the black wire from the fixture to the "hot" wire from the power source.
  - Connect the white wire from the fixture to the neutral wire from the power source.
 Carefully tuck the wires back into the outlet box.

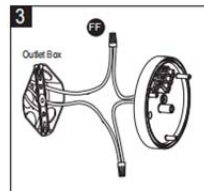

4. Place mounting bracket (A) against the outlet box, insert the mounting bracket screw (BB) through the mounting bracket hole, thread mounting bracket screw (BB) into the center hole of the mounting strap(CC). Tighten the mounting bracket screw (BB) securely.
  - ▲ When mounting to a wall, the "UP" arrow must point upward.
  - ▲ When mounting to an eave, the "UP" arrow must point toward the building.

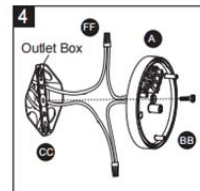

5. Attach the backplate(B) of the light fixture to the mounting bracket(A), secure it with the fixture mounting screw(EE). Then push the decorative cover (DD) firmly into the fixture mounting screw (EE) hole on the light fixture.

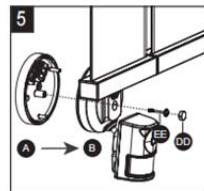

6. With silicone caulking compound, caulk completely around where the mounting bracket meets the wall surface.
 

**CAUTION: Be sure to caulk completely where the mounting bracket meets the wall surface to prevent water from seeping into the outlet box.**

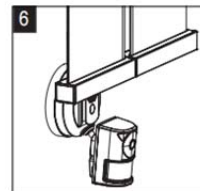

**ADJUSTING YOUR LIGHT HEADS**

Your light heads can be adjusted by turning the individual light head to desired position. You can also adjust your light head up and down to your desired position.

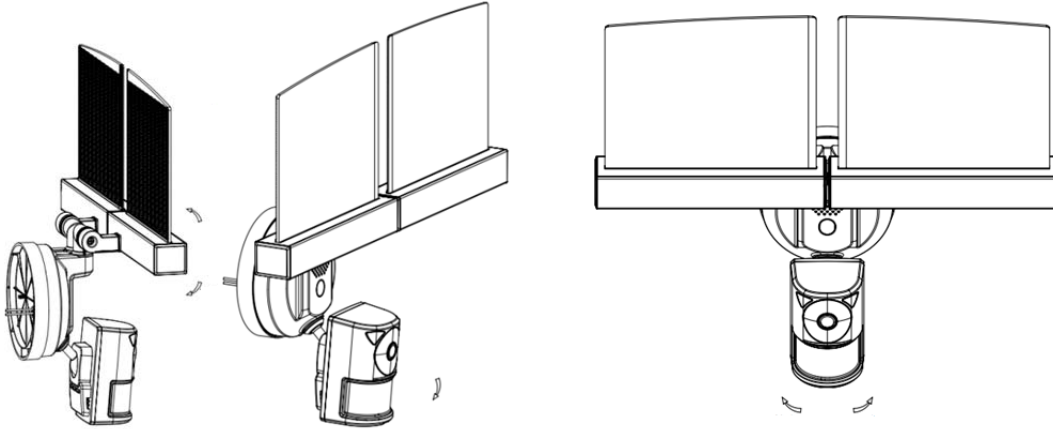

**Indicator light:**

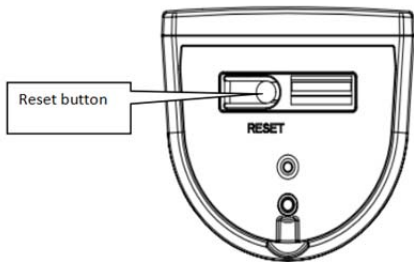
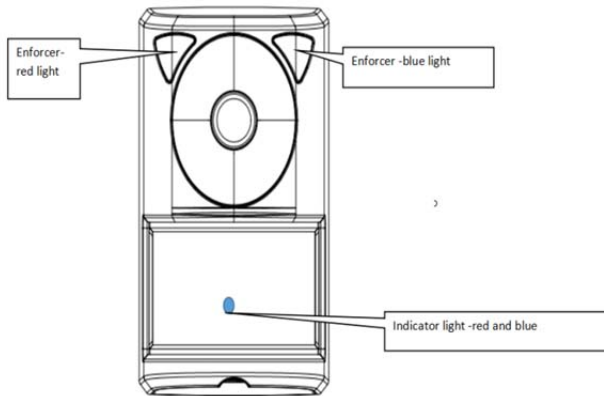

**Note: Fixture can be wall mounted or eave mounted.**

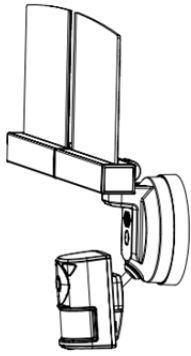

**Wall mounted**

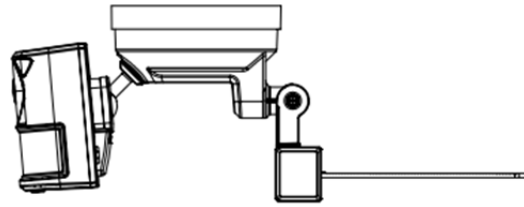

**Eave mounte\**

(Light fixture and sensor should be mounted as shown above when installed (depending upon type of installation).

**APP User guide:**

Setting light through mobile device. Search "Guard 720" or "Swann security" in IOS APP store or in Android Google play. Install the "Guard 720" or "Swann security" App onto the device. (Take Guard 720 as an example)

1. \* Register a new account:

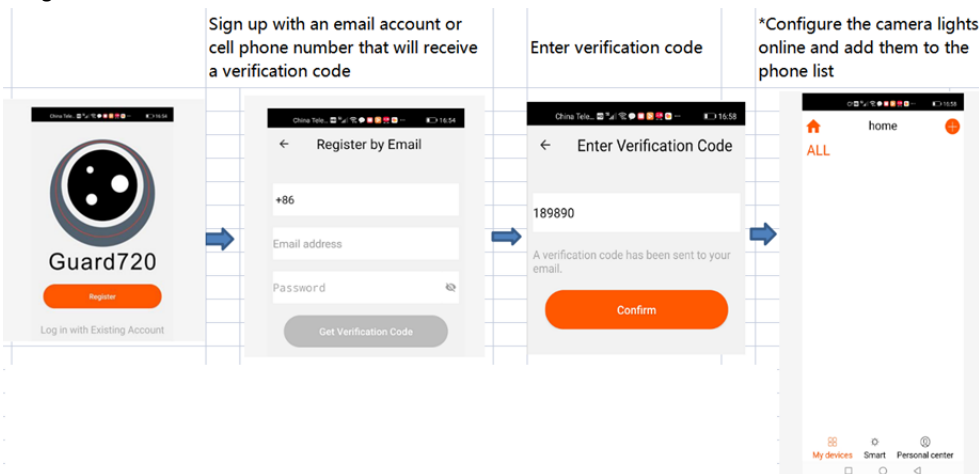

- 2.

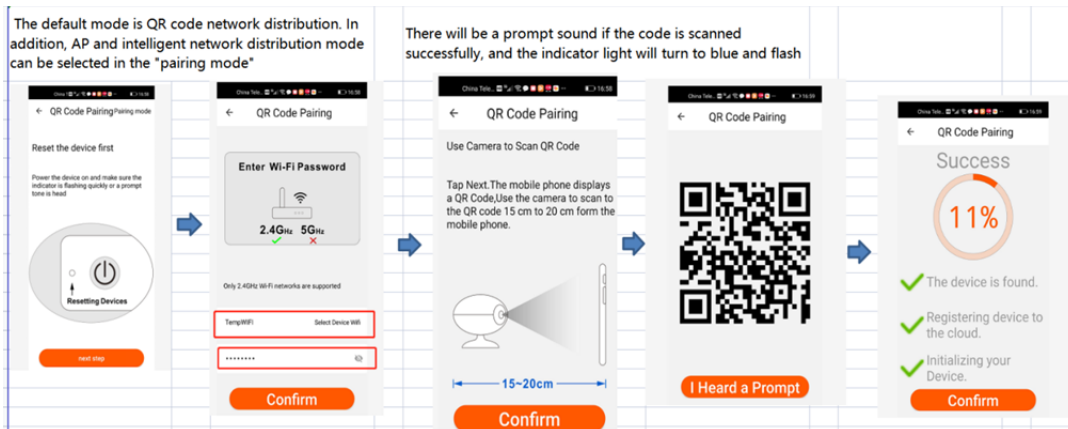

- 3

3.

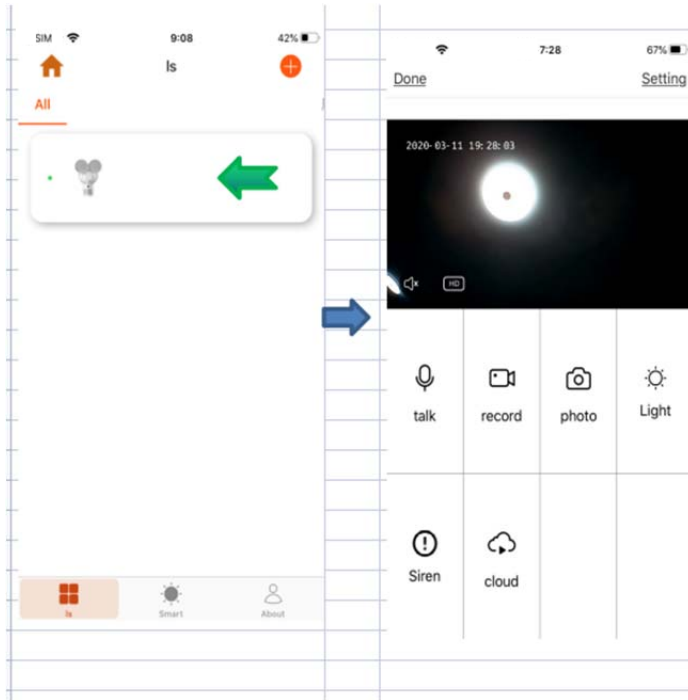

### **TROUBLE SHOOTING**

If the light does not come on:

- Verify the power is turned on at the switch and breaker
- Verify that the product is properly wired
- Verify that the line voltage is correct (100V-240V)

If the manual override stays on after dawn

- The ambient light lever may be too low (not enough light)

### **FCC WARNING**

Any Changes expressly or modifications not approved by the party responsible for compliance could void the user's authority to operate the equipment.

This device complies with part 15 of the FCC Rules. Operation is subject to the following two conditions:

(1) This device may not cause harmful interference, and (2) this device must accept any interference received, including interference that may cause undesired operation.

FCC Radiation Exposure Statement:

This equipment complies with FCC radiation exposure limits set forth for an uncontrolled environment.

This transmitter must not be co-located or operating in conjunction with any other antenna or transmitter.

This equipment should be installed and operated with minimum distance 20cm between the radiator& your body.

Note: This equipment has been tested and found to comply with the limits for a Class B digital device, pursuant to part 15 of the FCC Rules. These limits are designed to provide reasonable protection against harmful interference in a residential installation. This equipment generates, uses and can radiate radio frequency energy and, if not installed and used in accordance with the instructions, may cause harmful interference to radio communications. However, there is no guarantee that interference will not occur in a particular installation. If this equipment does cause harmful interference to radio or television reception, which can be determined by turning the equipment off and on, the user is encouraged to try to correct the interference by one or more of the following measures:

- Reorient or relocate the receiving antenna.
- Increase the separation between the equipment and receiver.
- Connect the equipment into an outlet on a circuit different from that to which the receiver is connected.
- Consult the dealer or an experienced radio/TV technician for help.

#### ISED RSS WARNING

This device complies with ISED licence-exempt RSS standard (s). Operation is subject to the following two conditions:

(1) this device may not cause interference, and (2) this device must accept any interference, including interference that may cause undesired operation of the device.

Le présent appareil est conforme aux CNR d'ISED applicables aux appareils radio exempts de licence. L'exploitation est autorisée aux deux conditions suivantes:

(1) l'appareil ne doit pas produire de brouillage, et (2) l'utilisateur de l'appareil doit accepter tout brouillage radioélectrique subi, même si le brouillage est susceptible d'en compromettre le fonctionnement.

#### ISED RADIATION EXPOSURE STATEMENT

This equipment complies with ISED RF radiation exposure limits set forth for an uncontrolled environment.

This transmitter must not be co-located or operating in conjunction with any other antenna or transmitter.

This equipment should be installed and operated with minimum distance 20cm between the radiator & your body.

Cet appareil est conforme aux limites d'exposition de rayonnement RF ISED établies pour un environnement non contrôlé.

Cet émetteur ne doit pas être co-implanté ou fonctionner en conjonction avec toute autre antenne ou transmetteur.

Cet équipement doit être installé et utilisé avec une distance minimale de 20cm entre le radiateur & votre corps.