



CLT146401

User Manual

14.1" Laptop with Windows™ 10 S

Read Before Use

1. This laptop works best in non-tropical areas below 6560 feet (2000 meters).
2. Protect your device from impact from bumps and falls.
3. Do not use this device for extended periods of time in environments that are either too cold, too hot, too humid or too dusty. Do not expose the device to direct sunlight.
4. Avoid using this device in strong magnetic and static environments as much as possible.
5. If the device comes into contact with water or any other liquid, power it off immediately and wait for it to dry completely before turning it on again.
6. Do not clean the device with any cleaning products containing chemicals, to avoid damage caused by corrosion and dampness. When cleaning is necessary, use a dry, soft cloth.
7. The company shall not be held responsible for the loss or deletion of material inside the device caused by abnormal software and hardware operation, maintenance or any other accidents.
8. Please regularly back up important data and files to avoid loss.
9. Please do not disassemble the device by yourself; doing so will void the warranty.

Unit at a Glance

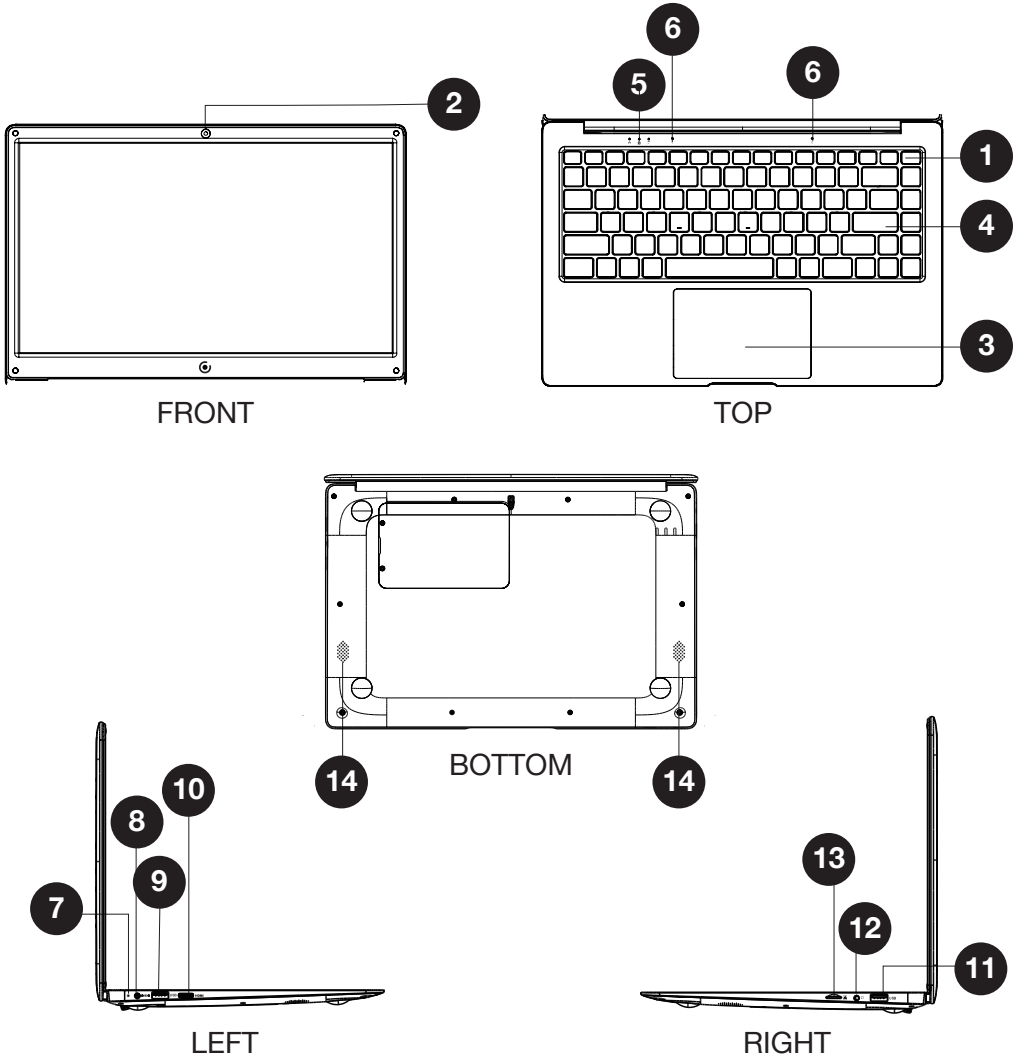

1. **Power Button:** Turn your device on or off. Use to set your device to Sleep or to wake it from Sleep.
2. **Front Camera:** Take photos and videos.
3. **Touchpad:** Use the touchpad to move your cursor.

Unit at a Glance (Continued)

4. **Keyboard:** Use the keyboard for typing.
5. **Indicators:**
 - 1 - The first light from the left indicates that the Power is on.
 - 2 - The middle light indicates that Caps Lock is on.
 - 3 - The third is the Num Lock indicator. When this light is on, you may use the secondary keys on your keyboard.
6. **Microphone:** Transmits audio signals.
7. **Charging Indicator:** Red light illuminates when connected to a power adapter.
8. **Charging Port:** 5V/2.5A charger.
9. **USB Input:** Connect external USB devices.
10. **Mini HDMI® Output:** Connect your laptop to a monitor, TV or other HDMI®-enabled device.
11. **USB Input:** Connect external USB devices.
12. **Headphone Jack:** Transmit audio signals to speakers or headphones.
13. **Micro SD Card Slot:** Built-in memory card reader slot that supports Micro SD format up to 128GB.
14. **Speakers:** Built-in 2x1W speakers allow you to playback sound without connecting external devices.

Getting Started

Fully charge your laptop for at least six hours before initial use. Use the included wall charger. The battery indicator will confirm that your device is charging.

Turn your laptop on by pressing and holding the power key for two seconds.

Once the screen is loaded, connect to your Wi-Fi® network. To wake the screen from sleep, press the power key and the lock screen should appear. Next, press the upwards arrow key (↑) and log in. Sign in if your laptop requires a password to log in.



Use your information to create a user account. You can use this account to create, modify or remove other accounts on this device.