



USER MANUAL

CELLULAR EQUIPPED
BASE STATION

SPECIFICATIONS



Parameter	Value	Units
Input Voltage	5	VDC
Operating Voltage	3.3	VDC
Peak Power Consumption	3.3	W
Peak Current Draw	1	A
Average Power Consumption	330	mW
Average Current Draw	100	mA
Operating Temperature	-10° to 40°	C
Weight	145	grams
Length	137	mm
Width	91	mm
Height	24	mm
Power Adapter Specifications		
Input Voltage (max)	240	VAC
Input Voltage Frequency	50/60	Hz
Output Voltage	5	VDC
Output Current (max)	1000	mA
Power Output (max)	5	W

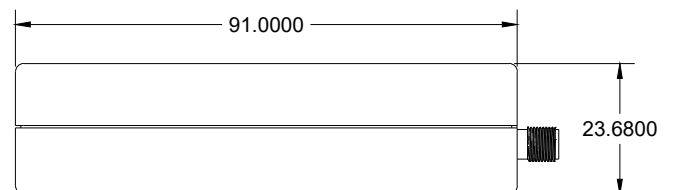
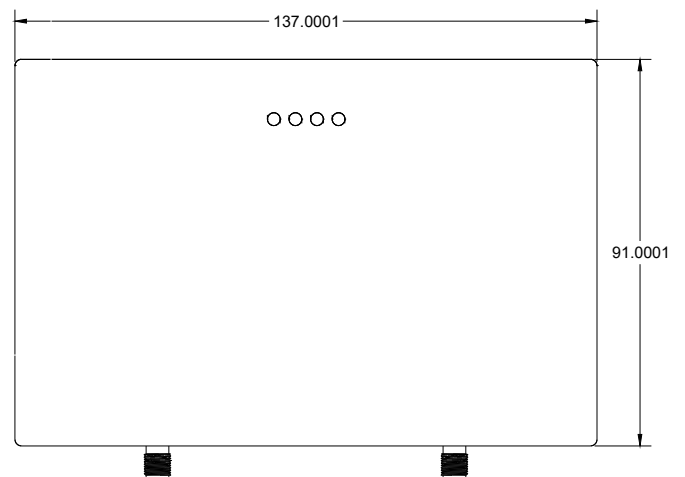
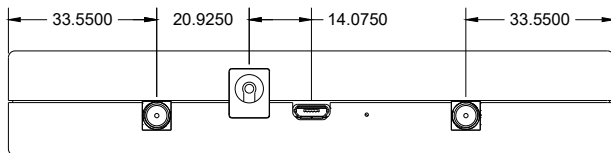
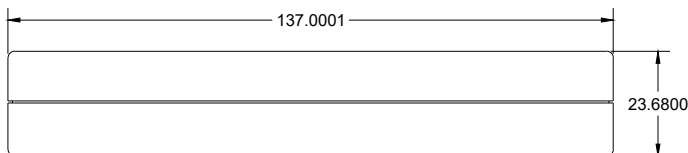

For installation instructions, please follow the guidance on the Retail Aware Portal Field Tools page by visiting portal.retailaware.com and clicking on "Field Tools"

Once you have used the Field Tools to install the device, simply plug the device into a power outlet.

NOTE: Changes or modifications not expressly approved by Retail Aware Inc. could void the user's authority to operate the equipment.

This equipment has been tested and found to comply with the limits for a Class A digital device, pursuant to part 15 of the FCC Rules. These limits are designed to provide reasonable protection against harmful interference when the equipment is operated in a commercial environment. This equipment generates, uses, and can radiate radio frequency energy and, if not installed and used in accordance with the instruction manual, may cause harmful interference to radio communications. Operation of this equipment in a residential area is likely to cause harmful interference in which case the user will be required to correct the interference at his own expense.

This device complies with Part 15 of the FCC Rules. Operation is subject to the following two conditions:

1. This device may not cause harmful interference, and
2. This device must accept any interference received, including interference that may cause undesired operation.

To comply with RF exposure requirements, Please maintain 20cm separation from the device.

This device contains licence-exempt transmitter(s)/receiver(s) that comply with Innovation, Science and Economic Development Canada's licence-exempt RSS(s). Operation is subject to the following two conditions:

1. This device may not cause interference.
2. This device must accept any interference, including interference that may cause undesired operation of the device.

This equipment complies with IC radiation exposure limits set forth for an uncontrolled environment. This equipment should be installed and operated with minimum distance 20cm between the radiator & your body.

L'émetteur/récepteur exempt de licence contenu dans le présent appareil est conforme aux CNR d'Innovation, Sciences et Développement économique Canada applicables aux appareils radio exempts de licence.

L'exploitation est autorisée aux deux conditions suivantes :

- (1) L'appareil ne doit pas produire de brouillage;
- (2) L'appareil doit accepter tout brouillage radioélectrique subi, même si le brouillage est susceptible d'en compromettre le fonctionnement.

Le dispositif est conforme aux limites d'exposition au rayonnement ci fixées pour un environnement non contrôlé. La distance minimale entre le radiateur et votre corps doit être de 20 cm lors de l'installation et du fonctionnement de cet appareil.