

使用说明

双边真无线蓝牙耳机

产品示意图

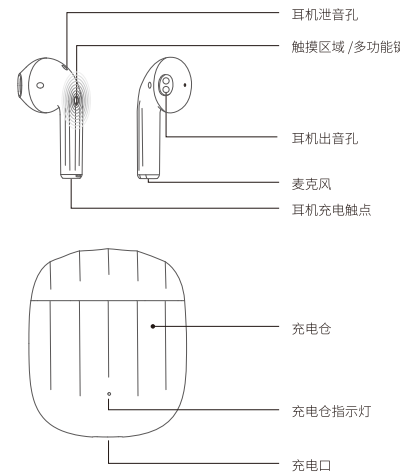

产品参数

产品名称:双边真无线蓝牙耳机
型号:Airplus-032Z
佩戴方式:半入耳式
蓝牙版本:V5.0
蓝牙音频解码:AAC/SBC
支持协议:HFP A2DP AVRCP
喇叭灵敏度:115 dB
麦克风灵敏度:42dB
频率范围:50Hz~10KHz
耳机电池容量:30mAh
充电仓电池容量:400mAh
输出阻抗:450Ω
额定功率:5mW

驱动单元:Φ13mm
音乐时长:4H
通话时长:3.5H
耳机待机时间:约120H(连接状态)
输入:5v=340ma
充电输入口:Type C
可给双耳机充电次数:约4次
耳机充电时间:约1H
充电仓充电时间:约80分钟
充电仓尺寸:55.3*46.5*22.5mm
耳机尺寸:35.2*16.4*18.3mm
产品材质:ABS
产品净重:44g

包装清单



配对操作

- 1.打开充电仓,耳机自动开机;
- 2.打开手机蓝牙,搜索蓝牙设备“Airplus-032Z”点击连接,连接成功后,即可使用耳机听歌通话;
- 3.单边耳机使用:连接蓝牙后取出左/右任意一个耳机,即可单耳使用,此时可以正常单耳听歌通话使用。

备注:首次连接该耳机需要手动连接,非首次连接耳机会自动回连最后连接过的设备(苹果安卓手机连接方式一致)



操作说明

① 开机/关机	
耳机开机	打开充电仓上盖耳机自动开机
耳机关机	耳机放回充电仓关闭充电仓上盖耳机自动关机 长按左/右耳机多功能按键3秒关机 开机3分钟无连接设备,自动关机
② 音频状态功能定义	
播放/暂停	单击任意一边耳机的多功能键
上一曲	双击左边耳机多功能键
下一曲	双击右边耳机多功能键
③ 通话定义:	
来电接听	单击一边耳机的多功能键
来电挂断	单击一边耳机的多功能键
来电拒接	长按任意一边耳机的多功能键2秒,提示音:“嘟”
④ 语音助手功能	
iOS系统设备	长按2S任意一边耳机的多功能键“滴”一声后唤醒Siri
Android系统设备	长按2S任意一边耳机的多功能键“滴”一声后唤醒语音助手(确保安卓系统自带语音助手方可召唤)

无线充电



功能	指示灯状态
充电状态	白灯常亮
充满电状态	白灯灭

充电仓指示灯

产品状态	指示灯状态
充电仓给耳机充电	左耳充电:绿灯闪烁
	右耳充电:白灯闪烁
	左右耳同时充电,绿灯白灯交替慢闪
充电仓充电	白灯常亮
充电仓充满电	充满灭

充电仓一共有2个LED灯	白色,绿色
绿灯常亮	100%-52%电量
白灯常亮	52%-13%电量
白灯闪	低于13%电量

提示音说明

提示项	提示音说明
关机	提示音:“嘟”升调
开机	提示音:“嘟”升调
连接设备成功	提示音:“嘟嘟”升调
呼叫Siri/关闭Siri	提示音:“滴”
断开设备	提示音:“嘟嘟”降调
入耳检测	提示音:“咚钢琴声”
电池低电量报警	提示音:“嘟嘟”(低于3.4V,60秒循环播报一次,直至3.0V低电量关机)

安全准则

1. 请遵循本说明书的使用说明,勿以任何理由拆卸或改装设备,否则可能导致耳机发生故障或烧毁;
2. 请勿将产品浸入任何液体或用水冲洗产品;
3. 请勿使用超过耳机额定电流电压(5V/1A)以外的充电器给耳机充电,否则将容易造成耳机电池损坏(请使用搭配的充电线给耳机充电)
4. 请在常温环境中使用和存放本产品,勿将设备置于温度过低或过高(0°以下或者45°以上)的环境中;
5. 请勿堵塞耳机的开口处,如充电口、指示灯和麦克风等;
6. 请避免过大音量或者过长时间使用耳机,避免造成头晕或对听力造成伤害。
7. 请勿在雷暴天气下使用设备,雷暴可以导致设备工作不正常,信号中断等现象。

保修卡

用户名: _____
 用户电话: _____
 用户地址(含邮编): _____
 购机日期: _____
 发票编号: _____
 销售单位名称: _____
 售后服务商: _____
 全国售后电话: _____

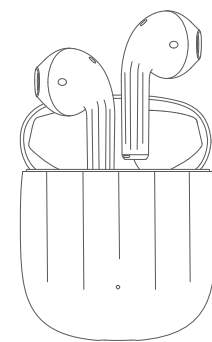

Use Manual

TWS Bilateral Wireless Earphone

Structure diagram

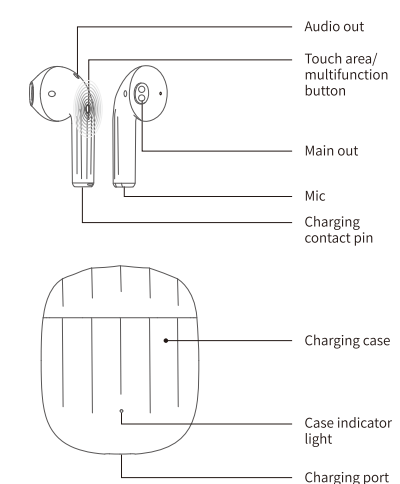

Parameters

Name: TWS Bilateral Wireless Earphone
Model: Airplus-032Z
Type: half in-ear
BT version: V5.0
Audio decoding: AAC / SBC
Supporting protocols: HFP, A2DP, AVRCP
Speaker sensitivity: 115 DB
Mic sensitivity: -42db
Frequency range: 50 Hz ~ 10 kHz
Earphone battery capacity: 30mAh
Case battery capacity: 400mAh
Output impedance: 450 Ω
Rated power: 5mW
Speaker: Φ 13mm

Music time: 3.5H
Talk time: 3.5H
Standby time: About 120H (connected)
Input: 5v=340ma
Charging port: Type C
Cycle count: about 4 times
Earphone Charging time: About 1H
Case charging time: About 80 minutes
Case size: 55.3*46.5*22.5mm
Earphone size: 35.2*16.4*18.3mm
Material: ABS
Net weight: 44g

Packing list

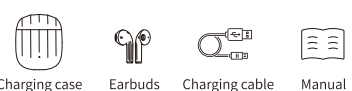

Pairing operation

1. The earphone will open automatically once opening the charging case.
2. Turn the phone BT function on and search for BT device "Airplus-032Z", connect the phone with it. You can use it to listen to music or for calls after being connected successfully.
3. Single earphone mode: you can take the left / right earphone out arbitrarily to use the single earphone mode after you connect the earphone with the phone BT function. At this time, you can listen to music and you can also make a call with a single earphone normally.

Note: Connecting the earphone manually for the first time and then it will connect to the last connected device automatically (Apple & Android connecting in the same way)

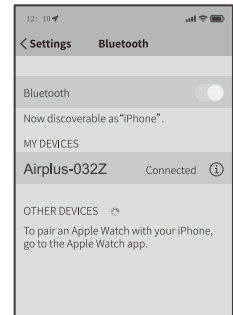

Operating instructions

① ON/Off	
Turn on	The earphone will turn on automatically once you open the charging case
Turn off	The earphone will turn off automatically once you put the earphone back to the charging case and close the cover Long press the left/right multifunctional button of the earphone for 8 seconds to turn it off It will turn off automatically without connecting for 3 minutes
② Audio function	
Play/Pause	Click the multifunctional button on either side
Prev	Double click the multifunctional button of left earphone, the prompt tone of hoofs sound you can hear
Next	Double click the multifunctional button of right earphone, the prompt tone of hoofs sound you can hear
Note: Double click the left/right earphone will go to the next song (Only supports the next song function)	
③ Call	
Answer	Click the multifunctional button of either earbuds
Hang up	Click the multifunctional button of either earbuds
Reject	Long press the multifunctional button of either earphone for 2s, the prompt tone of hoofs sound you can hear

④ Voice assistant	
iOS system	Long press the multifunctional button of either earphone for 2s to wake Siri up and the prompt tone of tick sound you can hear
Android system	Long press the multifunctional button of either earphone for 2s to wake the voice assistant up and the prompt tone of tick sound you can hear (make sure the Android system with voice assistant before wake it up)

Indicator light of charging case

Product status	Indicator status
Charging the earphone by charging case	Charging the left earphone: the green light keeps on
	Charging the right earphone: white light flashing
	Charging the right earphone: white light flashing
Charging the charging case	The white light keeps on
Full charged	Light is off when full charged
The charging case with two LED lights	White, green
Green light keeps on	100%-52% battery capacity
White light keeps on	52%-13% battery capacity
White light flashing	Lower than 13% battery capacity

Prompts instructions

Prompts	Description
Turn off	Prompt tone: beep sound in rising tune
Turn on	Prompt tone: beep sound in rising tune
Get connected	Prompt tone: beep, beep sound in rising tune
Wake Siri up/ shut down	Prompt tone: tick sound
Disconnected	Prompt tone: beep, beep sound in falling tone
In-ear detection	Prompt tone: rataplan sound similar to the piano sound
Low battery alarm	beep, beep sound (broadcast every 60 seconds when lower than 3.4V, it will not stop until the earphone power off at 3.0V low battery)

Prompts instructions



Function	Indicator status
Charging	The white light keeps on
Full charged	The white light is off

Mode No.:EP032B

FCC ID:2AVLI-EP031B

Warranty Card

User Name: _____
User Tel.: _____
User Add.: _____
Purchase Date: _____
Invoice No.: _____
Dealer Name: _____
User Add.: _____
Dealer Tel.: _____

FCC Requirement

changes or modifications not expressly approved by the party responsible for compliance could void the user's authority to operate the equipment.

This device complies with Part 15 of the FCC Rules. Operation is subject to the following two conditions:

- (1) this device may not cause harmful interference, and
- (2) this device must accept any interference received, including interference that may cause undesired operation.

Note: This equipment has been tested and found to comply with the limits for a Class B digital device, pursuant to Part 15 of the FCC Rules. These limits are designed to provide reasonable protection against harmful interference in a residential installation. This equipment generates, uses, and can radiate radio frequency energy, and if not installed and used in accordance with the instructions, may cause harmful interference to radio communications. However, there is no guarantee that interference will not occur in a particular installation. If this equipment does cause harmful interference to radio or television reception, which can be determined by turning the equipment off and on, the user is encouraged to try to correct the interference by one or more of the following measures:

- Reorient or relocate the receiving antenna.
- Increase the separation between the equipment and receiver.
- Connect the equipment into an outlet on a circuit different from that to which the receiver is connected.
- Consult the dealer or an experienced radio/TV technician for help.