

ANC Headset H001

T.S. Pioneer |



User Manual

Specifications

Solution:	CSR8635
Version:	5.0
Protocol:	HSP/HFP/A2DP/AVRCP
Music Playback Time (ANC off):	25-30 hours
Talk Time (ANC off):	25-30 hours
Range:	10meters
Frequency Range:	20Hz-20kHz
Speaker Impedance:	32Ω
Charging Time:	1.5-2 hours
Battery Capacity:	3.7V/500mAh

Features

- ANC Active Noise Cancellation: feedforward and feedback noise cancelling, effective noise reduction.
- Wireless Stereo-Support wireless devices and support stereo music.
- Handsfree: CVC voice calling.
- Auto-reconnect: Auto-reconnect after power on if connected before.
- Compatibility: Compatible to most of wireless devices in the market.
- Rotatable,Retractable: suitable for most of head style of people, comfortable wearing.
- Long standby time: Powerful battery life.

※Please read carefully the manual before using and keep it as a record

Know Your Headset

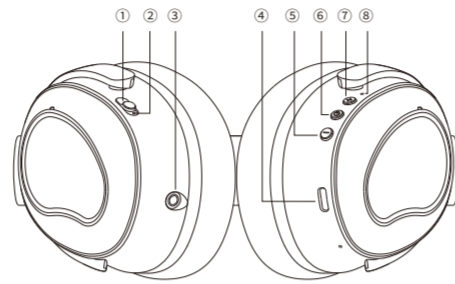

- | | |
|------------------------|-------------------------------|
| ① ANC ON/OFF | ⑤ VOL- / Previous Song |
| ② ANC Indicator | ⑥ MFB (Multi-Function Button) |
| ③ 3.5mm Audio Port | ⑦ VOL+ / Next Song |
| ④ Type-C Charging Port | ⑧ Indicator |

Package Content

- Wireless headset
- User manual
- USB to Type-C Charging cable
- 3.5mm audio cable

Headset Pair with Smart Phone

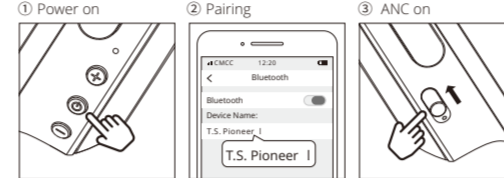

① Power on
Press and hold the MFB 5 sec until the red and blue light flash in turns.

② Pairing
Headset pairs with smart phone. Voice prompt: "Your device is connected", the light remains blue.

③ ANC on
Slide the switch to the top to turn on the ANC, the light remains green.

Scalable

Scalable, to fit different types of head, make sure to wear comfortable

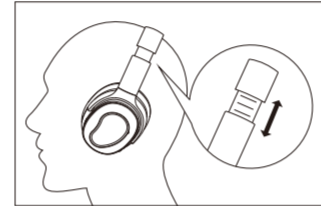

Product Instruction

Power off:
In the state of power-on, press and hold the MFB at least 3 sec, the red light will flash once and with the voice prompt of "power off".

Pairing:
In the state of power-off, press and hold the MFB at least 5 sec until the red and blue light flash in turns, then you will hear the voice prompt "Pairing", then you can connect with your phone.

Pairing status:
Voice prompt: "Pairing", red light and blue light flash in turns.

Connected:
Voice prompt: "Your device is connected", blue light flashes slowly.

Disconnected:
Voice prompt: "Your device is disconnected", blue light flashes twice every second.

Last number redial:
Press MFB twice when headset is standby, it will redial the last number.

Answer/end phone calls:
Press MFB to answer the phone call.
Press MFB once to end the phone call.

Reject the phone calls:
Press MFB twice to reject the phone call.

Play/pause:
Press MFB once to play/pause the music.

Previous song/next song:
While listening to the music, press and hold "VOL-" button to skip to the previous song; Press and hold "VOL+" button to skip to the next song.

Volume up/volume down:
While playing the music, short press "VOL-" button to reduce the volume. Short press "VOL+" button to increase the volume.

Lower battery warning/Power off:
When the headset is low battery, the right LED indicator will flash red continuously with the voice prompt "low battery" every 3 minutes. When the battery runs out, the headset will power off.

Indicator:
When charging, the light remains red. When full-charged, the indicator light will change from red to blue.

Noise Cancelling:
Slide the switch to the top to turn on the ANC, the light remains green. Slide the switch to the bottom to turn off ANC, the green light is off.

※The headset will power off if there is no connection within 5 minutes.

- Attention**
- When use the audio cable to connect this headset with the device, the function of this wireless headset is same as the wired type. The ANC button is still working while all other buttons become disabled.
 - If headset doesn't work, please check if the battery is exhausted, please charge it fully first.
 - To guarantee the battery life, please power off the headset if not in using. Please charge the headset with the equipped cable.
 - Please charge the headset if not in using for long time.
 - Please don't change the built-in battery by yourself.
 - Please don't put the headset under wet or rainy place.
 - Please don't expose the headset under the blazing sun or over 45°C, not mention to fire to avoid battery accident.
 - Please don't twist the headset in reverse direction.
 - Please don't disassemble the headset if unprofessional.
 - When headset is not using state, please turn off the ANC switch to avoid loss of power.

FCC Statement

Changes or modifications not expressly approved by the party responsible for compliance could void the user's authority to operate the equipment. This equipment has been tested and found to comply with the limits for a Class B digital device, pursuant to Part 15 of the FCC Rules. These limits are designed to provide reasonable protection against harmful interference in a residential installation. This equipment generates uses and can radiate radio frequency energy and, if not installed and used in accordance with the instructions, may cause harmful interference to radio communications. However, there is no guarantee that interference will not occur in a particular installation. If this equipment does cause harmful interference to radio or television reception, which can be determined by turning the equipment off and on, the user is encouraged to try to correct the interference by one or more of the following measures:

- Reorient or relocate the receiving antenna.
- Increase the separation between the equipment and receiver.
- Connect the equipment into an outlet on a circuit different from that to which the receiver is connected.
- Consult the dealer or an experienced radio/TV technician for help

This device complies with part 15 of the FCC rules. Operation is subject to the following two conditions: (1) this device may not cause harmful interference, and (2) this device must accept any interference received, including interference that may cause undesired operation.

Made in China



头戴式无线降噪耳机

T.S. Pioneer |



说明书

规格参数

芯片方案:	CSR8635
蓝牙版本:	5.0
支持协议:	HSP/HFP/A2DP/AVRCP
音乐播放时间(ANC 关闭):	25-30 小时
通话时间(ANC 关闭):	25-30 小时
传输距离:	10米
频率范围:	20Hz-20kHz
喇叭:	32Ω
充电时间:	1.5-2 小时
电池容量:	3.7V/500mAh

产品特点

- ANC主动降噪:前馈+反馈混合降噪,有效减缓周围环境的噪声。
- 无线立体声:支持无线设备并支持立体声音乐。
- 免提功能:CVC高清语音通话。
- 自动重新连接:如果之前已连接,则开机后自动重新连接。
- 超强的兼容性:兼容市场上的大多数无线设备。
- 舒适佩戴:耳机可旋转和伸缩,适合不同用户的头型,佩戴舒适且稳固。
- 超长待机:超长续航。

※请在使用前仔细阅读本说明书,并保存备用。

耳机图示

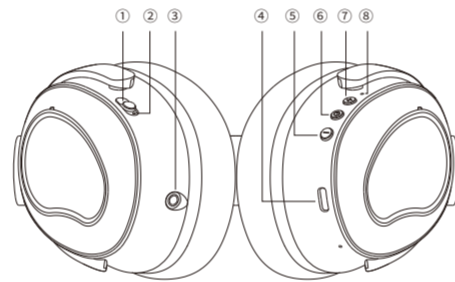

- | | |
|--------------|-----------|
| ① 主动降噪开关 | ⑤ 音量减/上一曲 |
| ② 主动降噪指示灯 | ⑥ 多功能按键 |
| ③ 3.5mm 音频口 | ⑦ 音量加/下一曲 |
| ④ Type-C 充电口 | ⑧ 指示灯 |

包装清单

- 无线降噪耳机
- 说明书
- USB转Type-C充电线
- 3.5mm 音频线

耳机与智能手机配对

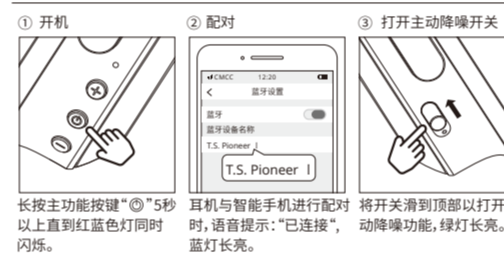

① 开机
长按多功能按键 5秒以上直到红蓝色灯同时闪烁。

② 配对
耳机与智能手机进行配对时,语音提示:"已连接",蓝灯长亮。

③ 打开主动降噪开关
将开关滑到顶部以打开主动降噪功能,绿灯长亮。

伸缩调节

本产品可以伸缩调节,适合不同用户的头型,确保佩戴舒适

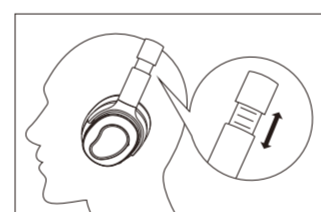

产品介绍

关机:
在开机状态下,长按多功能按键 3秒以上,红灯闪烁一次,语音提示"关机",电源随之关闭。

配对:
在关机状态下,长按多功能按键 5秒以上直到红蓝灯交替闪烁,然后你会听到"配对中"的提示音,进入配对模式。

配对状态:
语音提示:"配对中",红蓝灯交替闪烁。

已连接:
语音提示:"已连接",蓝灯长亮,连接后转蓝灯慢闪。

断开连接:
语音提示:"断开连接",蓝灯每秒闪烁两次。

回接功能:
待机状态下,双击多功能按键,将重拨上次拨打的电话号码。

接听/挂断通话:
来电时,单击多功能按键接听通话。
通话时,单击多功能按键挂断当前通话。

拒接来电:
来电时,双击多功能按键拒接通话。

播放/暂停:
播放音乐时,单击多功能按键控制音乐的暂停和播放。
上一曲/下一曲:
听音乐时,长按"VOL-"按钮可切换至上一首歌曲。长按"VOL+"按钮切换到下一首歌曲。

音量+/音量-:
播放音乐时,短按"VOL-"按钮可减小音量。短按"VOL+"可增加音量。

低电量警告/关机:
低电量时,右耳指示灯变成红灯连续闪烁,每3分钟语音提示一次"低电量"。耳机电量耗尽将自动关机。

指示灯:
耳机充电时,红灯亮。充满电后,指示灯由红灯将变为蓝灯。

耳机降噪:
将开关滑到顶部打开ANC功能,绿灯长亮。
将开关滑到底部关闭ANC,绿灯熄灭。

※如果5分钟内没有连接,耳机将自动关机。

注意事项

- 当使用音频线连接本产品与使用设备时,本产品的功能等同于有线耳机。除了ANC功能可以正常使用外,其他按键均无法操作使用。
- 如果耳机无法工作,请检查电池是否耗尽后再对耳机进行充电。
- 为保证电池使用寿命,不使用时请关闭耳机。务必使用包装中赠送的数据线为耳机充电。
- 如果长时间不使用,请给耳机充电。
- 请勿将耳机放在潮湿或多雨的地方。
- 请勿将耳机暴露在超过45°C的地方,以避免电池遇火发生事故。
- 请勿将耳机往反方向拧。
- 非专业人士请勿拆卸耳机。
- 不使用时请将降噪开关关闭,以免造成电量损失。