

## Bluetooth Tripod Selfstick

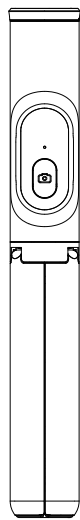

User Manual

Bluetooth Tripod Selfstick  
User Manual

## Product Description

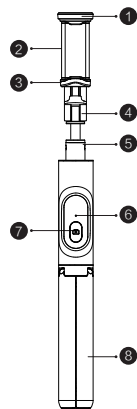

1. Upper Fixator
2. Phone Holder
3. Lower Fixator
4. Rotational Axis
5. Extendable Stick
6. Remote Control Indicator
7. Capture Button
8. Tripod

## Contents

Bluetooth Tripod Selfstick\*1  
User Manual\*1

EN

## Quick Guide

1. Press and hold the Capture Button for 2 seconds to power on. Enable the Bluetooth on the mobile phone to start searching and click "ITFIT Selfie P007" on the searched device list. The green indicator will go off after successful connection.
2. Go to Camera App mode and start to take selfies.

## User Notes

**Remote Control**  
Take the remote control from the selfie stick for long-distance photographing.

Press the Capture Button to take a photo or record a video (under the REC mode).

**Tripod**

Unfold the tripod in the bottom, push the extendable stick up and place the tripod on a flat surface.

**Power Off**

Press and hold the Capture Button for 3 seconds and the green indicator will flash for 3 times before going off.

**Preventive Measure**

Do not move the phone by force after it's clamped in case of damage to the phone shell.

## Reminders

1. In case of no operation within 3 minutes after Bluetooth is connected, the selfie stick will automatically enter the Sleep Mode. Press the Capture Button again to restore connection. In the event of no operation after 6 hours in the Sleep Mode, the selfie stick will automatically power off.
2. In case of low battery during the use of the selfie stick, the indicator will turn red and flash. Please replace the battery in a timely manner.

EN

## Warnings

1. Watch your hands during use.
2. The product is not designed for children under 14 years old. Do not swallow it.
3. Do not dismantle or modify the product.
4. Do not store the product in a humid environment.
5. Keep the product away from heat sources.
6. Do not expose the product to water or other liquids in case of damage.

## How to Install it

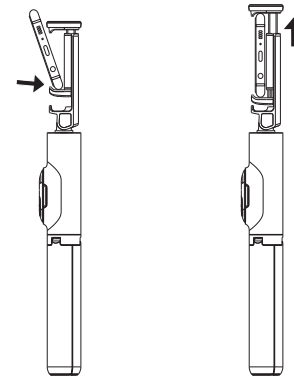

1. Insert the phone into the lower fixator slantwise.

2. Pull the upper fixator up to snap the phone into the holder.

EN

EN

## How to Use it

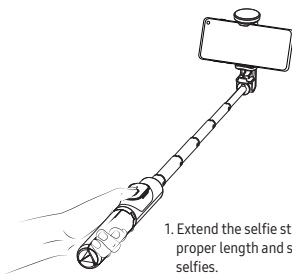

1. Extend the selfie stick to the proper length and start to take selfies.

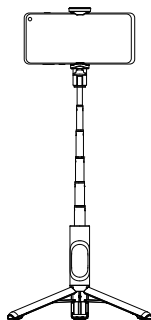

Barrier-free Operation within  
10 Meters

2. Unfold the tripod, push the extendable stick up and place the tripod on a flat surface. Start to take selfies.

EN

## How to Replace Battery

Take the remote control from the selfie stick, push the rear cover at the direction of the arrow, and take off the rear cover for battery replacement.

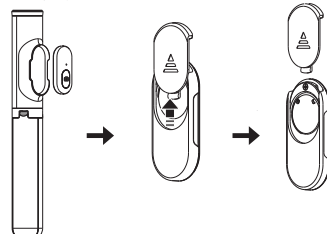

## How to Take off the Phone

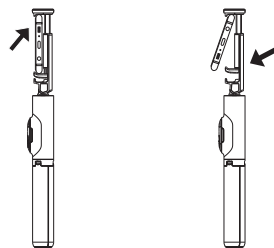

1. Hold the phone with one hand and pull the upper fixator up.

2. Slide the phone out.

EN

## Product Specifications

Product Name	Bluetooth Tripod Selfstick
Model No	ITFIT Selfie P007
Rated Voltage	3V
Place of Origin	China
Weight	142g
Materials	ABS+ Aluminum Alloy
Length of Storage	207mm
Battery Capacity	75mAh
Product operating temperature range	-20°C~+53°C

The device has been evaluated to meet general RF exposure requirement, The device can be used in portable exposure condition without restriction Federal Communication Commission (FCC) Radiation Exposure Statement Power is so low that no RF exposure calculation is needed.

This device complies with part 15 of the FCC rules. Operation is subject to the following two conditions:

(1) this device may not cause harmful interference, and  
(2) this device must accept any interference received, including interference that may cause undesired operation.

NOTE: The manufacturer is not responsible for any radio or TV interference caused by unauthorized modifications or changes to this equipment. Such modifications or changes could void the user's authority to operate the equipment.

FCC ID:2AVIA-ITFITP007

Manufacturer:Winners' Sun Plastic & Electronics (Shenzhen) Co., Ltd.  
Address: 1/F-4/F of Factory 6 & 3/F of Factory 2, Detai Industrial Park, 496 Huarong Road, Langkou Community, Dalang Sub-district, Longhua District, Shenzhen Guangdong, China



Copyright©2020 ITFIT All rights reserved Made in China