

WIFI wireless smart switch

2AVHBB120

Quick install guide



smart life

① switch power

Confirm the total power supply position of the house or the manufacturer, and then turn off the total switching power supply.

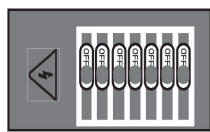

When installing or repairing, please confirm that the line is completely powered off to avoid the risk of electric shock.

② Remove the switch

After confirming that the power has been disconnected, use a flat-blade screwdriver to remove the original conventional switch.

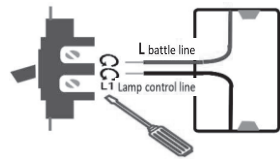

③ switch line connection

Connect the live wire and each power cable to the switch base in sequence according to the wiring diagram.

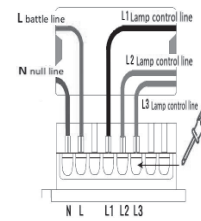

⑤ switch install

Use a flat-blade screwdriver to secure the switch bottom box to the cassette, then cover the glass panel.

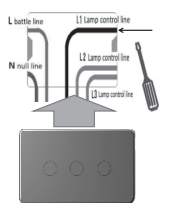

④ Open the pannel

Use a flat-blade screwdriver to insert the switch housing connector and turn the screwdriver to open the glass panel cover.

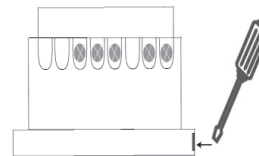

⑥ Turn on power

After confirming that the installation is complete, turn on the main power and wait for about 10 seconds before you can start using the switch.

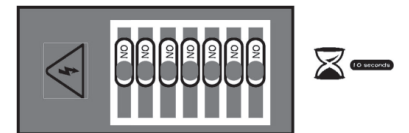

Pay attention matters

- Install this product with the power off.
- Do not install in a humid environment
- Do not use beyond the load.
- The total power of the electrical connection device cannot be greater than the maximum rate of the outlet.
- Please install the manual installation steps.
- Do not disassemble or install other equipment as this may cause a safety hazard.

Specification

Rated voltage	100V ~ 240V/50Hz
Negative line current	each way : Capacitive load < 200W, Resistive load < 500
Operating temperature	0 ~ 50°C
Use environment	indoor limit
Wifi & Zigbee frequency	2.4G Hz

How to install smart life app

- Open the mobile app and download the [Smart Life] app. You can also search for it in ios store or Google Play to install the app.
- Open [Smart Life] APP Click [Register], use your phone number or email to register for [Smart Life] account, and then log in to the app.
- When [Successfully add 1 device] appears, the connection is complete and your device will be listed in your APP list.

Easy mode

- Make sure your smart device is powered on and your phone is connected to a Wi-Fi network. Press and hold any button for more than 3 seconds until the indicator light starts flashing rapidly (about 2 times per second) which means the device is already configured for configuration
- Open the [Smart Life] APP, click [+] in the upper right corner of the APP, select the device type, click on it, and then confirm [the indicator light flashes rapidly]. This will automatically get the Wi-Fi network password that your phone is connected to, and then click [OK] to connect to the device.
- When [Successfully add 1 device] appears, the connection is complete and your device will be in your APP list.

Now you can control your smart device from anywhere with your mobile app (make sure your phone and smart device are connected to the network). Once you've successfully added your device, you can share it with friends or family. You will enjoy more features (reference picture)

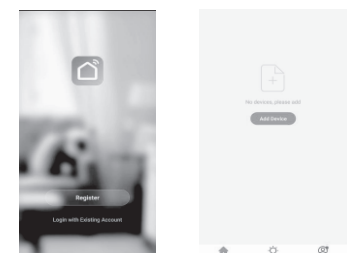

FCC Statement

This device complies with part 15 of the FCC Rules. Operation is subject to the following two conditions:

(1) This device may not cause harmful interference, and (2) this device must accept any interference received, including interference that may cause undesired operation. Any Changes or modifications not expressly approved by the party responsible for compliance could void the user's authority to operate the equipment.

Note: This equipment has been tested and found to comply with the limits for a Class B digital device, pursuant to part 15 of the FCC Rules. These limits are designed to provide reasonable protection against harmful interference in a residential installation. This equipment generates uses and can radiate radio frequency energy and, if not installed and used in accordance with the instructions, may cause harmful interference to radio communications. However, there is no guarantee that interference will not occur in a particular installation. If this equipment does cause harmful interference to radio or television reception, equipment generates, uses and can radiate radio frequency energy and, if not installed and used in accordance with the instructions, may cause harmful interference to radio communications. However, there is no guarantee that interference will not occur in a particular installation. If this equipment does cause harmful interference to radio or television reception,

- Reorient or relocate the receiving antenna.
- Increase the separation between the equipment and receiver.
- Connect the equipment into an outlet on a circuit different from that to which the receiver is connected.
- Consult the dealer or an experienced radio/TV technician for help.

FCC RF Radiation Exposure Statement

The equipment should be installed and operated with minimum distance 20cm between the radiator and your body.