

材质：120g铜版纸覆亚膜 双面印刷 风琴折

成品尺寸：65*90mm*7P

产品说明书

车载无线充电器

CE FC RoHS
中国制造

产品介绍

感谢您购买本公司产品，本产品是一款智能车载手机无线充电器，让您轻松体验数码产品无限乐趣。使用本产品前请认真阅读并妥善保管本手册，以备查阅。

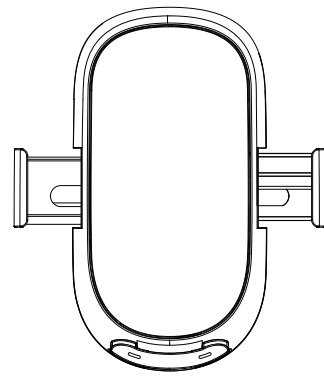

配件清单

车载无线充电器
Type-C 电源线
说明书
QC 车充头 (选配)
出风口夹 (选配)
中控台支架 (选配)

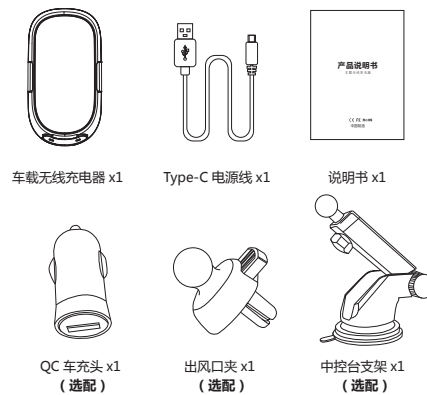

注：QC 车充头、出风口夹、中控台支架均为选配，并非标配。

安装方式一

1. 将塑胶螺母装入球头，然后安装到车载无线充电器固定卡位，旋紧螺母，出风口安装成功。(如图①②所示)

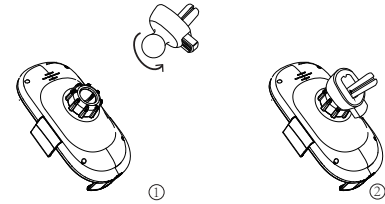

2. 出风口夹安装好后，将车载无线充电器卡在车内导风叶片上固定；将Type-C 电源线一端连接车载无线充电器底部接口，另一端连接 QC 车充头；通电后，车载臂膀自动张开，指示灯为白色灯，长亮 2 秒灭，进入待机状态。(如图③所示)

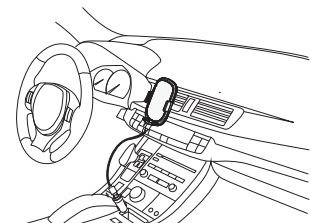

注：充电板由智能芯片控制，可放心长期待机。

3. 使用手指触摸外壳右后上角的感应区域(如图④所示)臂膀自动感应张开，将手机置于其中，臂膀自动锁紧；取拿手机时，以手再次触摸外壳右后方(如图⑤所示)，可打开臂膀，取出手机即可。

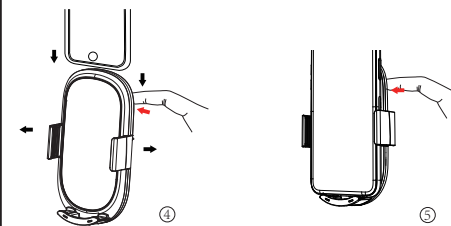

4. LED 状态显示为：通电后，LED 指示灯长亮 2 秒，灯灭后进入待机状态；充电时，LED 指示灯长亮 2 秒，灯灭后进入充电状态；满电后，LED 指示灯长亮 2 秒，灯灭，报警停止充电(如图⑥所示)

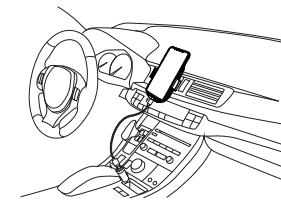

注：目前只有三星手机支持满电提示，其余手机充满电后充电器不作任何提示。

安装方式二

1. 将塑胶螺母装入球头，然后安装到车载无线充电器固定卡位，旋紧螺母，支架安装成功。(如图⑦⑧所示)

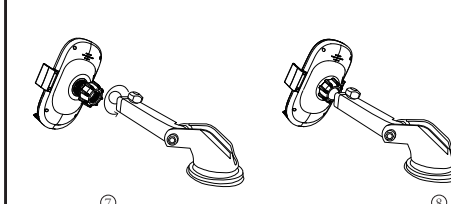

2. 将其固定在车内中控台上；也可以固定在挡风玻璃上。(如图⑨所示)

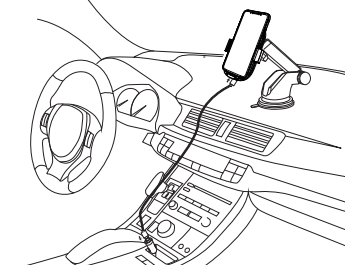

3. 以上安装步骤参照安装方式一(3-4)。

产品规格

输入电压	5V \equiv 2A 9V \equiv 1.8A
工作频率	110-205KHz
电力转换	\leq 75%
规格尺寸	126mm*67mm*53mm

注意事项

1. 本产品请用标配Type-C电源线，要求电源线电流1.5-2A；
2. 车载充电器不宜置于潮湿或高温环境下，此产品不防水，适宜温度为0-60 $^{\circ}$ C；
3. 使用过程中会有一些发热，车内常温下发热不超过60 $^{\circ}$ C属正常现象；
4. 各类无线手机充电电流以及电池容量存在差异，所以充满电时间不一致，与车载无线充电器充电性能无关；
5. 请在汽车启动后再使用本产品，避免因汽车点火时电瓶电压过低影响汽车点火；
6. 注意Type-C接口的卫生，长时间不用时取下车载充电器存放；
7. 请将本产品远离儿童放置。

注：从安全考虑出发，劣质QC车充头极易发生安全隐患，建议用户从正规渠道选购正品QC车充头、Type-C电源线。

PRODUCT MANUAL

In-car Wireless Charger

CE FC RoHS
MADE IN CHINA

Product Introduction

Thanks for choosing us!
This is a in-car wireless charger for smartphone that allows enjoying the fun of digital products easily.
Please read the manual carefully before using the product, and keep properly for checking.

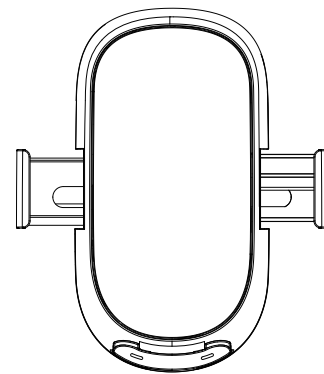

Configuration list

In-car wireless charger
Type-C cable
Product manual
Quick charge adapter(option)
Air outlet clip (option)
Center console holder(option)

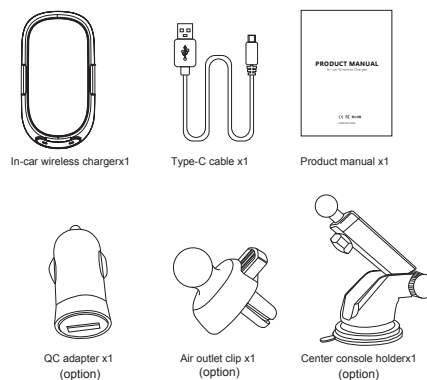

Remark:Quick charge adapter,air outlet clip and center console holder are for your options rather than standard configurations.

Installation 1

1. Atch the plastic nut with the ball joint, and fix it on the back of in-car wireless charger, tighten it. (AS①②)

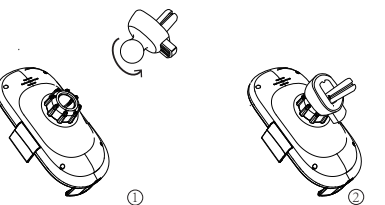

2. Fix the charger on the air-outlet in the car with the clip, and let the type-C cable link the charger with the Quick Charge adapter, wings will automatically open. The white indicator will light for 2s and then in standby mode after power on (As③)

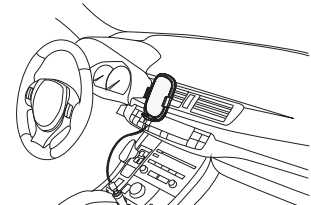

NOTE: Our fast wireless charger is in control of smart chip, and long-term standby is assured.

3. Touch sensing area at the upper right corner of the backside housing, wings will automatically open (as shown in figure ④). Then put your mobile phone on car charger, wings will be locked automatically. When taking out your mobile phone, just lightly touch the same sensing area. (as shown in figure ⑤).

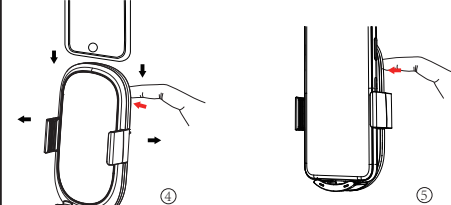

4. LED staus display as: white breathing indicator keeps 2s once charged with electricity, and standby is no indication. when there is a phone charged, LED breathes s and goes off. White breathing indicator keeps 2s when obile phone is full charged. Alarm stop charging (AS⑥)---

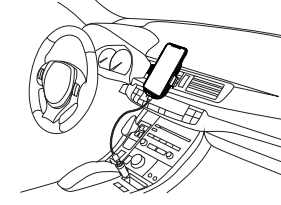

NOTE: Only samsung mobile phone conform to the full recharge feedback now. Another phone will not send any notice after full recharged.

Installation 2

1. Attach the plastic nut with the ball joint, and fix it on the base of in-car wireless charger, tighten it. (as⑦⑧)

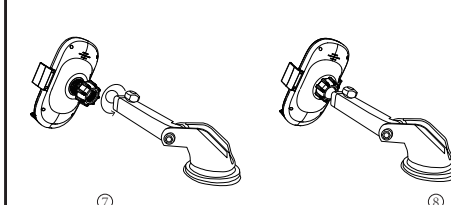

2. Fix it on center console or on windshield. (AS ⑨)

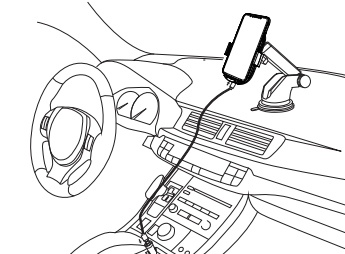

3. The rest steps are close to **Installation 1** (3-4)

Specification

Input	5V \equiv 2A 9V \equiv 1.8A
Frequency	110-205KHz
Efficiency	\leq 75%
Size	126mm*67m*53mm

Attention

1. Standard type-c cable with 1.5-2A current is required.
2. Vehicle charger should avoid wet or high temperature environment, non-waterproof and the temperature should between 0-60 $^{\circ}$ C.
3. Heating Under 60 $^{\circ}$ C is a normal situation of the charger at normal temperature.
4. Different devices differ the time before full-charged because of the actual current or battery capacity, which is not about the charger's quality.
5. It should be used after starting the vehicle, to avoid failure of ignition caused by a very low voltage.
6. Keep the type-C port clean, and take down the charger while it's not in frequent use.
7. Keep it away from children.

NOTE: Poor quality chargers cause a lot danger, thus you'd better get the chagers and type-C cables from regulated channels for safe.

FCC Statement

This device complies with part 15 of the FCC rules. Operation is subject to the following two conditions: (1) this device may not cause harmful interference, and (2) this device must accept any interference received, including interference that may cause undesired operation.

Caution: Changes or modifications not expressly approved by the party responsible for compliance could void the user's authority to operate the equipment.

NOTE: This equipment has been tested and found to comply with the limits for a Class B digital device, pursuant to part 15 of the FCC Rules. These limits are designed to provide reasonable protection against harmful interference in a residential installation. This equipment generates and can radiate radio frequency energy and, if not installed and used in accordance with the instructions, may cause harmful interference to radio communications. However, there is no guarantee that interference will not occur in a particular installation. If this equipment does cause harmful interference to radio or television reception, which can be determined by turning the equipment off and on, the user is encouraged to try to correct the interference by one or more of the following measures:

- Reorient or relocate the receiving antenna.
- Increase the separation between the equipment and receiver.
- Connect the equipment into an outlet on a circuit different from that to which the receiver is connected.
- Consult the dealer or an experienced radio/TV technician for help important announcement

Radiation Exposure Statement

The equipment complies with FCC radiation exposure limits set forth for an uncontrolled environment. During the operation of device a distance of 15 cm surrounding the device and 20 cm above the top surface of the device must be respected.